

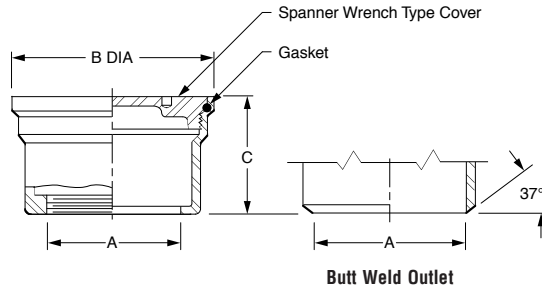

SPECIALTIES, STAINLESS AND CARBON STEEL

FIG. 9760 ROUND DECK PLUG

FUNCTION: Used as floor cleanout for drainage lines. Cover is water and gas tight and requires a spanner wrench for removal.



OUTLET VARIATIONS (Specify type of outlet and pipe size in inches.)

Outlet Type	Outlet Designation Outlet Type/Pipe Size	ADD
Butt Weld	BW02, BW03, BW04 Specify Schedule 5, 10, †40, or 80	POA
Threaded	T02, T03, T04	POA

OPTIONS:
-SW Steel Spanner Wrench ADD POA

A OUTLET SIZE	B DIA CAULK BUTT WELD	C CAULK BUTT WELD	†-CF8 (304) STAINLESS STEEL	-CF8M (316) STAINLESS STEEL	-A27 CARBON STEEL	APPROX. WT. LBS
02"	4 1/2"	4 1/2"	3"	3"	POA	5
03"	5 1/2"	4 1/2"	3"	3"	POA	5
04"	7 1/2"	5 1/2"	3 1/4"	3 1/4"	POA	10

REGULARLY FURNISHED: CF8 (Equivalent to Type 304) Rough Finish Stainless Steel Body and Cover with Gasket.

SPECIALTIES

FIG. 9770 FERRULE AND PLUG

FUNCTION: Used where extension type of cleanout is required. Not recommended for installation in floor areas subject to traffic unless access cover is provided.

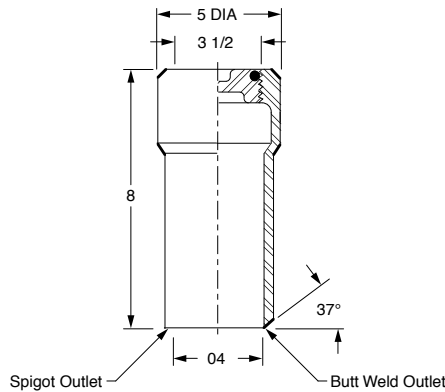

OUTLET VARIATIONS (Specify type of outlet and pipe size in inches.)

Outlet Type	Outlet Designation Outlet Type/Pipe Size	ADD
Butt Weld	BW04 Specify Schedule 5, 10, †40, or 80	POA

OPTIONS:
-SF Satin Finish Top ADD POA

A OUTLET SIZE	†-CF8 (304) STAINLESS STEEL	-CF8M (316) STAINLESS STEEL	-A27 CARBON STEEL	APPROX. WT. LBS
04"	POA	POA	POA	10

REGULARLY FURNISHED: CF8 (Equivalent to Type 304) Rough Finish Stainless Steel Body and Plug with Gasket.

