

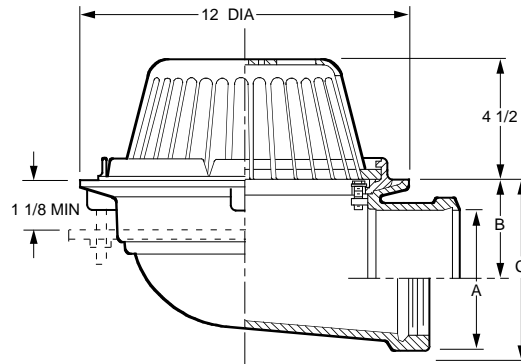

# ROOF DRAINS

## FIG. 1320 12" DIAMETER LOW PROFILE DOME

**FUNCTION:** Used in flat roofs of any construction where a medium sized drain is required. Flashing clamp holds flashing and roofing material without puncturing. Low profile dome protects sump and intercepts debris.



A OUTLET SIZE	FLANGE DIA.	B	FREE AREA SQ IN	†DUCO CI POLY DOME	DUCO CI CI DOME	APPROX. WEIGHT LBS
02"	12"	4 1/2"	71.5	492.00	492.00	30
03"	12"	4"	71.5	492.00	492.00	30
04"	12"	3 1/2"	71.5	492.00	492.00	30

**REGULARLY FURNISHED:** Duco Cast Iron Body with Combined Flashing Clamp and Gravel Stop with Polyethylene Dome.

### OUTLET VARIATIONS (Specify type of outlet and pipe size in inches.)

Outlet Type	Outlet Designation Outlet Type/Pipe Size	"C" Body HT. DIM.	ADD
Inside Caulk	C02, C03, C04	6 5/8"	N/C
Threaded	T02, T03, T04	6 5/8"	N/C
No-Hub	Y02, Y03, Y04	6 5/8"	N/C

### OPTIONS:

	ADD
-AD Aluminum Dome	109.00
-C Underdeck Clamp	90.00
-C2 Secondary Flashing Clamp	112.00
-CIDG Cast Iron Dome with Galvanizing	220.00
-CL Angular Underdeck Clamp	296.00
-E Ext. to 4" Per Inch, CI	52.00
-E04P 4" Perf SS Extension	383.00
-G Galvanized Cast Iron	238.00
-R Sump Receiver	156.00
-RBD Rough Bronze Dome	249.00
-SSM SS Mesh on Metal Dome	282.00
-U Vandal Proof Dome	69.00
-WD02 2" Solid Water Dam	117.00

ROOF DRAINS

## FIG. 1330 8 1/2" DIAMETER LOW PROFILE DOME

**FUNCTION:** Used in flat roofs, gutters or valleys of any construction. Small diameter pan is particularly adaptable to gutters and valleys where limited space is available. Flashing clamp holds flashing and roofing materials without puncturing. Low profile dome provides sufficient free area for quick drainage of rain water and protects the drain sump and connected piping from the intrusion of debris.

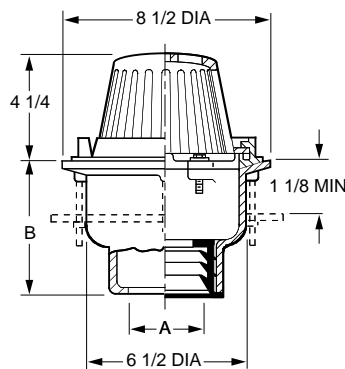

A OUTLET SIZE	FLANGE DIA.	FREE AREA SQ IN	†DUCO CI POLY DOME	DUCO CI CI DOME	APPROX. WEIGHT LBS
02, 03, 04"	8 1/2"	41.5	322.00	322.00	30

**REGULARLY FURNISHED:** Duco Cast Iron Body with Combined Flashing Clamp and Gravel Stop with Polyethylene Dome.

### OUTLET VARIATIONS (Specify type of outlet and pipe size in inches.)

Outlet Type	Outlet Designation Outlet Type/Pipe Size	"B" Body HT. DIM.	ADD
Inside Caulk	C02, C03, C04	5 1/2"	N/C
Speedi-Set SW	L02, L03, L04	5 1/2"	N/C
Speedi-Set XH	LXH02, LXH03, LXH04	5 1/2"	N/C
Threaded	T02, T03, T04	4 1/4"	47.00
No-Hub	Y02, Y03, Y04	5 1/2"	N/C

### OPTIONS:

	ADD
-AD Aluminum Dome	109.00
-C Underdeck Clamp	90.00
-C2 Secondary Flashing Clamp	112.00
-CIDG Cast Iron Dome with Galvanizing	87.00
-CL Angular Underdeck Clamp	296.00
-E Ext. to 4" Per Inch, CI	52.00
-E04P 4" Perf SS Extension	281.00
-G Galvanized Cast Iron	120.00
-R Sump Receiver	156.00
-RBD Rough Bronze Dome	206.00
-RDP Roof Deck Plate	206.00
-SSM SS Mesh on Metal Dome	213.00
-U Vandal Proof Dome	69.00
-WD02 2" Solid Water Dam	117.00

