



HYDRANTS

FIG. 5619 GUARDIAN DUAL CHECK-1/4 TURN HYDRANT W/INTEGRAL VACUUM BREAKER, DUAL CHECK VALVE AND EXPOSED HOSE CONNECTION



FUNCTION: For installation in interior or exterior building walls where an exposed hose connection is acceptable. Provides positive non-freeze protection. Adaptable to all types of wall construction.

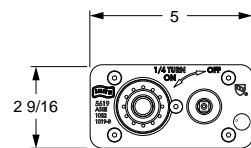
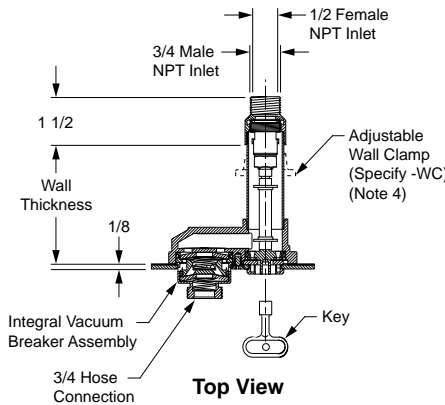

Front View

Fig. 5619

OPTIONS:

	ADD
-CP Chrome Plated Face	58.00
-E Elbow Inlet	29.00
-E1 1" NPT Elbow Inlet	162.00
-HC1 1" Hose Conn Adaptor	133.00
-IC1 1" Male NPT Inlet Connection*	133.00
-MF1 1" Straight Female Inlet	133.00
-PB Polished Bronze Face	38.00
-SE Sweat Elbow Inlet	29.00
-SE1 1" NPT Sweat Elbow Inlet	162.00
-SS Straight Sweat Inlet	N/C
-SS1 1" Straight Sweat Inlet	133.00
-WC Adjustable Wall Clamp	N/C
-WH Wheel Handle	182.00

For Hydrant Parts Repair Kit, See Pg. 340

NOTES:

1. Recommended wall opening 2 1/4 x 4".
2. When ordering, specify wall thickness in 1 increments as follows 4,5,6,7,8.....24.
3. All Jay R. Smith hydrants are manufactured with "NO-LEAD" brazing rings, and USDA approved lubricants.
4. When wall clamp -WC is desired, increase wall thickness dimension by 2".
5. Add 3/4" to Overall Length When Specified*
6. When specifying Fig. 5619 (-SAP) the wall thickness shall be 2".

WALL THICKNESS	3/4" INLET	APPROX WEIGHT LBS
-SAP	471.00	7
04 - 07"	622.00	8
08 - 15"	712.00	9
16 - 23"	800.00	10
24 - 30"	889.00	12

REGULARLY FURNISHED: Bronze Quarter Turn Non-Freeze Automatic Draining Hydrant with Stainless Steel Face, Hose Connection, Integral Vacuum Breaker and Dual Check Valve and "T" Handle Key.

Meets ANSI A112.21.3M Specifications
Complies w/ ASSE 1019-B,1052 and 1053.
IAPMO Listed- File #2749
Patent No. US 6,752,167

Seepage of a small amount of water may occur from the vacuum breaker upon the initial opening and closing of this hydrant. This is normal operation.

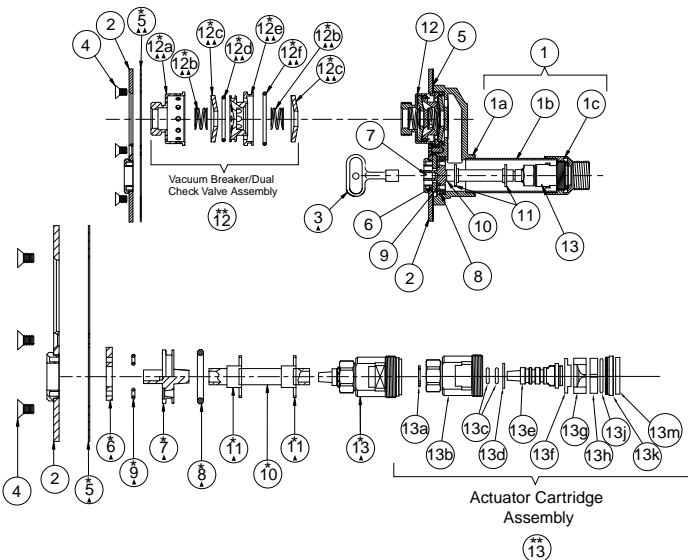

HYDRANT PARTS LIST			
NO.	DESCRIPTION	NO.	DESCRIPTION
1	Casing Assembly	10	Operator Rod
1a	Head	11	Operator Rod Guides (2)
1b	Casing	12	Vacuum Breaker/Dual Check Valve Assembly
1c	Valve Housing	13a	**Retaining Ring
2	Wall Plate Assembly	13b	**Valve Body
3	Key	13c	**Actuator O-Ring (2)
4	Wall Plate Securing Screw (5)	13d	**Nylon Thrust Spacer
5	Wall Plate Gasket	13e	**Valve Actuator
6	Stationary Operator Piece	13f	**Nylon Thrust Washer
7	Movable Operator Piece	13g	**Rotating Ceramic Disc
8	Movable Operator O-Ring	13h	**Fixed Ceramic Disc
9	Drain Hole Seal (2)	13j	**O-Ring
		13k	**O-Ring Gasket Retainer
		13m	**Rubber Seal

- ▲ These Replacement Parts Available in HPRK-19
- ▲ These Replacement Parts Available in HPRK-19VB
- * These Parts Accessible from Face of Hydrant by Removing Wall Plate Assembly.
- ** Parts supplied as an assembly only, see part 12 or 13.

