



# FLOOR DRAINS

## FIG. 2135 MEDIUM DUTY FLOOR DRAIN WITH 12" ROUND TOP



**FUNCTION:** Used in moderate traffic areas where waste water contains no sediment or debris and floor construction requires a shallow drain. Body flange and flashing collar serve as anchor in on-grade locations and as flashing clamp when installed in waterproof floors.

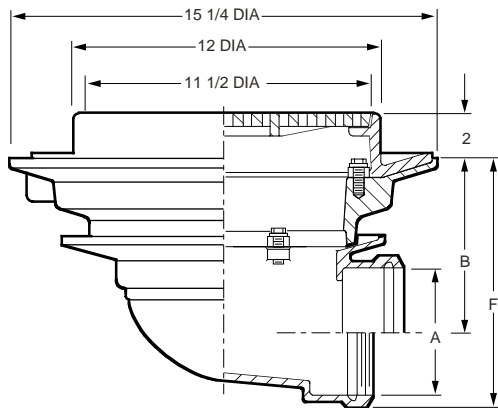

A OUTLET SIZE	TOP SIZE	FREE AREA SQ IN	B	†DUCO CI PB TOP	DUCO CI NB TOP	DUCO CI NB TOP	APPROX. WEIGHT LBS
02"	12"	28.5	6 7/8	1,036.00	1,431.00	1,493.00	51
03"	12"	28.5	6 3/8	1,036.00	1,431.00	1,493.00	51
04"	12"	28.5	5 7/8	1,036.00	1,431.00	1,493.00	51
05"	12"	28.5	5	1,036.00	1,431.00	1,493.00	51
06"	12"	28.5	4 1/2	1,036.00	1,431.00	1,493.00	51

**REGULARLY FURNISHED:** Duco Cast Iron Body and Flashing Collar with Cast Iron Bar Grate.

### OUTLET VARIATIONS (Specify type of outlet and pipe size in inches.)

Outlet Type	Outlet Designation	Outlet Type/Pipe Size	"F" Body HT. DIM.	ADD
Inside Caulk	C02		8 5/8"	N/C
	C03, C04		8 3/4"	N/C
	C05, C06		8 1/2"	N/C
Threaded	T02		8 5/8"	N/C
	T03, T04		8 3/4"	N/C
	T05, T06		8 1/2"	N/C
No-Hub	Y02		8 5/8"	N/C
	Y03, Y04		8 3/4"	N/C
	Y05, Y06		See Fig. 2646Y	

### OPTIONS:

Option	Description	ADD
-ARI	ARC Inside	392.00
-ARIO	ARC In and Out	518.00
-B	Sediment Bucket	156.00
-D	Dome Grate, CI	84.00
-DG	Deflector Grate	242.00
-DNB	Dome Grate, add to CI	753.00
-DPB	Dome Primer, add to CI	647.00
-G	Galvanized CI	444.00
-H	Hinged Grate	156.00
-M	Ductile Iron Grate	157.00
-P	Trap Primer Connection	99.00
-S	Square Top, CI	208.00
-SC	Solid Scoriated Cover	354.00
-SNB	Square Top, add to CI	753.00
-SPB	Square Top, add to CI	654.00
-U	Vandal Proof Grate	89.00

## FIG. 2140 HEAVY DUTY FLOOR DRAIN WITH 12" ROUND TOP W/TRACTOR GRATE

**FUNCTION:** Used in heavy traffic areas where waste water contains no sediment or debris and floor construction requires a shallow drain. Body flange and flashing collar serve as anchor in on-grade locations and as flashing clamp when installed in waterproof floors.

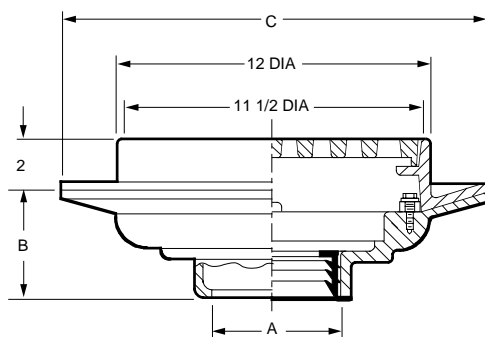

A OUTLET SIZE	TOP SIZE	FREE AREA SQ IN	C DIA.	†DUCO CI PB TOP	DUCO CI NB TOP	DUCO CI NB TOP	APPROX. WEIGHT LBS
02, 03, 04"	12"	29	*15 1/4	695.00	1,090.00	1,152.00	45
05, 06"	12"	29	15 1/4	695.00	1,090.00	1,152.00	47

\*Dimension is 16 for Caulk outlet

**REGULARLY FURNISHED:** Duco Cast Iron Body and Flashing Collar with Cast Iron Tractor Grate.

### OUTLET VARIATIONS (Specify type of outlet and pipe size in inches.)

Outlet Type	Outlet Designation	Outlet Type/Pipe Size	"B" Body HT. DIM.	ADD
Inside Caulk	C02, C03, C04, C05, C06		3 3/4"	N/C
	T02, T03, T04, T05, T06		3 3/4"	47.00
	No-Hub			N/C

### OPTIONS:

Option	Description	ADD
-ARI	ARC Inside	392.00
-ARIO	ARC In and Out	518.00
-B	Sediment Bucket	156.00
-DG	Deflector Grate	242.00
-FBSCI	Flat Bottom Strainer, CI	36.00
-G	Galvanized CI	444.00
-M	Ductile Iron Grate	157.00
-S	Square Top, CI	208.00
-SC	Solid Scoriated Cover	354.00
-SNB	Square Top, add to CI	753.00
-SPB	Square Top, add to CI	654.00
-U	Vandal Proof Grate	89.00

**Note:** Trap Primer (-P) cannot be used when Caulk Outlet is specified. Please specify Fig. 2141.

