



FLOOR DRAINS

FIG. 2341 HEAVY DUTY FLOOR DRAIN WITH 12" ROUND ADJUSTABLE TOP AND TRACTOR GRATE



FUNCTION: Used in heavy duty traffic areas where large top drain is required. Adjustable top collar permits accurate positioning of grate to meet finished floor level.

2341
Same as
2340
with shallow
body

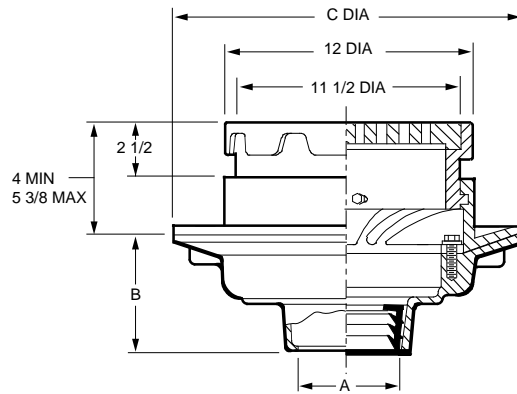

| A OUTLET SIZE | TOP SIZE | FREE AREA SQ IN | C DIA | †DUCO CI | DUCO CI PB TOP | DUCO CI NB TOP | APPROX. WEIGHT LBS |
|---------------------|-------------|-----------------------|----------|----------|-------------------|-------------------|--------------------------|
| 02, 03, 04" | 12" | 29 | 16" | 1,091.00 | 1,486.00 | 1,548.00 | 57 |
| 05, 06" | 12" | 29 | 16" | 1,091.00 | 1,486.00 | 1,548.00 | 59 |

REGULARLY FURNISHED: Duco Cast Iron Body and Flashing Collar with Adjustable Top and Tractor Grate.

OUTLET VARIATIONS (Specify type of outlet and pipe size in inches.)

| Outlet Type | Outlet Designation Outlet Type/Pipe Size | "B" Body HT. DIM. | ADD |
|--------------|---|-------------------------|----------------|
| Inside Caulk | C02, C03, C04, C05, C06 | 3 3/4" | N/C |
| Threaded | T02, T03, T04, T05, T06 | 3 3/4" | 47.00 |
| No-Hub | Y02, Y03, Y04, Y05, Y06 | | See Fig. 2646Y |

OPTIONS:

| Option | Description | ADD |
|--------|--------------------------|--------|
| -B | Sediment Bucket | 156.00 |
| -E | Ext., ea 2" or fract | 150.00 |
| -FBSCI | Flat Bottom Strainer, CI | 36.00 |
| -FP | Frost Proof Sed Bucket | 223.00 |
| -G | Galvanized CI | 492.00 |
| -M | Ductile Iron Grate | 157.00 |
| -P | Trap Primer Connection | 99.00 |
| -S | Square Top, CI | 208.00 |
| -SNB | Square Top, add to CI | 753.00 |
| -SPB | Square Top, add to CI | 654.00 |
| -U | Vandal Proof Grate | 89.00 |

FLOOR DRAINS

FIG. 2345 HEAVY DUTY FLOOR DRAIN WITH 12" ROUND ADJUSTABLE TOP AND TRACTOR GRATE

FUNCTION: Used in heavy duty traffic areas where large top drain is required. Adjustable top collar permits accurate positioning of grate to meet finished floor level.

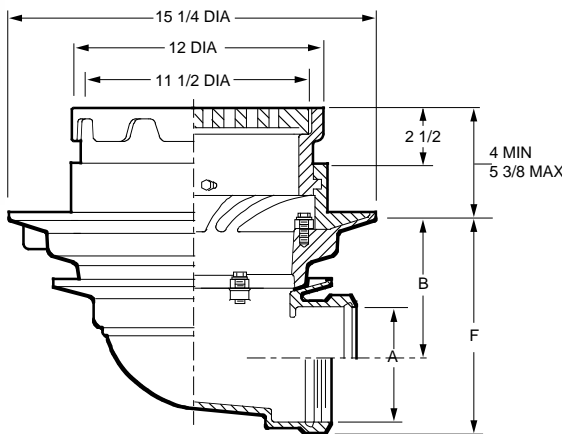

| A OUTLET SIZE | TOP SIZE | FREE AREA SQ IN | B | †DUCO CI | DUCO CI PB TOP | DUCO CI NB TOP | APPROX. WEIGHT LBS |
|---------------------|-------------|-----------------------|--------|----------|-------------------|-------------------|--------------------------|
| 02" | 12" | 29 | 6 7/8" | 1,354.00 | 1,749.00 | 1,811.00 | 74 |
| 03" | 12" | 29 | 6 3/8" | 1,354.00 | 1,749.00 | 1,811.00 | 74 |
| 04" | 12" | 29 | 5 7/8" | 1,354.00 | 1,749.00 | 1,811.00 | 74 |
| 05" | 12" | 29 | 5" | 1,354.00 | 1,749.00 | 1,811.00 | 76 |
| 06" | 12" | 29 | 4 1/2" | 1,354.00 | 1,749.00 | 1,811.00 | 76 |

REGULARLY FURNISHED: Duco Cast Iron Body and Flashing Collar with Adjustable Top and Tractor Grate.

OUTLET VARIATIONS (Specify type of outlet and pipe size in inches.)

| Outlet Type | Outlet Designation Outlet Type/Pipe Size | "F" Body HT. DIM. | ADD |
|--------------|---|-------------------------|----------------|
| Inside Caulk | C02 | 8 5/8" | N/C |
| | C03, C04 | 8 3/4" | N/C |
| | C05, C06 | 8 1/2" | N/C |
| Threaded | T02 | 8 5/8" | N/C |
| | T03, T04 | 8 3/4" | N/C |
| | T05, T06 | 8 1/2" | N/C |
| No-Hub | Y02 | 8 5/8" | N/C |
| | Y03, Y04 | 8 3/4" | N/C |
| | Y05, Y06 | | See Fig. 2646Y |

OPTIONS:

| Option | Description | ADD |
|--------|-----------------------|--------|
| -B | Sediment Bucket | 156.00 |
| -E | Ext., ea 2" or fract | 150.00 |
| -G | Galvanized CI | 492.00 |
| -M | Ductile Iron Grate | 157.00 |
| -P | Trap Primer Conn | 99.00 |
| -S | Square Top, CI | 208.00 |
| -SNB | Square Top, add to CI | 753.00 |
| -SPB | Square Top, add to CI | 654.00 |
| -U | Vandal Proof Grate | 89.00 |

