



FLOOR DRAINS

FIG. 2141 HEAVY DUTY FLOOR DRAIN WITH 12" ROUND TOP W/TRACTOR GRATE



FUNCTION: Used in heavy traffic areas where waste water contains no sediment or debris and floor construction requires a shallow drain. Body flange and flashing collar serve as anchor in on-grade locations and as flashing clamp when installed in waterproof floors.

2141
Same as
2140
with deep
body

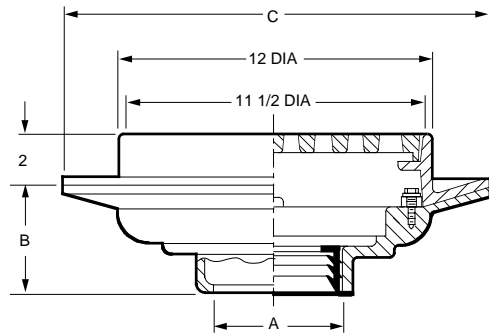

A OUTLET SIZE	TOP SIZE	FREE AREA SQ IN	C DIA.	†DUCO CI	DUCO CI PB TOP	DUCO CI NB TOP	APPROX. WEIGHT LBS
02, 03, 04"	12"	28.5	15 1/4	833.00	1,228.00	1,290.00	90
05, 06"	12"	28.5	15 1/4	833.00	1,228.00	1,290.00	93

REGULARLY FURNISHED: Duco Cast Iron Body and Flashing Collar with Cast Iron Tractor Grate.

OUTLET VARIATIONS (Specify type of outlet and pipe size in inches.)

Outlet Type	Outlet Designation	Outlet Type/Pipe Size	"B" Body HT. DIM.	ADD
Inside Caulk	C02, C03, C04, C05, C06		5"	N/C
Speedi-Set SW	L02, L03, L04		5"	N/C
Speedi-Set XH	LXH02, LXH03, LXH04		5"	N/C
Threaded	T02, T03, T04		3 3/4"	47.00
No-Hub	Y02, Y03, Y04, Y05, Y06		5"	N/C

OPTIONS:

OPTION	DESCRIPTION	ADD
-ARI	ARC Inside	392.00
-ARIO	ARC In and Out	518.00
-B	Sediment Bucket	156.00
-DG	Deflector Grate	242.00
-DID	Drain Installation Device	125.00
-FBSCI	Flat Bottom Strainer, CI	36.00
-FP	Bucket w/Seepage Holes	223.00
-G	Galvanized CI	444.00
-M	Ductile Iron Grate	157.00
-P	Trap Primer Conn	99.00
-S	Square Top, CI	208.00
-SC	Solid Scoriated Cover	354.00
-SNB	Square Top, add to CI	753.00
-SPB	Square Top, add to CI	654.00
-U	Vandal Proof Grate	89.00

FLOOR DRAINS

FIG. 2142 HEAVY DUTY FLOOR DRAIN WITH 12" TOP W/ROUND TRACTOR GRATE AND SOLID FREE STANDING SEDIMENT BUCKET

FUNCTION: Used in heavy trucking or traffic areas where waste water contains sand, sediment and other debris. Drain has solid free standing bucket to intercept this type of debris.

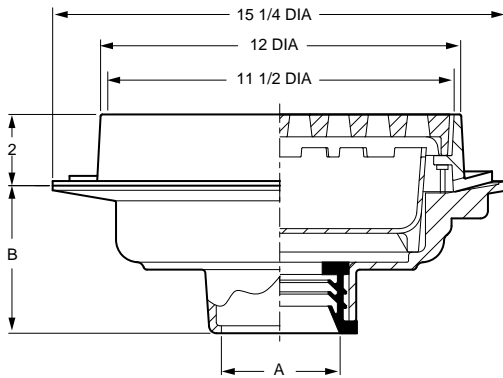

A OUTLET SIZE	TOP SIZE	FREE AREA SQ IN	†DUCO CI	DUCO CI PB TOP	DUCO CI NB TOP	APPROX. WEIGHT LBS
02, 03, 04"	12"	29	1,044.00	1,439.00	1,501.00	60
05, 06"	12"	29	1,044.00	1,439.00	1,501.00	62

REGULARLY FURNISHED: Duco Cast Iron Body and Flashing Collar with Cast Iron Tractor Grate and Solid Free Standing Sediment Bucket.

OUTLET VARIATIONS (Specify type of outlet and pipe size in inches.)

Outlet Type	Outlet Designation	Outlet Type/Pipe Size	"B" Body HT. DIM.	ADD
Inside Caulk	C02, C03, C04, C05, C06		5"	N/C
Speedi-Set SW	L02, L03, L04		5"	N/C
Speedi-Set XH	LXH02, LXH03, LXH04		5"	N/C
Threaded	T02, T03, T04		3 3/4"	47.00
No-Hub	Y02, Y03, Y04, Y05, Y06		5"	N/C

OPTIONS:

OPTION	DESCRIPTION	ADD
-ARI	ARC Inside	517.00
-ARIO	ARC In and Out	680.00
-DG	Deflector Grate	242.00
-DID	Drain Installation Device	125.00
-FBSCI	Flat Bottom Strainer, CI	36.00
-FP	Seepage Holes in Bucket	70.00
-G	Galvanized CI	589.00
-M	Ductile Iron Grate	157.00
-P	Trap Primer Conn	99.00
-S	Square Top, CI	208.00
-SC	Solid Scoriated Cover	354.00
-SNB	Square Top, add to CI	753.00
-SPB	Square Top, add to CI	654.00
-U	Vandal Proof Grate	89.00

