



Vertical Equipment Wall Mounts



EIA/TIA Compliant



Spec. #
96-700
for full
product
info.



WRP-6
shown in service position



WRS-6
shown with top cover open



WRP-6
shown with top cover open



EIA/TIA Compliant

VPM-4



Specify a WRP or WRS for vertically mounting equipment on a wall surface in a protective enclosure.

Structural Features

- Unique design with 23" useable racking depth allows mounting of deeper equipment vertically in a parallel-to-the-wall orientation for space efficiency and aesthetics
- Standard adjustable heavy-gauge, 10-32 threaded rackrail
- Solid hinged body swings either left or right
- Angled, hinged plexiglass (WRP Series) or solid steel (WRS Series) top cover allows convenient equipment access
- Top cover keyed separately from body keylock, providing user access to equipment controls while limiting access to rear equipment connections
- Finished in a durable putty powder coat (WRP Series) or black textured powder coat (WRS Series)

Thermal Management

- Vented front and two bottom located fan mounting positions facilitate thermal management
- Accepts two optional 4-1/2" fans

Cable Management

- Rackrail adjusts to provide a space from 1" to 4" between top cover and equipment faces, allowing abundant room for D-Ring cable managers

Regulatory / Certifications

- Grounding/bonding stud facilitates the proper grounding and bonding of electronic equipment, as per NEBS and NEC standards
- UL Listed in the US and Canada
- GREENGUARD Indoor Air Quality Certified for Children and Schools (the most strict level)

Putty Part #*	Black Part #*	Racking Height	Useable Depth	Weight Capacity
WRP-4	WRS-4	7" (4 space)	23"	150 lbs.
WRP-6	WRS-6	10-1/2" (6 space)	23"	150 lbs.
WRP-8	WRS-8	14" (8 space)	23"	150 lbs.

*Putty version has plexi cover, black version has solid cover.

Vertical Equipment Mount

Versatile solution for wall mount racking where a protective enclosure is not required.

- Can accommodate all depths of equipment
- Mounts horizontally or vertically allowing versatile component placement – under desktops, for example
- Heavy duty threaded rack rail, available in 2, 3 or 4 rackspace models
- Use two to provide 4-point mounting
- Includes hole for safety screw (for under desk mounting)

Part #	Description
VPM-2	2 space, vertical equipment mount
VPM-3	3 space, vertical equipment mount
VPM-4	4 space, vertical equipment mount



Vertical Equipment Wall Mounts

Ideal for mounting patch panels with switches, hubs, routers and other equipment.

Structural Features

- Beveled front door with flanges on all sides provides greater security for equipment
- Reversible hinged door with lock and padlockable latch
- Integral electrical box simplifies power distribution
- Constructed of 16-gauge steel,
- 24" wide by 36" high x 7-1/2" deep
- Finished in a durable putty powder coat
- Standard heavy-gauge, 10-32 threaded rackrail
- 4 total rackspaces for equipment mounting in two sections

Thermal Management

- Ventilation slots on front cover address thermal management needs
- 4-1/2" fan kit available, mounts externally to maximize equipment mounting and cable management space

Cable Management

- Cable management features include a 7" x 4" cable pass-through on backpan, abundant cable tie points and integral lacing bar on top set of rackrail
- 24" length of hook and loop fasteners included to facilitate cable management
- Laser knockouts on the top, bottom and sides for cable entry

Regulatory / Certifications

- 150 lb. weight capacity
- Grounding/bonding stud facilitates the proper grounding and bonding of electronic equipment, as per NEBS and NEC standards
- UL Listed in the US and Canada
- GREENGUARD Indoor Air Quality Certified for Children and Schools (the most strict level)

Part #	Racking Height	Part #	Description
HDR-4	3-1/2" + 3-1/2" (2 rackspace + 2 rackspace)	HDR-FAN	external 4-1/2" fan kit & vent blocker

Spec. # **96-975**
for full product info.

UL LISTED

EIA/TIA Compliant

GREENGUARD



HDR-FAN
optional external mount fan

Easy Access to Equipment Connections

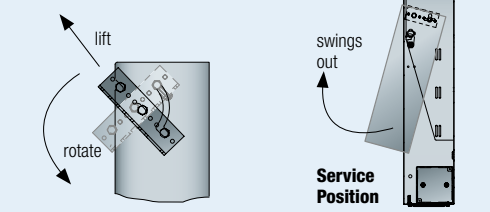

Upper bay rotates for easy access to patch panel connections & positive stop for punch downs

Lower bay rotates out for easy access to equipment connections

Ideal for small sound systems, paging & patching applications in schools, hotels, offices or anywhere a secure, low-profile wall mount solution is required.

Structural Features

- Two models available: surface mount or flush between studs
- Tamper resistant design ideal for use in non-secure areas
- Mount non-rackmount equipment using included clamp bars
- 10-32 threaded rackrail is adjustable with a 1-1/2" to 3-3/8" recess to accommodate handles and knobs
- Up to 20" useable depth
- Durable, neutral putty finish
- Vented for effective passive thermal management
- Knockout provided in face to mount RPS Series remote power switch and low-voltage Decora® devices

Cable Management

- Includes knockout to accommodate Middle Atlantic Products UCP Series universal connector panels, mounts BNC, XLR and other popular connectors
- Cable management tie points, with knockouts provided in back box for cable pass-through

Regulatory / Certifications

- 100 lb. weight capacity
- Grounding/bonding stud facilitates the proper grounding and bonding of electronic equipment, as per NEBS and NEC standards
- UL Listed in the US and Canada
- GREENGUARD Indoor Air Quality Certified for Children and Schools (the most strict level)

Spec. # **96-01009**
for full product info.

UL LISTED

EIA/TIA Compliant

GREENGUARD

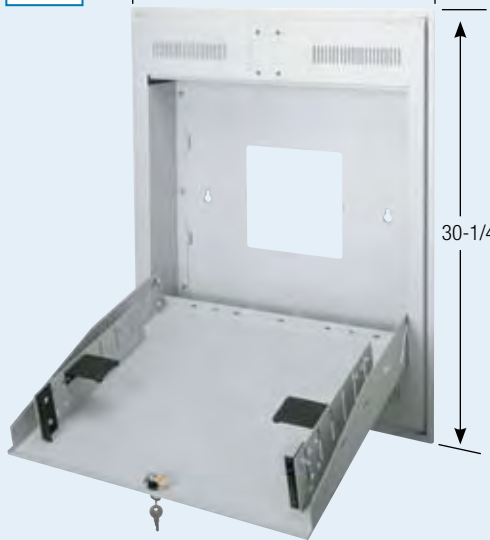

keylocks closed for security



front panel equipment access



includes electrical box for 120V connections

Surface Mount Part #	Flush Mount Part #	Racking Height	Outside Depth	When mounting TOR-3-20RP or TOR-4-20RP between 2x4 studs, order the partial recess trim kit to finish the installation.	Part #
TOR-2-20SP	TOR-2-20RP	3-1/2" (2 space)	4-7/16"		TOR-PRT
TOR-3-20SP	TOR-3-20RP	5-1/4" (3 space)	6-3/16"		
TOR-4-20SP	TOR-4-20RP	7" (4 space)	7-15/16"		

