

Tel-Tru Sanitary Pressure Gauge MODEL 83

PHARMA LINE

Model 83 sanitary pressure gauges are accurate to $\pm .75\%$ full scale and have a built-in, highly polished, totally flush 316L stainless steel diaphragm. They are designed with a unique pulsation dampening system, waterproof construction, and polycarbonate lenses, making them ideal for the most rigid sanitary requirements of the pharmaceutical industry.

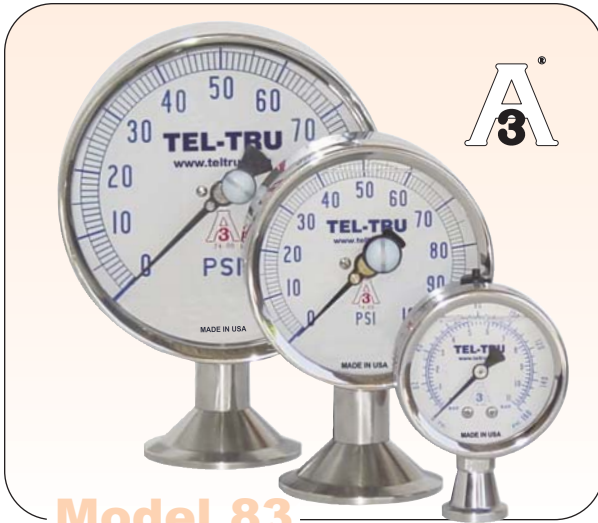

Model 83

► AVAILABLE OPTIONS:

- Dry case
- Connection locations - right, left, top mount
- 2, 2½, or 3" fittings
- High temperature option ($>250^{\circ}\text{F} \leq 500^{\circ}\text{F}$) Viton® Seal
- Other fitting types (including **Cherry Burrell, APC**) and sizes are available on request.

► REPAIR SERVICE:

- Disassemble, clean, and inspect all components
- Replace/repair damaged or worn components
- Reassemble and calibrate to original factory specifications

► AVAILABLE CASE STYLES AND DIMENSIONS:

DIAL	Tri-Clamp Fitting	A	B	C	D	E	F	G
2583 2½"	1½"	2.5" (63.5mm)	3.81" (96.8mm)	1.99" (50.5mm)	1.31" (33.3mm)	.44" (11.2mm)	2.63" (66.8mm)	.56" (14.3mm)
	2"	2.5" (63.5mm)	3.81" (96.8mm)	2.5" (63.5mm)	1.31" (33.3mm)	.44" (11.2mm)	2.63" (66.8mm)	.56" (14.3mm)
3583 3½"	1½"	3.68" (93mm)	5.5" (140mm)	1.99" (50.5mm)	1.88" (48mm)	.63" (16mm)	3.75" (95mm)	.88" (22mm)
	2"	3.68" (93mm)	5.5" (140mm)	2.5" (63.5mm)	1.88" (48mm)	.63" (16mm)	3.75" (95mm)	.88" (22mm)
5083 5"	1½"	5.06" (129mm)	6.88" (175mm)	1.99" (50.5mm)	2.3" (59mm)	.63" (16mm)	4.2" (106mm)	.88" (22mm)
	2"	5.06" (129mm)	6.88" (175mm)	2.5" (63.5mm)	2.3" (59mm)	.63" (16mm)	4.2" (106mm)	.88" (22mm)

► SPECIFICATIONS:

Dial size/Accuracy:	2½" (63mm), $\pm .75\%$ FS 3½" (90mm), $\pm .75\%$ FS 5" (120mm), $\pm .75\%$ FS
Case:	304 SS, Food Grade Glycerine fill
Bezel:	304 SS
Wetted Material:	316L SS diaphragm Ra < 8 microinches
Internal Material:	Brass/bronze system/movement Mechanical dampening
Transmission Fluid:	Glycerine system fill
Connection:	1½" Tri-clamp® Lower mount, center-back mount
Lens:	Polycarbonate
Pointer:	Aluminum with re-zero adjustment
Dial:	White aluminum
Ranges:	See chart: 30 Hg to 1000 psi
Scale:	PSI or dual PSI/Bar
Over Range Protection:	P max + 30%
3A:	Certified
Traceable ID:	Marked with order and date code
Environmental Protection:	Waterproof, can be CIP

► TEMPERATURE LIMITS:

0°F (-18°C) to 250°F (121°C)
500°F (260°C) is maximum process temperature with high temperature option

► MODEL CODES:

2583	Pharma, 2½" dial
3583	Pharma, 3½" dial
5083	Pharma, 5" dial

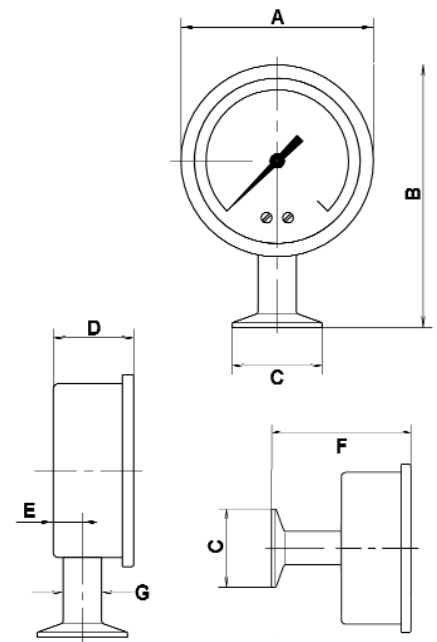

Tel-Tru Manufacturing Company

408 St. Paul St., Rochester, New York 14605 USA

Phone: 585.232.1440 • 800.232.5335 • Fax: 585.232.3857 • E-mail: info@teltru.com • Web: www.teltru.com

Tel-Tru Sanitary Pressure Gauge MODEL 83

PHARMA LINE

How to Order

Ordering Example: Pharma, 2½" dial, 316L SS wetted parts, 304 SS Case, 1½" Tri-Clamp connection size, Lower location, Glycerine system fill, 0-160 psi & 0-11 bar range, Dry case.

A B C D E F G H I
2 5 8 3 1 S 8 L A E 4 F * T

Code	Description	Available		
A	Model			
	2583	Pharma, 2½" dial	2583	3583
	3583	Pharma, 3½" dial	3583	5083
	5083	Pharma, 5" dial	5083	
B	Materials - Wetted Parts			
	1	316L SS	S	S
C	Case			
	S	304 SS	S	S
D	Connection Size			
	8	1½"	X	X
	9	2"	X	X
	E	2½"	X	X
	F	3"	X	X
E	Connection Location			
	C	Center-back	X	X
	L	Lower	X	X
	V	Right side	X	X
	W	Left side	X	X
	T	Top	X	X
F	Connection Type			
	A	Tri-Clamp	S	S
	J	G&H "H" Line Male	X	X
	K	Cherry-Burrell Male I-Line	X	X
	N	DIN40 (accord. to DIN11851)	X	X
	P	DIN50 (accord. to DIN11851)	X	X
	Q	SMS38	X	X
	R	SMS51	X	X
	G	Range and Scale		
xxx	See Range Chart	See Range Chart		
H	Options* <i>Insert codes only if required</i>			
	L	Glass Lens	X	X
	D	Drag Pointer		X
	0	Extra Dampening	X	X
	I	High Temperature Option <i>Process temp. >250° F</i>	X	X
I	Case Fill			
	G	Glycerine Filled	X	X
	T	Dry case	X	X

Key:

X = Available

S = Standard

Ranges

	CODE
0-30 psi	C6A
0-60 psi	D6A
0-100 psi	D9A
0-160 psi	E4A
0-200 psi	E5A
0-300 psi	E8A
0-400 psi	F2A
0-600 psi	F4A
0-1000 psi	F8A
30-0-30 psi	Z2A
30-0-60 psi	Z3A
30-0-100 psi	Z4A
30-0-150 psi	U6A
30-0-200 psi	Z6A
30-0-300 psi	Z7A
0-30 psi & 0-2 bar	C6F
0-60 psi & 0-4 bar	D6F
0-100 psi & 0-7 bar	D9F
0-160 psi & 0-11 bar	E4F
0-200 psi & 0-14 bar	E5F
0-300 psi & 0-20 bar	E8F
0-400 psi & 0-28 bar	F2F
0-600 psi & 0-40 bar	F4F
0-1000 psi & 0-70 bar	F8F
30-0-30 psi & 1-0-2 bar	Z2Z
30-0-60 psi & 1-0-4 bar	Z3Z
30-0-100 psi & 1-0-7 bar	Z4Z
30-0-150 psi & 1-0-10 bar	U6Z
30-0-200 psi & 1-0-15 bar	Z6Z
30-0-300 psi & 1-0-20 bar	Z7Z

Other ranges are available, including PSI/Kg/cm² and PSI/KPa.

Repair Service (order separately)

Code	Description
RSPG83-25	2½" Pharma Line pressure gauges
RSPG83-35	3½" Pharma Line pressure gauges
RSPG83-50	5" Pharma Line pressure gauges

Certificates (order separately)

Code	Description
10000016	Material Certificate
10000002	Calibration Certificate

* See Ordering Example, top of page.

Fractional Gauge alternative: We recommend purchase of a ¾ x ¾ x 1½" tee. Connect this into the ¾" line and use a 2½" dial pressure gauge with a 1½" Tri-Clamp fitting.

Other fitting types and sizes are available on request. Other case fill materials and transmission fluids are available on request.

Shipping weight approximately 3lbs. (1.3kg)

Tri-Clamp® is a registered trademark of Tri-Clover, Inc.

Viton® is a registered trademark of DuPont Performance Elastomers.

Product specifications and pricing are subject to change without notice.



Tel-Tru Manufacturing Company

408 St. Paul St., Rochester, New York 14605 USA
 Phone: 585.232.1440 • 800.232.5335 • Fax: 585.232.3857
 E-mail: info@teltru.com • Web: www.teltru.com

SPG8308