

Hemispheric IP Video Door Station



Better Overview. Increased Security.

With the IP Video Door Station, MOBOTIX is introducing a new product line in the area of door communication and access control that supports the VoIP/SIP video telephone standard. The T24 records all events outside the house door with sound; automatically when the doorbell is pushed, with movement in the image or upon triggering a contact.

Complete video solution with powerful performance ...

- Complete Panorama view from wall to wall and from floor to ceiling thanks to Hemispheric technology
- Recording with sound of all activities in front of the door, automatically around the clock
- Two-way video worldwide via IP telephony, computer or MOBOTIX App
- Integrated messaging features for leaving and retrieving messages directly at the door
- Keyless entry using PIN code, transponder or in the near future also the MOBOTIX App
- Simple installation, optional use of two existing bell wires instead of network cable

... starting at \$1,778* incl. video management software

*MSRP (Manufacturer's suggested retail prices) • Prices ex-works Charleston, South Carolina (SC), USA (EXW) • Excluding VAT and any other handling charges • Calculated at FXR 1EUR = 1,4857USD, 28.10.2009
Information subject to change without notice! • © MOBOTIX AG

Complete Panorama View For Superior Overview

The high-resolution Hemispheric door camera with 3.1 megapixel image sensor and internal MicroSD storage allows monitoring of the entire entrance area. Complete Panorama view from wall to wall and floor to ceiling.





Technical Specifications T24



The HiRes Video Company

Technical Specifications T24 Hemispheric Camera	
Models	Sec, Sec-Night
Lenses	L11 (hemispherical) (90° x 67°)
Sensitivity	Color: 1 lux (t=1/60 s), 0.05 lux (t=1/1 s) B/W: 0.1 lux (t=1/60 s), 0.005 lux (t=1/1 s)
Sensor	1/2" CMOS, progressive scan
Max. image resolution	Color: 2048 x 1536 (3MEGA), Black/White: 1280 x 960 (MEGA)
Image format	Free image format selection (from 160x120 to 2048x1536); with L11: PTZ view, Quad view, panorama broad view image, double panorama view, panorama focus with 3 views
Max frame rate (M-JPEG) (Live/Recording)	VGA: 25 fps, TV-PAL: 18 fps, MEGA: 8 fps, 3MEGA: 4 fps
Video stream (MxPEG) (Live/Recording/Audio)	VGA: 30 fps, TV-PAL: 30 fps, MEGA: 30 fps, 3MEGA: 20 fps
Image compression	MxPEG, M-JPEG, JPEG, H.264 (only Video-VoIP)
Internal DVR	MicroSD slot (camera-internal video recording up to 64 GB)
External storage	Directly on NAS and PC/Server without additional recording software
Software (inclusive)	Video management software MxEasy, Control room software MxControlCenter
Image processing	Backlight compensation, automatic white balance, image distortion correction (panorama image correction included), video sensor (motion detection)
Virtual PTZ	Digital Pan/Tilt/Zoom, continuous 8x zoom
Alarm/Events	Triggering of events by integrated multiple-window motion detection, temperature sensor, notification over email, FTP, IP telephony (VoIP, SIP), visual/acoustic alarm, pre- and post-alarm images
Audio	Integrated microphone and speaker, lip-synchronous audio, two-way speaker, audio recording
Interfaces	Ethernet 10/100, USB, MxBus
Video phone	VoIP, SIP, two-way speaker, remote control via DTMF signaling, event notification
Security	User-/Group management, HTTPS/SSL, IP address filter, IEEE 802.1x, intrusion detection, digital image signature
Certificates	EMC (EN50121-4, EN55022, EN55024, EN61000-6-2, FCC part15B, AS/NZS3548)
Power supply	Power over Ethernet (IEEE 802.3af): PoE class variable depending on operating mode; power consumption; typ. 3 W; with PoE switch/MOBOTIX PoE-Adapter
Operating conditions	IP65 (DIN EN 60529), -30 to +60 °C (-22 to +140 °F)
Dimensions	W x H: 13.1 x 13.1 cm (single camera modul), Weight: ca. 450 g
Standard delivery	Housing (high-resistance composites – PBT-PC), white, incl. 360° lens, mounting parts, allen wrench, patch cable - 50 cm, manual, software, 4 GB MicroSD (except Basic)

Technical information subject to change without notice!

T24 Modules			Available Colors
<p>T24-CamCore</p>  <ul style="list-style-type: none"> Allround view with high-resolution color images and vPTZ function Long-term recording, integrated speaker, microphone, doorbell and light buttons 	<p>T24-KeypadRFID</p>  <ul style="list-style-type: none"> Keyless Entry per PIN code or transponder Integrated messaging feature 	<p>T24-Info</p>  <ul style="list-style-type: none"> Optional with T24-Info2wire+ unit To connect the T24 via 2 bell wires (data and power) 	<p>Colors</p>  <ul style="list-style-type: none"> Available in white, metallic silver, dark gray, amber and black Modern, discreet design

Accessories			
<p>Frames (Without Modules)</p>  <ul style="list-style-type: none"> Available as On-Wall or In-Ceiling model Weatherproof (IP65) For 1 to 3 modules Including anti-theft protection 	<p>T24-DoorMaster</p>  <ul style="list-style-type: none"> Integrated doorbell Backup power supply with battery (up to 60 hours) 2 buttons, 2 LEDs 2 signal inputs, 1 signal output 	<p>MOBOTIX App</p>  <ul style="list-style-type: none"> For iPhone/iPad/iPod touch Worldwide connection with T24 via WLAN (Wi-Fi) or UMTS 	<p>Grandstream VoIP Videophone</p>  <ul style="list-style-type: none"> Video remote station for T24 Comfortable camera operation, event research, door and light control

Simple And Cost-Effective Installation

The MOBOTIX IP Video Door Station can be connected and supplied with power via a network cable or – thanks to the Mx2wire+ technology – via two bell wires. Siedle Vario installation systems can also be upgraded with the T24M camera.

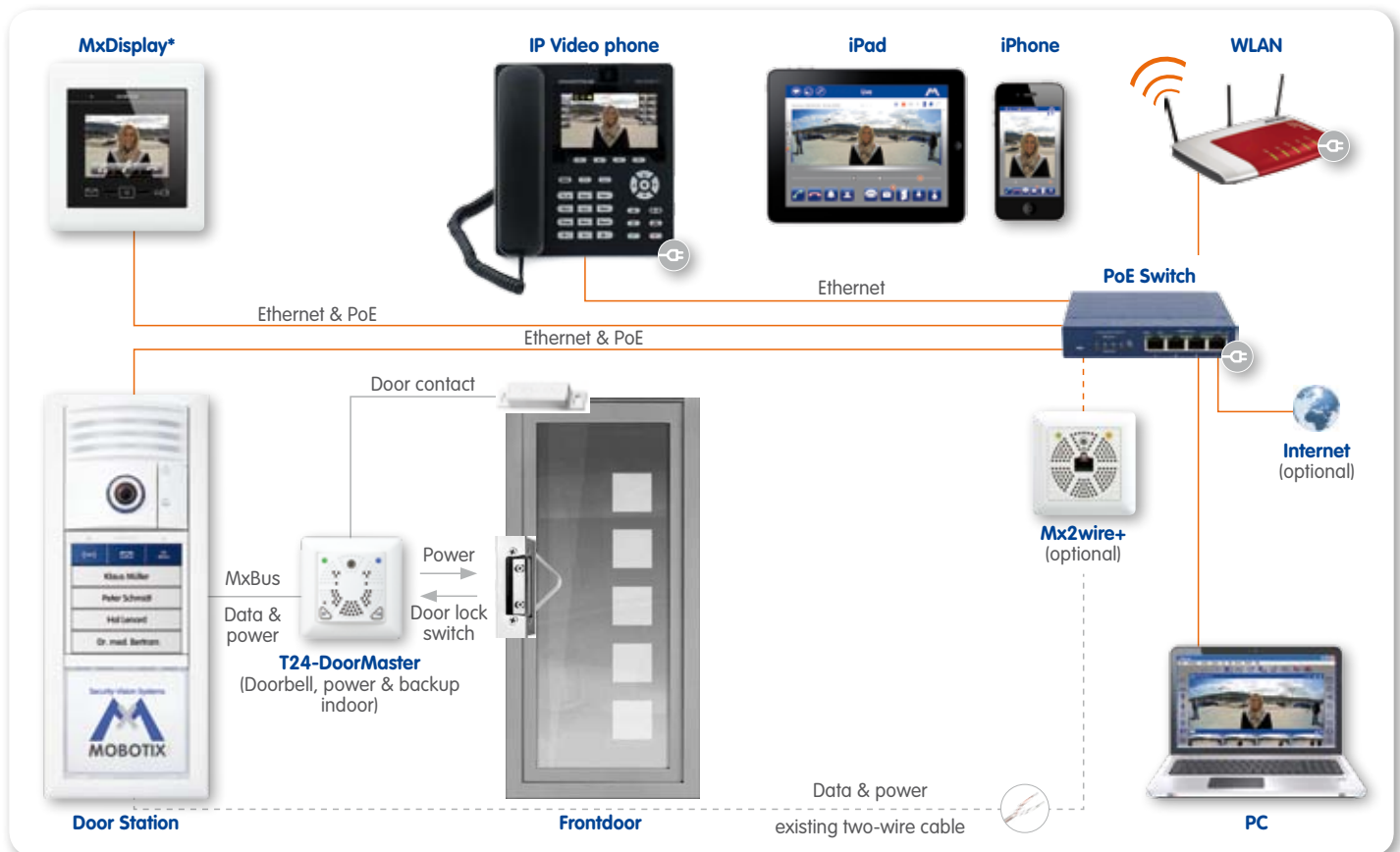

* planned for Q4 2012

T24: Quick And Cost-Efficient Mounting

What does a typical system look like and what kind of cabling is needed? The system image shows the schematic structure of a hemispheric IP Video Door Station including the Security Door Opener from MOBOTIX for inside installation next to the door (T24 DoorMaster).

The outdoor station network connection and power supply are supplied via an Ethernet cable (PoE technology) or alternatively using the **T24-Info2wire+** expansion set via a two-wire bell wire. This way, the existing doorbell or **simple door intercom system can be replaced by a versatile access control system with a high-resolution MOBOTIX door station with little extra effort or cost.**

Simple Network Connection

The T24 outdoor station requires just one cable for data and power to be connected to a PoE switch and thereby to any expandable Ethernet network.

* planned for Q4 2012



MxDisplay With Touch Screen

The display* is a versatile expansion module to the hemispheric IP Video Door Station and fits into the system frames and the housing of the Door Station. Equipped with touch screen, the device functions as video intercom, installed in a house, for MOBOTIX Door Stations, and security cameras - including switching functions for door opener and light as well as to retrieve mailbox and event recordings. The device does not require a power connection because it is powered over PoE standard via the network cable.

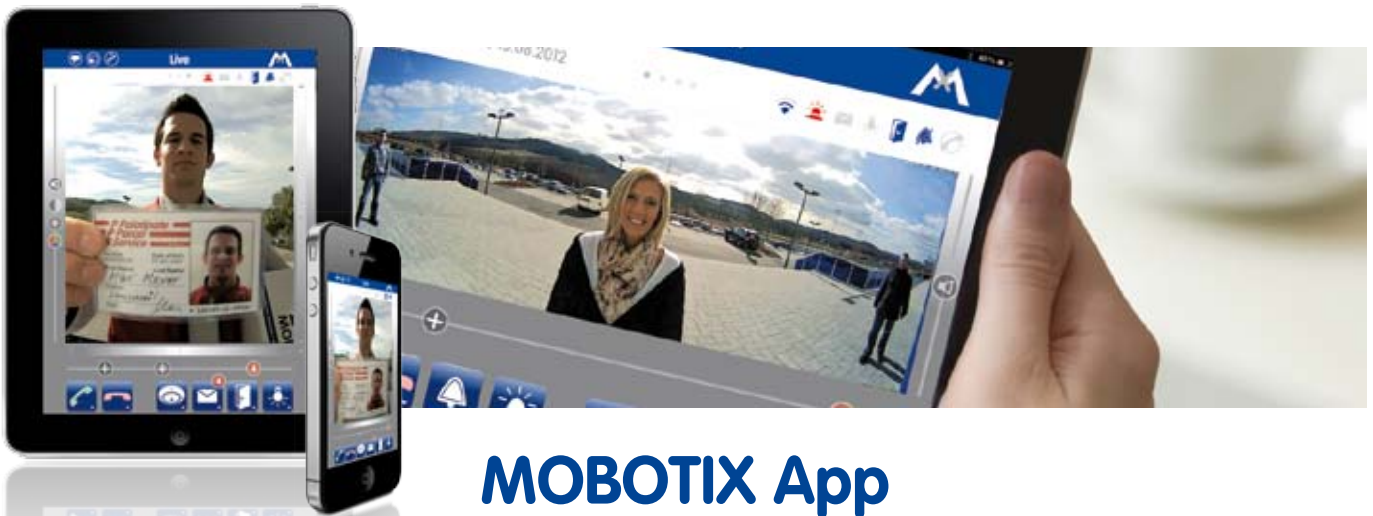

MOBOTIX App

T24 owners will be able to use their iPhone or iPad as a remote station in the future. The MOBOTIX App provides notifications when someone rings the doorbell, enables two-way communication with visitors and can remotely open the door. It is also possible to retrieve voice mailbox messages, live images and recordings from all integrated Door Stations and cameras.

New Expansions To The Door Station

MOBOTIX will soon offer a doorbell module T24-BellRFID with up to five bell buttons and integrated RFID technology. In addition, a special T24 installation set will be offered to integrate single modules of the Door Station in stainless steel surfaces.