

## Valves



### Series 14-B Ball Type Blow Down Valve

- For McDonnell & Miller Series 47, 67 and 70B boiler control blow down valve replacement
- Full-ported ball action valve
- PTFE seats provide bind free, leak tight ball movement
- Easy open handle keeps hands away from hot water and steam
- Gasket and mounting screws included
- Maximum pressure 30 psi (1.8 kg/cm<sup>2</sup>)
- See page 127 for blow-down information



Series 14-B

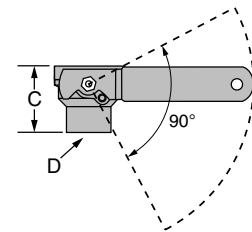
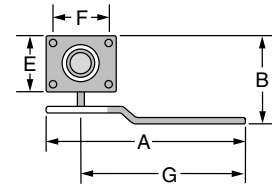

#### Dimensions, in. (mm)

A	B	C	D NPT	E	F	G
6 <sup>3</sup> / <sub>4</sub> (171.4)	4 (102)	2 <sup>1</sup> / <sub>4</sub> (57)	<sup>3</sup> / <sub>4</sub>	2 <sup>1</sup> / <sub>2</sub> (64)	2 <sup>1</sup> / <sub>2</sub> (64)	5 <sup>3</sup> / <sub>4</sub> (146)

#### Ordering Information

Model Number	Part Number	Description	Weight lbs. (kg)
14-B	310447	Blow down valve	1 (.5)

### Series TC-4 Test-N-Check® Valves



- For hot water boilers
- Simplifies ASME CSD-1A. code mandated testing of low water cut-offs by eliminating the need to drain the system
- Includes one upper and one lower valve for mounting at crosses in equalizing lines
- Restricts water flow when the low water cut-off's blow down valve is open
- Adjustable built-in vacuum breaker in upper valve provides rapid evacuation of water from the float chamber
- 1" NPT
- Maximum temperature 250°F (121°C)
- Maximum pressure 160 psi (11 kg/cm<sup>2</sup>)



Series TC-4  
Upper Valve

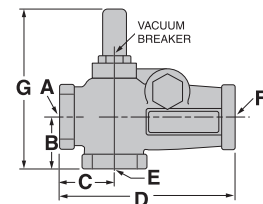

Series TC-4  
Lower Valve

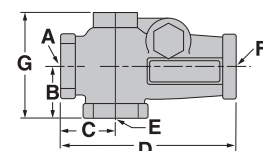

#### Dimensions, in. (mm)

A NPT	B	C	D
1	1 <sup>1</sup> / <sub>2</sub> (38)	1 <sup>1</sup> / <sub>2</sub> (38)	5 (125)

E NPT	F NPT	G	
		Upper	Lower
1	1	5 <sup>1</sup> / <sub>4</sub> (133)	3 <sup>1</sup> / <sub>16</sub> (78)

#### Ordering Information

Model Number	Part Number	Description	Weight lbs. (kg)
TC-4	195000	Test-N-Check Valves, set of 2	5.3 (.4)