



# FITTINGS W/ DRESSER® EFV'S

## PA COMPRESSION FITTINGS Full Couplings Dresser® Excess Flow Valves

DRESSER® EXCESS FLOW VALVES			
EFV SIZE	PE SIZE	WALL	PART NUMBER
DRESSER® LOW CAPACITY	1/2" CTS (5/8" OD)	.090	5657-52-1004-76
		.062	5657-52-1004-77
	1" CTS (1 1/8" OD)	.099/.101	5657-52-1008-76
		.090	5657-52-1008-77
	1" IPS	SDR-11 (.119)	5657-52-1014-76
DRESSER® MEDIUM CAPACITY	1/2" CTS (5/8" OD)	.090	5657-52-1004-78
		.062	5657-52-1004-79
	1" CTS (1 1/8" OD)	.099/.101	5657-52-1008-78
		.090	5657-52-1008-79
	1" IPS	SDR-11 (.119)	5657-52-1014-78
DRESSER® HIGH CAPACITY	1" CTS (1 1/8" OD)	.099/.101	5657-52-1008-80
		.090	5657-52-1008-81
	1" IPS	SDR-11 (.119)	5657-52-1014-80



- For sizes not listed, contact Continental Industries.
- PA Compression fittings rated at 125 psig.

## POLYETHYLENE PIGTAILS For Butt Fusion Applications with Dresser® Excess Flow Valves

DRESSER® EXCESS FLOW VALVES				
EFV SIZE	PE SIZE	WALL	PART NUMBER (2406)	PART NUMBER (3408/4710)
DRESSER® LOW CAPACITY	1/2" CTS (5/8" OD)	.090	0000-33-5866-24	0000-33-5866-34
		.062	0000-33-5865-24	0000-33-5865-34
	1" CTS (1 1/8" OD)	.099/.101	0000-33-5868-24	0000-33-5868-34
		.090	0000-33-5867-24	0000-33-5867-34
	1" IPS	SDR-9.3 (.090)	0000-33-5869-24	0000-33-5869-34
DRESSER® MEDIUM CAPACITY	1" CTS (1 1/8" OD)	.099/.101	0000-33-5875-24	0000-33-5875-34
		.090	0000-33-5874-24	0000-33-5874-34
	3/4" IPS	SDR-11 (.095)	0000-33-5877-24	0000-33-5877-34
	1" IPS	SDR-11 (.119)	0000-33-5878-24	0000-33-5878-34
	DRESSER® HIGH CAPACITY	1" CTS (1 1/8" OD)	.099/.101	0000-33-5880-24
.090			0000-33-5879-24	0000-33-5879-34
1" IPS		SDR-11 (.119)	0000-33-5883-24	0000-33-5883-34

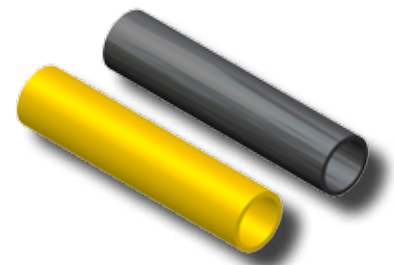

- For sizes not listed, contact Continental Industries.