

SOCK-IT® PIPING METHOD FITTINGS

The Gruvlok® Sock-It® Piping Method provides a quick, secure and reliable method of joining plain-end steel pipe. Several Sock-It configurations are available: tees with NPT outlets, reducing run tees with NPT outlets, straight couplings, 90 elbows, straight tees and reducing elbows. Pressure energized elastomeric gaskets provide the Sock-It with a leak tight seal. Specially designed lock bolts secure the pipe in the Sock-It Fitting, providing a fast, dependable way of joining small diameter plain-end pipe.



FITTING SIZE			
Nominal Size	O.D.	Nominal Size	O.D.
In./DN(mm)	In./mm	In./DN(mm)	In./mm
1/2	0.840	1 1/2	1.900
15	21.3	40	48.3
3/4	1.050	2	2.375
20	26.7	50	60.3
1	1.315	2 1/2	2.875
25	33.7	65	73.0
1 1/4	1.660		
32	42.4		

The Fitting Size Chart is used to determine the O.D. of the pipe that the fittings is to be used with. Gruvlok Fittings are identified by either the Nominal size in inches or the Pipe O.D. in mm.

Working pressure ratings shown are for reference only and are based on schedule 40 pipe. For the latest UL/ULC Listed and FM approved pressure ratings versus pipe schedule see www.anvilintl.com or contact your local Anvil Sales Representative.

See Installation & Assembly directions on page 189.



For Listings/Approval Details and Limitations, visit our website at www.anvilintl.com or contact an Anvil® Sales Representative.

MATERIAL SPECIFICATIONS

HOUSING: Cast iron ASTM A 126 CLASS A

BOLTS: Case hardened carbon steel, dichromate finish.

GASKETS: EPDM, as specified in accordance with ASTM D 2000

NOTE: All Sock-It® fittings are UL/ULC Listed and FM Approved for 175 psi working pressure when used to join XL Pipe and Dyna-Flow Pipe.

FIG. 7100 - 90° Elbow (Sock-It® x Sock-It®)

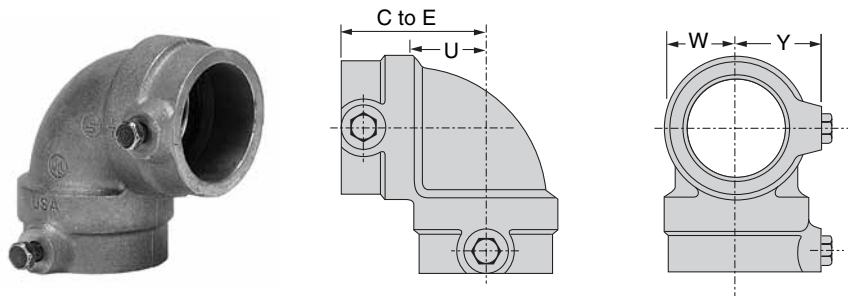

FIGURE 7100 SOCK-IT® ELBOW (S X S)								
Nominal Size	O.D.	Max. Working Pressure		Dimensions				Approx. Wt. Ea.
		UL/ULC Listed	FM Approved	Center To End	U*	W	Y	
In./DN(mm)	In./mm	PSI/bar	PSI/bar	In./mm	In./mm	In./mm	In./mm	Lbs./Kg
1	1.315	300	300	2 5/16	7/8	1 1/16	1 3/4	1.9
25	33.7	20.7	20.7	59	22	27	44	0.9
1 1/4	1.660	300	300	2 7/16	1	1 1/4	1 13/16	2.3
32	42.4	20.7	20.7	62	25	32	46	1.0
1 1/2	1.900	300	300	2 5/8	1 1/8	1 3/8	1 15/16	2.7
40	48.3	20.7	20.7	67	29	35	49	1.2
2	2.375	175	250	3 1/4	1 3/16	1 5/8	2 1/16	4.0
50	60.3	12.1	17.2	83	40	41	56	1.8

*"U" - Run take-out dimension.

SOCK-IT® PIPING METHOD FITTINGS

FIG. 7101 - 90° Reducing Elbow (Sock-It® x NPT)

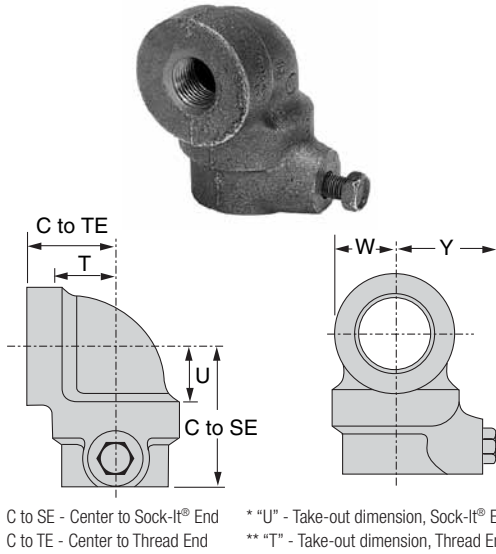

FIGURE 7101 SOCK-IT® REDUCING ELBOW (S X NPT)										
Nominal Size	Max. Working Pressure		Dimensions						Approx. Wt. Ea.	
	UL/ULC Listed	FM Approved	Center to TE	Center To SE	U*	T**	W	Y		
In./DN(mm)	PSI/bar	PSI/bar	In./mm	In./mm	In./mm	In./mm	In./mm	In./mm	Lbs./Kg	
1 x 1/2 25 x 15	300 20.7	300 20.7	1 1/16 37	2 5/16 59	7/8 22	1 25	1 1/16 27	1 1/16 43	1.7 0.8	
1 x 3/4 25 x 20	300 20.7	300 20.7	1 1/16 37	2 5/16 59	7/8 22	7/8 22	1 1/16 27	1 1/16 43	1.6 0.7	
1 x 1 25 x 25	300 20.7	300 20.7	1 1/16 37	2 5/16 59	7/8 22	7/8 22	1 1/16 27	1 1/16 43	1.5 0.7	
1 1/4 x 1/2 32 x 15	300 20.7	300 20.7	1 9/16 40	2 1/2 64	1 1/16 17	1 1/8 29	1 1/4 32	1 3/16 46	2.2 1.0	
1 1/4 x 3/4 32 x 20	300 20.7	300 20.7	1 9/16 40	2 1/2 64	1 1/16 17	1 25	1 1/4 32	1 3/16 46	2.1 1.0	
1 1/4 x 1 32 x 25	300 20.7	300 20.7	1 9/16 40	2 1/2 64	1 1/16 17	1 25	1 1/4 32	1 3/16 46	2 0.9	
1 1/2 x 1/2 40 x 15	300 20.7	300 20.7	1 11/16 43	2 1/2 64	1 25	1 1/4 32	1 3/8 35	1 5/16 49	2.5 1.1	
1 1/2 x 3/4 40 x 20	300 20.7	300 20.7	1 11/16 43	2 1/2 64	1 25	1 1/8 29	1 3/8 35	1 5/16 49	2.4 1.1	
1 1/2 x 1 40 x 25	300 20.7	300 20.7	1 11/16 43	2 1/2 64	1 25	1 1/8 29	1 3/8 35	1 5/16 49	2.3 1.0	

FIG. 7103 - Straight Tee (Sock-It® x Sock-It® x Sock-It®)

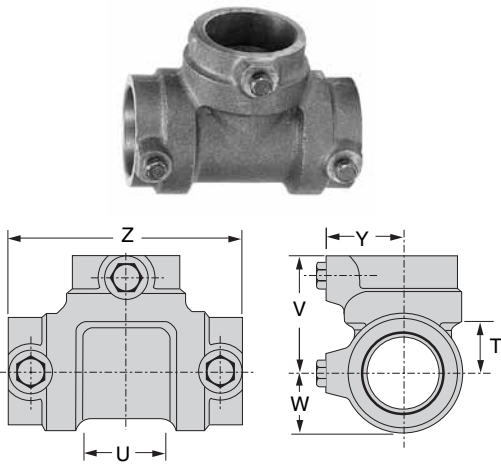

FIGURE 7103 SOCK-IT® STRAIGHT TEE (S x S x S)										
Nominal Size	O.D.	Max. Working Pressure		Dimensions						Approx. Wt. Ea.
		UL/ULC Listed	FM Approved	**T	U*	V	W	Y	Z	
In./DN(mm)	In./mm	PSI/bar	PSI/bar	In./mm	In./mm	In./mm	In./mm	In./mm	In./mm	Lbs./Kg
1 25	1.315 33.7	300 20.7	300 20.7	1 3/16 21	1 5/8 41	2 1/4 57	1 1/16 27	1 11/16 43	4 1/2 114	2.3 1.0
1 1/4 32	1.660 42.4	175 12.1	300 20.7	1 25	2 51	2 1/16 62	1 1/4 32	1 13/16 46	4 7/8 124	2.9 1.3
1 1/2 40	1.900 48.3	175 12.1	300 20.7	1 1/16 17	2 1/8 54	2 9/16 65	1 3/8 35	1 15/16 49	5 1/8 130	3.4 1.5
2 50	2.375 60.3	175 12.1	250 17.2	1 9/16 23	2 5/8 67	3 76	1 11/16 43	2 3/16 56	6 152	5.6 2.5

* "U" - Run take-out dimension.
***"T" - Outlet take-out dimension.

FIG. 7107 - Coupling (Sock-It® x Sock-It®)

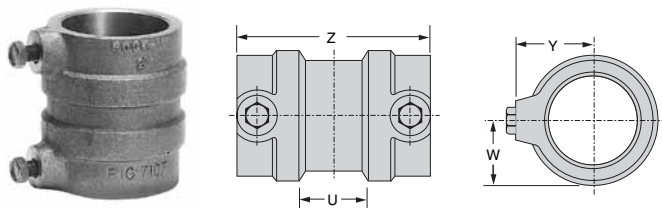

FIGURE 7107 SOCK-IT® COUPLING (S x S)										
Nominal Size	O.D.	Max. Working Pressure		Dimensions				Approx. Wt. Ea.		
		UL/ULC Listed	FM Approved	U*	W	Y	Z			
In./DN(mm)	In./mm	PSI/bar	PSI/bar	In./mm	In./mm	In./mm	In./mm	Lbs./Kg		
1 25	1.315 33.7	300 20.7	300 20.7	1/4 6	1 1/16 27	1 11/16 43	3 3/8 79	1.7 0.8		
1 1/4 32	1.660 42.4	300 20.7	300 20.7	1/4 6	1 1/4 32	1 13/16 46	3 3/8 79	1.9 0.9		
1 1/2 40	1.900 48.3	300 20.7	300 20.7	1/4 6	1 3/8 35	1 15/16 49	3 1/4 83	2.1 1.0		
2 50	2.375 60.3	175 12.1	250 17.2	1/4 6	1 1/8 41	2 3/16 56	3 3/8 92	2.9 1.3		

* "U" - Run take-out dimension.