

STEEL PIPE CLAMPS

Fig. 103

Offset Pipe Clamp

Size Range: 3/4" through 8"
Material: Carbon steel
Finish: Plain or Galvanized
Service: For use in supporting piping away from wall or floor.
Maximum Temperature: Plain 650° F, Galvanized 450° F
Ordering: Specify pipe size, figure number, name and finish
Service: For use in supporting horizontal piping away from the wall or floor (not to be used as a riser type support)

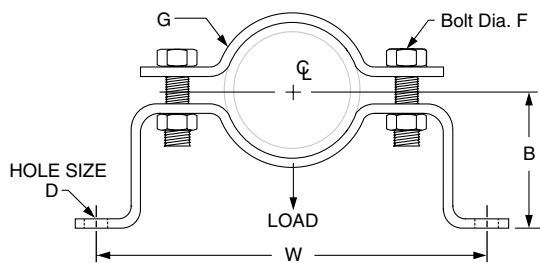

FIG. 103: LOADS (LBS) • WEIGHT (LBS) • DIMENSIONS (IN)

Pipe Size	Max Load	Weight	W	B	D	Bolt Dia. F	G Width
3/4	190	1.50	8 3/4	2 1/2	7/16	3/8	1 1/4
1		1.60	9 1/4	2 5/8			
1 1/4		1.70	9 3/4	2 13/16			
1 1/2		1.80	10	2 15/16			
2	420	2.70	11 1/4	3 3/16	9/16	1/2	1 1/2
2 1/2		2.90	11 3/4	3 1/16			
3		3.20	12 7/8	3 3/4			
4	610	4.60	13 7/8	4 1/4	1 1/16	5/8	2
5		7.30	15 5/8	4 3/4			
6	870	7.80	16 3/4	5 3/16	1 1/16	5/8	2
8		9.00	18 3/4	6 5/16			

Fig. 100

Extended Pipe Clamp

Size Range: 1/2" through 8"
Material: Carbon steel
Finish: Plain or Galvanized
Service: For attachment to structure without use of rods.
Maximum Temperature: Plain 650° F, Galvanized 450° F
Ordering: Specify pipe size, figure number, name and finish.

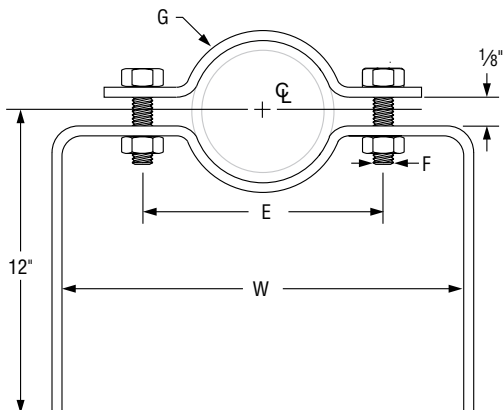
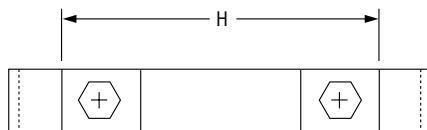

FIG. 100: WEIGHT (LBS) • DIMENSIONS (IN)

Pipe Size	W	E	F	G Width	H	Weight
1/2	5 5/8	2 7/8	3/8	1	4 1/4	1.85
3/4	5 7/8	3 1/8			4 1/2	2.20
1	6 3/8	3 5/8			5	2.25
1 1/4	6 7/8	4 1/8			5 1/2	2.34
1 1/2	7 1/8	4 3/8	1/2	1 1/4	5 3/4	2.39
2	8 3/8	5 1/8			6 7/8	3.25
2 1/2	8 7/8	5 5/8			7 7/8	3.40
3	10	6 3/4			8 1/4	3.58
4	10 5/8	7 3/8	5/8	1 1/2	9 1/8	4.74
5	12 3/8	8 5/8			10 7/8	5.09
6	13 1/2	9 3/4			12	8.23
8	15 1/2	11 3/4			14	9.25