

COMMERCIAL PRODUCTS CATALOG

Regular Port Economy Ball Valves

32-200 SERIES

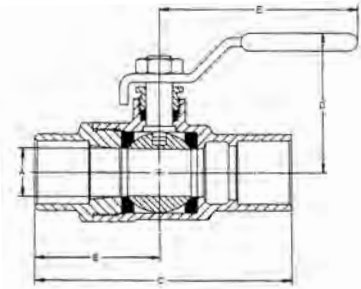

REGULAR PORT SOLDER END BRONZE BALL VALVE

Solder end ball valve with vacuum service to 29" Hg. 400 psig CWP, non-shock 125 psig for saturated steam. Blowout-proof design with adjustable packing gland.

FEATURES

- ASTM B584 Bronze
- PTFE seats and MPTFE Stuffing box ring

OPTIONS

- 2-1/4" stem extension (-04)
- Tee handle (-07)
- Round handle (-15)
- SS latch-lock lever & nut (-27)
- Balancing stop (-92)

Model Number	Size (in.)	Dimensions (in.)				
		A	B	C	D	E
32-203-01	1/2	0.40	1.29	2.65	1.68	2.87
32-204-01	3/4	0.65	1.73	3.56	1.90	3.87
32-205-01	1	0.75	2.11	4.26	2.18	4.87
32-206-01	1-1/4	1.00	2.36	4.60	2.53	5.50
32-207-01	1-1/2	1.12	2.84	5.42	2.69	5.50
32-208-01	2	1.50	3.33	6.48	2.94	5.50

Ball Valves w/Mounting Pad

71-100 SERIES

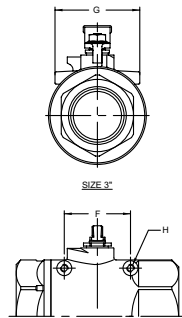
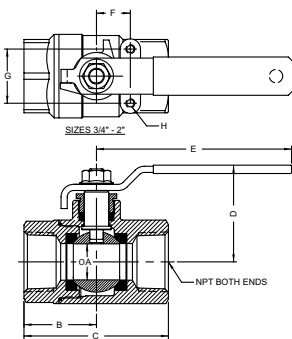

BALL VALVE WITH MOUNTING PAD

Designed to easily accommodate spring return handle, actuator or simple panel mounting. Threaded end connections with RPTFE seats and stuffing box ring.

FEATURES

- 3/4" to 3" models (See 77 Series for 1/4" - 1/2")
- 600 CWP non-shock
- Blowout-proof stem
- ASTM B584 Bronze
- Round handle option
- Adjustable packing

Model Number	Size (in.)	Dimensions (in.)							
		A	B	C	D	E	F	G	H
71-104-01	3/4	0.68	1.50	3.00	2.12	4.87	0.87	1.37	10-24 NC
71-105-01	1	0.87	1.68	3.37	2.25	4.87	0.87	1.37	10-24 NC
71-106-01	1-1/4	1.00	2.00	4.00	2.62	5.50	0.93	1.50	1/4-20 NC
71-107-01	1-1/2	1.25	2.18	4.37	2.87	8.00	0.93	1.50	1/4-20 NC
71-108-01	2	1.50	2.34	4.68	3.06	8.00	0.93	1.50	1/4-20 NC
71-100-01	3	2.50	3.37	6.75	4.12	8.00	3.37	2.75	1/4-20 NC