

WALL PIPE SUPPORT

Figure 221

The Figure 221 is used to support steel or cast iron pipe close to walls, piers, or in a trench. These supports can be made to carry pipelines at various distances from the wall,

Also for Hot Water Tanks 12" inches to 36" inches in diameter. Prices furnished in accordance with customer specifications.

Made special to customer order.

Material: Steel.

Finish: Plain, Painted, Electro-Galvanized, Hot-Dip Galvanized.

Ordering: Specify pipe size, figure number, and finish. For Metric applications specify Figure M221.

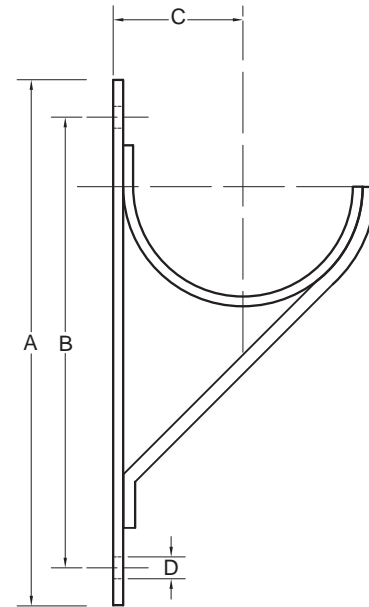

FIGURE 221 – WALL PIPE SUPPORT

PIPE SIZE	A	B	C	D	WEIGHT EACH
3	9 ¹ / ₈	7 ⁷ / ₈	2 ¹ / ₄	⁵ / ₁₆	2.39
80	232	200	57	14	1.08
4	10 ¹ / ₂	9 ¹ / ₄	2 ³ / ₈	⁵ / ₁₆	2.56
100	267	235	70	14	1.16
5	12 ³ / ₄	11 ¹ / ₄	3 ³ / ₁₆	⁵ / ₁₆	4.05
125	324	286	84	14	1.84
6	14	12 ¹ / ₂	3 ¹³ / ₁₆	⁵ / ₁₆	4.48
150	356	318	97	14	2.03
8	18	16	5 ⁵ / ₈	¹ / ₁₆	15.3
200	457	406	137	17	6.94
10	22	19 ¹ / ₂	6 ³ / ₈	¹ / ₁₆	23.4
250	559	495	162	17	10.6
12	24 ¹ / ₂	22	7 ³ / ₈	¹ / ₁₆	26.9
300	622	559	187	17	12.2

DIMENSIONS		TEMPERATURE	LOADS	WEIGHT
INCHES	FAHRENHEIT	POUNDS	POUNDS	
MILLIMETERS	CELSIUS	NEWTONS	KILOGRAMS	