

CHANNEL/M-134

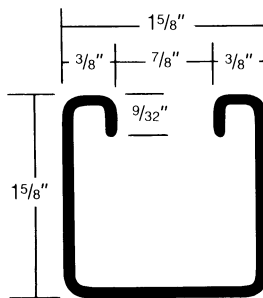

1 5/8" x 1 5/8" x 1 5/8"
14 Gauge Channel
wt./100 ft. - 145#

Stocked in Pre Galvanized, Plain & Painted in 10 & 20 ft. lengths. Post Galvanized & Aluminum available upon request.



M-134-RS

1 5/8" x 1 5/8" x 1 5/8" x 14GA 9/16"
Dia.;
1 7/8" on Centers



M-134-KO

1 5/8" x 1 5/8" x 1 5/8" x 14GA 7/8"
Dia. Knockout;
6" on Centers

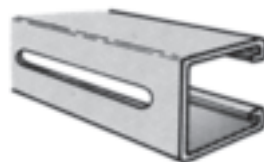

M-134-OS3

1 5/8" x 1 5/8" x 1 5/8" x 14GA 1 3/32"
x 3" Slot;
4" on Centers



M-134-OS

1 5/8" x 1 5/8" x 1 5/8" x 14GA 9/16"
x 1 1/8" Slot;
2" on Centers



M-134-A

3 1/4" x 1 5/8" x 3 1/4" x 14GA
Back to Back

*Other welded combinations available upon request

PROPERTIES OF SECTION

Figure Number	Wt./Ft. Lbs.	Area of Section Sq. in.	X-X Axis			Y-Y Axis		
			Ix in. ⁴	Sx in ³	Rx in.	Iy in. ⁴	Sy in ³	Ry in.
M-134	1.45	.407	0.143	0.158	0.593	0.179	0.221	0.664
M-134-A	2.90	.814	0.706	0.445	0.931	0.359	0.441	0.664

ALLOWABLE COLUMN LOADS (LBS.)

Figure Number	UNSUPPORTED HEIGHT OF COLUMN IN INCHES												
	12"	18"	24"	30"	36"	42"	48"	60"	72"	84"	96"	108"	120"
M-134	5906	5819	5698	5542	5352	5126	4867	4243	3481	2630	2013	1591	1288
M-134-A	11839	11701	11508	11259	10954	10595	10180	9184	7967	6528	5042	3983	3227

ALLOWABLE BEAM LOADS (LBS.)

Figure Number	Notes	SPAN IN INCHES												
		12"	18"	24"	30"	36"	42"	48"	60"	72"	84"	96"	108"	120"
M-134	1	2631	1754	1316	1052	877	752	658	526	439	376	329	292	263
	2	-	-	-	-	-	-	587	376	261	192	147	116	94
	3	0.014	0.032	0.056	0.088	0.128	0.172	0.224	0.350	0.504	0.687	0.897	1.135	1.401
M-134-A	1	7409	4939	3704	2963	2470	2117	1852	1482	1235	1058	926	823	741
	2	-	-	-	-	-	-	-	-	-	944	723	571	463
	3	0.008	0.018	0.032	0.050	0.072	0.098	0.128	0.200	0.288	0.392	0.512	0.649	0.801

NOTES:

- I. All Figures show the Load in Lbs.
- II. Line 1 shows the Allowable Uniform Beam Load based on calculations using 25000 psi Stress.
- III. Line 2 shows the Allowable Uniform Load at Maximum Deflection = 1/240 of Span.
- IV. Line 3 shows Beam Deflection in inches.