

# INTEGRAL FLANGED VALVES- GATE TYPE- BOLTED BONNET- FULL PORT

**1500 LB.**

**Design construction:**

- ASME B16.34 - BS 5352
  - Full port type
  - Testing according to API 598
  - Marking MSS SP25
  - Outside Screw and Yoke (OS&Y)
  - Self aligning two piece packing gland
  - Spiral wound gasket
  - Integral backseat
  - Integral body flanges
  - Face to face according to ASME B16.10
  - Flanges according to ASME B16.5
  - Ring joint type gasket available on request
- Ratings:
- carbon steel class 1500    3705 psig @ 100°F
  - 255 bar + 38°C

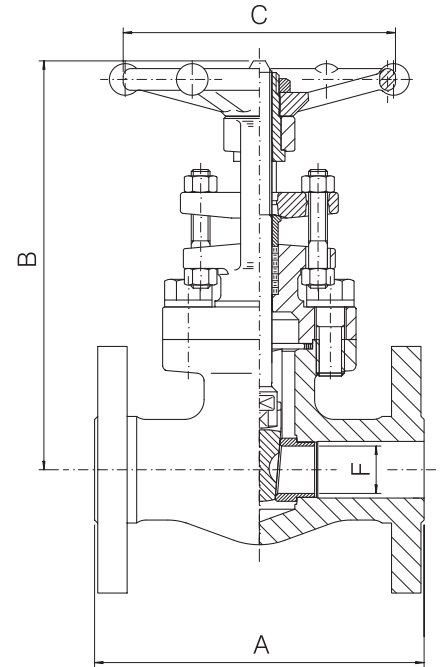

FULL PORT – FIG. 15F 10						
SIZE	inch	1/2	3/4	1	1 1/2	2
	mm	15	20	25	40	50
A	inch	8.50	9.02	10	12.01	14.5
	mm	216	229	254	305	368.5
B open	inch	8.46	9.84	10.63	13.78	17.52
	mm	215	250	270	350	445
C	inch	3.82	5.43	5.43	6.77	9.21
	mm	97	138	138	172	234
F	inch	.55	.71	.94	1.44	1.89
	mm	14	18	24	36.6	48
Weight	lb.	18	28.5	35.5	63.75	121.25
	kg	8,2	13	16,2	29	55
PACKING		BH5	BH6	2B4	BH8	9B8
GASKET		G2	G3	G4	G7	G8