

# FASTENERS

## STANDARD HEX NUT

Figure 165

## HEAVY HEX NUT

Figure 165H

Material is an ASTM A-563 Grade A (Alloy and Stainless Steel grades are Available). Sizes 1 3/4" and larger are only available as a Figure 165H. RH tap will be furnished. LH tap are special order.

**Finish:** Plain, Electro-galvanized, Hot-Dip Galvanized

**Ordering:** Specify tap size, figure number, and finish.

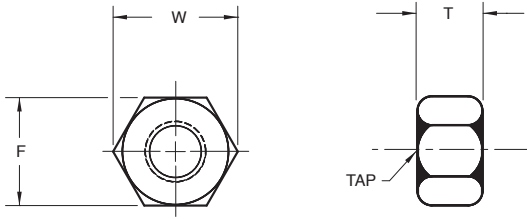

FIGURE 165 – STANDARD HEX NUT

FIGURE 165H – HEAVY HEX NUT

ROD SIZE	MAX LOAD	F	T	W	WEIGHT EACH
3/8	730	1 1/16	3/8	1 3/16	0.031
M10	3247	17	10	21	0.014
1/2	1350	7/8	1/2	1	0.065
M12	6005	22	13	25	0.029
5/8	2160	1 1/16	5/8	1 1/4	0.119
M16	9609	27	16	32	0.054
3/4	3230	1 1/4	3/4	1 1/16	0.193
M20	14368	32	19	37	0.088
7/8	4480	1 7/16	7/8	1 11/16	0.297
M20	19929	37	22	43	0.135
1	5900	1 3/8	1	1 7/8	0.425
M24	26246	41	25	48	0.193
1 1/4	9500	2	1 1/4	2 5/16	0.786
M30	42260	51	32	59	0.357
1 1/2	13800	2 3/8	1 1/2	2 3/4	1.31
M36	61388	60	38	70	0.594
1 3/4	18600	2 3/4	1 3/4	3 3/16	2.04
M42	82740	70	44	81	0.925
2	24600	3 3/8	2	3 5/8	2.99
M48	109431	79	51	92	1.36
2 1/4	32300	3 1/2	2 3/16	4 1/16	4.19
M56	143683	89	56	103	1.90
2 1/2	39800	3 7/8	2 7/16	4 1/2	5.64
M64	177046	98	62	114	2.56
2 3/4	49400	4 1/4	2 11/16	4 15/16	7.38
M72	219751	108	68	125	3.35
3	60100	4 5/8	2 15/16	5 5/16	9.50
M80	267349	117	75	135	4.31
3 1/4	71900	5	3 3/16	5 3/4	12.0
M80	319840	127	81	146	5.44
3 1/2	84700	5 3/8	3 7/16	6 3/16	15.3
M90	376779	137	87	157	6.94

## HEX HEAD BOLT

Figure 162

Hex head bolt with UNC threads. Stocked for immediate shipment. Various lengths available.

Also available in alloy (A193B7), stainless steel (316 and 18-8), and high strength (A325).

**Material:** Low carbon steel

**Finish:** Plain, Electro-galvanized, Hot-dip Galvanized

**Ordering:** Specify diameter, length, thread length, figure number, and finish.

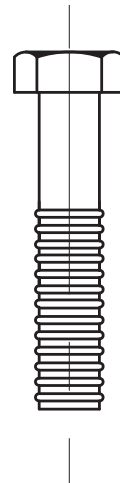

FIGURE 162 – HEX HEAD BOLT – WEIGHT PER 100

DIA. OF BOLT	LENGTH OF BOLT IN INCHES									
	2"	2 1/4"	2 1/2"	2 3/4"	3"	3 1/4"	3 1/2"	3 3/4"	4"	5"
5/8	36	38	40	42	44	46	48	50	52	60
3/4	57	60	62	65	68	71	74	77	80	92
7/8	86	90	94	99	103	107	111	115	118	135
1	127	133	138	143	148	153	158	163	169	190

DIMENSIONS		TEMPERATURE	LOADS	WEIGHT
INCHES	FAHRENHEIT	POUNDS	POUNDS	
MILLIMETERS	CELSIUS	NEWTONS	KILOGRAMS	