

HEAVY ALLOY THREE BOLT PIPE CLAMP

Figure 91Z

The Figure 91Z is designed to accommodate higher loads than the Figure 304Z for use on insulated alloy piping. The spacer on the top inner bolt provides uniform space for the connecting eyerod or weldless eyenut.

Temperature range: Above 750° F (399° C) to 1050° F (566° C).

Material: Chrome Molybdenum Steel ASTM A-387 Grade 22.

Compliance: Federal Specification A-A-1192A Type 3, MSS-SP-69 Type 3, and BSPSS-BS3974.

Finish: Plain.

Ordering: Specify figure number and pipe size. For Metric applications specify Figure M91Z.

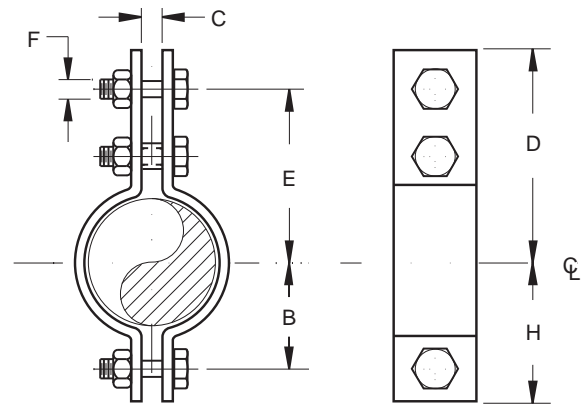

FIGURE 91Z – HEAVY ALLOY THREE BOLT PIPE CLAMP

PIPE SIZE	MAXIMUM LOAD			B	C	D	E	F	H	WEIGHT EACH
	950° F 510° C	1000° F 538° C	1050° F 566° C							
6	7300	5200	3700	5¼	1¾	11	9	1½	7	28
150	32473	23132	16459	133	44	279	229	M36	178	13
8	7300	5200	3700	6⅝	1¾	12	10	1½	8½	33
200	32473	23132	16459	168	44	305	254	M36	216	15
10	10000	7200	5000	7⅞	2	14	12	1¾	10	53
250	44484	32028	22242	200	51	356	305	M42	254	24
12	10000	7200	5000	9⅜	2	15	13	1¾	11¼	65
300	44484	32028	22242	238	51	381	330	M42	286	29
14	11600	8300	6000	9⅞	2¼	16¼	14	1⅞	12	88
350	51601	36922	26690	251	57	413	356	M48	305	40
16	11600	8300	6000	11	2¼	17¼	15	1⅞	13	95
400	51601	36922	26690	279	57	438	381	M48	330	43
18	11600	8300	6000	12	2¼	18¼	16	1⅞	14	103
450	51601	36922	26690	305	57	464	406	M48	356	47
20	15000	10600	7500	13½	2¼	20½	18	2	15½	142
500	66726	47153	33363	343	57	521	457	M48	394	64
24	15000	13000	9000	15¾	2¼	23	20	2	18	213
600	66726	57829	40036	400	57	584	508	M48	457	97
30	15000	13000	9000	19	2¼	28	25	2	21½	300
750	66726	57829	40036	483	57	711	635	M48	546	136
36	15000	13000	9000	22	2¼	31	28	2	24½	340
900	66726	57829	40036	559	57	787	711	M48	622	154

DIMENSIONS		TEMPERATURE	LOADS	WEIGHT
INCHES	MILLIMETERS	FAHRENHEIT	POUNDS	POUNDS
		CELSIUS	NEWTONS	KILOGRAMS