

ADJUSTABLE PIPE SUPPORT

Figure 101

The Figure 101 is used for support of piping from below without welding to the pipe and consists of a steel saddle, nipple, and pipe reducer. It connects to a threaded pipe standard and base which is also available, ordered separately, as our Figure 138.

Rated loads are for up to 650° F (343° C).

Materials: Reducer is Cast Iron, Pipe saddle and nipple are carbon steel.

Compliance: Federal Specification A-A-1192A Type 39, MSS-SP-69 Type 39.

Finish: Plain, Painted, Electro-Galvanized, Hot-Dip Galvanized.

Ordering: Specify pipe size, figure number, and finish. For Metric applications specify Figure M101.

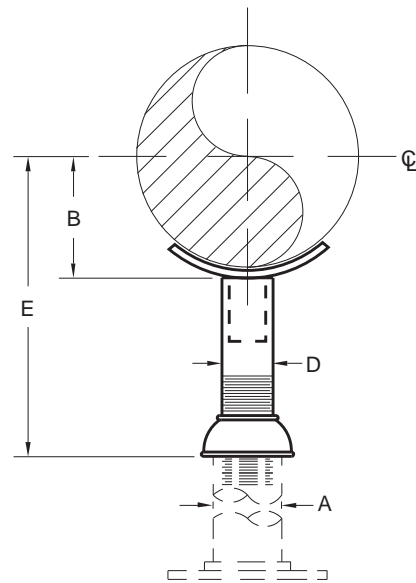

FIGURE 101 – ADJUSTABLE PIPE SUPPORT

PIPE SIZE	MAX LOAD	A	B	D	E MIN.	E MAX.	WEIGHT EACH
1½	5,000	2½	1¼	1½	8	13	4.75
40	22242	65	32	40	203	330	2.15
2	5,000	2½	1½	1½	8	13	4.80
50	22242	65	38	40	203	330	2.18
2½	5,000	2½	1¾	1½	8	13	4.90
65	22242	65	48	40	203	330	2.22
3	5,000	2½	2¼	1½	8¼	13¼	5.00
80	22242	65	54	40	210	337	2.27
4	7,000	3	2½	2½	9¼	14¼	9.30
100	31139	80	67	65	232	359	4.22
5	7,000	3	3¼	2½	9¼	14¼	9.65
125	31139	80	83	65	244	371	4.38
6	7,000	3	3¾	2½	10	15	11.70
150	31139	80	98	65	254	381	9.40
8	7,000	3	4¼	2½	11	16	12.90
200	31139	80	124	65	279	406	5.83
10	7,000	3	5¼	2½	12¼	17¼	14.10
250	31139	80	149	65	308	435	6.40
12	7,000	3	6¼	2½	13¼	18¼	15.30
300	31139	80	175	65	333	460	6.90
14	7,000	4	7¼	3	13	18	21.70
350	31139	100	191	80	330	457	9.84
16	7,000	4	8½	3	14¼	19¼	25.40
400	31139	100	219	80	359	486	11.50
18	7,000	6	9¼	4	15¼	20¼	39.30
450	31139	150	244	100	384	511	17.80
20	7,000	6	10¼	4	16¼	21¼	44.90
500	31139	150	270	100	410	537	20.40
24	10,000	6	12¼	4	18¼	23¼	54.30
600	44484	150	324	100	464	591	24.60
30	10,000	6	15¼	4	21¼	26¼	62.40
750	44484	150	400	100	540	667	28.30
36	10,000	6	18¼	4	24¼	29¼	70.20
900	44484	150	476	100	616	743	31.80

DIMENSIONS		TEMPERATURE	LOADS	WEIGHT
INCHES	FAHRENHEIT	POUNDS	POUNDS	
MILLIMETERS	CELSIUS	NEWTONS	KILOGRAMS	