

MULTI-STRUT®

CHANNEL/M-142

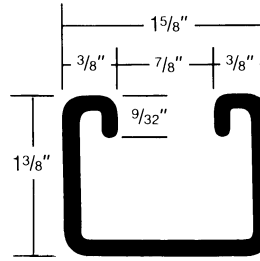

M-142-RS
 $1\frac{3}{8}$ " x $1\frac{5}{8}$ " x $1\frac{3}{8}$ " x 12GA $\frac{9}{16}$ "
 Dia.;
 $1\frac{7}{8}$ " on Centers



$1\frac{3}{8}$ " x $1\frac{5}{8}$ " x $1\frac{3}{8}$ "
 12 Gauge Channel
 wt./100 ft. - 176#

Stocked in Pre Galvanized, Plain & Painted in 10 & 20 ft. lengths. Post Galvanized & Aluminum available upon request.

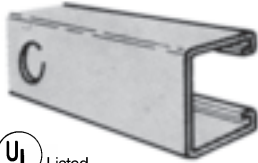

M-142-KO
 $1\frac{3}{8}$ " x $1\frac{5}{8}$ " x $1\frac{3}{8}$ " x 12GA $\frac{7}{8}$ "
 Dia. Knockout;
 6" on Centers

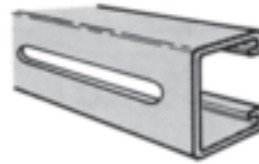

M-142-OS3
 $1\frac{3}{8}$ " x $1\frac{5}{8}$ " x $1\frac{3}{8}$ " x 12GA $\frac{13}{32}$ "
 x 3" Slot;
 4" on Centers

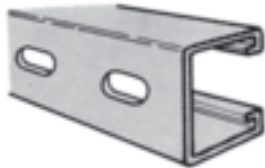

M-142-OS
 $1\frac{3}{8}$ " x $1\frac{5}{8}$ " x $1\frac{3}{8}$ " x 12GA $\frac{9}{16}$ "
 x $1\frac{1}{8}$ " Slot;
 2" on Centers

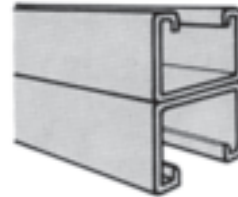

M-142-A
 $2\frac{3}{4}$ " x $1\frac{5}{8}$ " X $2\frac{3}{4}$ " x 12GA
 Back to Back

*Other welded combinations available upon request

PROPERTIES OF SECTION

Figure Number	Wt./Ft. Lbs.	Area of Section Sq. in.	X-X Axis			Y-Y Axis		
			Ix in. ⁴	Sx in. ³	Rx in.	Iy in. ⁴	Sy in. ³	Ry in.
M-142	1.76	0.492	0.117	0.148	0.489	0.203	0.250	0.642
M-142-A	3.52	0.983	0.570	0.431	0.762	0.408	0.50	0.642

ALLOWABLE COLUMN LOADS (LBS.)

Figure Number	UNSUPPORTED HEIGHT OF COLUMN IN INCHES												
	12"	18"	24"	30"	36"	42"	48"	60"	72"	84"	96"	108"	120"
M-142	6653	6509	6306	6046	5727	5351	4917	3876	2749	2020	1547	1222	990
M-142-A	13404	13237	13002	12701	12333	11898	11396	10191	8718	6978	5347	4225	3422

ALLOWABLE BEAM LOADS (LBS.)

Figure Number	Notes	SPAN IN INCHES												
		12"	18"	24"	30"	36"	42"	48"	60"	72"	84"	96"	108"	120"
M-142	1	2473	1649	1236	989	824	707	618	495	412	353	309	275	247
	2	-	-	-	-	-	628	481	308	214	157	120	95	77
	3	0.016	0.036	0.064	0.100	0.145	0.197	0.257	0.402	0.579	0.788	1.029	1.302	1.608
M-142-A	1	7187	4791	3593	2875	2396	2053	1797	1437	1198	1027	898	799	719
	2	-	-	-	-	-	-	-	-	1039	763	584	462	374
	3	0.010	0.022	0.038	0.060	0.086	0.118	0.154	0.240	0.346	0.471	0.615	0.778	0.961

NOTES:

- I. All Figures show the Load in Lbs.
- II. Line 1 shows the Allowable Uniform Beam Load based on calculations using 25000 psi Stress.
- III. Line 2 shows the Allowable Uniform Load at Maximum Deflection = 1/240 of Span.
- IV. Line 3 shows Beam Deflection in inches.