

MULTI-STRUT®

GRIP LOCK NUTS

DATA:

Finished in Electro-Galvanized

The case hardened carbon steel nuts are designed with special formed teeth in the parallel channel recesses. The nuts are made to grip the returned lip of the channel. The shearing action of the teeth assures a positive locking of the H-Strut channels to the fittings. The selection table shows the correct locking nuts for each size channel.

WITHOUT SPRING

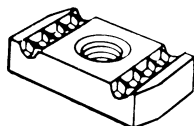

Cat. No.	Size	Thd	Thk	Wt/100 pc.	Channel
N-800	1/4"	20	1/4"	6	All Multi-Strut
N-801	3/8"	16	3/8"	9	
N-802	1/2"	13	3/8"	9	
N-803	1/2"	13	1/2"	12	M-122, M-132, M-134
N-804	5/8"	11	7/16"	13	M-142, M-152, M-164
N-805	3/4"	10	7/16"	13	M-165, M-166, M-112
N-806	5/8"	11	3/8"	13	All Multi-Strut
N-807	3/4"	10	3/8"	13	
N-808	5/16"	18	3/8"	7	
N-809	7/8"	9	7/16"	13	

SHORT SPRING

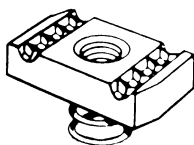

Cat. No.	Size	Thd	Thk	Wt/100 pc.	Channel
N-810	1/4"	20	1/4"	7	M-152, M-164, M-165 M-166
N-811	3/8"	16	3/8"	9	
N-812	1/2"	13	3/8"	9	
N-814	3/8"	11	3/8"	10	
N-815	3/4"	10	3/8"	9	
N-818	5/16"	18	3/8"	7	

REGULAR SPRING

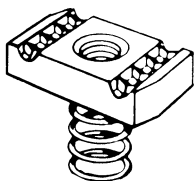

Cat. No.	Size	Thd	Thk	Wt/100 pc.	Channel
N-820	1/4"	20	1/4"	7	M-132, M-134, M-142
N-821	3/8"	16	3/8"	10	
N-822	1/2"	13	3/8"	10	
N-823	1/2"	13	1/2"	13	
N-824	5/8"	11	7/16"	13	
N-825	3/4"	10	7/16"	13	
N-828	5/16"	18	3/8"	7	
N-829	7/8"	9	7/16"	13	

LONG SPRING

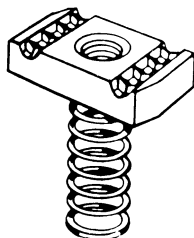

Cat. No.	Size	Thd	Thk	Wt/100 pc	Channel
N-830	1/4"	20	1/4"	7	M-122, M-112
N-831	3/8"	16	3/8"	10	
N-832	1/2"	13	3/8"	10	
N-833	1/2"	13	1/2"	13	
N-834	5/8"	11	7/16"	13	
N-835	3/4"	10	7/16"	13	
N-838	5/16"	18	3/8"	7	

TOP SPRING NUT

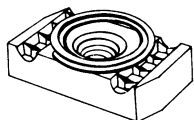

Cat. No.	Size	Thd	Thk	Wt/100 pc.	Channel
TSN-800	1/4"	20	1/4"	6	All Multi-Strut
TSN-801	3/8"	16	3/8"	9	
TSN-802	1/2"	13	3/8"	9	
TSN-808	5/16"	18	3/8"	7	

NOTE:

1. Tests performed with 1/2" - 13 Bolt tightened to 50/Ft./Lbs. torque
2. Tests performed in accordance with, "The Metal Framing Manufacturers Association" 1983 Specifications.
3. Safety Factor of 3

LOAD DATA

RESISTANCE TO SLIP	PULL OUT STRENGTH
12 Gauge - 1,400#	12 Gauge - 2,000#
14 Gauge - 1,100#	14 Gauge - 1,1400#
15 Gauge - 1,100#	15 Gauge - 1,100#