

ADJUSTABLE SPLIT SWIVEL HANGER

Figure 240

Designed to support non-insulated, stationary lines from above. The hinged design is easier to install, making it ideal for retrofit needs. Vertical adjustment is achieved by turning the swivel. Pipe sizes 3/4" to 2" and 1 1/2" to 2" have the window cutout.

Material: Malleable Iron

Compliance: ASME B31-69 (Type 6)

Finish: Plain

Ordering: Specify pipe size, figure number, and finish. For Metric applications specify Figure M240.

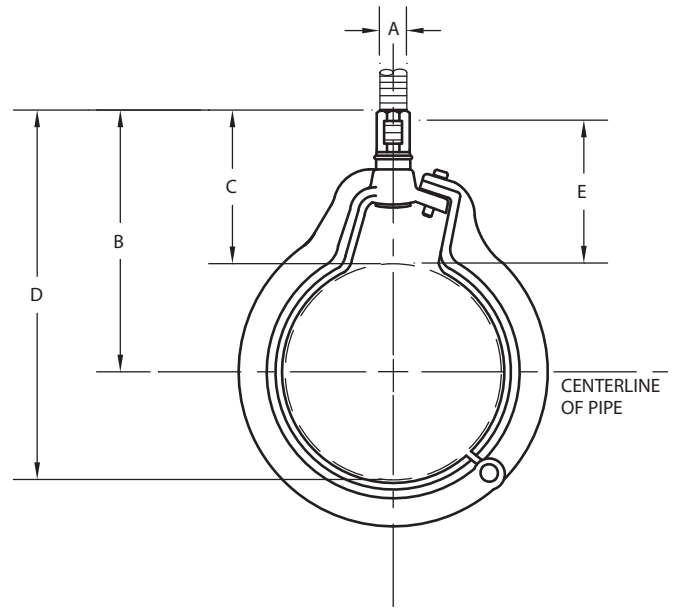

FIGURE 240 - ADJUSTABLE SWIVEL HANGER

PIPE SIZE	MAXIMUM LOAD	ROD SIZE A	B	C	D	E	WEIGHT EACH
3/4	300	3/8	2 1/8	2 3/8	2 5/8	2	0.23
20	1335	10	54	60	67	51	0.10
1	300	3/8	2 3/8	2 1/4	3	1 3/4	0.25
25	1335	10	60	57	76	44	0.11
1/4	300	3/8	2 5/8	2 1/4	3 3/8	1 3/4	0.30
32	1335	10	67	57	86	44	0.14
1 1/2	300	3/8	2 3/4	2 1/4	3 3/4	1 3/4	0.32
40	1335	10	70	57	95	44	0.15
2	300	3/8	3 1/8	2 3/8	4 1/4	1 7/8	0.34
50	1335	10	79	60	108	48	0.15
2 1/2	500	1/2	4 3/8	2 1/8	5 3/4	1 7/8	0.65
65	2224	13	111	54	146	48	0.29
3	500	1/2	4 5/8	2 1/8	6 3/8	2	0.78
80	2224	13	117	54	162	51	0.35
3 1/2	500	1/2	5	2 1/4	7	2 7/8	0.85
90	2224	13	127	57	178	73	0.39
4	900	5/8	6	2 7/8	8 1/4	2 7/8	1.54
100	4004	16	152	73	210	73	0.70
5	900	5/8	6 3/4	3	9 1/2	3	2.00
125	4004	16	171	76	241	76	0.91
6	1300	3/4	7 3/4	3 3/8	11	3 1/2	3.20
150	5783	19	197	86	279	89	1.45
8	1800	7/8	9 3/4	4 3/8	14	3 7/8	5.00
200	8007	22	248	111	356	98	2.27

DIMENSIONS	TEMPERATURE	LOADS	WEIGHT
INCHES	FAHRENHEIT	POUNDS	POUNDS
MILLIMETERS	CELSIUS	NEWTONS	KILOGRAMS