

PIPE ATTACHMENTS

HEAVY DUTY TWO BOLT PIPE CLAMP

Figure 298

Designed to suspend heavy loads on cold or hot pipe lines where little or no insulation is required. The Figure 298 is usually used with a Figure 279 Weldless Eyerut or Figure 93 Welded Eyerod.

Rated Loads are for up to 750° F (399° C).

Material: Carbon Steel.

Compliance: Federal Specification A-A-1192A Type 4, MSS-SP-69 Type 4 and BSPSS-BS3974.

Finish: Plain, Painted, Hot-Dip Galvanized.

Ordering: Specify figure number, finish and pipe size. For Metric applications specify Figure M298.

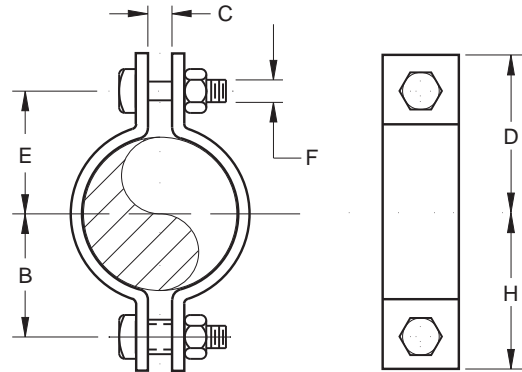

FIGURE 298 – HEAVY DUTY TWO BOLT PIPE CLAMP

PIPE SIZE	MAXIMUM LOAD		B	C	D	E	F	H	WEIGHT EACH
	650° F 343° C	750° F 399° C							
2	3400	3000	2	3/4	3	2	5/8	3	2.1
50	15125	13345	51	19	76	51	M16	76	1.0
3	3550	3150	3 1/8	1	4	3 1/8	3/4	4	3.8
80	15792	14012	79	25	102	79	M20	102	1.7
4	3550	3150	3 3/4	1	4 7/8	3 3/4	7/8	4 7/8	6.5
100	15792	14012	95	25	124	95	M22	124	2.9
5	3550	3150	4 3/8	1	5 1/2	4 3/8	7/8	5 1/2	7.4
125	15792	14012	111	25	140	111	M22	140	3.4
6	4900	4350	5 3/8	1 1/8	6 3/4	5 3/8	1	6 3/4	14.0
150	21797	19351	137	29	171	137	M24	171	6.4
8	4900	4350	6 3/4	1 1/8	8 1/8	6 3/4	1	8 1/8	16.4
200	21797	19351	171	29	206	171	M24	206	7.4
10	6000	5400	7 5/8	1 1/4	9 1/8	7 3/4	1 1/4	9	25.3
250	26690	24021	194	32	232	197	M30	229	11.5
12	8700	7750	9 1/4	1 5/8	11 3/8	9 1/2	1 1/2	11 1/8	44.1
300	38701	34475	235	41	289	241	M36	283	20.0
14	9150	8150	9 3/4	1 5/8	11 7/8	10	1 1/2	11 5/8	58.8
350	40703	36254	248	41	302	254	M36	295	26.7
16	9150	8150	11	1 5/8	12 7/8	11	1 1/2	12 7/8	64.1
400	40703	36254	279	41	327	279	M36	327	29.1
18	13800	12280	14 1/2	3	17 1/4	14 1/2	2	17 1/4	126.3
450	61388	54626	368	76	438	368	M48	438	57.3
20	15300	13620	16	3	18 3/4	16	2	18 3/4	150.0
500	68060	60587	406	76	476	406	M48	476	68.0
24	16300	14500	18 1/2	3 1/4	21 1/2	18 1/2	2 1/4	21 1/2	210.5
600	72509	64502	470	83	546	470	M56	546	95.5
30	20500	18250	22 1/2	3 1/2	26	22 1/2	2 1/2	26	365.4
750	91192	81183	572	89	660	572	M64	660	165.7
36	28000	24900	26 1/2	3 1/2	30 1/4	26 1/2	2 3/4	30 1/4	575.1
900	124555	110765	673	89	768	673	M72	768	260.9

DIMENSIONS	TEMPERATURE	LOADS	WEIGHT
INCHES	FAHRENHEIT	POUNDS	POUNDS
MILLIMETERS	CELSIUS	NEWTONS	KILOGRAMS