

CertainTeed Product Reference Guide

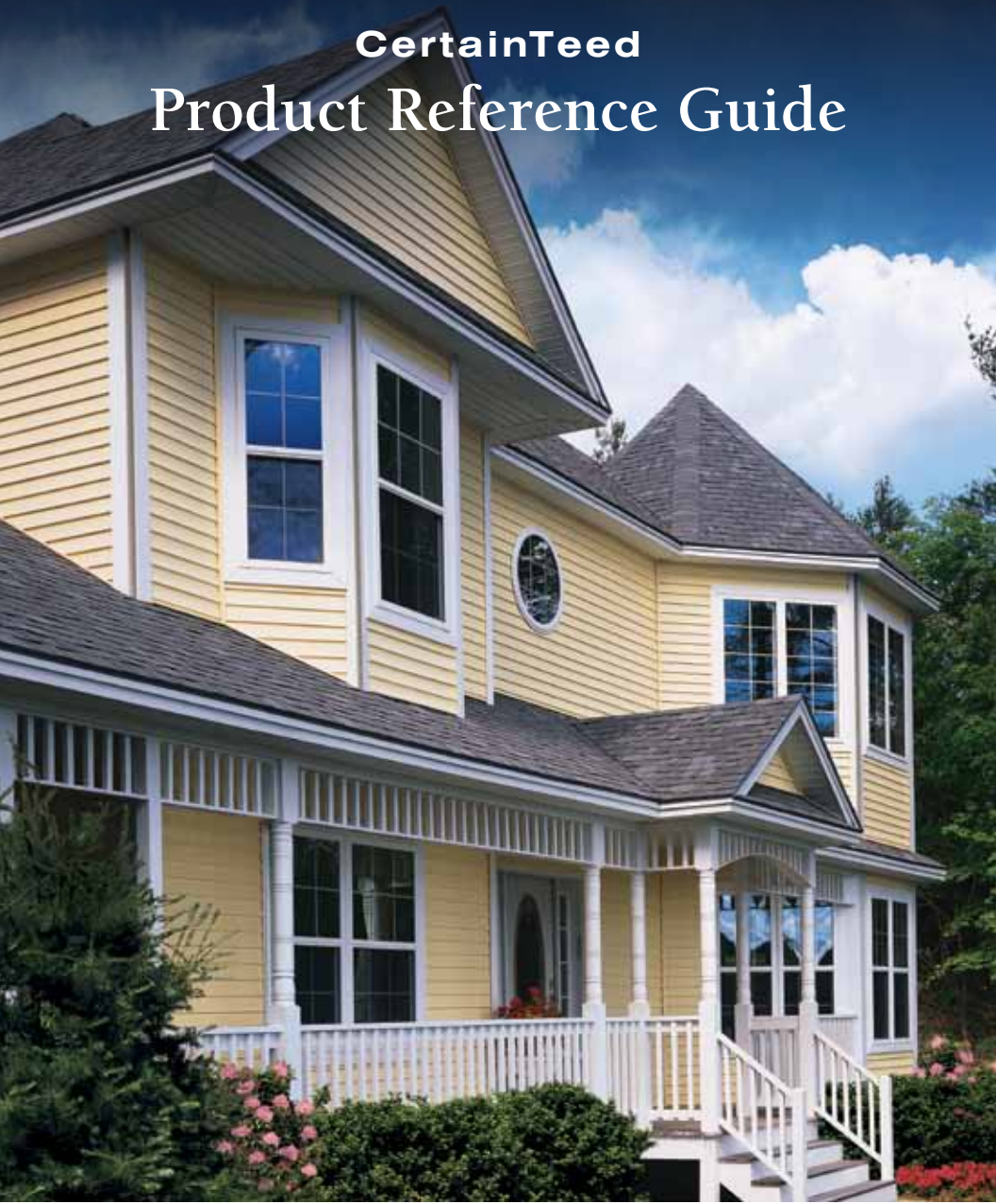

CertainTeed
SAINT-GOBAIN

Montage Deer Valley — Park City, Utah

HKS Hill Glacier Studio, LEED® Silver

Encompassing nearly one million square feet under a common roof, the Montage Deer Valley Resort is one of North America's top ski resorts. In addition to LEED® Silver certification, it participated in the U.S. EPA's ER3 program for responsible reuse and redevelopment of a brownfield site. Montage's ski resort, spa and luxury residences are set in Park City, Utah, home of the Sundance Film Festival. The project was selected for Saint-Gobain Gypsum's International Trophy Competition held in London in 2012.

CertainTeed products used: CertainTeed insulation, roofing, wallboard, exterior sheathing and finishing products.



CertainTeed

A leading name in building products since 1904

For more than 100 years, CertainTeed has helped shape the building products industry by providing high-quality products and innovative solutions.

Today, CertainTeed is North America's leading brand of exterior and interior building products, including roofing, siding, fence, decking, railing, trim, insulation, gypsum and ceilings for both residential and commercial applications.

The CertainTeed Product Reference Guide is designed to provide a quick overview of CertainTeed's comprehensive offering of building materials.

For more detailed information, please contact us at 800-233-8990 or visit us online at certainteed.com.

CertainTeed System Solutions

LEED and NAHB Designs	6
-----------------------	---

Exterior

Roofing	13
Siding	49
Fence	62
Decking & Railing	73
Trim	79

Interior

Insulation	84
Gypsum & Sheathing	90
Ceilings	102

Additional Reference

Sweets	142
--------	-----

COVER IMAGE:

CertainTeed MainStreet™ Double 4" Clapboard Siding



CertainTeed. Confidence Worth Building On.

There's one thing we know for sure. With more than 100 years experience and nearly 70 manufacturing facilities throughout Canada and the United States, you can **Be Certain** about your decision to partner with CertainTeed — North America's leading brand of exterior and interior **building products**. And you can **Be Certain** that when you partner with us, we will work hard to give you the competitive edge you need to succeed.

Rebates and Rewards

CertainTeed rewards loyal customers for using a wide array of CertainTeed products on residential and commercial projects. Builders and contractors are eligible for several types of rebates and rewards. The more products you use, the more rewards you get! Learn more at certainteed.com/Pros/Rebates-Rewards.

Building Knowledge

CertainTeed is more than just a great company with great products. We offer the industry's most extensive collection of CEU courses, Building Science white papers, blogs, and technical information — both online and at live events for collaborative learning and consultation. It's not just information; it's applied knowledge for the real world. Learn more at certainteed.com/BuildingKnowledge.

Sustainability

All that goes into a building — from the life cycle consideration of all raw materials to structure design — has a far-reaching impact on the well-being of people and the environment. CertainTeed shares that responsibility with you, with building materials that help you make a sustainable difference for your customers and the environment. Learn more at certainteed.com/buildingresponsibly.

Credentials for Contractors and Installers

CertainTeed provides contractors with the tools they need to successfully differentiate themselves from competition. Our product knowledge and installation training programs allow contractors to enhance their skills while earning credentials to use with customers. Credentialed contractors receive preferred listing on the CertainTeed website, a great source of homeowner leads.

Learn more at certainteed.com/Pros/Education-Credentials.

Continuing Education for Architects

As a leading continuing education provider, CertainTeed offers more than 40 unique courses on products and systems developed by Building Science experts. Courses are offered in a variety of formats — self-guided online instruction, in person lunch and learns, and live webinars. All courses are AIA accredited, many also have USGBC, GBCI accreditation. Learn more at certainteed.com/continuinged.

CertainTeed has your system solution for moisture

LEED for New Construction (NC)
and LEED for Canada: NC

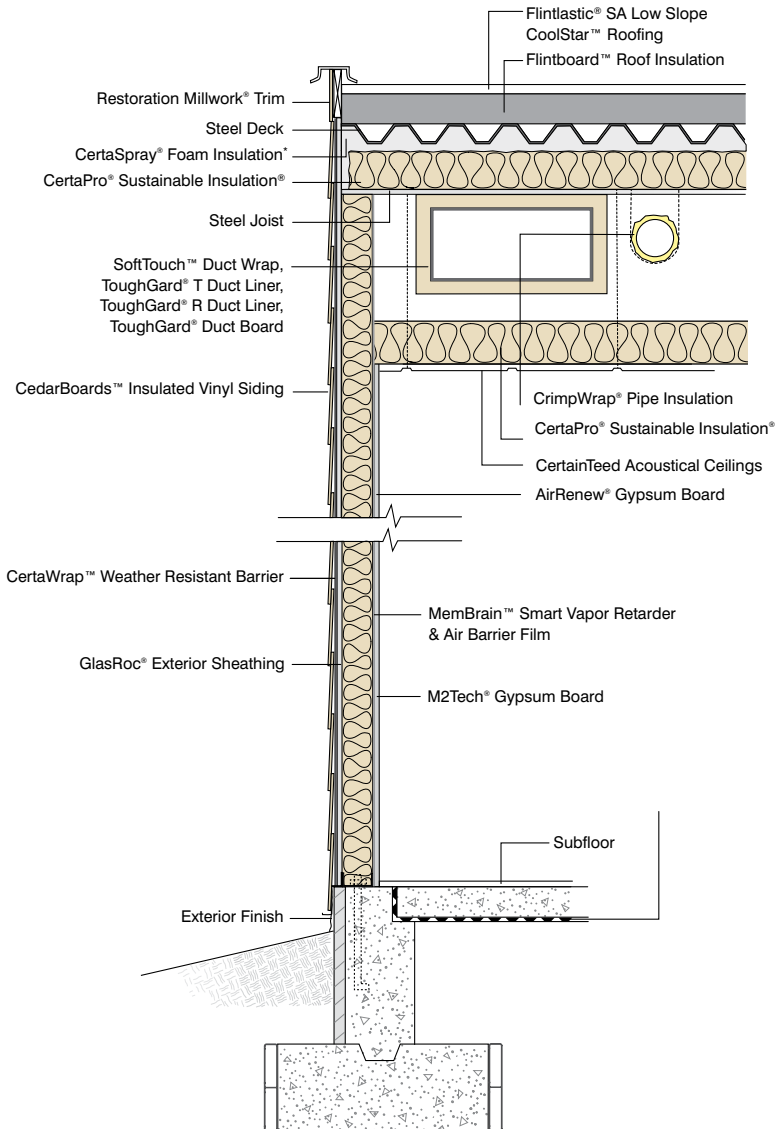

*Apply thermal or ignition barrier. Check local code.

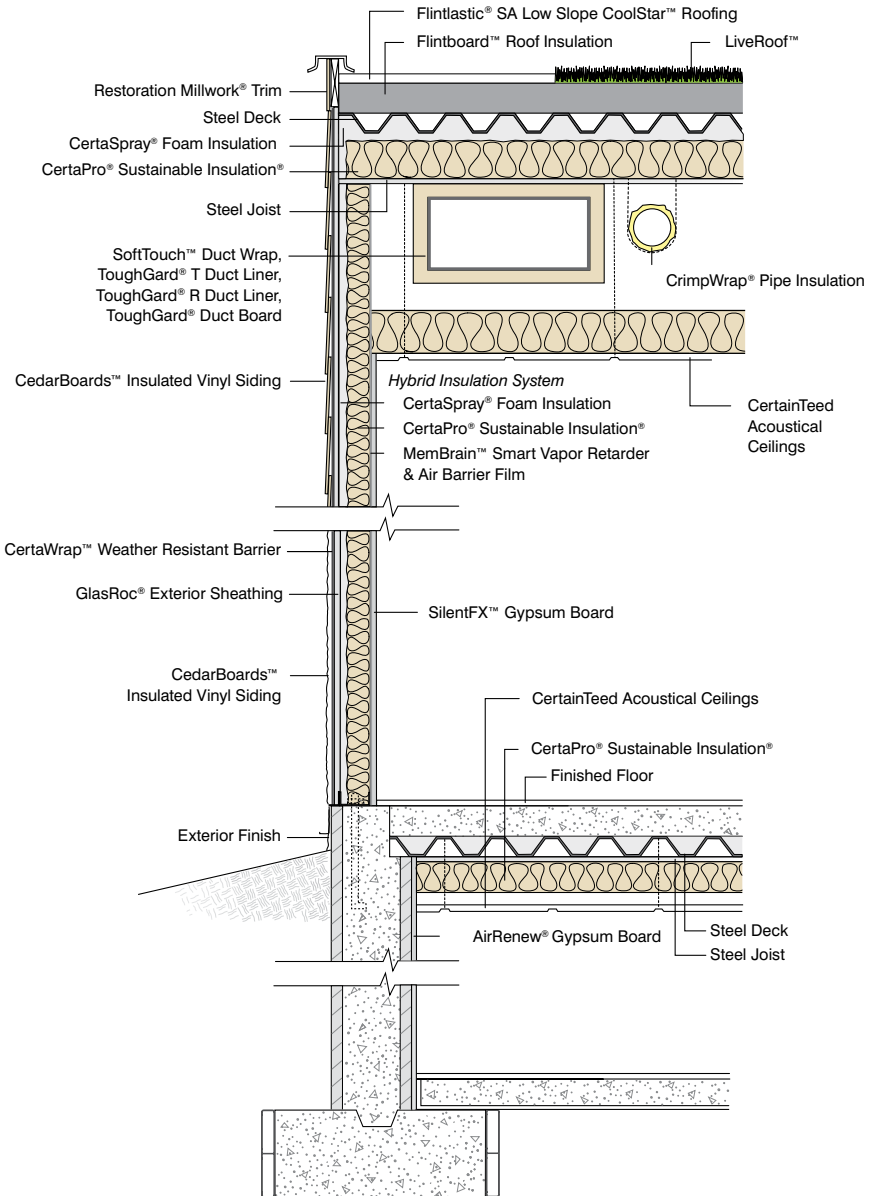

LEED for Healthcare (HC)

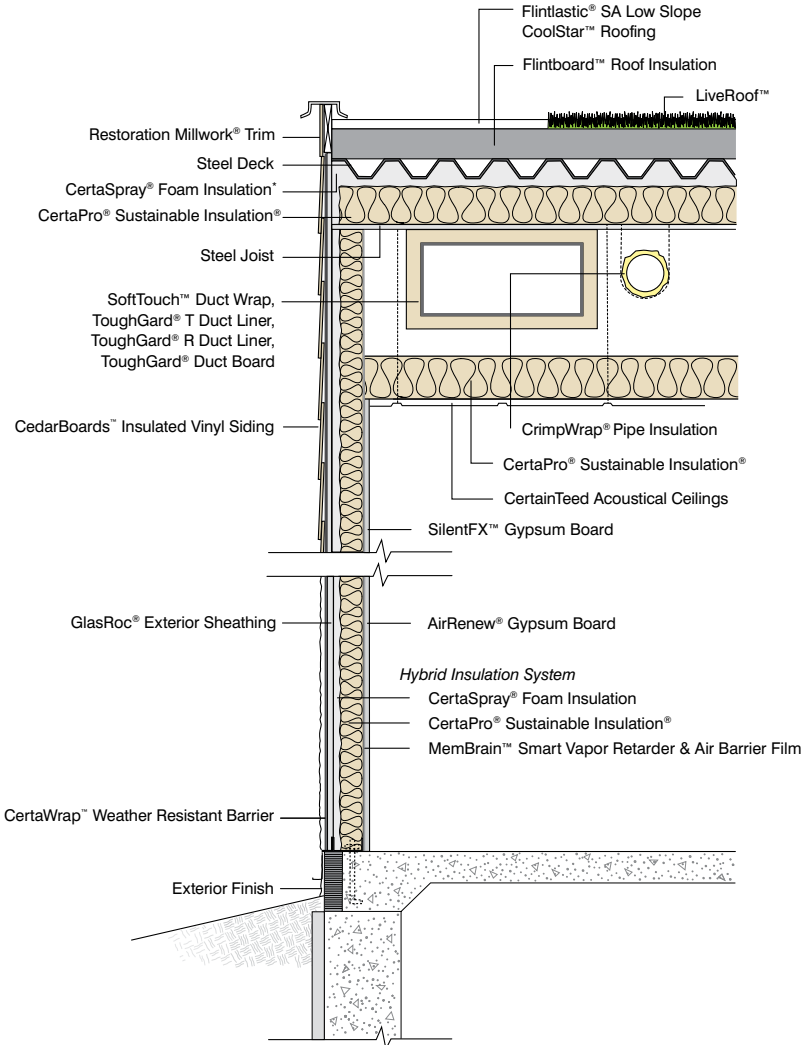

LEED for Homes (H) and LEED for Homes: Canada Advanced Design

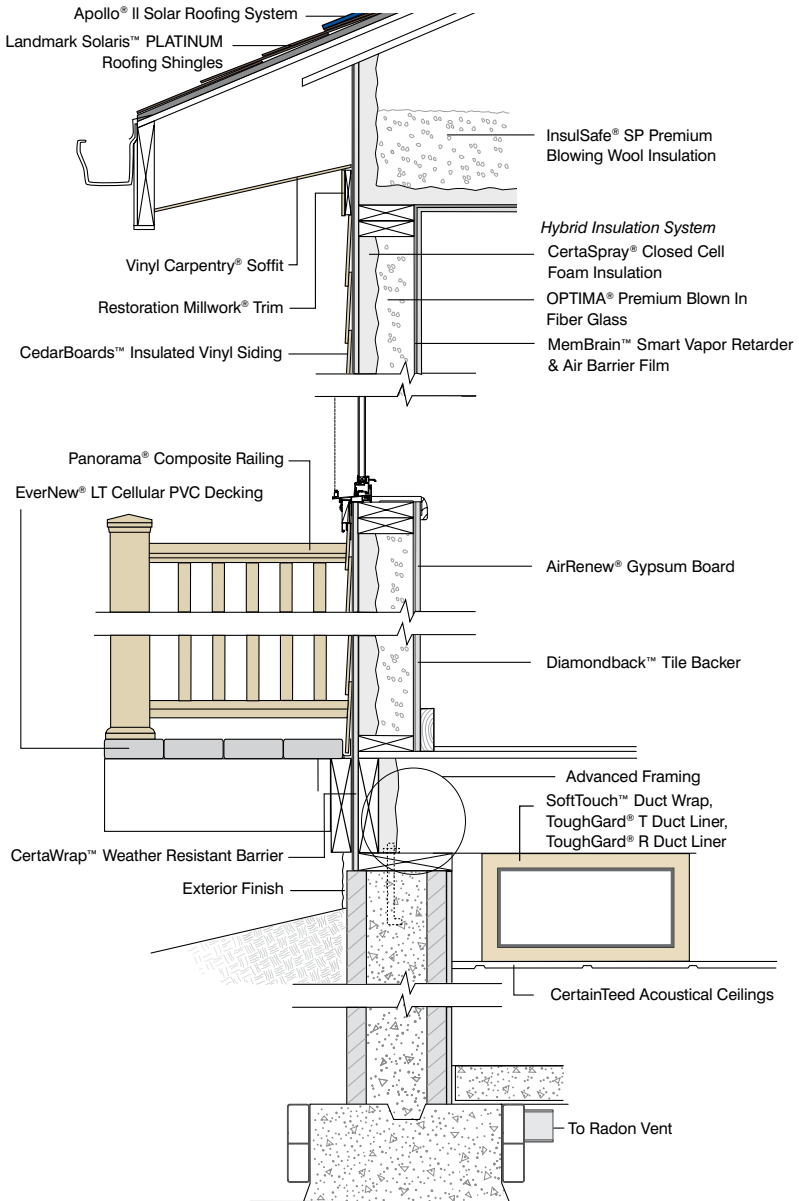

LEED for Homes (H) and LEED for Homes: Canada Standard Design

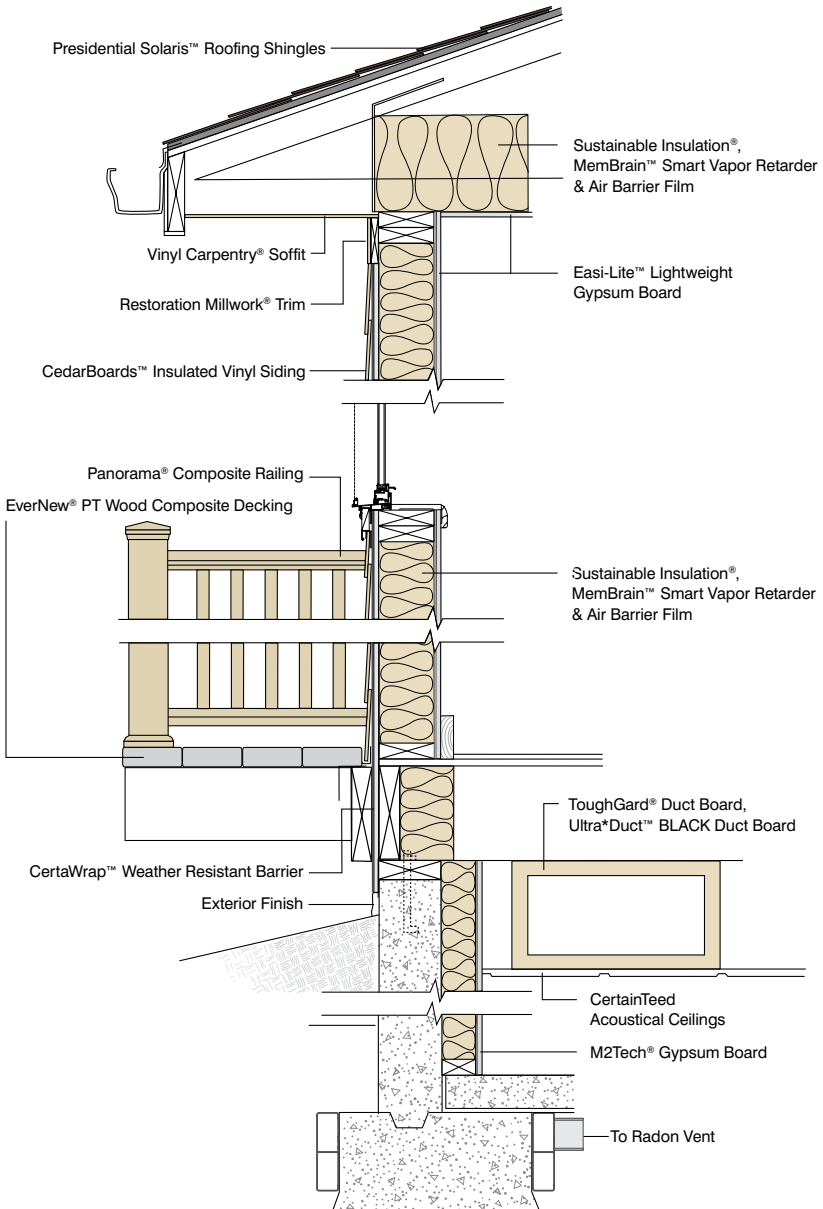

NAHB Advanced Design

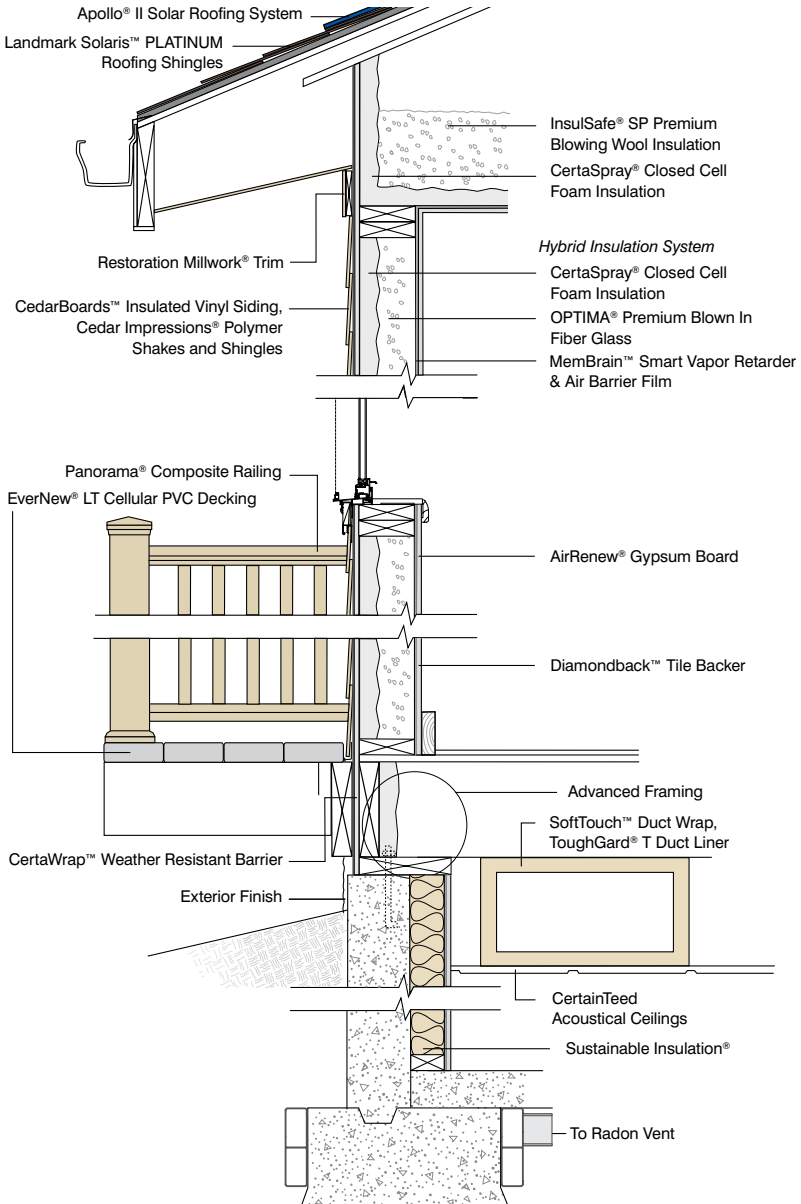

NAHB Standard Design

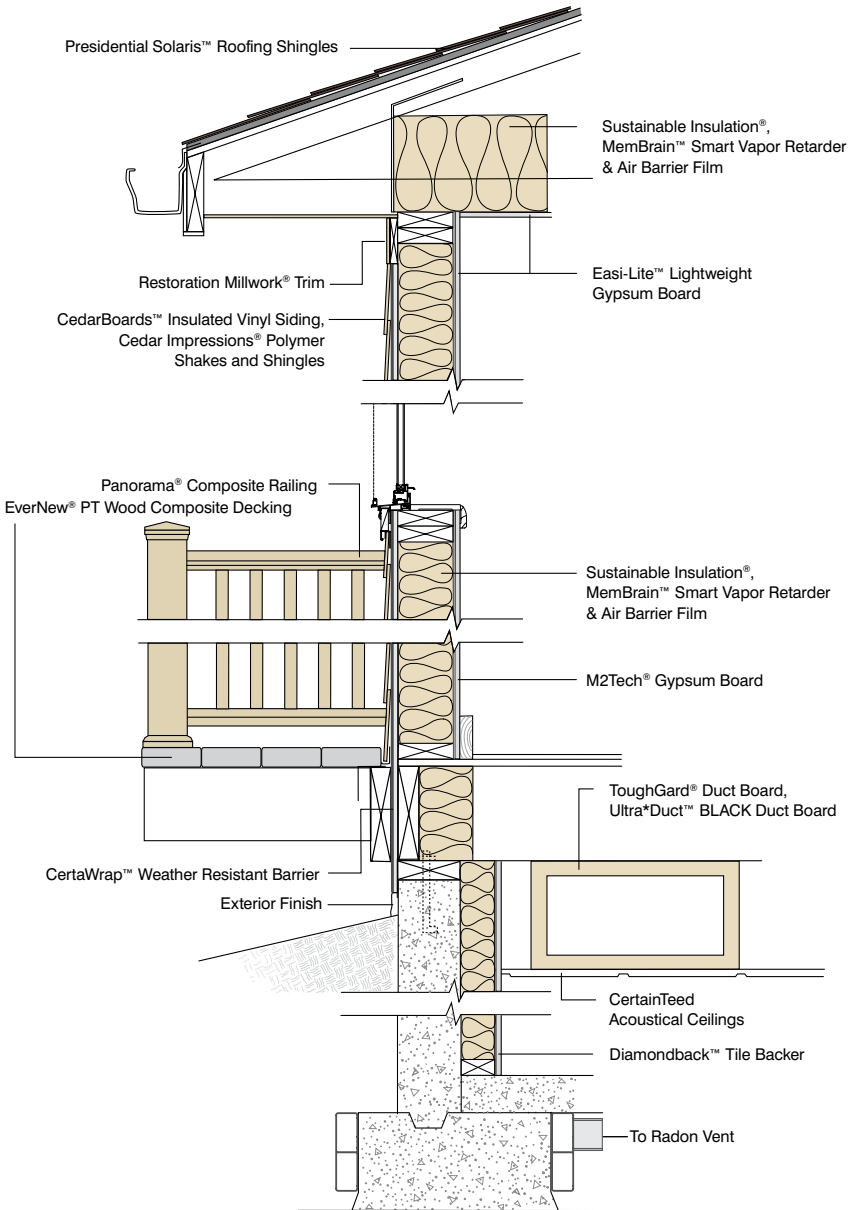

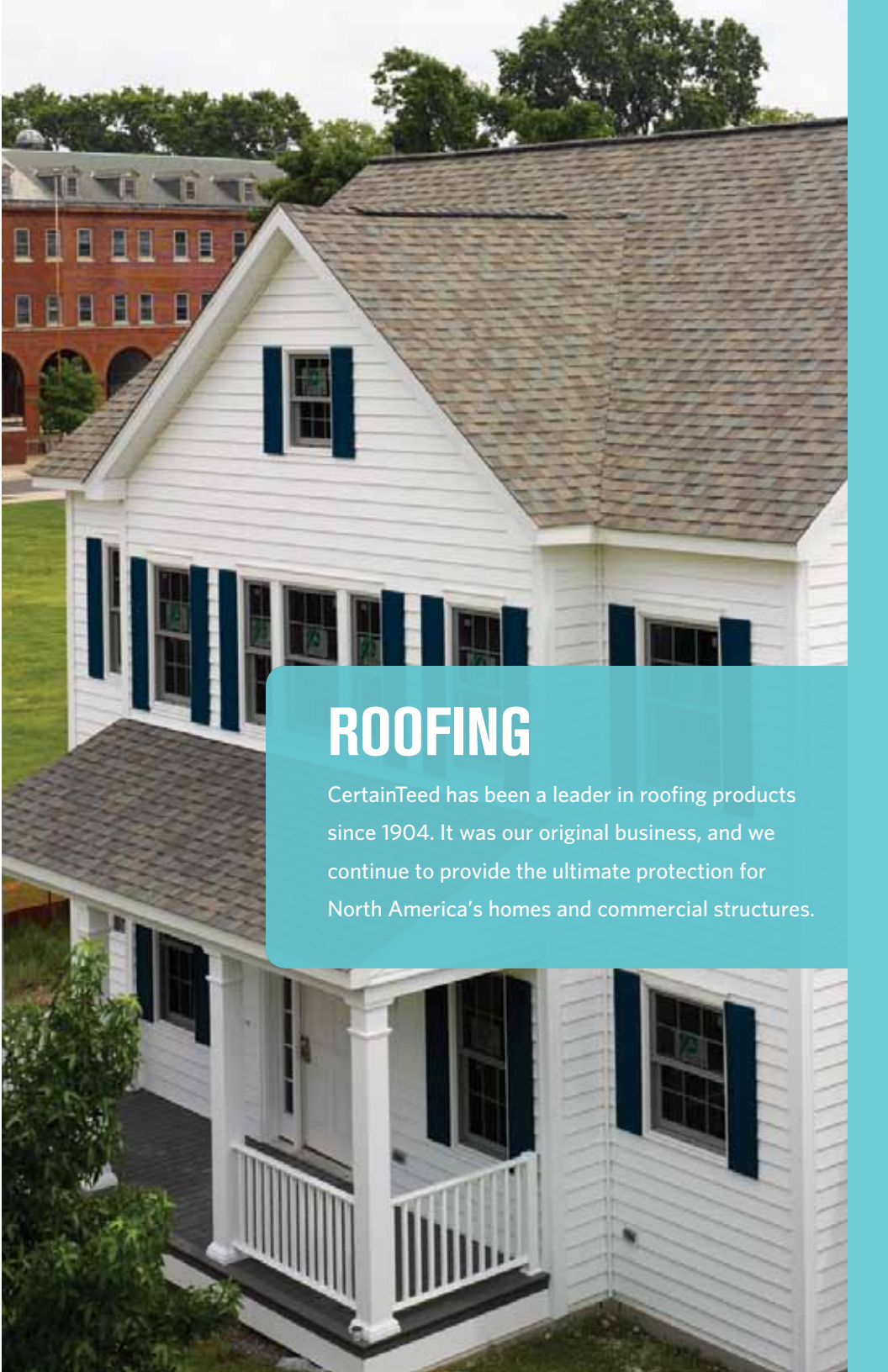

ROOFING

CertainTeed has been a leader in roofing products since 1904. It was our original business, and we continue to provide the ultimate protection for North America's homes and commercial structures.

SHINGLES

Symphony™

Symphony™ composite slate shingles are a masterpiece of synthetic slate design with enduring qualities of tooled craftsmanship, natural beauty and harmony. Symphony is a specially engineered composite roofing shingle that mimics the look and feel of natural slate, but is lighter, more durable and a fraction of the price. The Symphony product line has earned the designation of an ENERGY STAR® Qualified Product.

- UL Class A fire resistance rating (with approved underlayment)
- UL 2218 Class 4 impact resistance rating
- Passed UL testing for 110 MPH wind resistance at full 8" exposure
- ASTM D3161 wind resistance
- Superior fade-resistant (UV) surface technology
- Meets ENERGY STAR requirements for residential cool roofing
- 50-year limited transferable warranty
- 7-year SureStart™ Protection

Grand Manor™

Grand Manor™ is a top-of-the-line, architectural shingle that's best suited to larger homes with steeply pitched roofs, with virtually five-layer coverage when applied. Random tabs accented by shadow lines on the asphalt shingle with fiber glass base create a look of depth and dimension.

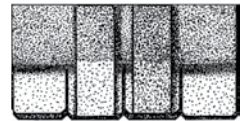

- Two-layer construction
- Five-layer coverage when applied
- UL Class A fire resistance
- UL certified to meet ASTM D3462
- UL certified to meet ASTM 3018 Type I
- UL 2218 Class 2 impact resistance rating
- ASTM D3161, Class F, 110 MPH wind resistance
- Lifetime limited transferable warranty
- 10-year SureStart™ Protection
- 15-year StreakFighter™ Protection
- 15-year 110 MPH wind resistance warranty (upgrade to 130 MPH available). CertainTeed starter and CertainTeed hip and ridge required
- Available nationwide

Carriage House™

Carriage House™ features premium performance and aesthetics. Unique, scalloped edges give the appearance of hand craftsmanship. Beautiful shadow lines provide unparalleled depth and richness. This product is perfect for a one-of-a-kind home featuring a steeply pitched roof.



- Two-layer construction
- Four-layer coverage when applied
- UL Class A fire resistance
- UL certified to meet ASTM D3462
- UL certified to meet ASTM 3018 Type I
- UL 2218 Class 1 impact resistance rating
- ASTM D3161, Class F, 110 MPH wind resistance
- Lifetime limited transferable warranty
- 10-year SureStart™ Protection
- 15-year StreakFighter™ Protection
- 15-year 110 MPH wind resistance warranty (upgrade to 130 MPH available). CertainTeed starter and CertainTeed hip and ridge required
- Available nationwide

Presidential Shake™ TL (Triple Laminate)

Presidential Shake™ TL, with its sculpted rustic edges, is constructed using three laminated layers of the industry's strongest, most durable materials, making it one of the thickest, toughest and best-looking shingles on the market. The beauty of a wood shake with less cost and better performance.



- Tri-laminate technology
- UL Class A fire resistance
- UL certified to meet ASTM D3462
- UL certified to meet ASTM 3018 Type I
- ASTM D3161, Class F, 110 MPH wind resistance
- Lifetime limited transferable warranty
- 10-year SureStart™ Protection
- 15-year StreakFighter™ Protection (except in CA)
- 15-year 110 MPH wind resistance warranty (upgrade to 130 MPH available). CertainTeed starter and CertainTeed hip and ridge required
- Available nationwide

Landmark™ TL (Triple Laminate)

Landmark™ TL is constructed using three laminated layers of the industry's most durable materials, providing a dramatically thick roofing product styled with the classic appeal of wood shakes.

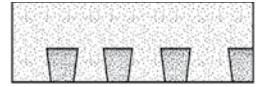

- Tri-laminate technology
- UL Class A fire resistance
- UL certified to meet ASTM D3462
- UL certified to meet ASTM 3018 Type I
- ASTM D3161, Class F, 110 MPH wind resistance
- Lifetime limited transferable warranty
- 10-year SureStart™ Protection
- 15-year StreakFighter™ Protection (except in CA)
- 15-year 110 MPH wind resistance warranty (upgrade to 130 MPH available). CertainTeed starter and CertainTeed hip and ridge required
- Available nationwide

Presidential Shake™

The real beauty of Presidential Shake™ is its unique sculptured tab, providing the distinct styling, depth and dimension of wood shakes. Constructed using two laminated layers of the industry's strongest, most durable roofing materials.



- 2-piece laminate with sculptured tabs
- UL Class A fire resistance
- UL certified to meet ASTM D3462
- UL certified to meet ASTM 3018 Type I
- ASTM D3161, Class F, 110 MPH wind resistance
- Lifetime limited transferable warranty
- 10-year SureStart™ Protection
- 15-year StreakFighter™ Protection available in some selling areas
- 15-year 110 MPH wind resistance warranty (upgrade to 130 MPH available). CertainTeed starter and CertainTeed hip and ridge required
- Available nationwide
- Impact resistant version available in select areas

Highland Slate™

CertainTeed's Highland Slate™ has the look, texture and tone of natural slate with a dark shadow line to accentuate its appeal from the curb. Each tab is individually colored by state-of-the-art Precision Color technology to provide a rich, deep hue and its four-across tab is the ideal design to deliver color, contrast and perfection when installed.



- Single-layer construction
- UL Class A fire resistance
- UL certified to meet ASTM 3018 Type I
- ASTM D3161, Class F, 110 MPH wind resistance
- Lifetime limited transferable warranty
- 10-year SureStart™ Protection
- 15-year StreakFighter™ Protection
- 15-year 110 MPH wind resistance warranty (upgrade to 130 MPH available). CertainTeed starter and CertainTeed hip and ridge required
- Available nationwide
- Impact resistant version available in select areas

Independence™

Independence™ captures the depth of wood shakes and the look of slate. Random laminated tabs and a smooth surface blend to create the look of both classic roofing styles.



- Random laminated tabs
- Full-size, one-piece base shingle
- UL Class A fire resistance
- UL certified to meet ASTM D3462
- UL certified to meet ASTM 3018 Type I
- Lifetime limited transferable warranty
- 10-year SureStart™ Protection
- 15-year StreakFighter™ Protection
- 15-year 110 MPH wind resistance warranty (upgrade to 130 MPH available). CertainTeed starter and CertainTeed hip and ridge required

Landmark Solaris™

Landmark Solaris™ Gold

Landmark Solaris™ Platinum

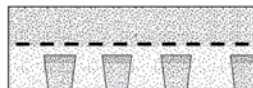

Landmark Solaris™ from CertainTeed Roofing is a brilliant energy-saving breakthrough that puts cool roof technology to work. Landmark Solaris is a steep-slope, solar reflective asphalt roofing shingle which contains advanced colored granules that reflect the sun's rays and can reduce a roof's temperature.

- Two-piece laminated fiber glass-based construction
- UL Class A fire resistance
- UL certified to meet ASTM D3462
- UL certified to meet ASTM D3018 Type I
- Conforms to CSA standard A123.5
- Meets California Title 24 requirements for reflectance and emittance
- Meets ENERGY STAR® requirements for residential cool roofing
- Lifetime limited transferable warranty
- 10-year SureStart™ Protection
- 15-year StreakFighter™ Protection
- 15-year 110 MPH wind resistance warranty (upgrade to 130 MPH available). CertainTeed starter and CertainTeed hip and ridge required
- Also available in an Impact Resistant version

Landmark™ Series

The Landmark™ Series of two-piece laminated shingles features the industry's toughest fiber glass mat base. Complex color blending techniques, interspersed with shadow lines, produce a unique color selection.

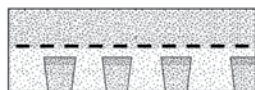

- Two-piece laminated shingle
- Fiber glass composition
- UL Class A fire resistance
- UL certified to meet ASTM D3462
- Available nationwide

Landmark™ Premium

- One of our heaviest Landmark™ products
- Maximum definition color palette
- Lifetime limited transferable warranty
- 10-year SureStart™ Protection
- 15-year StreakFighter™ Protection version available in some selling areas
- 15-year 110 MPH wind resistance warranty (upgrade to 130 MPH available). CertainTeed starter and CertainTeed hip and ridge required

Landmark™ PRO

- Maximum definition color palette
- Lifetime limited transferable warranty
- 10-year SureStart™ Protection
- 15-year StreakFighter™ Protection version available in some selling areas
- 15-year 110 MPH wind resistance warranty (upgrade to 130 MPH available). CertainTeed starter and CertainTeed hip and ridge required

Landmark™

- Lifetime limited transferable warranty
- 10-year SureStart™ Protection
- 10-year StreakFighter™ Protection version available in some selling areas
- 15-year 110 MPH wind resistance warranty (upgrade to 130 MPH available). CertainTeed starter and CertainTeed hip and ridge required

Landmark™ IR (Impact Resistant)

Landmark™ IR (Impact Resistant) shingles are built on the industry's toughest fiber glass mat base, with an even tougher fiber glass scrim reinforcement to help it achieve the highest (Class 4) impact resistance classification.

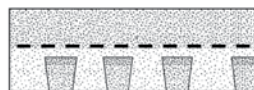

- UL 2218 Class 4 impact resistant
- UL certified to meet ASTM D3462
- Lifetime limited transferable warranty
- 10-year SureStart™ Protection
- 10-year StreakFighter™ Protection
- 15-year 110 MPH wind resistance warranty (upgrade to 130 MPH available). CertainTeed starter and CertainTeed hip and ridge required
- Available in select areas

Hatteras®

Oversized construction, an extra-heavy mat and dual self-sealing strips made with an aggressive sealant deliver superior performance.

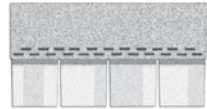

- Four-tab slate-like appearance
- Oversized (18" x 36") construction
- Extra-heavy fiber glass mat
- UL Class A fire resistance
- UL certified to meet ASTM D3462
- UL certified to meet ASTM 3018 Type I
- ASTM D3161, Class F, 110 MPH wind resistance
- Lifetime limited transferable warranty
- 10-year SureStart™ Protection
- 10-year StreakFighter™ Protection
- 15-year 110 MPH wind resistance warranty (upgrade to 130 MPH available). CertainTeed starter and CertainTeed hip and ridge required
- Dual strips of Certa-Seal™ Plus advanced modified sealant
- Available nationwide

Patriot

Patriot features intricate color blend drops combined with intermittent shadow lines offering rich, aesthetic appeal homeowners have grown to expect in quality asphalt roofing shingles. The end result provides an exceptional look at an exceptional value.

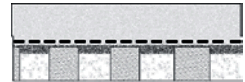

- UL Class A fire resistance
- UL certified to meet ASTM D3462
- UL certified to meet ASTM 3018 Type I
- UL certified to meet ASTM D3161, Class F, wind resistance
- UL certified to meet ASTM D7158, Class H, wind resistance
- 30-year limited transferable warranty
- 8-year SureStart™ Protection
- 10-year StreakFighter™ Protection
- 10-year 110 MPH wind resistance warranty
- Available in select areas

XT™ 30

The XT™ 30 shingle is built on a super-tough fiber glass base using even more asphalt than our popular XT™ 25 shingle to provide exceptional performance and durability — the perfect choice for light commercial and residential buildings requiring warranties of longer duration.

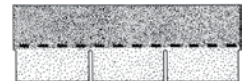

- UL Class A fire resistance
- UL certified to meet ASTM D3462
- UL certified to meet ASTM 3018 Type I
- 30-year limited transferable warranty
- 5-year SureStart™ Protection
- 10-year StreakFighter™ Protection version available in some selling areas
- 5-year 70 MPH wind resistance warranty
- Available nationwide except in the Southwest

XT™ 30 IR (Impact Resistant)

This roof is a stopper in more ways than one. Proven to withstand the impact of a 2" steel ball dropped from a height of 20', XT™ 30 Impact Resistant shingles provide exceptional performance and durability.

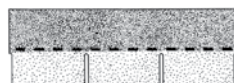

- UL Class A fire resistance
- UL certified to meet ASTM D3462
- UL 2218 Class 4 impact resistant
- 30-year limited transferable warranty
- 5-year SureStart™ Protection
- 10-year StreakFighter™ Protection
- 5-year 70 MPH wind resistance warranty
- Available in select areas

XT™ 25

XT™ 25 is an exceptionally durable three-tab asphalt shingle built on a tough fiber glass base with high tear strength rating and superior resistance to blowoffs and handling damage.

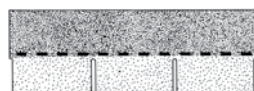

- UL Class A fire resistance
- UL certified to meet ASTM D3462
- UL certified to meet ASTM 3018 Type 1
- 25-year limited transferable warranty
- 5-year SureStart™ Protection
- 10-year StreakFighter™ Protection version available in some selling areas
- 5-year 60 MPH wind resistance warranty
- Available nationwide except in the Southwest and Northwest

CT 20

An economical three-tab asphalt strip shingle with tough fiber glass base.

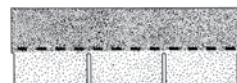

- UL Class A fire resistance
- UL certified to meet ASTM D3462
- UL certified to meet ASTM 3018 Type I
- 20-year limited transferable warranty
- 3-year SureStart™ Protection
- 5-year 60 MPH wind resistance warranty
- Limited availability

CertainTeed Ridge Vent — 12" Unfiltered

Shingle-over ridge vent

Features:

- Designed with an external baffle to deflect wind and weather over the vent to help protect the attic from rain and snow infiltration. The external baffle creates low pressure over the vent openings to "pull" air from the attic
- 18" sq. of net free area per linear foot
- CertainTeed Ridge Vent is pre-formed to a 4/12 pitch, and fits pitches from 3/12 to 16/12
- Lifetime limited warranty and 5-year SureStart™ Protection
- CertainTeed Ridge Vent comes with thirty 3" ring shank, galvanized roofing nails bagged and taped to each 4' piece inside the carton
- Ten 4' pieces per box
- Weight: 24 lbs.
- Color: Black

Benefits:

- Works year-round to ventilate the attic
- Provides evenly distributed ventilation along the entire underside of the roof
- Slim design for visual appeal
- Provides a higher volume of airflow per square foot of attic area than any other fixed-vent system
- Design maximizes airflow across the entire underside of roof sheathing
- Changes in wind direction have no significant effect on vent performance
- Wind-driven rain resistant to 110 MPH
- UL Classified, Miami-Dade approved

CertainTeed Ridge Vent — 12" Filtered

Shingle-over ridge vent

Features:

- Designed with internal weather filter and an external baffle to deflect wind and weather over the vent to help protect the attic from rain and snow infiltration. The external baffle creates low pressure over the vent openings to “pull” air from the attic
- 18" sq. of net free area per linear foot
- CertainTeed Ridge Vent is pre-formed to a 4/12 pitch, and fits pitches from 3/12 to 16/12
- Lifetime limited warranty and 5-year SureStart™ Protection
- Easy installation – has pre-printed slot guides for truss or ridge pole construction. Pre-drilled nail holes are designed to assure proper nailing
- Ten 4' pieces per box
- Weight: 18 lbs.
- Color: Black

Benefits:

- Works year-round to ventilate the attic
- Weather filter provides advanced protection from rain, snow, dust and insect intrusion
- Provides evenly distributed ventilation along the entire underside of the roof
- Slim design for visual appeal
- Provides a higher volume of airflow per square foot of attic area than any other fixed-vent system
- Design maximizes airflow across the entire underside of roof sheathing
- Changes in wind direction have no significant effect on vent performance
- Wind-driven rain resistant to 110 MPH
- UL Classified, Miami-Dade approved

CertainTeed Ridge Vent — 9" Filtered

Shingle-over ridge vent

Features:

- Designed with an external baffle to deflect wind and weather over the vent to help protect the attic from rain and snow infiltration. The external baffle creates low pressure over the vent openings to "pull" air from the attic
- Internal weather filter provides a more complete barrier to help protect the attic from wind-driven rain, snow, dust and insects
- Easy installation – has pre-printed slot guides for truss or ridge pole construction. Pre-drilled nail holes are designed to assure proper nailing
- 16" sq. of net free area per linear foot
- CertainTeed Ridge Vent is pre-formed to a 4/12 pitch, and fits pitches from 3/12 to 12/12
- Lifetime limited warranty and 5-year SureStart™ Protection
- Ten 4' pieces per box
- Weight: 19 lbs.
- Color: Charcoal

Benefits:

- Works year-round to ventilate the attic
- Provides evenly distributed ventilation along the entire underside of the roof
- Slim design for visual appeal
- Provides a higher volume of airflow per square foot of attic area than any other fixed-vent system
- Design maximizes airflow across the entire underside of roof sheathing
- Changes in wind direction have no significant effect on vent performance
- Miami-Dade approved

CertainTeed Ridge Vent — 9" and 7" Filtered Class A Fire-Rated

Shingle-over ridge vent

Features:

- Designed with an external baffle to deflect wind and weather over the vent to help protect the attic from rain and snow infiltration. The external baffle creates low pressure over the vent openings to “pull” air from the attic
- Internal weather filter provides a more complete barrier to help protect the attic from wind-driven rain, snow, dust and insects
- Easy installation - has pre-printed slot guides for truss or ridge pole construction. Pre-drilled nail holes are designed to assure proper nailing
- 16" sq. of net free area per linear foot
- CertainTeed Ridge Vent is pre-formed to a 4/12 pitch, and fits pitches from 3/12 to 12/12
- Lifetime limited warranty and 5-year SureStart™ Protection
- Ten 4' pieces per box
- Weight 19 lbs.
- Color: Charcoal

Benefits:

- Works year-round to ventilate the attic
- Provides evenly distributed ventilation along the entire underside of the roof
- Slim design for visual appeal
- Provides a higher volume of airflow per square foot of attic area than any other fixed-vent system
- Design maximizes airflow across the entire underside of roof sheathing
- Changes in wind direction have no significant effect on vent performance
- UL Classified, Miami-Dade approved

CertainTeed Rolled Ridge Vent — Unfiltered

Unfiltered rolled ridge vent

Features:

- Designed with an external baffle to deflect wind and weather over the vent to help protect the attic from rain and snow infiltration. The external baffle creates low pressure over the vent openings to “pull” air from the attic
- Built-in ventilating weathertight end plugs flex for different roof pitches and protects roof decking
- 12" sq. net free area per linear foot
- CertainTeed Ridge Vent fits pitches from 3/12 to 12/12
- Lifetime limited warranty and 5-year SureStart™ Protection
- 28' rolls - 25 rolls per pallet
- Two coils of roofing nails are included
- Weight: 17.5 lbs.
- Color: Black

Benefits:

- Fast and easy installation - internal ribbing adds rigidity to make the vent nail gun friendly. Roll it out and nail it down
- Prevents the premature deterioration of shingles and other roofing materials caused by inadequate ventilation
- Meets typical roof shingle warranty ventilation requirements

CertainTeed Rolled Ridge Vent — Filtered

Filtered rolled ridge vent

Features:

- Designed with an external baffle to deflect wind and weather over the vent to help protect the attic from rain and snow infiltration. The external baffle creates low pressure over the vent openings to “pull” air from the attic
- Built-in ventilating weathertight end plugs flex for different roof pitches and protects roof decking
- 12" sq. net free area per linear foot
- CertainTeed Ridge Vent fits pitches from 3/12 to 12/12
- Lifetime limited warranty and 5-year SureStart™ Protection
- 28' rolls - 25 rolls per pallet
- Two coils of roofing nails are included
- Weight: 17.5 lbs.
- Color: Black

CertainTeed Rolled Ridge Vent — Filtered (continued)

Benefits:

- Fast and easy installation – internal ribbing adds rigidity to make the vent nail gun friendly: roll it out and nail it down
- Prevents the premature deterioration of shingles and other roofing materials caused by inadequate ventilation
- Meets typical roof shingle warranty ventilation requirements

CertainTeed Intake Vent

Filtered edge vent

Features:

- Designed with internal baffles and drainage system along with an internal weather filter which provides three levels of weather protection
- 9" sq. of net free area per linear foot
- CertainTeed Intake Vent has a minimum 3/12 roof pitch with no maximum
- Lifetime limited warranty and 5-year SureStart™ Protection
- 3/4" low profile helps it blend in with the roof
- Ten 4' pieces per box
- Each 4' piece has integrated end plugs on each end
- Weight: 26 lbs.
- Color: Black

Benefits:

- Easily installs on the roof's edge
- Roof-top installation eliminates overhead with soffits and undereaves
- Located tabs on the underside of the CertainTeed Intake Vent assist with positioning the vent over the slot
- Co-polymer construction

WinterGuard™ Waterproofing Underlayment

WinterGuard™ products are most commonly used in critical areas such as roof eaves, valleys and as a waterproofing underlayment for low-slope shingle, metal, slate and tile roofing applications. WinterGuard HT (High Tack, High Temperature) is an advanced waterproofing underlayment for shingle, metal, slate and tile roofs. It is specially formulated to resist high roof temperatures under metal roofs. WinterGuard Sand and Granular underlayments are designed for use on roof decks as a waterproofing barrier beneath shingle, slate and tile roofs to prevent leakage due to water backup from ice dams or wind-driven rain.

Problem: When snow and ice melt, trapped water can infiltrate to damage the roof deck and building interior.

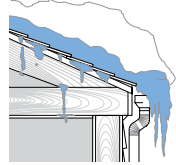

Solution: WinterGuard is installed under shingled roofing to prevent water damage from ice dams, as well as wind-driven rain.

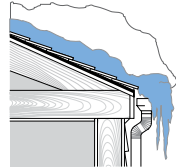

- Roll dimensions: 3' x 65'
- Meets ASTM D1970

Roofers' Select™

Roofers' Select™ is a high-performance, fiber glass-reinforced underlayment that is heavier, stronger and less likely to wrinkle than typical No. 15 organic felt underlayments. It is recommended for residential shingle applications and is a great alternative to #15 and #30 organic felt.

Cedar Crest™

- Three-layer design
- Dimensions (overall): 12" x 36"
- Divides into three 12" x 12" pieces
- 8" exposure
- Covers 20 linear feet/bundle
- Colors match CertainTeed Presidential Shake™, Presidential Shake™ TL, Highland Slate™, Hatteras®, Landmark™ and the Landmark™ TL Series

Cedar Crest™ IR

- Three-layer design
- Dimensions (overall): 12" x 36"
- Divides into three 12" x 12" pieces
- 8" exposure
- Covers 20 linear feet/bundle
- UL 2218 Class 4 impact resistant
- Colors match CertainTeed Presidential Shake™ IR, Presidential Shake™ IR, Highland Slate™ IR, and the Landmark™ IR Series

Mountain Ridge™

Mountain Ridge™ high-profile hip and ridge accessory is the perfect finishing touch for your roof with blended color and high-profile design. The difference is noticeable... by blending in.

- Fiber glass reinforced SBS modified bitumen
- Five-layer design with tri-laminate base
- Available in 8" (Southwest and Northwest region only) and 10" widths
- Colors match CertainTeed Presidential Shake™, Presidential Shake™ TL, Landmark™ and the Landmark TL™ Series
- 8" exposure

Shingle Ridge®

- Pre-cut for easy installation, with a centering notch for a no-miss side-to-side alignment
- Two full layers
- 12" x 18", with 8" exposure
- Covers 10 lineal feet per box
- Colors match Grand Manor™ and Carriage House™

Shadow Ridge™

Shadow Ridge™ Hip and Ridge Accessory Shingles are designed specifically for use with Landmark™ TL, Landmark™ Series and Independence™ shingles and are used to finish the hips and ridges of your roof.

ENGLISH

- Dimensions (overall):
12" x 36"
- 5" exposure
- Covers 30 linear feet/bundle
- Weight: 65 lbs./bundle

METRIC

- Dimensions (overall):
13-1/4" x 39-3/8"
- 5-5/8" exposure
- Covers 45 linear feet/bundle
- Weight: 80 lbs./bundle

DiamondDeck™

DiamondDeck™ is a high-performance synthetic underlayment. DiamondDeck's lightweight multi-layer construction results in a surface with superior wet and dry traction matched with excellent strength and superior tear resistance for watertight performance. UV resistant for six months of exposure.

- Roll Dimensions: 48" x 250'
- 10 squares per roll
- Weight: 38 lbs./roll
- 25 rolls/pallet
- Meets ASTM D226 and D4869 (physical properties only)

SwiftStart

CertainTeed SwiftStart metric starter shingle is designed specifically for use with CertainTeed Landmark Series shingles. Rather than cutting expensive field shingles to use as starters, you can save time and money by starting with SwiftStart.

- Code-compliant, meets minimum 2" head lap requirement for metric shingles— many competing products do not
- Each 18-piece bundle covers 116 linear ft.
- Dimensions: Each sheet measures 38-3/4" x 15-1/4" and separates into two 38-3/4" x 7-5/8" starter shingles
- Precision sealant for proper sealing at the eaves
- Works with all metric shingles that are similar to Landmark

LOW-SLOPE

SBS MODIFIED BITUMEN BASE & INTERPLY SHEETS

Flexiglas™ Base Sheet

- Standard fiber glass SBS base sheet
 - HA, CA, MF
 - 1.2 mm (48 mils) thickness
 - 90 lbs. per roll
 - 300 sq. ft. coverage
 - ASTM D4601, Type II
-

Flintlastic® Base 20

- Premium fiber glass SBS base sheet
 - HA, CA, MF
 - 2.3 mm (92 mils) thickness
 - 90 lbs. per roll
 - 150 sq. ft. coverage
 - ASTM D6163, Grade S, Type I
 - ASTM D4601, Type II
-

Flintlastic® Base 20 T

- Premium SBS modified bitumen, coated fiber glass base sheet
 - TA, MF
 - 3.0 mm (120 mils) thickness
 - 81 lbs. per roll
 - 100 sq. ft. coverage
 - ASTM D6163, Grade S, Type I
 - ASTM D4601, Type II
-

Flintlastic® Poly SMS™ Base Sheet

- Standard polyester SBS base sheet
 - HA, CA, MF
 - 2.0 mm (80 mils) thickness
 - 90 lbs. per roll
 - 200 sq. ft. coverage
 - ASTM D4601, Type II
-

Flintlastic® Ultra Poly SMS™ Base Sheet

- Premium, heavy weight polyester SBS base sheet
- HA, CA, MF
- 3.7 mm (148 mils) thickness
- 90 lbs. per roll
- 100 sq. ft. coverage
- ASTM D6164, Grade S, Type I

Black Diamond™ Base Sheet

- Heat-activated, self-adhesive, SBS, fiber glass base sheet (for noncombustible decks) or mid-ply with fine particle surfacing
- SA
- 1.5 mm (60 mils) thickness
- 78 lbs. per roll
- 200 sq. ft. coverage
- ASTM D1970

All Weather Empire™ Base Sheet

- Fiber glass reinforced, SBS base sheet
- MF, HA, CA
- 1.8 mm (70 mils) thickness
- 70 lbs. per roll
- 200 sq. ft. coverage
- ASTM D4601, Type II

Metalayment™

- Self-adhesive, SBS, fiber glass underlayment for use beneath metal, mechanically fastened tile & shingles
- SA
- 1.5 mm (60 mils) thickness
- 54 lbs. per roll
- 200 sq. ft.
- ASTM D1970

Flintlastic® Ultra Glass SA

- Self-adhesive, SBS, fiber glass base sheet for noncombustible decks or mid-ply with sand surfacing
- SA
- 3.0 mm (120 mils) thickness
- 73 lbs. per roll
- 100 sq. ft. coverage
- ASTM D6163, Grade S, Type I
- ASTM D1970

Flintlastic® SA NailBase

- Fiber glass reinforced, nailable SBS base sheet with unique top film designed exclusively for use with self-adhering membrane systems
- MF, HA
- 1.5 mm (60 mils) thickness
- 82 lbs. per roll
- 200 sq. ft. coverage
- ASTM D4601, Type II

Flintlastic® SA PlyBase

- Fiber glass reinforced, self-adhering SBS base or interply membrane with a unique top film designed exclusively for use with self-adhering membranes
- SA
- 1.5 mm (60 mils) thickness
- 86 lbs. per roll
- 200 sq. ft. coverage
- ASTM D4601, Type II
- ASTM D1970

Flintlastic® SA Mid Ply

- Polyester/fiber glass scrim reinforced, self-adhering SBS mid ply membrane with a unique top film designed exclusively for use with self-adhering cap sheet
- SA
- 3.0 mm (120 mils) thickness
- 62 lbs. per roll
- 100 sq. ft. coverage
- ASTM D6163, Grade S, Type I
- ASTM D1970

SBS MODIFIED BITUMEN CAP SHEETS

Flintlastic® FR Cap 30

- Fiberglass reinforced, SBS, mineral surfaced cap sheet
- HA, CA
- 3.5 mm (140 mils) thickness
- 87 lbs. per roll
- 100 sq. ft. coverage
- ASTM D6163, Grade G, Type I

Flintlastic® FR Cap 30 CoolStar™

- Mineral surfaced, fire resistant, SBS modified bitumen fiber glass cap sheet with reflective CoolStar™ granules
- HA, CA
- 3.5 mm (140 mils) thickness
- 88 lbs. per roll
- 100 sq. ft. coverage
- ASTM D6163, Grade G, Type I
- ENERGY STAR® labeled product

Flintlastic® FR Cap 30 T

- Mineral surfaced, fire resistant, SBS modified bitumen fiber glass cap sheet
- TA
- 4.0 mm (160 mils) thickness
- 100 lbs. per roll
- 100 sq. ft. coverage
- ASTM D6163, Grade G, Type I

Flintlastic® FR Cap 30 T CoolStar™

- Mineral surfaced, fire resistant, SBS modified bitumen fiber glass cap sheet with reflective CoolStar™ granules
 - TA
 - 4.0 mm (160 mils) thickness
 - 102 lbs. per roll
 - 100 sq. ft. coverage
 - ASTM D6163, Grade G, Type I
 - ENERGY STAR® labeled product
-

Flintlastic® FR-P

- Standard polyester, SBS, mineral surfaced cap sheet, fire resistant
 - HA, CA
 - 4.2 mm (168 mils) thickness
 - 101 lbs. per roll
 - 100 sq. ft. coverage
 - ASTM D6164, Grade G, Type I
-

Flintlastic® FR-P CoolStar™

- Standard polyester, SBS, fire resistant mineral surfaced cap sheet with reflective CoolStar™ granules
 - HA, CA
 - 4.2 mm (168 mils) thickness
 - 103 lbs. per roll
 - 100 sq. ft. coverage
 - ASTM D6164, Grade G, Type I
 - ENERGY STAR® labeled product
-

Flintlastic® Premium FR-P

- Premium, heavier weight polyester, SBS, mineral surfaced cap sheet, fire resistant
 - HA, CA
 - 4.2 mm (168 mils) thickness
 - 101 lbs. per roll
 - 100 sq. ft. coverage
 - ASTM D6164, Grade G, Type II
-

Flintlastic® Premium FR-P CoolStar™

- Premium, fire-resistant, SBS modified, heavy polyester mineral surfaced cap sheet with reflective CoolStar™ granules
 - HA, CA
 - 4.2 mm (168 mils) thickness
 - 103 lbs. per roll
 - 100 sq. ft. coverage
 - ASTM D6164, Grade G, Type II
 - ENERGY STAR® labeled product
-

Flintlastic® FR Dual Cap

- Fire-resistant, SBS modified fiberglass/polyester composite reinforcement
 - HA, CA
 - 4.3 mm (169 mils) thickness
 - 103 lbs. per roll
 - 100 sq. ft. coverage
 - ASTM D6162, Grade G, Type I
-

Flintlastic® FR Dual Cap CoolStar™

- Fire-resistant, SBS modified fiberglass/polyester composite reinforced, mineral surfaced cap sheet with reflective CoolStar™ granules
- HA, CA
- 4.3 mm (169 mils) thickness
- 105 lbs. per roll
- 100 sq. ft. coverage
- ASTM D6162, Grade G, Type I

Flintlastic® GMS

- Mineral surfaced, SBS, polyester cap sheet
- HA, CA
- 4.0 mm (160 mils) thickness
- 94 lbs. per roll
- 100 sq. ft. coverage
- ASTM D6164, Grade G, Type I

Flintlastic® GMS CoolStar™

- SBS modified bitumen roll roofing with reflectant CoolStar™ granules
- HA, CA
- 4.0 mm (160 mils) thickness
- 97 lbs. per roll
- 100 sq. ft. coverage
- ASTM D6164, Grade G, Type I
- ENERGY STAR® labeled product

Flintlastic® GTS- FR

- Premium mineral surfaced, polyester, SBS cap sheet for torch application
- TA
- 4.0 mm (160 mils) thickness
- 103 lbs. per roll
- 100 sq. ft. coverage
- ASTM D6164, Grade G, Type II

Flintlastic® GTS- FR CoolStar™

- Premium mineral surfaced, polyester, SBS cap sheet for torch application
- TA
- 4.0 mm (160 mils) thickness
- 105 lbs. per roll
- 100 sq. ft. coverage
- ENERGY STAR® labeled product

Flintlastic® SA Cap

- Polyester/fiber glass scrim reinforced SBS self-adhering cap sheet, mineral surfaced in a variety of colors. For use over Flintlastic SA NailBase or SA PlyBase and/or Flintlastic SA Mid Ply.
- SA
- 4.0 mm (160 mils) thickness
- 95 lbs. per roll
- 100 sq. ft. coverage
- ASTM D6164, Grade G, Type I
- ASTM D7505

Flintlastic® SA Cap CoolStar™

- Self-adhering SBS modified, polyester/fiber glass scrim combination mat reinforced cap sheet with reflective CoolStar™ granules
- SA
- 4.0mm (160 mils) thickness
- 98 lbs. per roll
- 100 sq. ft. coverage
- ASTM D6164, Grade G, Type I
- ASTM D7505
- ENERGY STAR® labeled product

Flintlastic® SA Cap FR

- Heavy-duty fiberglass reinforced SBS self-adhering cap sheet, fire resistant, mineral surfaced. Fire resistant. For use over Flintlastic, Flintlastic SA, NailBase or SA PlyBase and/or Flintlastic SA Mid Ply
- SA
- 3.2 mm (125 mils) thickness
- 88 lbs. per roll
- 100 sq. ft. coverage
- ASTM D6163, Grade G, Type I, UL 2218 Class 4
- ASTM D7530

Flintlastic® SA Cap FR CoolStar™

- Self-adhering, fire-resistant, SBS modified, heavy-duty fiberglass mat reinforced, mineral surfaced cap sheet with reflective CoolStar™ granules
- SA
- 3.2 mm (125 mils) thickness
- 90 lbs. per roll
- 100 sq. ft. coverage
- ASTM D6163 Grade G Type I, UL 2218, Class 4
- ASTM D7530
- ENERGY STAR® labeled product

BUR (BUILT-UP ROOFING) BASE SHEETS

Glasbase™ Base Sheet

- Standard fiber glass base sheet
- MF, HA, CA
- 1.0 mm (40 mils) thickness
- 75 lbs. per roll
- 300 sq. ft. coverage
- ASTM D4601, Type II, UL Type G2

Yosemite® Venting Base Sheet

- Heavy duty fiber glass base sheet with embossed “channels” for venting moisture
- MF, HA
- 2.8 mm (110 mils) thickness
- 85 lbs. per roll
- 100 sq. ft. coverage
- ASTM D3909
- ASTM D4897 Type II, UL Type G3

BUR (BUILT-UP ROOFING) INTERPLY SHEETS

Flintglas® Ply Sheet Type 4

- Standard fiber glass ply sheet
- HA, CA
- 0.6 mm (24 mils) thickness
- 38 lbs. per roll
- 500 sq. ft. coverage
- ASTM D2178, Type IV, UL Type G1

Flintglas® Premium Ply Sheet Type 6

- Premium fiber glass ply sheet
- HA, CA
- 0.8 mm (32 mils) thickness
- 40 lbs. per roll
- 500 sq. ft. coverage
- ASTM D2178, Type VI, UL Type G1

BUR (BUILT-UP ROOFING) CAP SHEETS

Flintglas® Mineral Surfaced Cap Sheet

- Fiber glass cap sheet
- HA, CA
- 3.0 mm (120 mils) thickness
- 78 lbs. per roll
- 100 sq. ft. coverage
- ASTM D3909, UL Type G3

Flintglas® Cap Sheet CoolStar™

- Mineral surfaced fiber glass cap sheet with reflectant CoolStar™ granules
- HA, CA
- 3.0 mm (120 mils) thickness
- 80 lbs. per roll
- 100 sq. ft. coverage
- ASTM D3909
- ENERGY STAR® labeled product

APP MODIFIED BITUMEN BASE/INTERPLY SHEETS

Flintlastic® APP Base T

- Standard smooth surfaced, fiber glass, reinforced APP
- TA
- 2.0 mm (80 mils) thickness
- 100 lbs. per roll
- 200 sq. ft. coverage
- ASTM D6509

Flintlastic® STA

- Standard smooth surfaced, polyester, APP
- TA
- 4.0 mm (160 mils) thickness
- 87 lbs. per roll
- 100 sq. ft. coverage
- ASTM D6222, Grade S, Type I

APP MODIFIED BITUMEN CAP SHEETS

Flintlastic® STA

- Standard smooth surfaced, polyester, APP cap sheet
 - TA
 - 4.0 mm (160 mils) thickness
 - 87 lbs. per roll
 - 100 sq. ft. coverage
 - ASTM D6222, Grade S, Type I
-

Flintlastic® GTA™

- Standard, polyester, mineral surfaced APP cap sheet
 - TA
 - 4.2 mm (168 mils) thickness
 - 105 lbs. per roll
 - 100 sq. ft. coverage
 - ASTM D6222, Grade G, Type I
-

Flintlastic® GTA™ CoolStar™

- APP modified bitumen roll roofing with reflective CoolStar™ granules
 - TA
 - 4.2 mm (168 mils) thickness
 - 106 lbs. per roll
 - 100 sq. ft. coverage
 - ASTM D6222, Grade G, Type I
 - ENERGY STAR® labeled product
-

Flintlastic® GTA-FR™

- Polyester, mineral surfaced APP cap sheet with fire retardant additives
- TA
- 4.2 mm (168 mils) thickness
- 105 lbs. per roll
- 100 sq. ft. coverage
- ASTM D6222, Grade G, Type I

Flintlastic® GTA-FR™ CoolStar™

- Mineral surfaced fire resistant, APP modified bitumen roll roofing with reflective CoolStar™ granules
- TA
- 4.2 mm (168 mils) thickness
- 106 lbs. per roll
- 100 sq. ft. coverage
- ASTM D6222, Grade G, Type I
- ENERGY STAR® labeled product

COATINGS/ADHESIVES/PRIMERS

FlintBond®

FlintBond® SBS Modified Bitumen Adhesive is a cold applied, high strength SBS polymer modified asphalt adhesive that provides excellent adhesion and elongation properties. Used to adhere SBS and selected BUR roof membranes. Available in Brush Grade, Trowel Grade and Caulk Grade.

- UL Listed
- Excellent cure
- Tough, flexible, adhesive and cohesive film
- Excellent water and weather resistance
- Outstanding general adhesive
- Excellent lap cement
- Good U.V. resistance
- Easy to apply
- Asbestos-free
- Elastomeric, flexible, withstands stress
- ASTM D3019, Type III



FlintCoat™ -A 150

FlintCoat™ -A 150 Fibered Aluminum Roof Coating is made of selected asphalts and pigment flakes of pure aluminum, blended with mineral fibers and refined solvents for heavy duty performance capability.

- Self-protecting: the aluminum flakes protect the coating's asphaltic oils
- Reflects over 60% of the sun's rays
- Prolongs roof life; helps protect roof membrane from U.V. degradation
- Helps reduce energy consumption costs by keeping building interiors cooler
- Easy to apply
- ASTM D2824, Type III

FlintCoat™ -A 300

FlintCoat™ -A 300 is a premium fibered aluminum roof coating made of selected asphalts and pigment flakes of pure aluminum, blended with mineral fibers and refined solvents for heavy duty performance capability.

- Self-protecting: the aluminum shield protects the base coating's asphaltic oils; coating stays resilient
- Reflects over 65% of the sun's rays
- Prolongs roof life; helps protect roof membrane from U.V. degradation
- Helps reduce energy consumption costs by keeping building interiors cooler
- Non-asbestos
- ENERGY STAR® labeled product
- 3 lbs. plus aluminum pigment content
- Asbestos-free
- ASTM D2824, Type II
- ASTM D3805

FlintCoat™ -E

FlintCoat™-E Emulsion Roof Coating is manufactured with refined asphalt, bentonite clay, emulsifiers and fibers for brush or spray application on smooth surface and metal roofs. It is used wherever cold emulsion is specified and as a base coat under aluminum and acrylic top coatings.

- Odorless
- Dries to a durable, flexible finish
- Excellent adhesion over clean asphalt surfaces
- Outstanding water and water vapor resistance
- Adds to the service life of reflective coatings when used as a primer
- ASTM D1227, Type II, Class I

FlintCoat™ -W

FlintCoat™-W is a white, copolymer elastomeric emulsion exterior protective coating. FlintCoat-W provides excellent protection, appearance, mildew resistance, color stability, weatherability and flexibility.

- Cures within 24-48 hours
- Dries to a tough, flexible elastic film
- Excellent adhesion over clean primed surfaces
- Outstanding U.V. protection; reflects min. 85% of the sun's rays
- Excellent weather resistance
- Good resistance to salts and alkalis
- ENERGY STAR® labeled
- ASTM 6083

FlintPatch™

FlintPatch™ Flashing Cement is an asbestos-free flashing cement, compounded with a carefully formulated blend of rubber-reinforced asphalt, mineral fibers, and refined solvents. FlintPatch is available in three consistencies: Summer, Semi and Winter.

- Use in wet or dry conditions
- Excellent low temperature flexibility
- SBS additive for long-term flexibility
- Resists shrinkage and cracking
- Outstanding adhesion to vertical and horizontal surfaces
- Excellent lap cement
- Good U.V. resistance
- Easy to apply; smooth consistency
- Asbestos-free
- Elastomeric, flexible; withstands stress
- ASTM D4586, Type I
- ASTM D3409

FlintPrime™ SA

FlintPrime™ SA is a water-based polymer modified primer for use with self-adhering modified bitumen roofing membrane systems such as Flintlastic SA.

- Applies easily
- Quick drying
- Promotes adhesion
- Excellent coverage at 1/5 to 1/4 gallon per 100 sq. ft.
- No need to mix
- Blue color eliminates possibility of bare spots
- VOC compliant

FlintPrime™

FlintPrime™ Asphalt Primer is a general purpose, penetration asphalt primer used for the preparation of all types of surfaces prior to the application of hot or cold asphalt coatings.

- Suitable for a variety of substrates
- Promotes adhesion
- Excellent coverage at 1/2 to 1 gallon per 100 sq. ft.
- No need to mix
- ASTM D41

ROOFING INSULATION AND FASTENERS

FlintBoard™ roof insulation products from CertainTeed are proven, energy-efficient systems available in a variety of thicknesses. FlintBoard reduces energy demands and is compatible with most roofing membranes. FlintFast™ fasteners and plates are designed and manufactured of high-quality materials to meet the toughest roofing demands.

FlintBoard™ ISO

- Polyisocyanurate roof insulation featuring a closed-cell polyiso core laminated to heavy, black (non-asphaltic) fiber-reinforced felt facers
- Marked on one side for hot asphalt applications; unmarked side for single-ply membrane applications
- Ideal for hybrid BUR and modified bitumen roof system applications
- ASTM C1289, Type II
- Available in 4' x 4' and 4' x 8' boards

FlintBoard™ ISO-T

- FlintBoard™ ISO with a tapered design to promote positive drainage
- ASTM C1289, Type II
- Available in 4' x 4' boards

FlintBoard™ ISO Plus

- Closed-cell polyiso foam core bonded to 1/2" perlite with a fiber-reinforced felt facer
- Ideal as the second insulating layer
- Eliminates the need for a separate cover board over the polyisocyanurate boards
- Suitable for hybrid BUR and modified bitumen roof system applications
- ASTM C1289, Type II or Type III
- Available in 4' x 4' and 4' x 8' boards

FlintBoard™ ISO-T Plus

- FlintBoard™ ISO-T Plus composite polyisocyanurate/perlite roof insulation board with a tapered design to promote positive drainage
- Ideal for hybrid BUR and modified bitumen roof system applications
- ASTM C1289, Type II or Type III
- Available in 4' x 4' boards

FlintBoard™ ISO Cold

- Polyisocyanurate roof insulation featuring a closed-cell polyiso foam core integrally laminated to heavy, coated glass facers
- Specifically designed for single-ply, cold applied hybrid BUR and cold applied SBS modified bitumen roof systems
- NOT FOR USE WITH HOT APPLIED ROOFING SYSTEMS
- ASTM C1289, Type II, Class 2
- Available in 4' x 4' and 4' x 8' boards

FlintBoard™ ISO-T Cold

- Polyisocyanurate bonded to a coated glass facer designed for Cold Applied and Spray Applied applications
- Available in tapered panels
- Mold resistant polymer coated facer - moisture resistant
- ASTM C1289, Type II
- Available in 4' x 4' and 4' x 8' boards

FlintBoard™ ISO NB

- Polyisocyanurate bonded to a 7/16" or 5/8" OSB (Oriented Strand Board) suitable for new construction or re-roofing where a durable insulating panel is needed under tile, slate or a heavy shingle.
- Also available bonded to plywood
- Available in tapered panels
- Standard black-faced facer
- ASTM C1289, Type IV
- Available in 4' x 4' and 4' x 8' boards

FlintBoard™ ISO WF

- Polyisocyanurate bonded to 1/2" high-density wood fiberboard
- Available in tapered panels
- ASTM C1289, Type IV
- Available in 4' x 4' and 4' x 8' boards

FlintBoard™ ISO-T WF

- Polyisocyanurate bonded to 1/2" wood fiberboard
- Available in tapered panels
- ASTM C1289, Type IV
- Available in 4' x 4' and 4' x 8' boards

FlintBoard™ ISO DD

- Polyisocyanurate bonded to a 1/4" DensDeck
- Fiber reinforced felt facer on the bottom side
- ASTM C1289, Type VII
- Available in 4' x 4' and 4' x 8' boards

FlintBoard™ CV (Crossventilating)

- Designed specifically for use over sloped unventilated roof decks
- Provides thermally efficient insulation with cross-venting that promotes air circulation
- 1.0", 1.5" or 2.0" ventilation channels separating 7/16" APA/TECO OSB from the polyiso foam
- ASTM C1289-95, Type V; UL listed and FM approved
- Available in 4' x 8' boards with thicknesses between 2.5" and 6.5"

FlintBoard™ Pre-Cut Crickets

- Pre-packaged in triangular sections only (not the entire cricket), each with a right angle to align with CertainTeed's standard 4' x 4' tapered FlintBoard insulation panels
- ASTM C1289-95, Type II

FlintFast™ #12

- Fastener features a sharp drill point and tapered wedge entry
- Corrosion protection and back-out resistance
- Fastener length 1-5/8" to 8"

FlintFast™ #14

- Heavy-duty drill point fasteners with tapered wedge entry
- Low profile head, deep threads
- Fastener length 1-1/2" to 12"

FlintFast™ SIPLD

- Engineered fastener for attaching structural insulated panels (SIPS)
- Light-duty drill point for corrugated steel dock & wood applications
- Fastener length 3" to 18"

FlintFast™ 3" Galvalume Metal Insulation Plates

- Concave, reinforced circular design with low profile
- Designed for outer perimeter strength with recess for screw head

LiquiFlash™

High performance seamless and self-terminating waterproofing flashing system. Kits include all tools and material necessary to flash and repair approximately 25 square feet of area; 2-part, urethane technology.

LiquiFlash™ EZ Patch

1-part urethane repair patch for cracks in bitumen sheets, PVC roofing sheets, concrete, wood and metal. Patch measures 16" x 10-1/2".

CERTASPEC™

CertainTeed's comprehensive online roofing specification writing tool — with important LEED® criteria built in.

CertaSpec™ allows users to quickly write accurate steep- and low-slope roofing specifications for job submittal packages and can be accessed by visiting www.certainteed.com/certaspec.

The screenshot displays the Certaspec website interface. At the top, there is a navigation bar with links: Home | About Certaspec | About Certainteed | My Account | Contact Us | Log Out | Administrative. Below this is the Certaspec logo and the tagline "Certainteed Roofing System Specification Tool". To the right of the logo are three icons: "Environmental Products", "Insulation Products", and "Cladding Resources".

The main content area is titled "Drawing Resource" and features a grid of 16 thumbnail images of technical drawings, arranged in 4 rows and 4 columns. Each drawing shows a cross-section of a roof assembly with various components and labels.

On the right side of the page, there is a dark blue sidebar with the heading "INSTRUCTIONS". Below the heading, there are two bullet points:

- Click on a thumbnail to view larger version.
- To download a file to your desktop, click on a file to view larger version then select which file format you wish to download the file in.



SIDING

Freedom of Choice™. That's what you'll get with CertainTeed Vinyl and Polymer Shake siding. With the industry's widest choice of colors, styles, profiles and accessories to choose from, CertainTeed is more than ready to meet your needs. For additional information refer to our Digital Architect Binder at www.certainteed.com/architectbinder

CERTAINTEED VINYL & POLYMER SIDING

Cedar Impressions®

Cedar Impressions incorporates breakthrough technology featuring patented PanelThermometer™ and straight-up installation, and offers the size, shape and texture of authentic cedar shingles.

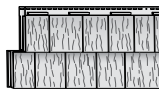

Perfection & Half-Round

- Profiles:
 - Double 7" Straight Edge Perfection Shingles (14" x 48" panel)
 - Double 7" Staggered Perfection Shingles (14" x 48" panel)
 - Triple 5" Straight Edge Perfection Shingles (15" x 60" panel)
 - Double 6-1/4" Half Round Shingles (12-1/2" x 32" panel)

- Molded Perimeter Lock™
- 3/4" panel projection
- .100" thickness
- 30 low-gloss colors
- Lifetime limited warranty

Double 7" Straight Edge Rough-Split Shakes

- 14" x 57" length
- 1" panel projection
- .125" thickness
- 28 low-gloss colors
- Lifetime limited warranty

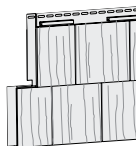

Double 9" Staggered Rough-Split Shakes

- 18" x 57" length
- 1" panel projection
- .125" thickness
- 28 low-gloss colors
- Lifetime limited warranty

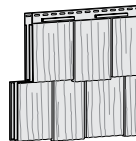

Northwoods®

- Profiles:
 - Single 7" Straight Edge Rough-Split Shakes
 - Single 9" Staggered Rough-Split Shakes
- .050" thickness
- Single 7" (7" x 10' - 1" length)
- Single 9" (9" x 10' - 4-3/4" length)
- TrueTexture™ finish molded from real cedar shakes
- Deep, well-defined gaps
- 1" accessories
- 17 low-gloss colors
- Lifetime limited warranty

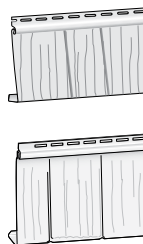

CedarBoards™ Insulated Siding

CedarBoards Insulated Siding is a complete wall system that combines the low maintenance qualities of vinyl siding with the thermal efficiency of rigid insulation.

- Profiles:
 - Double 6" Clapboard (up to 60% recycled content)
 - Single 7" Clapboard
 - Double 4" Clapboard
 - Double 4-1/2" Dutchlap
 - Single 12" Vertical Board & Batten
- Patented STUDfinder™ Installation System
- TrueTexture™ Rough Cedar finish
- Insulated Horizontal Siding - .044" thickness; 1-1/4" panel projection*
- Insulated Board & Batten - .052" thickness; 1-1/4" panel projection*
- 24 low-gloss colors
- Lifetime limited warranty

* Complete assembly



CedarBoards™ XL Insulated Siding

Longer length CedarBoards panels reduce seams.

- Profiles:
 - Double 6" Clapboard (up to 60% recycled content)
 - Single 7" Clapboard
- TrueTexture™ Rough Cedar finish
- Patented STUDfinder™ Installation System
- 3/4" panel projection
- .044" thickness
- 18 low-gloss colors
- Lifetime limited warranty



Monogram® 46

Monogram's selection of colors, profiles, accessories and finishes offers the widest range of design possibilities in the industry.

- Profiles:
 - Double 4" Rough Cedar Clapboard
 - Double 5" Rough Cedar Clapboard
 - Double 5" Rough Cedar Dutchlap
- TrueTexture™ Rough Cedar finish
- Patented STUDfinder™ Installation System
- RigidForm™ 220 technology tested to withstand wind load pressures up to 220 mph
- Self-aligning CertiLock™
- 3/4" panel projection
- .046" heavy-duty thickness
- 33 low-gloss solid colors
- 8 low-gloss wood-tone blend colors
- Lifetime limited warranty



Monogram® 46L & 46XL

Longer length Monogram 46L & 46XL have the same great benefits as traditional Monogram 46 while reducing seams.

- Profiles:
 - Double 4" Rough Cedar Clapboard, 16' 8", 20' or 25'
 - Double 5" Rough Cedar Dutchlap, 16', 20' or 25'
- TrueTexture™ Rough Cedar finish
- Patented STUDfinder™ Installation System
- RigidForm™ 220 technology tested to withstand wind load pressures up to 220 mph
- Self-aligning CertiLock™
- 3/4" panel projection
- .046" thickness
- 16 low-gloss colors
- Lifetime limited warranty



Restoration Classic™

Restoration Classic provides the premium features that make it a great choice for both new construction and remodeling.

- Profiles:
 - Double 4" Select Cedar Clapboard
 - Double 5" Select Cedar Clapboard
 - Double 4-1/2" Select Cedar Dutchlap
 - Double 4-1/2" Smooth Clapboard
 - Triple 3" Smooth Clapboard
- RigidForm™ 180 technology tested to withstand wind load pressures up to 180 mph
- DuraLock® post-formed lock
- Natural woodgrain appearance or smooth low-gloss finish option
- Patented STUDfinder™ Installation System
- 5/8" panel projection
- .044" thickness
- 28 low-gloss colors
- Lifetime limited warranty



Board & Batten

Board and Batten Vertical Siding is designed to emulate historic cedar siding originally applied to log-built homes, barns and early American structures. Alternating wide and narrow vertical panels combine in a simple yet beautiful design, well suited to distinctive architectural styles, making it ideal for whole house or accent applications.

- Available in two lengths: 12'-6" and 10'
- Eliminates seams in wall up to 12'-6"
- Straight-edge batten for a sharp, carpentered look
- Flat face, 6-1/2" boards for true Cedar board appearance
- TrueTexture™ Rough Cedar finish
- 1/2" panel projection
- .048" thickness for ultimate strength and durability
- 12 low-gloss colors
- Lifetime limited warranty

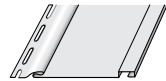

Carolina Beaded™

The unique styling of the historically accurate Carolina Beaded features a deep "V" groove between the face and bead of each panel, creating distinctive shadow lines.



- Profile:
 - Single 6-1/2" brushed beaded panel
- Patented STUDfinder™ Installation System
- Post-formed lock
- 3/4" panel projection
- .044" thickness
- 14 low-gloss colors
- Lifetime limited warranty

MainStreet™

The versatile MainStreet panel has a wide variety of profiles and colors, making it ideal for any home design and a great choice for building professionals looking for value plus the benefits of a premium panel.



- Profiles:
 - Triple 3" Brushed Clapboard
 - Double 4" Woodgrain Clapboard
 - Double 4" Woodgrain Dutchlap
 - Double 5" Woodgrain Clapboard
 - Double 5" Woodgrain Dutchlap
 - Single 6-1/2" Brushed Beaded
 - Single 8" Woodgrain Clapboard
- Patented STUDfinder™ Installation System
- RigidForm™ 160 technology tested to withstand wind load pressures up to 160 mph
- DuraLock™ post-formed lock
- 9/16" panel projection; 5/8" panel projection Single 8"
- .042" thickness
- 24 low-gloss colors
- Lifetime limited warranty

Wolverine American Legend™

Wolverine American Legend features the exclusive STUDfinder™ System and GripLock™ design. American Legend is virtually maintenance-free and suitable for new construction and remodeling projects.

- Profiles and finishes:
 - Double 4" Woodgrain Clapboard
 - Double 5" Woodgrain Clapboard
 - Double 4-1/2" Woodgrain Dutchlap
- Patented STUDfinder™ Installation System
- GripLock™
- 9/16" panel projection
- .042" thickness
- 22 low-gloss colors
- Lifetime limited warranty



Encore™

Encore is available in four distinct styles.

- Profiles:
 - Triple 3" Woodgrain Clapboard
 - Double 4" Woodgrain Clapboard
 - Double 5" Woodgrain Clapboard
 - Double 4-1/2" Woodgrain Dutchlap
- Patented STUDfinder™ Installation System with roll-over nail hem
- 1/2" panel projection; 7/16" panel projection on Triple 3" & Double 4-1/2" Dutchlap
- .040" thickness
- 13 low-gloss colors
- Lifetime limited warranty



VINYL CARPENTRY®

SOFFIT AND VERTICAL SIDING

(All vented soffits are for soffit use only)

T3-1/3" Soffit

T3-1/3" Vinyl Soffit has the timeless, traditional look of finely finished wood.

- Profile:
 - Triple 3-1/3" InvisiVent Soffit (soffit only)
 - Triple 3-1/3" Solid Soffit and Vertical Siding
- InvisiVent Soffit provides more than 10" of net-free intake area. Concealed intake vents provide a smooth appearance.
- 3/4" panel projection
- .044" thickness
- Low-gloss matte finish
- 13 low-gloss colors
- Lifetime limited warranty

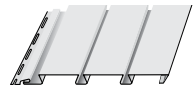
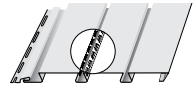

Perimeter™ Triple 3-1/3" Soffit

Perimeter T3-1/3" offers a smooth, flat surface and provides the perfect balance of aesthetics and performance.

- Profile:
 - Triple 3-1/3" Hidden Vent Soffit (soffit only)
 - Triple 3-1/3" Solid Soffit and Vertical Siding
- 5/8" panel projection
- .040" thickness
- 14 low-gloss colors
- Lifetime limited warranty

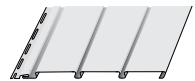
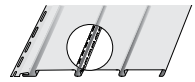

Chamfer Board™ Soffit

Chamfer Board provides the authentic look of beveled edge wood plus the durability of vinyl siding.

- Profiles:
 - Double 5" Solid Soffit and Vertical Siding
 - Double 5" Fully Vented (soffit only)
- Post-formed lock
- 9/16" panel projection
- .044" thickness
- Unique V-Groove lock design
- 8 low-gloss brushed colors
- Lifetime limited warranty

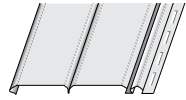

Ironmax™ Soffit

Premium D5" extra-thick soffit design offers attractive aesthetics, optimum strength, and outstanding rigidity. It is available in universal woodgrain finish. Solid panels can also be used for vertical siding applications.

- Profile:
 - Double 5" Solid
 - Double 5" Fully Vented (soffit only)
- Post-formed lock
- 9/16" panel projection
- .046" extra thick construction
- 29 low-gloss colors
- Lifetime limited warranty

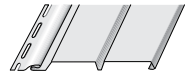
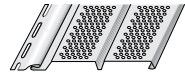

Beaded Triple 2" Soffit

Beaded T2" Vinyl Soffit, with a low-gloss smooth finish and classic wainscot style, in solid and invisibly vented panels.



- Profiles:
 - Triple 2" Solid
 - Triple 2" Invisibly Vented (soffit only)
- Smooth finish wainscot design
- Extra long slip-lock design
- 3/8" panel projection
- .039" thickness
- 8 low-gloss colors
- Lifetime limited warranty

Universal Soffit

With its matte finish, Universal T4" is a versatile soffit, offered in most CertainTeed colors. Solid panels are also appropriate for vertical applications.

- Profile:
 - Triple 4" Solid
 - Triple 4" Fully Vented (soffit use only)
 - Triple 4" Center Vented (soffit use only)
- Post-formed lock
- 7/16" panel projection
- .040" thickness
- 35 low-gloss colors; Center Vented available in Colonial White and Snow only
- Lifetime limited warranty

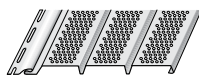

Value Soffit

An economy soffit available in a matte finish for both new construction and remodeling projects. Not suitable as vertical siding.



- Profiles:
 - Triple 4" Solid, Center and Fully Vented (soffit only)
 - Double 5" Solid and Fully Vented (soffit only)
- Post-formed lock
- 7/16" panel projection
- T4": .036" thickness
- D5": .038" thickness
- Up to 9 low-gloss colors
- Lifetime limited warranty

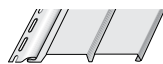

Decorative Trim and Accessories

From functional installation components to eye-catching decorative trim, Vinyl Carpentry® accessories have been engineered to provide the utmost in quality, good looks and performance, offered in the industry's widest range of colors. Some examples:

- One-piece SuperCorner™ Fluted, Beaded, and Traditional foam-backed cornerposts
- Extra-wide, smooth lineals
- Window and Door Surrounds with Crown Molding
- Corner Block and Rosette



CertaWrap™ Weather Resistant Barrier

A protective barrier for sheathing and framing of a structure, CertaWrap provides optimal moisture vapor permeance, superior air and water holdout and outstanding tear strength. It also contributes to energy efficiency, air quality and overall comfort of a home.

- Water holdout: 865 cm
- Optimal water vapor PERM rating: 11.7
- Thickness: 12.9 mils
- UV resistance: 180 days
- STUDfinder technology
- Lifetime limited material warranty plus 10-year SureStart™ labor protection



CertaWrap Accessories

CertaFlash™ BA: For use in straight jams and straight heads, it features a split back and quick-peel release paper

Roll Sizes: 4" x 75'; 6" x 75'; 9" x 75'



CertaFlash™ Flex: For use around curved and angular applications such as arched windows, doors and window sills

Roll Sizes: 6" x 75'; 9" x 75'



CertaTape™ Construction Tape: Used to seal overlaps, seams and penetrations

Roll Size: 1-7/8" x 165'



VYTEC POLYMER & VINYL SIDING

Shakes

Cedar shakes have clean lines and a refined appearance. Longer, single-course panel for natural looks with minimal installation waste.

- Profile:
 - Single 7" Cedar Shakes
- Cedar grain finish
- 81-1/4" length
- .085" extra-thick panel
- 13 colors
- Lifetime limited warranty

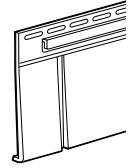

Prestige®

Natural oak woodgrain that adds handcrafted style to your home's exterior.

- Profiles:
 - D4.5" Traditional
 - D4.5" Dutchlap
 - D5" Dutchlap
- .044" thickness
- Woodgrain finish
- Panel projection:
 - D4.5 – 9/16"; D4.5DL – 1/2"; D5DL – 5/8"
- TruColor!® Protection Technology
- 21 colors
- Lifetime limited warranty

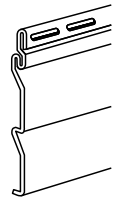
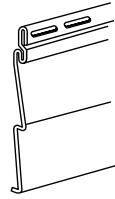

Proside® LG

Subtle, elegant maple woodgrain that looks like freshly painted wood.

- Profiles:
 - D4.5" Traditional
 - D4.5" Dutchlap
 - D4" Traditional
 - S8" Traditional
- Woodgrain finish
- .042" thickness (.045" for S8")
- 1/2" panel projection (5/8" for S8")
- 13 colors
- Lifetime limited warranty

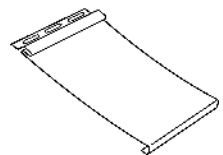
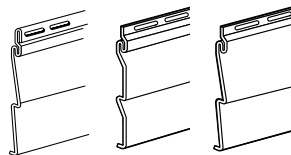

Nantucket®

- Profiles
 - D4" Traditional
 - D4" Dutchlap
 - D4.5" Dutchlap
- .040" thickness
- Woodgrain finish
- 1/2" panel projection
- 12 colors
- Lifetime limited warranty

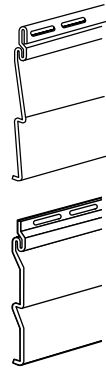

SOFFIT AND VERTICAL SIDING

D5" Select

- Profiles (soffit use only):
 - D5" Select Solid
 - D5" Select Full Vent
- .040" thickness
- Brushed finish
- 1/2" panel projection
- 13 colors
- Lifetime limited warranty

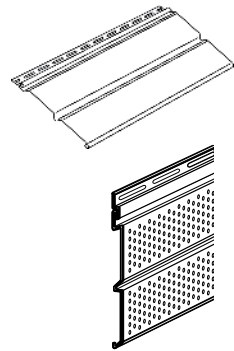

Triple 4"

- Profiles (soffit use only):
 - Triple 4" Solid
 - Triple 4" Full Vent
 - Triple 4" Center Vent
- Woodgrain finish
- .036" thickness
- 3/8" panel projection
- 14 colors
- Lifetime limited warranty

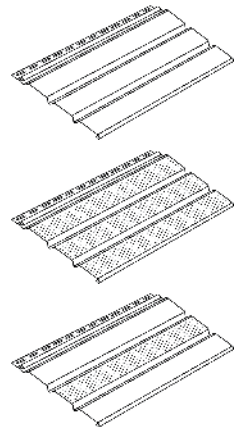



FENCE

CertainTeed Vinyl Fence products are beautiful, low-maintenance alternatives to wood construction. These products resist rotting, splitting, warping and wood-boring insects and are important elements in the design of outdoor living spaces. For additional information refer to our Digital Architect Binder at www.certainteed.com/architectbinder

TRADITIONAL PICKET

Newbury & Scalloped Newbury

- Newbury features thru-picket style with brackets
- Scalloped Newbury features concave shape thru-picket style with brackets
- “Good neighbor” design
- 4' height, 8' wide section
- Posts, caps and gates sold separately
- Available in White
- Lifetime limited warranty

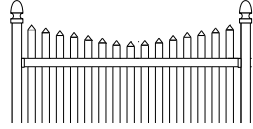
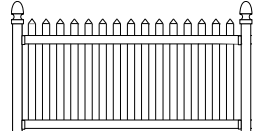

Newport & Scalloped Newport

- Newport features traditional picket style vinyl fence
- Scalloped Newport features concave shape traditional picket vinyl fence
- Routed post design
- Available in White
- 3' & 4' heights, 6' wide sections
- Concave 3', 4', 5'
- Posts, caps and gates sold separately
- Designed to rack up to 30 degrees
- Lifetime limited warranty

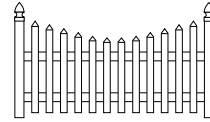
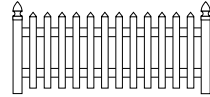

PRIVACY

Arlington & Arlington with Lattice Top

- Adds total privacy to a property
- Available with lattice top in 6' heights, 8' wide sections
- Routed post design
- 5' & 6' heights, 8' wide sections
- Tongue-n-groove pickets
- Posts, caps and gates sold separately
- Colors: White, Almond
- Available with CertaGrain® authentic wood texture — Sierra Blend (full privacy only)
- Lifetime limited warranty

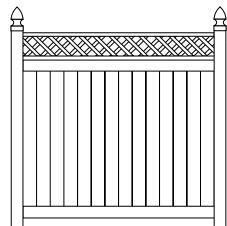
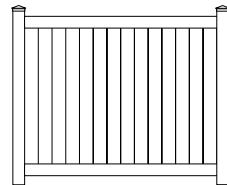

Brookhaven & Brookhaven with Lattice Top

- Complete privacy design with brackets
- Available with lattice top
- 6' height, 8' wide sections
- Classic wood molding rail design
- Tongue-n-groove pickets
- Posts, caps and gates sold separately
- Available in White
- Brackets available in both vinyl and aluminum
- Lifetime limited warranty

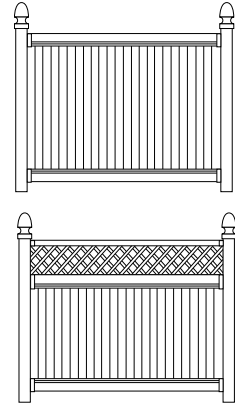

CONTEMPORARY PICKET

Wilshire

- Contemporary picket
- Routed post design
- Available in White and Almond
- Meets most pool codes
- 3', 4', 5' & 6' high, 8' wide (5' and 6' have midrail)
- Posts, caps and gates sold separately
- Designed to rack up to 6 degrees
- Lifetime limited warranty

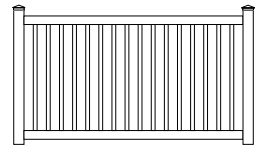

SEMI-PRIVATE

Bel Air

- Semi-private fence
- Routed post design
- Meets most pool codes
- Picket spacing creates privacy but allows air flow
- Available in White and Almond
- 4', 5' & 6' heights, 8' wide sections (5' and 6' have midrail)
- Posts, caps and gates sold separately
- Designed to rack up to 4 degrees
- Lifetime limited warranty

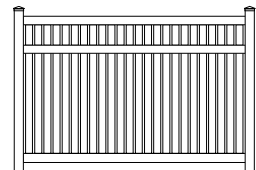

AGRICULTURAL

Post & Rail Fence

- 2, 3, and 4 rail
- 8' and 16' long rails
- Posts, caps and gates sold separately
- Designed to rack up to 6 degrees with 8' rails
- Retains virtually no moisture; has no taste so horses won't crib or chew
- Available in smooth finish in White and Almond or White with CertaGrain® texture
- Lifetime limited warranty

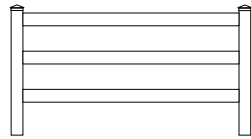

BUFFTECH®

TRADITIONAL

Cape Cod & Cape Cod Concave

- Routed post design
- Available in White
- 3', 4' and 5' high, 6' wide
- Posts, caps and gates sold separately
- 3" pointed picket
- Lifetime limited warranty

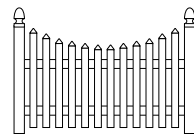
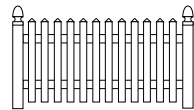

Yorkshire & Yorkshire Concave

- Routed post design
- Available in White
- 3' and 4' high, 6' wide
- Posts, caps and gates sold separately
- 3" dog ear picket
- Lifetime limited warranty

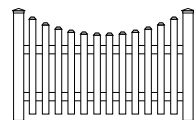
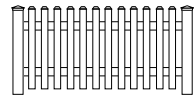

Rothbury & Rothbury Concave

- Routed post design
- Available in White and Almond
- 4' high, 8' wide
- Posts, caps and gates sold separately
- 3" dog ear picket (thru-picket)
- Lifetime limited warranty

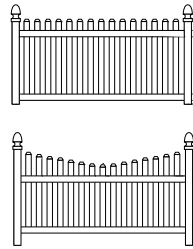

Danbury & Danbury Concave

- Routed post design
- 4' high, 8' wide available in Select Cedar texture in White, Almond, Clay, Arbor Blend, Arctic Blend, Sierra Blend and Weathered Blend
- 4' high, 8' wide Smooth style available in White, Almond and Clay
- Posts, caps and gates sold separately
- 3" pointed picket (thru-picket)
- Lifetime limited warranty

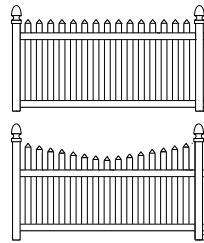

CLASSIC

Canterbury & Canterbury Swoop

- Routed post design
- Available in White
- 3' and 4' high, 8' wide
- Posts, caps and gates sold separately
- 1-1/2" square picket
- Lifetime limited warranty

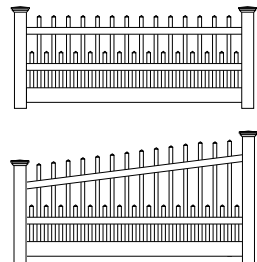

Manchester & Manchester Concave

- Routed post design
- Available in White and Almond
- 3' and 4' high, 8' wide
- Posts, caps and gates sold separately
- 1-1/2" square picket
- Lifetime limited warranty

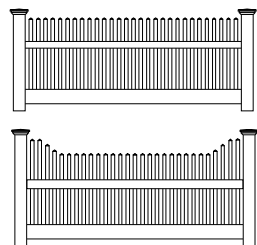

Classic Impressions™

- Choice of fluted or recessed design posts
- 3' and 4' posts
- Available in White
- For use with Manchester styles only
- Lifetime limited warranty

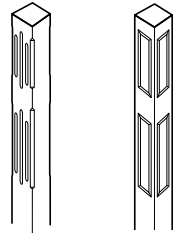

CONTEMPORARY

Baron

- Routed post design
- 4', 5' and 6' high, 8' wide available in Select Cedar texture in White, Almond, Arbor Blend, Arctic Blend, Sierra Blend and Weathered Blend
- 3', 4', 5' and 6' high, 8' wide Smooth style available in White and Almond (5' and 6' include midrail)
- Posts, caps and gates sold separately
- 7/8" x 3" picket
- Lifetime limited warranty

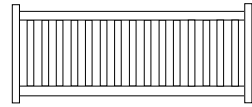

Countess

- Routed post design
- Available in White and Almond
- 3', 4', 5' and 6' high, 8' wide (5' and 6' include midrail)
- Posts, caps and gates sold separately
- 7/8" x 1-1/2" and 7/8" x 3" picket
- Lifetime limited warranty

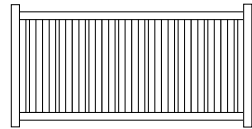

Monarch

- Routed post design
- Available in White and Almond
- 3', 4', 5' and 6' high, 8' wide (5' and 6' include midrail)
- Posts, caps and gates sold separately
- 7/8" x 1-1/2" and 7/8" x 3" picket
- Lifetime limited warranty

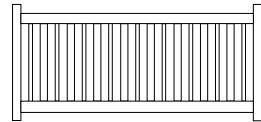

Princeton

- Routed post design
- Available in White and Almond
- 3', 4', 5' and 6' high, 8' wide (5' and 6' include midrail)
- Posts, caps and gates sold separately
- 7/8" x 1-1/2" picket
- Lifetime limited warranty

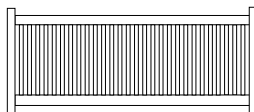

Victorian

- Routed post design
- Available in White and Almond
- 3', 4', 5' and 6' high, 8' wide (5' and 6' include midrail)
- Posts, caps and gates sold separately
- 7/8" x 1-1/2" picket
- Lifetime limited warranty

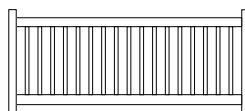

SEMI-PRIVATE

Columbia & Columbia with Lattice

- Routed post design
- Available in White
- 5' and 6' high, 8' wide
- Posts, caps and gates sold separately
- 7/8" x 6" ribbed picket
- WindZone™ performance
- Lifetime limited warranty

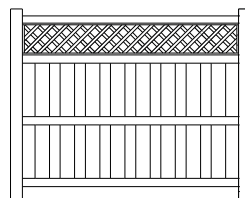
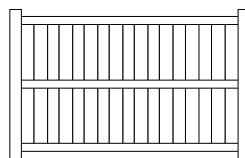

Imperial

- Routed post design
- 4', 5' and 6' high, 8' wide available in Select Cedar texture in White, Almond, Clay, Arbor Blend, Arctic Blend, Sierra Blend and Weathered Blend
- 3', 4', 5' and 6' high, 8' wide Smooth available in White, Almond, Clay (5' and 6' include midrail)
- Posts, caps and gates sold separately
- 7/8" x 3" picket
- Meets pool code
- WindZone™ performance (6' high only)
- Lifetime limited warranty

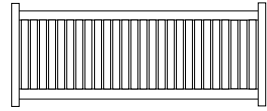

Millbrook

- Routed post design
- Available in White and Almond
- 5' and 6' high, 8' wide (5' and 6' include midrail)
- Posts, caps and gates sold separately
- 7/8" x 6" ribbed picket
- Lifetime limited warranty

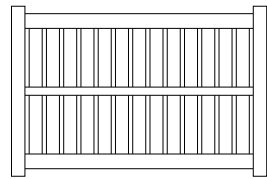

PRIVACY

Chesterfield

- Routed post design
- 4', 5' and 6' high, 8' wide Smooth available in White, Almond and Clay
- 4', 5' and 6' high, 8' wide CertaGrain® texture available in White, Almond, Clay, Arbor Blend, Arctic Blend, Brazilian Blend, Frontier Blend, Honey Blend, Sierra Blend, Weathered Blend, Canyon Blend and Timber Blend
- 4', 5' and 6' high, 8' wide CertaStucco™ texture available in Mission Ivory and Almond
- Posts, caps and gates sold separately
- 7/8" x 7" tongue & groove picket
- Meets pool code
- WindZone™ performance
- Lifetime limited warranty

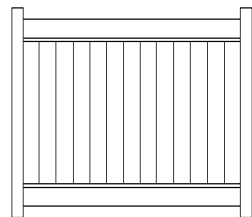

Chesterfield with Lattice Accent

- Routed post design
- Smooth available in White and Almond
- CertaGrain® texture available in White and Clay
- 3' 8" plus 1' 4" accent and 4' 8" plus 1' 4" accent high, 8' wide
- Posts, caps and gates sold separately
- 7/8" x 7" tongue & groove picket
- Meets pool code
- WindZone™ performance
- Lifetime limited warranty

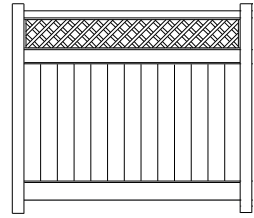

Chesterfield with Victorian Accent

- Routed post design
- Smooth available in White and Almond
- CertaGrain® texture available in White, Almond, Clay, Arctic Blend, Brazilian Blend, Sierra Blend and Weathered Blend
- 4' 8" plus 1' 4" accent
- Posts, caps and gates sold separately
- 7/8" x 7" tongue & groove and 7/8" x 1-1/2"
- Meets pool code
- Lifetime limited warranty

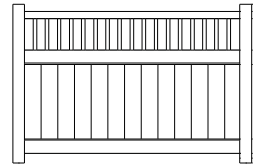

Chesterfield with Huntington Accent

- Routed post design
- Available in White and Almond
- 4' 8" plus 1' 4" accent high, 8' wide
- Posts, caps, and gates sold separately
- 7/8" x 7" tongue & groove and 1-1/2" square pickets
- Meets pool code
- Lifetime limited warranty

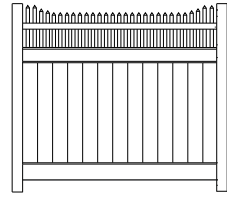

Chesterfield with Westminster Accent

- Routed post design
- Available in White and Almond
- 4' 8" plus 1' 4" accent high, 8' wide
- Posts, caps, and gates sold separately
- 7/8" x 7" tongue & groove pickets
- Meets pool code
- Lifetime limited warranty

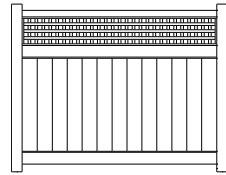

New Lexington, New Lexington with Lattice, New Lexington with Victorian Accent

- Routed post design
- Available in White and Almond
- Full 72" height or 4' 11" plus 1' 1" accent high, 8' wide
- Posts, caps, and gates sold separately
- 5/8" x 11-3/8" tongue & groove pickets
- Lifetime limited warranty

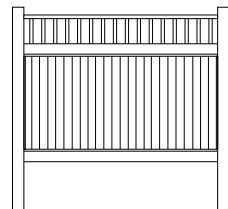
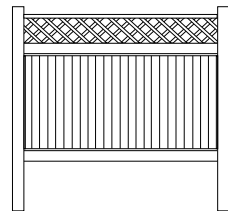
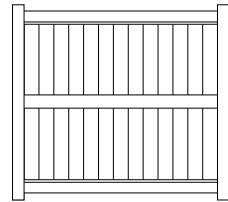

Galveston, Galveston with Lattice Accent and Galveston with Victorian Accent

- Routed post design
- 7' and 8' high, 8' wide in CertaGrain® texture available in Clay, Arbor Blend, Arctic Blend, Brazilian Blend, Frontier Blend, Honey Blend, Sierra Blend and Weathered Blend
- 7' and 8' and 6' 8" plus 1' 4" accent high, 8' wide Smooth available in White and Almond
- Posts, caps, and gates sold separately
- 7/8" x 7" tongue & groove pickets
- Lifetime limited warranty

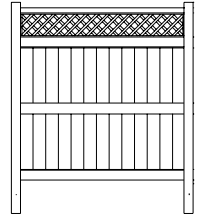
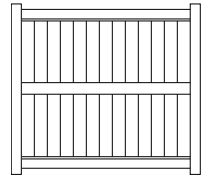

POST & RAIL

2-Rail, 3-Rail and 4-Rail Styles

- Routed post design
- Available in White and Almond (Almond only available with ribbed rails)
- Rail choice of 1-1/2" x 5-1/2" ribbed; 2 x 6 hollow and 2 x 6 ribbed; 8' and 16' wide
- Now available in CertaGrain texture in White and Sierra Blend (availability determined by rail size)
- Rail size (White): 1-1/2" x 5-1/2" ribbed
- Rail size (Sierra Blend): 2" x 6" ribbed
- Posts, caps, and gates sold separately
- Lifetime limited warranty

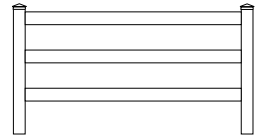

Crossback

- Routed post design
- Available in White
- Rail choice of 1-1/2" x 5-1/2" ribbed
- Posts, caps, and gates sold separately
- Lifetime limited warranty

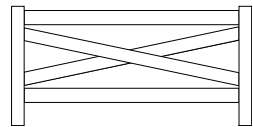

NOTES

Bufftech fence gates feature heavy-duty internal aluminum steel frame for sturdy construction that's built to last and stainless steel fasteners to prevent corrosion. For all fence styles, there is a choice of unassembled gate kits or pre-assembled gates that ship directly to install.



DECKING AND RAILING

CertainTeed Decking and Railing products are beautiful, low maintenance alternatives to wood deck construction. These products resist rotting, splitting, warping and wood boring insects. And they never require stain, paint or other protective coatings.

For additional information refer to our Digital Architect Binder at www.certainteed.com/architectbinder

EVERNEW® DECKING

EverNew delivers the ultimate in low-maintenance decking. Deck systems are offered in a variety of colors that are UV protected for long-term durability and superior color retention. EverNew decking coordinates with EverNew railing colors and perfectly complements CertainTeed siding and trim. Plus, it cuts, fastens and handles easier than wood planks.

EverNew® Vinyl

- Snap-in fill pieces hide fasteners
- 12', 16', 20' lengths
- Colors: White, Gray, Almond
- Safe, slip-resistant tread — ideal for docks
- Rigid multi-ribbed profile spans 24" joist spacing (16" recommended)
- Class A fire rating
- Lifetime limited warranty with SureStart™ Protection

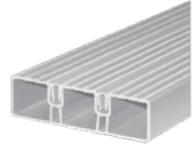

EverNew® LT Cellular PVC

- Unique, patent-pending Lumenite™ surface from Fiberon® provides unequalled stain, fade and chalk resistance
- Ultra-low maintenance — easy to clean
- Class A fire rating for flame spread
- Available option: Installs with patent-pending Deck Pilot® tool for a fastener-free surface
- 12', 16', 20' lengths
- Colors: Jatoba, Spanish Cedar, Driftwood, Cedar
- Lifetime limited performance warranty plus a 25-year Stain & Fade warranty



EverNew® PT Composite

- Features patent-pending PermaTech™ surface technology from Fiberon® for excellent stain, fade and scratch resistance
- Ultra low maintenance — easy to clean
- Optimum mold resistance resulting from no organics on the surface
- Resistant to termites, splinters and decay
- Available option: Installs with Fiberon® Approved Hidden Fastener System
- 12', 16', 20' lengths
- Colors: Rosewood, Ipe, Castle Gray, Tudor Brown
- Reversible boards reduce cuts and waste
- Recycled content creates sustainability
- 25-year performance warranty plus 25-year Stain & Fade warranty

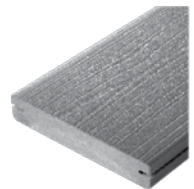

UnderShield® Water Diversion System

Designed to respond to the needs of building professionals and homeowners, UnderShield is easy to install to new or existing decks, and will maintain unobstructed air flow when properly installed. Panels can run parallel or perpendicular to the home, and an easy-to-use clip creates the desired pitch.

- Low maintenance water diversion system
- Easy to install adjustable grid system
- Concealed clip system
- Stainless steel hardware provides security and lasting performance
- High quality vinyl panels
- Available in 6" x 16' panels
- Choice of two panel styles and three colors
- Suitable for one and two-story residential applications
- Installs under the deck joist — no need to worry if the framing is 12" or 16" on center
- Helps maintain the required ventilation under the deck for most composite deck boards
- Since it installs under the framing, there is no need to worry about any bracing that may have been installed between joists
- Lifetime limited warranty

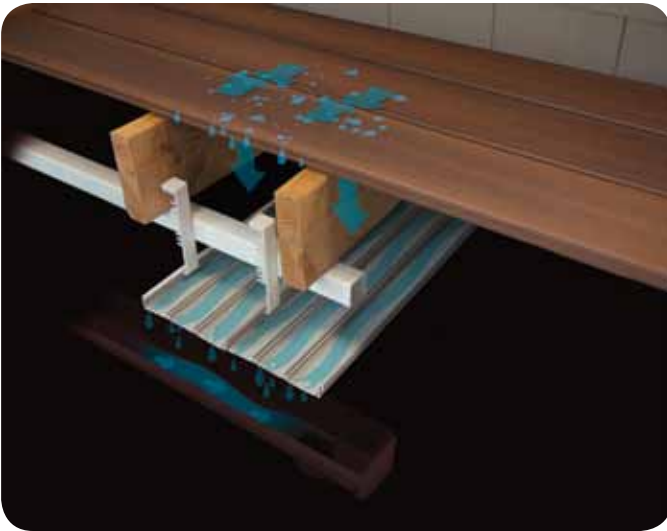

EVERNEW® RAILING

EverNew® products also include vinyl railing styles that add a beautiful finishing touch to decks, docks, porches or patios. The railing products combine the easy-care benefits of vinyl, with aluminum-reinforced construction for exceptional strength and durability. All backed by a limited lifetime warranty and SureStart™ Protection.

EverNew® Vinyl Railing

Ultra-rugged vinyl railings won't rot, chip, peel or fade. Reinforced with aluminum, EverNew® railing is ideal for any application and comes in a variety of styles.



Oxford

- Vinyl railing in 3' and 3-1/2' heights; 6', 8' and 10' lengths
- Available in White, Almond and Clay (square only)
- Perfect for balconies, decks, porches and stairs
- Routed post option with steel support posts
- Flat, stair, 45 degree and column brackets for walls or porch post installations
- Available with T-Rail top rail style
- Choice of 1-1/4" x 1-1/4" colonial or square vinyl balusters or 4" tempered glass balusters
- Independent tested as designated in report CCRR-0817
- Lifetime limited warranty with SureStart™ Protection

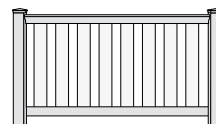
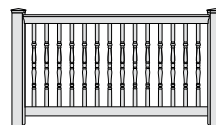
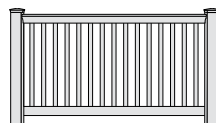

Kingston

- Vinyl railing in 3' and 3-1/2' heights; 6', 8', and 10' lengths
- Available in White, Almond and Clay (square only)
- Lifetime limited warranty with SureStart™ Protection
- Top Round style for both top and bottom rail
- Choice of 1-1/2" x 1-1/2" square or traditional balusters
- Flat, stair, 45 degree, 22-1/2 degree, and column bracket options for all installations
- Listed with the ICC-ES as designated in report ESR-1555

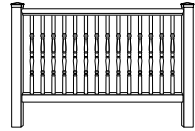
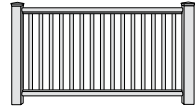

EverNew® Posts & Columns

EverNew vinyl porch systems come in a choice of styles, colors, textures and sizes that will complement any home's architectural design.

Structural Porch Posts

- Colonial Style Porch Post
 - 5" x 5" x 108" in White and Almond, rated for a 5,000 lb. load
 - 4" x 4" x 108" in White and Almond, rated for a 2,600 lb. load
- Square Style Porch Post
 - 5" x 5" x 108" in White, Almond and Clay, rated for a 5,000 lb. load
- Tie down kits included for areas with extreme wind or storm conditions or where roof cannot be lifted



PVC Exterior Columns

- Aluminum insert provides outstanding support — load bearing up to 18,000 lbs.
- 8" and 10" tapered round column, 8" non-tapered round column and 8" square column — all 108" length (8" tapered round also available in 120" length)
- Available in White
- Coordinating cap and base trim sets sold separately
- Mounting plates included for easy, secure installation

EverNew® Posts & Columns (continued)

Certa-Snap® Wrap

- Vinyl post cladding transforms wood posts in a snap
- Components snap together for easy installation
- Available in 4" x 4" x 10' as well as 6" x 6" x 10' sizes; can be field cut to any length
- Available in White or Almond colors
- Smooth and Select Cedar finishes

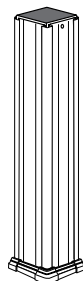

EverNew® Composite Railing

Composite railing provides the solid feel of wood railing with the strength of a durable composite core, and capped with high-quality PVC that replicates the look of freshly painted wood. The beautiful, smooth finish won't chip, peel or split, and will never need to be painted or stained. Components are engineered to work together — fastening tight with concealed hardware for a seamless appearance.

Panorama®

The Panorama® capped composite railing system features a classic painted wood railing design with handcrafted authenticity and true architectural details. Colonial, square and decorative steel balusters offer a variety of design possibilities. The concealed, corrosion-resistant stainless steel hardware provides years of worry-free performance. Panorama is a Green Approved product by the NGBS.

- PVC-capped composite railing in 3' and 3-1/2' heights, 6' and 8' lengths
- Available in White, Almond and Clay
- Perfect for balconies, decks, porches, and stairs
- Concealed hardware for a seamless appearance
- Choice of 1-1/4" square composite, 1-1/4" Colonial Vinyl or four styles of 5/8" steel balusters
- Third party testing completed as designated in report CCRR-0115
- 25-year warranty with SureStart™ Protection

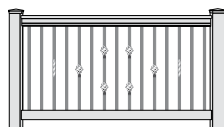
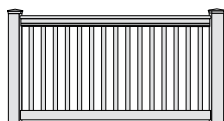
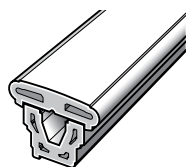



TRIM

Restoration Millwork® cellular PVC trim makes an authentic statement on your home. Available in Smooth and realistic TrueTexture™ woodgrain finish in a wide variety of traditional and specialty profiles - you can mill it or paint it to create custom designs. For additional information refer to our Digital Architect Binder at www.certainteed.com/architectbinder

Trimboards

- Smooth/Smooth and Woodgrain/Smooth
- Natural White
- Dimensions:
 - 5/8" x 4" - 5/4 x 6" Skirtboard
 - 5/8" x 6" - 5/4 x 8"
 - 5/8" x 8" - 5/4 x 8" Skirtboard
 - 5/8" x 10" - 5/4 x 10"
 - 5/8" x 12" - 5/4 x 12"
 - 1" x 3" - 5/4 x 16"
 - 1" x 4" - 5/4 x 4" J-Pocket
 - 1" x 5" - 5/4 x 4" J-Pocket with cutout
 - 1" x 6" - 5/4 x 6" J-Pocket
 - 1" x 6" Skirtboard - 5/4 x 6" J-Pocket
 - 1" x 8" - 1-1/2" x 10"
 - 1" x 8" Skirtboard
 - 1" x 10"
 - 1" x 12"
 - 1" x 16"
 - 5/4 x 4"
 - 5/4 x 5"
 - 5/4 x 6"

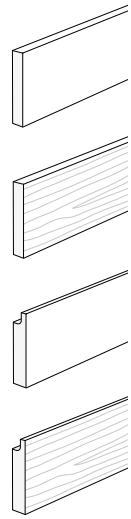

* Check product catalog for length availability and complete product offering.

Sheets

- Smooth/Smooth and Woodgrain/Smooth
- All sheets are 4' wide
- Dimensions:
 - 3/8" x 4'
 - 1/2" x 4'
 - 3/4" x 4'
 - 5/8" x 4' — (Smooth/Smooth Only)
 - 1" x 4' — (Smooth/Smooth Only)
 - 1-1/2" x 4' — (Smooth/Smooth Only)

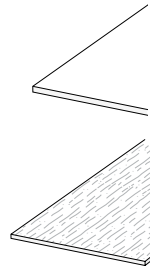

Beadboard

- Smooth
- Reversible beaded or channel repeat
- Dimensions:
 - 1/2" x 5-1/2" x 18' Traditional Tongue and Groove
 - 1/2" x 6" x 18' 2TL
 - 1/2" x 8-1/2" x 18' 3TL

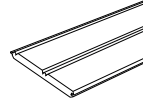

Beadboard Panel

- Smooth
- Dimensions:
 - 1/2" x 4' x 8'
 - 1/2" x 4' x 10'

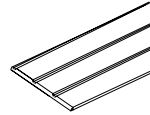

One-piece Corner

- Smooth and Woodgrain
- Dimensions:
 - 5/4 x 4" x 10'
 - 5/4 x 4" x 20'
 - 5/4 x 6" x 10'
 - 5/4 x 6" x 20'
 - 5/4 x 4" x 10' J-Pocket
 - 5/4 x 4" x 20' J-Pocket
 - 5/4 x 6" x 10' J-Pocket
 - 5/4 x 6" x 20' J-Pocket

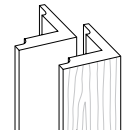
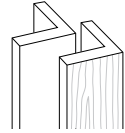

Nail Hem Flange

- Dimensions:
 - 3-1/2" x 10'

Column Wrap

- Smooth
- Dimensions: 8" x 8" x 9', 10" x 10" x 9'
- Selection of cap/base trim sets

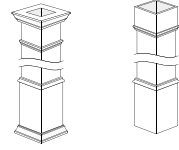

Specialty Profiles

- Smooth, Satin Finish
 - Brickmould: 1-1/8" x 2"
 - J-Channel Brickmould: 1-1/4" x 2"
 - #49 Crown: 11/16" x 3-5/8"
 - #47 Crown: 11/16" x 4-5/8"
 - #45 Crown: 9/16" x 5-1/4"
 - Rams Crown: 1-13/32" x 2-1/16"
 - Base Cap: 11/16" x 1-1/8"
 - Rake: 1" x 2"
 - Quarter Round: 3/4" x 3/4"
 - Drip Cap: 11/16" x 1-5/8"
 - Shingle Mould: 11/16" x 1-5/8"
 - Bed Mould: 9/16" x 1-5/8"
 - Lattice: 1/4" x 1-1/2"
 - Sill Nose: 1-5/16" x 1-3/8"
 - Sill: 1-1/4" x 5"
 - 356 Casing: 11/16" x 2-1/4"
 - RB3 Casing: 1-7/64" x 3-7/16"
 - Back Band: 1-3/16" x 4-1/2"
 - Adjustable Backband: 1-11/32" x 1-13/32"
 - Historic Sill: 1-3/4" x 2-13/16"
 - Cove Moulding: 3/4" x 3/4"
 - Inside Corner Post: 1-1/4" x 1-1/4" x 10'

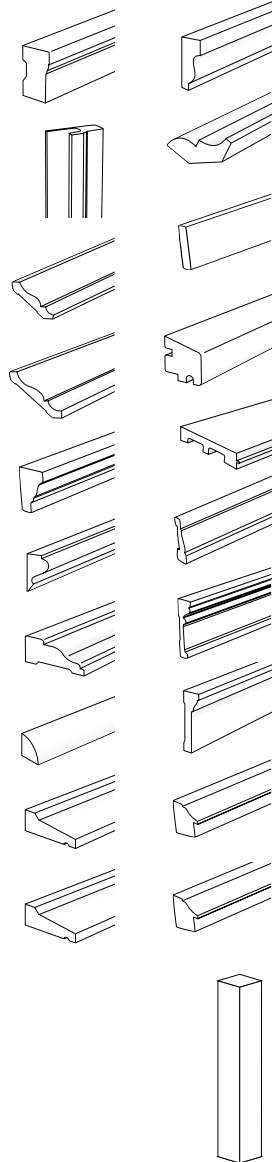

Adhesives

- TrimTight™ (Gorilla PVC™)
 - 8 oz. Can
 - 16 oz. Can



Cortex® Hidden Fastening System

- Smooth and woodgrain
 - 50 LF Box - 75 screws,
100 plugs, 1 setting tool
 - 250 LF Box - 375 screws,
400 plugs, 3 setting tools
 - 750 LF Box - 1,125 screws,
1,200 plugs, 6 setting tools

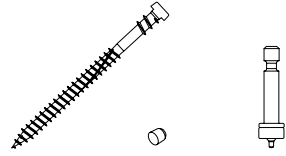

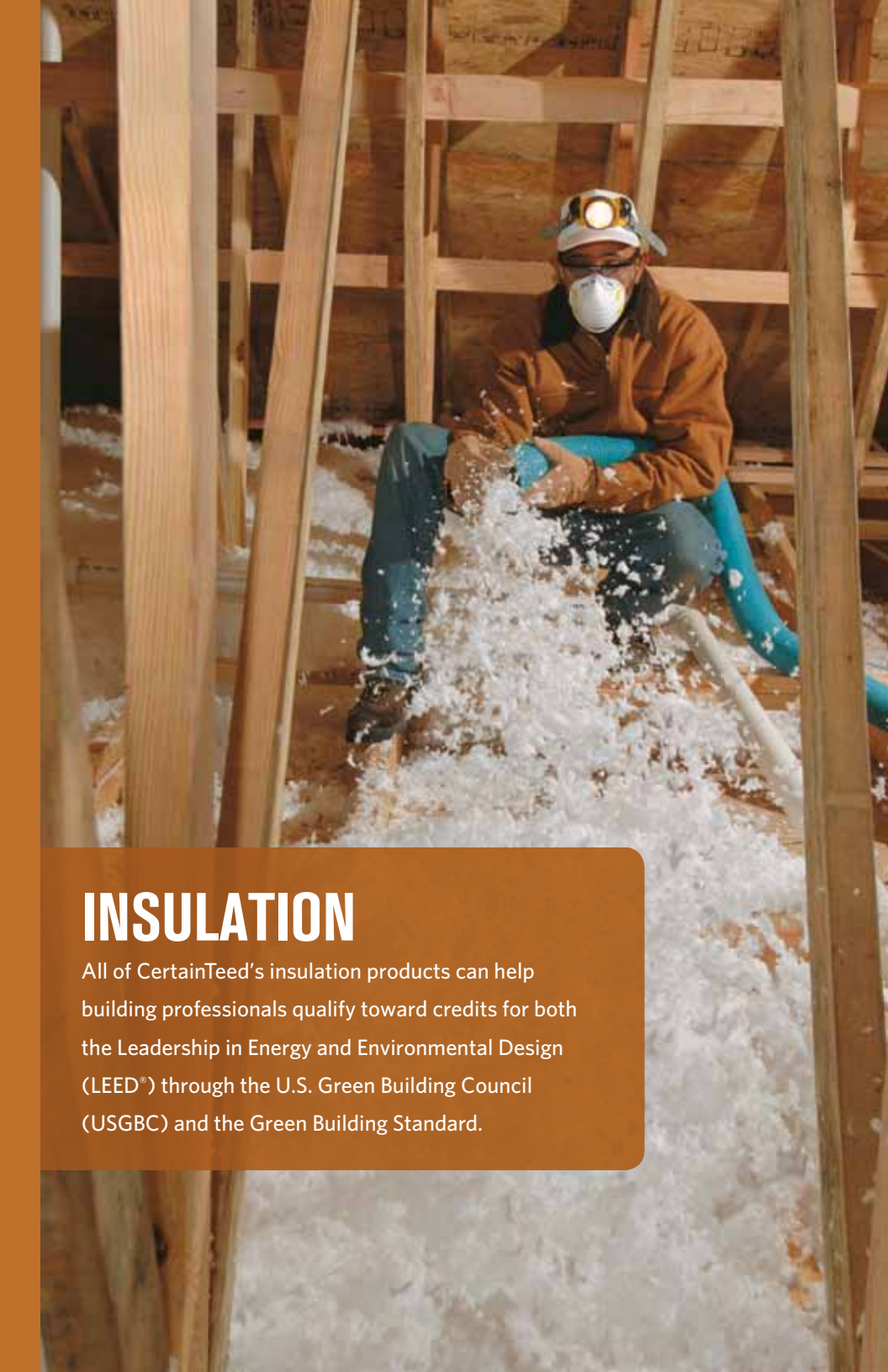

INSULATION

All of CertainTeed's insulation products can help building professionals qualify toward credits for both the Leadership in Energy and Environmental Design (LEED®) through the U.S. Green Building Council (USGBC) and the Green Building Standard.

Sustainable Insulation®

A full line of residential and commercial building insulation and mechanical/industrial products made with recycled and renewable content including a plant-based binder with no formaldehyde, acrylics, dyes or unnecessary fire-retardant chemicals added. Help Build an Environment of Change™ with Sustainable Insulation.

Building Insulation

CertainTeed Fiber Glass Building Insulation is available in batts or rolls in a variety of R-Values, widths and lengths. It is available either unfaced or faced.

- CertainTeed Unfaced Insulation is manufactured slightly wider to permit friction-fit installation in wall cavities or in steel stud construction. It is to be used with a separate vapor retarder, such as CertainTeed's MemBrain™ or in applications where no vapor retarder is required (i.e. reinsulating attics).
- CertainTeed Kraft Faced Insulation provides a vapor retarder, and has flanges at the edges for either inset or face stapling.
- CertainTeed also offers SpeedyR™ Kraft Faced insulation which is tabless for easy installation without stapling.
- CertainTeed also offers a line of foil-faced and FSK-faced products. The FSK (flame-resistant foil) is for applications (primarily commercial) where a flame spread rating of 25 (Class A) is required.
- EasyTouch™ Insulation is a line of thermal and acoustical insulation encapsulated in a vapor-permeable poly sheeting and is available with or without an attached kraft vapor barrier.

High-Performance Sidewall Batts

CertainTeed produces high-performance sidewall products for use where higher R-Values are required.

- 3-1/2" thick R-15 batts are for 2 x 4 construction
- 5-1/2" thick R-21 batts are for 2 x 6 construction
- Both have a higher density than standard sidewall batts

Cathedral Ceiling Batts

CertainTeed produces two high-density products for cathedral ceiling applications.

- 8-1/4" thick R-30 is thinner than the standard 10" thick R-30 batt
- 10-1/4" thick R-38 batt compares to a standard 12" thick product
- Both allow ventilation space between the insulation and the roof deck without the need to install roof baffles or increase joist size

Masonry Wall Insulation

Unfaced Masonry Wall Batts are designed for use behind paneling in masonry-type construction where cavity depth is limited by the furring strips used.

- Available in 15" and 23" widths and in two R-Values: 3/4" thick R-3 and 1-3/4" thick R-6
- Batts are designed to fit tightly between furring strips
- A vapor retarder may be nailed over the furring strips and insulation

Basement Wall Insulation

This product is for use in unconditioned basements and intended for applications where basement insulation is preferred or mandated and where insulation is left exposed. Basement wall insulation is produced with a white flame-resistant PSK or a reinforced foil facing. Basement wall insulation has micro-perforations to aid with moisture management.

- Available in 3-1/8" thick R-11 rolls
- Available in 44", 48", 60" and 72" widths

Sound Control Batts

CertainTeed NoiseReducer™ Batts are available unfaced for steel stud construction and with a special kraft facing for wood stud interior walls and floors. The facing is not a vapor retarder.

- Available in either 2-1/2" thick R-8 or 3-1/2" thick R-11 in 16" and 24" widths, in 96" lengths
- Available in 15" or 23" batts 3-1/2" thick, in 93" lengths

Both improve acoustical performance in residential and commercial applications.

InsulSafe® SP

InsulSafe® SP is a fiber glass blowing insulation used in residential construction as a thermal and sound absorbing insulation. It is designed for pneumatic installation in open (attic) and closed (sidewalls/floor) construction cavities. It may be used in both new and retrofit applications.

- Noncombustible
- Noncorrosive
- Won't settle
- Thermally efficient
- Formaldehyde-free
- Won't rot or decay

CertaSpray® Spray Foam

Available in open and closed cell formulas, CertaSpray® is sprayed into a building cavity and quickly expands to fill every opening that can potentially leak air. CertaSpray minimizes hot and cold spots and provides outstanding comfort and indoor air quality by impeding the penetration of moisture, air and outdoor allergens. It is appropriate for whole building applications, or in combination with fiber glass.

OPTIMA®

The loose-fill insulation designed for closed-cavity applications with the Blow-In-Blanket® System. Fills voids. No adhesive required. Blown behind OPTIMA® fabric.

MemBrain™ - The Smart Vapor Retarder and Air Barrier Film

MemBrain™ is a nylon vapor retarder sheeting intended for use with unfaced fiber glass insulation in wall and ceiling cavities. It is capable of changing its vapor permeability, from low permeability in conditions of low relative humidity to higher permeability during conditions of high relative humidity. This increases the drying potential of the cavity and reduces the risk of moisture-related damage.

Looking for proven airtight building solutions? MemBrain can also be installed as a continuous interior air barrier.

MemBrain permeance increases with humidity

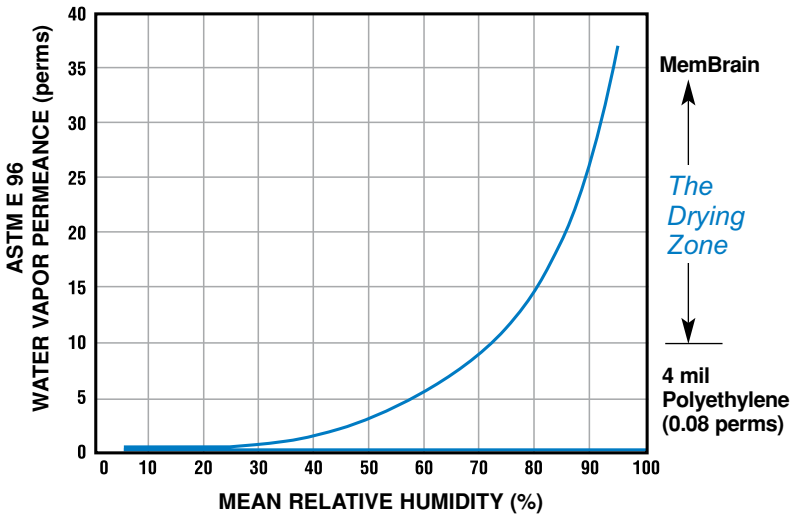

Mechanical Insulation Products

CertainTeed manufactures a complete line of fiber glass insulation for HVAC duct systems. These insulation products include ToughGard® board and liner products and SoftTouch™ duct wrap.

- **SoftTouch™ (SDW) Fiber Glass Duct Wrap**, available unfaced or faced, is a blanket insulation providing thermal control and condensation for HVAC duct work and is manufactured with an organic formaldehyde-free binder system.
- **SoftTouch™ Sustainable (SI) Fiber Glass Duct Wrap**, available unfaced or faced, provides the same performance as SoftTouch™ (SDW) Fiber Glass Duct Wrap but is manufactured with a plant-based formaldehyde-free binder system.
- **ToughGard® T Duct Liner** is composed primarily of long, textile-type glass fibers firmly bonded together with a thermosetting resin and overlaid with the ToughGard surface, providing an extremely tough and durable fire-resistant black composite airstream surface. The ToughGard surface is water resistant and treated with an EPA registered anti-microbial agent. The product is 75% recycled material.
- **ToughGard® R Duct Liner** is a duct liner manufactured with a plant-based formaldehyde-free binder and coating system.
- **Ultra*Duct® Black**, a rigid board designed for fabrication of supply and return air HVAC duct work. It provides a smooth airstream surface, is easy to clean and has molded shiplaps in all thicknesses.
- **ToughGard® Duct Board**, the highest performing board for fabrication of supply and return HVAC duct work. ToughGard Duct Board adds additional water resistance and a rich black surface to the airstream of our exceptional board for the most demanding applications. Now available in black base mat FSK with cutting guides.

ToughGard® board and liner products provide the following benefits:

- Tough airstream surface
- Excellent acoustical properties
- Lightweight
- Heat loss and gain reduced
- Resistant to microbial growth on airside surface
- Moisture repellent surface

Commercial and Industrial Insulation Products

- **CertaPro®** — A full line of commercial insulation products that includes the following:
 - AcoustaTherm™ batts
 - Commercial Board
 - Partition batts
 - AcoustaBoard™ Black
 - Thermal kraft faced batts
 - AcoustaBlanket™ Black
 - Thermal foil faced batts
 - Textile AcoustaBlanket™ Black
 - Thermal FSK-25 faced batts
 - Thermal extended flange batts
 - FSK and PSK faced

Commercial and Industrial Insulation products *continued*

- **Metal Building Insulation** is a flexible blanket insulation providing thermal, acoustical and condensation control in exterior walls and standing seam roofing systems of pre-engineered metal buildings. It is sold by local independent laminator/distributors who can assist the builder or designer with energy conservation analysis, code compliance, estimating material requirements, determining customized insulation support systems and the selection of appropriate vapor retarders.
- **Commercial Blanket** is used as a thermal and acoustical insulation in commercial buildings where wide rolls of unfaced insulation are required. It is commonly used in finishing systems as filler insulation in pre-engineered metal building wall and roof systems.
- **CrimpWrap® Crimped Pipe & Tank Wrap** is a unique, flexible, continuous blanket insulation composed of variably oriented glass fibers firmly bonded together with a thermosetting resin. It's available with either a foil faced or a white ASJ vapor retarder facing. The crimping creates an effect like corrugation, greatly increasing the compressive strength of this flexible blanket.

Marine Insulation

- **ULTIMATE** is used in shipbuilding and other applications. ULTIMATE provides excellent fire protection in addition to superior thermal and acoustical performance. It offers substantial weight savings for equal performance as commonly used mineral fibers in the market. It is a non-combustible, high temperature insulation composed of high melting temperature fibers that delivers substantial weight savings compared to traditional stone wool marine insulation. It is available unfaced or faced on one side with fiber scrim-reinforced aluminum facing (FSK), black glass tissue, glass fiber fabric or wire mesh.
- **Marine Duct Wrap** is used to insulate rectangular and round HVAC ductwork for marine and general applications. It is USCG approved and carries the wheel mark. It reduces unwanted heat loss or gain from equipment and ductwork and, when properly installed in the correct thickness, virtually eliminates condensation problems on cold duct surfaces. Marine Duct Wrap Insulation is used to insulate rectangular and round HVAC ductwork for marine and general applications. It reduces unwanted heat loss or gain from equipment and ductwork and, when properly installed in the correct thickness, virtually eliminates condensation problems on cold duct surfaces.

GYPSUM BOARD & SHEATHING

As a leading gypsum products manufacturer, we are more than ready to meet your gypsum wallboard, exterior sheathing and finishing needs.



GYPSUM BOARD

STANDARD

CertainTeed Regular

Interior gypsum board with a solid set gypsum core enclosed in ivory-colored face paper and liner back paper. Used for interior walls and ceilings in standard residential or commercial applications.

- Core: Regular
- Thickness: 1/4," 3/8"
- Width: 4'
- Standard length: 8', 12'
- Edge detail: Tapered
- ASTM: C1396

CertainTeed Type X

Interior gypsum board having a specially formulated core for use in fire-resistive, Type X designs. Used for interior walls and ceilings in residential and commercial applications requiring extended fire resistance ratings.

- Core: Type X
- Thickness: 5/8"
- Width: 4', 54"
- Standard length: 8', 9', 10', 12'
- Edge detail: Tapered
- ASTM: C1396, Type X
- For fire safety information, see www.certainteed.com

CertainTeed Type C

Interior gypsum boards consisting of a solid set, fire-resistive, Type C gypsum core enclosed in ivory-colored face paper and a strong liner back paper. CertainTeed Type C board features a specially formulated enhanced Type X core providing fire resistance ratings when used in tested assemblies. Used for interior walls and ceilings in residential and commercial applications requiring extended fire resistance ratings.

- Core: Type X
- Thickness: 1/2," 5/8"
- Width: 4'
- Standard length: 8', 9', 10', 12'
- Edge detail: Tapered
- ASTM: C1396, Type X

LIGHTWEIGHT

Easi-Lite™ Lightweight Gypsum Board

A specially formulated interior gypsum board that is up to 30% lighter than 1/2" CertainTeed Regular. It is used for interior walls and ceilings (perpendicular to framing) up to 24" o.c. in standard residential or commercial applications.

- Core: Regular
- Thickness: 1/2"
- Width: 4', 54"
- Standard length: 8', 9', 10', 12'
- Edge detail: Tapered
- ASTM: C1396

MOISTURE AND MOLD RESISTANT

M2Tech® Gypsum Board

Moisture and mold resistant gypsum board specially formulated for applications where enhanced moisture and mold resistance is preferred or required. For use on interior walls and ceilings in standard residential, commercial and institutional applications.

- Core: Regular
- Thickness: 1/2"
- Width: 4'
- Standard length: 8', 9', 10', 12'
- Edge detail: Tapered
- ASTM: C1396

M2Tech® Type X Gypsum Board

Provides the same protection as M2Tech® Gypsum Board plus a specially formulated core for use in fire-resistive designs.

- Core: Type X
- Thickness: 5/8"
- Width: 4'
- Standard length: 8', 9', 10', 12'
- Edge detail: Tapered
- ASTM: C1396, Type X

M2Tech® Shaftliner Type X

Gypsum Shaftwall and Area Separation Firewall Systems have replaced traditional masonry for interior vertical enclosures, stairwells, elevator enclosures, mechanical chases and area separation walls. Some inherent advantages of these systems are: lightweight construction, thinner walls, ease and speed of installation and cleanup, and cost effective construction. M2Tech Shaftliner is specially formulated to provide enhanced protection against mold growth. For extended weather exposure applications, specify GlasRoc® Shaftliner Type X.

- Core: Type X
- Thickness: 1"
- Width: 2'
- Length: 8', 10', 12'
- Edge detail: Double beveled
- ASTM: C1396, Type X

SPECIALTY

CertainTeed 1/4" Flex

1/4" Flex is ideal for curved walls, staircases and ceilings, as well as column enclosures in low- and high-rise residences, sport facilities, schools, condominiums and office areas.

- Core: Regular
- Thickness: 1/4"
- Width: 4'
- Standard length: 8', 12'
- Edge detail: Tapered
- ASTM: C1396

CertainTeed Interior Ceiling

A solid set, gypsum core enclosed in ivory-colored face paper and a strong liner back paper, for use on interior ceilings where framing is spaced up to 24" o.c. (perpendicular to framing). Gypsum core is comprised of special sag-resistant additives.

- Core: Regular
- Thickness: 1/2"
- Width: 4'
- Standard length: 8', 12', 14'
- Edge detail: Tapered
- ASTM: C1396

Easi-Lite™ Veneer Plaster Base

Interior gypsum board with a specially formulated face paper for use under veneer plaster finishes. **Up to 30% lighter than regular Veneer Plaster Base.**

- Core: Regular
- Thickness: 1/2"
- Width: 4'
- Standard length: 8' to 12'
- Edge detail: Tapered
- ASTM: C1396

CertainTeed Veneer Plaster Base Type X

Interior gypsum board with a specially formulated face paper for use under veneer plaster finishes. Also features a specially formulated core for use in fire-resistive designs.

- Core: Type X
- Thickness: 5/8"
- Width: 4'
- Standard length: 8', 9', 10', 12'
- Edge detail: Square, Tapered
- ASTM: C1396, Type X

EXTERIOR

CertainTeed Sheathing Treated Core

A water-repellent gypsum sheathing for application to the outside of building framing members, and serves as the base for the exterior wall finish. Used as attachments to the outside of exterior wall framing as a water-resistant underlayment for various siding materials. For extended weather exposure applications, specify GlasRoc® Sheathing.

- Core: Regular
- Thickness: 1/2"
- Width: 2', 4'
- Standard length: 8', 9', 10', 12'
- Edge detail: Square
- ASTM: C1396

CertainTeed Sheathing Treated Core Type X

Provides the same use as CertainTeed Sheathing Treated Core plus a specially formulated core for use in fire-resistive designs. For extended exposure applications, specify GlasRoc Sheathing.

- Core: Type X
- Thickness: 5/8"
- Width: 4'
- Standard length: 8', 9', 10', 12'
- Edge detail: Square
- ASTM: C1396, Type X

CertainTeed Exterior Soffit Board

Used for the underside of eaves, carport ceilings, canopies and other commercial and residential exterior applications with indirect exposure to the weather.

- Core: Regular
- Thickness: 1/2"
- Width: 4'
- Standard length: 8', 12'
- Edge detail: Tapered
- ASTM: C1396

CertainTeed Exterior Soffit Board Type X

Provides the same use as Exterior Gypsum Soffit Board plus a specially formulated core for use in fire-resistive designs.

- Core: Type X
- Thickness: 5/8"
- Width: 4'
- Standard length: 8', 12'
- Edge detail: Tapered
- ASTM: C1396, Type X

HIGH PERFORMANCE GYPSUM BOARD

AirRenew® Essential IAQ Gypsum Board

The first and only wallboard available in North America with patent-pending VOC scavenging technology that actively improves indoor air quality. AirRenew® permanently removes formaldehyde circulating indoors, even through multiple coats of paints*. For use on interior walls and ceilings in residential, commercial or institutional applications, it installs, finishes and can be recycled like standard gypsum board. Contains up to 99% total recycled content.

- Core: Regular
- Thickness: 1/2"
- Width: 4', 54"
- Standard length: 8', 12'
- Edge detail: Tapered
- ASTM: C1396

*Based on tests and analysis

AirRenew® Essential IAQ Gypsum Board Type X

Provides the same benefits as AirRenew® Essential IAQ Gypsum Board, plus it includes a specially formulated, fire-resistive core.

- Core: Type X
- Thickness: 5/8"
- Width: 4'
- **Standard length: 8', 12'
- Edge detail: Tapered
- ASTM: C1396, Type X

**Special order only

AirRenew® M2Tech® IAQ Gypsum Board

AirRenew M2Tech provides the same VOC scavenging technology as AirRenew Essential plus the added benefits of M2Tech® moisture and mold resistance. Ideal for schools, hospitals or any application where improved indoor air quality is required. Provides the same protection as AirRenew M2Tech IAQ Gypsum Board plus a specially formulated core for use in fire-resistive designs.

- Core: Regular
- Thickness: 1/2"
- Width: 4'
- **Standard length: 8', 10', 12'
- Edge detail: Tapered
- ASTM: C1396, Type X

**Special order only

AirRenew® M2Tech® IAQ Gypsum Board Type X

Provides the same protection as AirRenew M2Tech IAQ Gypsum Board plus a specially formulated core for use in fire-resistive designs.

- Core: Type X
- Thickness: 5/8"
- Width: 4'
- Standard length: 8', 10', 12'
- Edge detail: Tapered
- ASTM: C1396, Type X

AirRenew® Extreme Abuse Resistant Type X

Provides the same benefits as AirRenew® M2Tech® Type X, plus it includes a specially formulated, dense, fire-resistive, moisture-resistant core. Engineered for use in areas where abuse resistance and improved air quality are required – such as classrooms, patient rooms and public buildings.

- Core: Type X
- Thickness: 5/8"
- Width: 4'
- Standard length: 8', 10', 12'
- Edge detail: Tapered
- ASTM: C1396, Type X

AirRenew® Extreme Impact Resistant Type X

Provides the same benefits as AirRenew® Extreme Abuse Resistant Type X, plus it contains fiberglass mesh reinforcement within the core. Engineered for use in areas requiring impact resistance and improved air quality – such as school and hospital corridors, gymnasiums, utility rooms, airport terminals and public buildings.

- Core: Type X
- Thickness: 5/8"
- Width: 4'
- Standard length: 8', 10', 12'
- Edge detail: Tapered
- ASTM: C1396, Type X

SilentFX® Noise-Reducing Gypsum Board

Specially engineered to reduce airborne sound transmission through walls and ceilings. Ideal for applications with high STC requirements. SilentFX® also features M2Tech technology to provide enhanced moisture and mold resistance.

- Core: Regular
- Thickness: Nominal 1/2"
- Width: 4'
- Standard length: 8', 10', 12'
- Edge detail: Tapered
- ASTM: C1396, Type X

SilentFX® Noise-Reducing Gypsum Board Type X

Provides the same protection as SilentFX® Noise-Reducing Gypsum Board plus a specially formulated core for use in fire-resistive designs.

- Core: Type X
- Thickness: 5/8"
- Width: 4'
- Standard lengths: 8', 10', 12'
- Edge detail: Tapered
- ASTM: C1396, Type X

HIGH PERFORMANCE GLASS MAT GYPSUM BOARD

Diamondback® GlasRoc® Tile Backer

1/4"

A water-resistant gypsum tile backer with embedded glass mats and a textured coated surface for use in residential and light commercial flooring.

- Core: Regular
- Thickness: 1/4"
- Sizes: 4' x 8', 4' x 4'
- Edge detail: Square
- ASTM: C1178

1/2"

A water-resistant gypsum tile backer with embedded glass mats and a textured coated surface for use in walls, ceilings and countertops in wet and non-wet residential and commercial applications.

- Core: Regular
- Thickness: 1/2"
- Sizes: 32" x 5', 3' x 5', 4' x 5', 4' x 8'
- Edge detail: Square
- ASTM: C1178

Diamondback® Tile Backer Type X

Provides the same use as Diamondback® GlasRoc® Tile Backer plus a specially formulated Type X gypsum core.

- Core: Type X
- Thickness: 5/8"
- Width: 4'
- Standard length: 5', 8'
- Edge detail: Square
- ASTM: C1178, Type X

GlasRoc® Shaftliner Type X

Shaftliner brings added protection to buildings in high-humidity and wet-weather areas and offers exceptional fire resistance in completed commercial and multi-family buildings.

- For use in elevator shafts, stairwells and area separation firewalls
- Consists of a 1-inch thick noncombustible, moisture-resistant core with reinforcing glass mats and a protective coating on the exterior surface
- Core: Type X
- Thickness: 1"
- Width: 2'
- Standard length: 8', 10', 12'
- Edge detail: Double beveled
- ASTM: C1396, C1658, Type X

EXTERIOR

GlasRoc® Sheathing

Weather-resistant gypsum sheathing produced with our proprietary Embedded Glass Reinforced Gypsum™ technology. Appropriate substrate in EIF Systems, conventional stucco systems, traditional cladding systems, exterior ceilings, soffit systems and exterior curved applications.

- Core: Regular
- Thickness: 1/2"
- Width: 4'
- Standard length: 8'
- Edge detail: Square
- ASTM: C1177

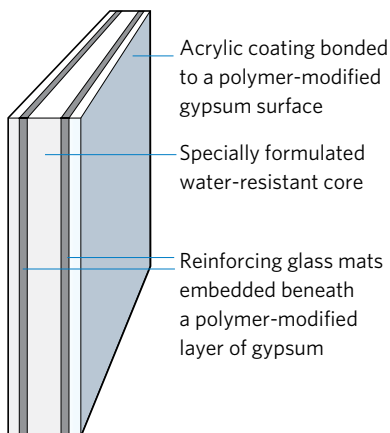

GlasRoc® Sheathing Type X

Weather-resistant Type X gypsum sheathing produced with our proprietary Embedded Glass Reinforced Gypsum™ technology. Appropriate substrate in EIF Systems, conventional stucco systems, traditional cladding systems, exterior ceilings, soffit systems and exterior curved applications.

- Core: Type X
- Thickness: 5/8"
- Width: 4'
- Standard Length: 8'
- Edge Detail: Square
- ASTM: C1177, Type X

GlasRoc® Roof Board

A high performance, paperless, moisture and mold resistant embedded glass mat gypsum roof board for use as a cover board, thermal barrier and recover board for use in mechanically attached low-slope commercial roofing systems.

- Core: Regular
- Thickness: 1/4", 1/2"
- Width: 4'
- Standard Length: 4', 8'
- Edge Detail: Square
- ASTM: C1177

GlasRoc® Roof Board Type X

Provides the same use as GlasRoc Roof Board plus a specially formulated Type X gypsum core.

- Core: Type X
- Thickness: 5/8"
- Width: 4'
- Standard Length: 4', 8'
- Edge Detail: Square
- ASTM: C1177

Green Glue Noiseproofing System

Noiseproofing Compound

Significantly reduces airborne noise between rooms in wall and floor/ceiling applications. Ideal for remodel, retrofit and new construction.

Easy cleanup, low odor and low VOC.

- 28 oz. tubes: 12 tubes/box
- Coverage: 192 sq. ft.

Noiseproofing Sealant

An economical, water-based, engineered acoustic sealant with easy cleanup, exceptional properties and no VOCs.

- 28 oz. tubes: 12 tubes/box
- Coverage: 85 linear ft. (1/4" bead)
- Standard length: 8'
- Edge detail: Square
- ASTM: C1177, Type X

CERTAINEED GYPSUM BOARD FINISHING PRODUCTS

JOINT TAPES AND CORNER REINFORCEMENT

Optimus™ Corner Bead

- Optimal strength and performance for the toughest, straightest edge
 - Easy to apply with standard drywall compounds
 - Available in 90 Degree, 3/8" Bullnose, Archway and L-Trim profiles
-

AquaBead™ Corner Bead

- Easy to apply, water-activated, self adhesive
 - Doesn't blister, bubble, dent or crack
 - Specially engineered beaded nose
 - Can be coated in 30 minutes
 - Available in 90 Degree, 3/4" Bullnose and L-Trim profiles
-

Easyflex™ Flexible and Easyflex™ PRO Flexible Corner Bead

- Easy to apply flexible corner bead
 - High performance flexible drywall corner
 - Comes in 100' rolls of various widths
 - Flexes into any inside or outside angle
 - Applied and finished with joint compound
-

Marco® Spark-Perf® Paper Tape

- Spark-perforated for easy pass-through of air to eliminate bubbles while retaining strength
- Manufactured from fibered-paper with added tensile strength to help prevent tearing, wrinkling or stretching
- Machine roughed for superior bonding
- Meets ASTM C475

Marco® Self Adhesive Fiberglass Mesh Tape

- Self adhesive for easy application
- Eliminates blisters and bubbles
- For use with setting compounds
- Meets ASTM C475

Marco® Metal Flex Corner Tape

- For inside and outside angles
- Fold to any angle
- Meets ASTM C1047

Marco® Plastic Flex Corner Tape

- For inside and outside angles
- Easy to cut and install
- Meets ASTM C1047



CEILINGS

CertainTeed is committed to providing innovative acoustical ceiling and wall solutions that contribute to a superior environment for the eye, the ear and the mind.

Trelisio®

Architectural woven metal finishes are fully integrated into Decoustics' single source, factory-fabricated panel system for both ceiling and wall applications. Woven wire acoustical panels can be used on ceiling or wall applications and are compatible with the Ceilencio® suspension system, allowing complete accessibility into the ceiling plenum.

Custom Curved S-Shaped and Wave Panels

Decoustics' Custom Curved S-Shaped and Wave acoustical panels help create a truly stunning and unique space. Panels consist of two-dimensional, pre-curved elements that use one or two radii throughout the S-Shape or Wave. Panels also offer versatile mounting options depending on plenum access requirements.

LightFrame®

LightFrame is a translucent ceiling and wall system that provides modular, accessible panels with light transmission rates up to 83% and NRC values of 0.90. The precision monofilament fabric optimizes artificial and natural light transfection without color shift, giving an even illumination. Extremely narrow seams and an elliptic profile ensure illuminated surfaces are practically shadow-free.

Quadrillo®

Quadrillo is a natural wood veneer finish that achieves acoustical absorption through Decoustics' unique perforation technology and a high-performance acoustical core. It's ideal for both wall and ceiling applications.

Although the perforated area of Quadrillo is only 4%, patented V-grooves create a four-sided "funnel" effect that captures and absorbs more sound. Quadrillo is available prefinished in clear lacquer or factory painted. Plus, Decoustics can provide custom lacquer toning, tinting and sheen to match other wood finishes.

Solo™

Solo is an acoustical wood plank consisting of a medium density fiberboard (MDF), finished in a natural wood veneer. The face is grooved, the plank is perforated from behind and the back is laminated with an acoustically transparent black mat, preventing insulation color from reading through.

The plank is cut to fit on-site and is typically installed on wood or steel furring with insulation placed behind the wood planks.

Solo-M™

Solo-M panels are a modified version of the standard Solo product and an economic alternative to Quadrillo finished panels. They offer large panels, design versatility and full customization. Solo-M is produced as a panel rather than planks and has the same quality standards, acoustic performance and fire rating as Solo.

Solo-M is available prefinished in clear lacquer or unfinished for post application. Decoustics can provide custom lacquer toning and sheen to match other wood finishes, and custom paint finishes are available. Veneer lay-up is produced as slip matched, quarter cut as a standard. Other veneer cuts and lay-up options are available.

Solo-M panels are available in both fully grooved and stop grooved formats, which should be considered during the design stage. Fully grooved panels create a monolithic appearance to panel layout. Alternatively, the stop grooving format adds an element of detail.

Solo-M maximum panel sizes vary depending on application and suspension methods.

Linear Grille and Linear Wood

Decoustics Linear Wood and Wood Grille ceilings enrich any space with the outstanding look of wood and ease of access. You can complement any design with a ceiling that produces an environment that looks truly natural.

With many finishes, sizes and configurations available, it's easy to incorporate the look of linear wood into your projects. You can choose from cherry, beech, maple and ash veneers — or specify a custom veneer finish that perfectly suits your design.

A convenient, heavy-duty T-bar grid system lets you add the distinctive charm of a wood ceiling without compromising on ease of installation and access. Configurations are available that provide complete access to the plenum.

WALL PANELS

Decoustics manufactures an extensive range of acoustical wall panels that provide aesthetically pleasing spaces while addressing room acoustics. Decoustics custom acoustical wall panels can be found in many applications, such as schools, offices, auditoriums and cafeterias.

AirRenew® Wall Panels

Improve indoor air quality, room hygiene and acoustics with Decoustics' fabric wrapped wall and ceiling panels featuring AirRenew fabric technology. They actively improve indoor air quality by removing potentially harmful VOCs from the air.

Benefits of AirRenew Fabric Technology:

- Safely converts VOCs into carbon dioxide (CO₂) and water
- Breaks down pollutants and odors
- Protects against bacteria growth and transmission that could otherwise damage or discolor panels
- Panel construction absorbs sound for improved room acoustics
- Ideal for schools, hospitals, nursing homes and offices
- Class A flame spread (less than 25) when tested in accordance with ASTM E84

Ceilencio®

Ceilencio can be tailored to perfectly complement your designs, without sacrificing convenience and performance. Each Ceilencio suspension system is custom designed, engineered and manufactured to meet the needs of your design.

Design flexibility doesn't mean you have to sacrifice convenience or performance. Along with the beauty Ceilencio lends to a project, it also brings a unique versatility. Ceilencio can be integrated with a number of Decoustics materials and finishes, both acoustical and non-acoustical depending on the needs of your project. It also installs easily, and is 100% downward accessible.

FINISHES AND OPTIONS

Decoustics' custom acoustical ceiling and wall products come in a wide variety of finishes, with several options. Architects and designers rely on Decoustics' custom finished to provide a unique appearance to a variety of spaces while providing superb acoustical performance. Our finishes and options include:

Claro: The classic appearance of drywall or plaster; can be custom color matched to a paint chip.

Metallo: A contemporary look achieved by integrating metalized components to provide luster and sparkle.

Design Returns: For custom acoustical ceiling panels; provide visual impressions of depth and thickness while architecturally concealing lighting elements and suspensions. They can be shaped and custom curved to match the ceiling panel.

Fabric Finishes: Available in a variety of natural and synthetic textiles, all are tested for acoustical transparency.

Vinyl Finishes: Array of varieties available, all tested for suitability for various applications.

Madero: Collection of natural wood veneered acoustical finishes that are ideal for both wall and ceiling applications.

VOC Compliant Focus™ A, Focus™ A XL

Features & Benefits:

- Exclusive 3RD™ technology combines a high content of recycled glass with a renewable plant-based binding agent completely replacing traditional petroleum-based binding
- Reduces excess noise to help create a more productive work environment
- Extremely low particle emissions (class 100)
- Akutex FT white finish has exceptional light diffusion (+99%)
- Sag and mold-resistant
- Tissue backing and edge paint treatment provide fully encapsulated fiberglass panels

Applications:

- Open plan offices
- Classrooms (walls-to-deck)
- Conference rooms (walls-to-deck)
- Private offices (walls-to-deck)
- Patient rooms (walls-to-deck)
- Healthcare (walls-to-deck)
- Libraries

Edge Detail:

- 15/16" trim

VOC Compliant Focus™ E, Focus™ E XL

Features & Benefits:

- Exclusive 3RD™ technology combines a high content of recycled glass with a renewable plant-based binding agent completely replacing traditional petroleum-based binding
- Reduces excess noise to help create a more productive work environment
- Extremely low particle emissions (class 100)
- Akutex FT white finish has exceptional light diffusion (+99%)
- Sag and mold-resistant
- Tissue backing and edge paint treatment provide fully encapsulated fiberglass panels
- Moisture-resistant

Applications:

- Open plan offices
- Classrooms (walls-to-deck)
- Conference rooms (walls-to-deck)
- Private offices (walls-to-deck)
- Patient rooms (walls-to-deck)
- Doctor's offices (walls-to-deck)
- Libraries

Edge Detail:

- 15/16" reveal
- 9/16" narrow reveal

Focus™ Dg , Focus™ Dg XL

Features & Benefits:

- Superior sound absorption
- Reduces excess noise to help create a more productive work environment
- Extremely low particle emissions (class 100)
- Wide selection of sizes up to 8' lengths
- Akutex FT white finish has exceptional light diffusion (+99%)
- Available in 9 colors
- Sag and mold-resistant
- Tissue backing and edge paint treatment provide fully encapsulated fiberglass panels

Applications:

- Public lobbies
- Open plan offices (walls-to-deck)
- Healthcare
- Galleries
- Libraries
- Doctor's offices (walls-to-deck)
- Patient rooms (walls-to-deck)

Edge Detail:

- Semi-concealed suspension yet easy to access
- 5/16" narrow reveal

Focus™ Ds, Focus™ Ds XL

Features & Benefits:

- Reduces excess noise to help create a more productive work environment
- Monolithic surface simulates drywall finished appearance
- Extremely low particle emissions (class 100)
- Akutex FT white finish has exceptional light diffusion (+99%)
- Available in 9 new colors
- Sag and mold-resistant
- Tissue backing and edge paint treatment provide fully encapsulated fiberglass panels

Applications:

- Public lobbies
- Conference rooms (walls-to-deck)
- Offices (walls-to-deck)
- Galleries
- Healthcare (walls-to-deck)
- Classrooms (walls-to-deck)

Edge Detail:

- Fully concealed suspension yet easy to access

Focus™ F

Features & Benefits:

- Reduces excess noise to help create a more productive work environment
- Direct attachment by glue or concrete screws or indirect attachment to wood furring
- Monolithic surface simulates drywall finish
- Extremely low particle emissions (class 100)
- Akutex FT white finish has exceptional light diffusion (+99%)
- Available in 9 colors
- Sag and mold-resistant
- Tissue backing and edge paint treatment provide fully encapsulated fiberglass panels

Applications:

- Churches
- Offices (walls-to-deck)
- Schools
- Restaurants
- Healthcare (walls-to-deck)
- Classrooms (walls-to-deck)
- Doctor's offices (walls-to-deck)

Edge Detail:

- Tongue and groove

Gedina™ A, Gedina™ A XL

Features & Benefits:

- Superior sound absorption
- Standard suspension profiles
- Extremely low particle emissions (class 100)
- Wide selection of sizes
- Sag and mold-resistant
- Akutex T white finish has exceptional light diffusion (+99%)
- Unique dimensions offer ease of installation and maintenance

Applications:

- Offices (walls-to-deck)
- Educational
- Healthcare (walls-to-deck)
- Libraries
- Hospitality
- Resorts

Edge Detail:

- 15/16" trim edge

Gedina™ E, Gedina™ E XL

Features & Benefits:

- Superior sound absorption
- Standard suspension profiles
- Extremely low particle emissions (class 100)
- Wide selection of sizes
- Sag and mold-resistant
- Akutex T white finish has exceptional light diffusion (+99%)

Applications:

- Offices
- Educational (walls-to-deck)
- Healthcare (walls-to-deck)
- Libraries
- Hospitality
- Resorts

Edge Detail:

- 15/16" reveal
- 9/16" narrow reveal

Hygiene® Advance™

Features & Benefits:

- Reduces excess noise to help create a more productive work environment
- Will withstand daily high-pressure washing and daily washing with disinfecting chemicals
- Extremely low particle emissions (class 100)
- Meets USDA/FSIS sanitary guidelines for food processing areas
- Approved for use in federally registered Canadian food establishments
- Fully encapsulated fiberglass panels

Applications:

- Commercial kitchens
- Healthcare (walls-to-deck)
- Labs
- Clean manufacturing
- Patient rooms (walls-to-deck)
- Conference rooms (walls-to-deck)

Edge Detail:

- 15/16" reveal

Hygiene® Labotec™

Features & Benefits:

- Reduces excess noise to help create a more productive work environment
- Monolithic surface ideal for clean room application
- Extremely low particle emissions (class 100)
- Will withstand weekly washing with disinfecting chemicals
- Painted edges and back allow for wet cleaning on all sides
- Tissue backing and edge paint treatment provide fully encapsulated fiberglass panels

Applications:

- Labs
- Clean rooms
- Pharmaceutical manufacturing
- Bottling facilities
- Food processing
- Healthcare

Edge Detail:

- 15/16" fully concealed suspension yet easy to access

Hygiene® Meditec™

Features & Benefits:

- Reduces excess noise to help create a more productive work environment
- Ideal for use in medical applications
- Extremely low particle emissions (class 100)
- Will withstand weekly washing with disinfecting chemicals
- Will withstand steam cleaning 4 times/year

Applications:

- Patient rooms (walls-to-deck)
- NICUs (walls-to-deck)
- Labs
- Exam rooms
- Healthcare (walls-to-deck)
- Patient rooms (walls-to-deck)

Edge Detail:

- 15/16" trim
- 15/16" narrow reveal

Hygiene® Performance™

Features & Benefits:

- Reduces excess noise to help create a more productive work environment
- Will withstand weekly washing with disinfecting chemicals and low-pressure washing twice a year
- Extremely low particle emissions (class 100)
- Meets USDA/FSIS sanitary guidelines for food processing areas
- Approved for use in federally registered Canadian food establishments
- Tissue backing and edge paint treatment provide fully encapsulated fiberglass panels

Applications:

- Commercial kitchens
- Food processing
- Clean manufacturing
- Patient rooms (walls-to-deck)
- Doctor's offices (walls-to-deck)
- Classrooms (walls-to-deck)

Edge Detail:

- 15/16" trim

Hygiene® Protec™

Features & Benefits:

- Reduces excess noise to help create a more productive work environment
- Will withstand weekly washing with disinfecting chemicals and low-pressure washing twice a year
- Extremely low particle emissions (class 100)
- Meets USDA/FSIS sanitary guidelines for food processing areas
- Approved for use in federally registered Canadian food establishments

Applications:

- Commercial kitchens
- Food processing
- Clean manufacturing
- Patient rooms (walls-to-deck)
- Doctor's offices (walls-to-deck)

Edge Detail:

- 15/16" trim

Solo Baffle

Features & Benefits:

- Reduces excess noise to help create a more productive work environment
- Ideal for spaces where wall-to-wall ceilings are not possible
- Baffles are demountable
- Easy to install
- Will withstand weekly wet wiping
- Laminated front and back with fully painted edges

Applications:

- Classrooms
(walls-to-deck)
- Offices
(walls-to-deck)
- Hallways
- Restaurants

Solo

Features & Benefits:

- Free-hanging ceiling and/or wall-mounted panel with superior sound absorption
- 3 different ceiling or wall mounting methods for ease of installation
- Simple integration of lighting components
- Laminated front and back with fully painted edges
- Akutex FT white finish has exceptional light diffusion (+99%)
- Available in 9 colors and 11 shapes

Applications:

- Auditoriums
- Classrooms
(walls-to-deck)
- Restaurants
- Offices
(walls-to-deck)

Texona Wall Panels

Features & Benefits:

- Use as a complement and/or alternative to acoustical ceiling panels for excellent performance within a space
- Smooth surface texture
- Moisture-resistant
- Available in 16 colors

Applications:

- Open plan offices
- Classrooms (walls-to-deck)
- Libraries

Super G Wall Panels®

Features & Benefits:

- Use as a complement and/or alternative to acoustical ceiling panels for excellent acoustical performance within a space
- High impact-resistant
- Moisture-resistant

Applications:

- Classrooms (walls-to-deck)
- Gymnasiums
- Recreation rooms
- Libraries

BIG® Quattro 41™

Features & Benefits:

- Large 2400 mm x 1200 mm x 12.5 mm gypsum panel for monolithic wall to ceiling finish
- Smooth, paintable surface simplifies installation and maintenance
- Suitable for direct or suspended screw mounting (Gyptone grid also available)
- Complementary Gyptone Quattro 20 ceiling tiles available for each pattern
- VOC Compliant to California Dept. of Health Standard Method version 1.1, 2010
- Health Product Declaration (HPD) available for this product

Applications:

- Conference rooms
- Healthcare facilities
- Classrooms
- Offices

Edge Detail:

- Designed with tapered edges for easy installation and finishing

BIG® Quattro 46™

Features & Benefits:

- Large 2400 mm x 1200 mm x 12.5 mm gypsum panel for monolithic wall to ceiling finish
- Smooth, paintable surface simplifies installation and maintenance
- Suitable for direct or suspended screw mounting (Gyptone grid also available)
- Complementary Gyptone Quattro 20 ceiling tiles available for each pattern
- VOC Compliant to California Dept. of Health Standard Method version 1.1, 2010
- Health Product Declaration (HPD) available for this product

Applications:

- Conference rooms
- Healthcare facilities
- Classrooms
- Offices

Edge Detail:

- Designed with tapered edges for easy installation and finishing

BIG® Sixto 63™

Features & Benefits:

- Large 2400 mm x 1200 mm x 12.5 mm gypsum panel for monolithic wall to ceiling finish
- Smooth, paintable surface simplifies installation and maintenance
- Suitable for direct or suspended screw mounting (Gyptone grid also available)
- Complementary Gyptone Sixto 60™ ceiling tiles available for each pattern
- VOC Compliant to California Dept. of Health Standard Method version 1.1, 2010
- Health Product Declaration (HPD) available for this product

Applications:

- Conference rooms
- Classrooms
- Healthcare facilities
- Offices

Edge Detail:

- Designed with tapered edges for easy installation and finishing

BIG® Sixto 65™

Features & Benefits:

- Large 2700 mm x 900 mm x 12.5 mm gypsum panel for monolithic wall to ceiling finish
- Smooth, paintable surface simplifies installation and maintenance
- Suitable for direct or suspended screw mounting (Gyptone grid also available)
- Complementary Gyptone Sixto 60™ ceiling tiles available for each pattern
- VOC Compliant to California Dept. of Health Standard Method version 1.1, 2010
- Health Product Declaration (HPD) available for this product

Applications:

- Conference rooms
- Classrooms
- Healthcare facilities
- Offices

Edge Detail:

- Designed with tapered edges for easy installation and finishing

BIG® Line 6™

Features & Benefits:

- Large 2400 mm x 1200 mm x 12.5 mm gypsum panel for monolithic wall to ceiling finish
- Smooth, paintable surface simplifies installation and maintenance
- Suitable for direct or suspended screw mounting (Gyptone grid also available)
- Complementary Gyptone Line 4 lay-in ceiling tiles available for each pattern
- VOC Compliant to California Dept. of Health Standard Method version 1.1, 2010
- Health Product Declaration (HPD) available for this product

BIG® Line 6™ *continued*

Applications:

- Conference Rooms
- Classrooms
- Healthcare Facilities
- Offices

Edge Detail:

- Designed with tapered edges for easy installation and finishing

Base 31™

Features & Benefits:

- 24" x 24" x 1/2" painted panel
- Complementary product used with Gyptone® Line 4™, Point 11™, Quattro 20™ and Sixto 60™ ceiling panels
- Easy plenum access
- No added formaldehyde
- Health Product Declaration (HPD) available for this product

Applications:

- Stores
- Airports
- Offices
- Schools
- Atriums
- Healthcare facilities
- Corridors

Line 4™

Features & Benefits:

- 24" x 24" x 1/2" painted panel
- Durable
- Punched gypsum panel
- Easy plenum access
- Sound absorbent
- Health Product Declaration (HPD) available for this product
- Unique aesthetic appeal
- No added formaldehyde

Applications:

- Stores
- Corridors
- Airports
- Schools
- Offices
- Atriums
- Healthcare facilities

Point 11™

Features & Benefits:

- 24" x 24" x 1/2" painted panel
- Punched gypsum panel
- Sound absorbent
- Unique aesthetic appeal
- No added formaldehyde
- Durable
- Easy plenum access
- Health Product Declaration (HPD) available for this product

Applications:

- Stores
- Airports
- Offices
- Corridors

Quattro 20™

Features & Benefits:

- 24" x 24" x 1/2" painted panel
- Punched gypsum panel
- Sound absorbent
- Unique aesthetic appeal
- No added formaldehyde
- Durable
- Easy plenum access
- Health Product Declaration (HPD) available for this product

Applications:

- Stores
- Airports
- Offices
- Corridors
- Schools
- Atriums

Sixto 60™

Features & Benefits:

- 24" x 24" painted panel
- Punched gypsum panel
- Sound absorbent
- Unique aesthetic appeal
- No added formaldehyde
- Durable
- Easy plenum access
- Health Product Declaration (HPD) available for this product

Applications:

- Stores
- Airports
- Offices
- Corridors
- Schools
- Atriums

Adagio®

Features & Benefits:

- Only product to meet NICU requirements per FGI guidelines for combined NRC and CAC performance
- Unique composite panel with optimal sound absorption and attenuation
- Encapsulated fiberglass layer provides exceptional sound absorption and acoustic comfort (0.90 NRC—Class A absorber)
- Offers highly effective sound containment (CAC 36-38)
- Can enhance space privacy compliance (Assists with HIPAA requirements in healthcare)
- Overtone® finish features extremely high light reflectance (LR 0.90)
- Mix with other Overtone® finish products for Fine Tuning capabilities
- Exceeds FGI Guidelines for cleanability and acoustic performance

Applications:

- Private offices
- Medical treatment/exam rooms
- Conference rooms
- Music rooms

Edge Detail:

- 15/16" trim
- 15/16" reveal
- 9/16" narrow reveal

Adagio® High CAC

Features & Benefits:

- Only product to meet NICU requirements per FGI guidelines for combined NRC and CAC performance
- Unique composite panel with optimum sound absorption and attenuation
- Encapsulated fiberglass layer provides exceptional sound absorption and acoustic comfort (0.80 NRC—Class A absorber)
- Offers exceptional sound containment (CAC 40-42)
- Can enhance space privacy compliance (Assists with HIPAA requirements in healthcare spaces)
- Overtone® finish features extremely high light reflectance (LR 0.90)
- Mix with other Overtone finish products for Fine Tuning capabilities
- Exceeds FGI Guidelines for cleanability and acoustic performance

Applications:

- Private offices
- Patient rooms
- Medical treatment/exam rooms
- Music rooms
- Conference rooms

Edge Detail:

- 15/16" trim
- 15/16" reveal
- 9/16" narrow reveal

Aquarock™

Features & Benefits:

- Paperless, fiberglass-reinforced gypsum substrate that is mold and impact resistant
- Sag resistant with exceptional indoor/outdoor performance in applications up to 95% relative humidity
- Vinyl facing cleanable with most sanitizing chemicals
- Scrub tested to 2000+ cycles with no sign of wear
- Extremely low particle emissions (100)
- Satisfies USDA/FSIS guidelines for sanitary applications
- Approved for use in federally registered Canadian food establishments

Applications:

- Parking garages
- Pools
- Commercial kitchens
- Locker rooms
- Shower rooms

Edge Detail:

- 15/16" trim

Baroque™

Features & Benefits:

- 100% non-directional fissured pattern
- Variety of edge detail options and panel sizes
- No added formaldehyde
- Third-party verified Environmental Product Declaration (EPD) and Health Product Declaration (HPD) available
- Available in fire-rated (Protectone®) version

Applications:

- Utility areas
- Discount retail

Edge Detail:

- 15/16" trim
- 15/16" reveal, corner bevel
- 9/16" narrow reveal, corner bevel
- 9/16" narrow reveal, corner bevel bolt slot

Baroque™ Customline®

Features & Benefits:

- Three geometric designs with 100% non-directional fissured pattern
- Clean, three-dimensional scoring, free of fissures or pin perforations
- Product's deep scoring complements the suspension system, masking the metal grid
- No added formaldehyde
- Third-party verified Environmental Product Declaration (EPD) and Health Product Declaration (HPD) available

Applications:

- Utility areas
- Discount retail
- Strip malls
- Commercial interior spaces
- Offices

Edge Detail:

- 15/16" reveal, corner bevel
- 9/16" narrow reveal, beveled

Cashmere®

Features & Benefits:

- Upscale appearance
- Finely textured
- Available in six standard colors including white
- Available in fire-rated (Protectone®) versions
- No added formaldehyde
- Third-party verified Environmental Product Declaration (EPD) and Health Product Declaration (HPD) available

Applications:

- Offices
- Healthcare areas
- Retail/department stores
- Hospitality areas

Edge Detail:

- 15/16" trim
- 15/16" reveal, corner bevel
- 9/16" narrow reveal, corner bevel
- 9/16" narrow reveal, corner bevel bolt slot

Cashmere® Customline®

Features & Benefits:

- Upscale appearance
- Finely textured
- Clean, linear scoring
- Scored options for added visual impact
- Product's deep scoring complements the suspension system, masking the metal grid
- No added formaldehyde
- Third-party verified Environmental Product Declaration (EPD) and Health Product Declaration (HPD) available

Applications:

- Offices
- Healthcare
- Hospitality areas
- Conference rooms
- Retail/department stores

Edge Detail:

- 15/16" reveal, corner bevel
- 9/16" narrow reveal, beveled

Cashmere® High NRC

Features & Benefits:

- Upscale appearance
- Finely textured
- Popular edge detail options
- Excellent sound absorption
- No added formaldehyde
- Third-party verified Environmental Product Declaration (EPD) and Health Product Declaration (HPD) available

Applications:

- Offices
- Healthcare areas
- Retail/department stores
- Conference centers
- Hospitality/resorts

Edge Detail:

- 15/16" trim
- 15/16" reveal, corner bevel
- 9/16" narrow reveal, corner bevel
- 9/16" narrow reveal, corner bevel bolt slot

Cashmere® Style Edge

Features & Benefits:

- Upscale appearance
- Fine texture with three highly decorative edge detail options
- No added formaldehyde
- Third-party verified Environmental Product Declaration (EPD) and Health Product Declaration (HPD) available

Applications:

- Offices
- Healthcare areas
- Retail/department stores
- Hospitality areas
- Conference centers

Edge Detail:

- 9/16" fluted reveal
- 9/16" ogee reveal
- 9/16" tier reveal
- 15/16" tier reveal

Directional Fissured

Features & Benefits:

- Economical directional fissured pattern
- Third-party verified Environmental Product Declaration (EPD) and Health Product Declaration (HPD) available
- Available in fire-rated (Protectone®) versions
- No added formaldehyde

Applications:

- Utility areas
- Discount areas
- Strip malls
- Commercial interior spaces

Edge Detail:

- 15/16" trim

Envirogard™

Features & Benefits:

- Gypsum core with vinyl facing, vinyl backing and sealed edges
- Specially designed for low particulate emission and maximum cleanability
- Surface suitable for cleaning with common disinfecting chemicals
- Exceeds FGI Guidelines for cleanability in healthcare spaces
- Satisfies USDA/FSIS guidelines for sanitary applications
- Approved for use in federally registered Canadian food establishments
- Extremely low particle emissions (class 100)
- No added formaldehyde

Applications:

- Food preparation areas
- Laboratories
- Sterile environments
- Treatment rooms
- Clean room environments
- Photo processing

Edge Detail:

- 15/16" trim

Fine Fissured

Features & Benefits:

- 100% non-directional pattern
- Available in fire-rated (Protectone®) versions
- Variety of edge detail options and panel sizes
- High humidity and sag resistant
- Third-party verified Environmental Product Declaration (EPD) and Health Product Declaration (HPD) available
- No added formaldehyde

Applications:

- Schools
- Libraries
- Retail/department stores
- Offices

Edge Detail:

- 15/16" trim
- 15/16" reveal, corner bevel
- 9/16" narrow reveal, corner bevel
- 9/16" narrow reveal, corner bevel bolt slot

Fine Fissured Customline®

Features & Benefits:

- Three dramatic geometric designs with discreet small scale fissure pattern
- Third-party verified Environmental Product Declaration (EPD) and Health Product Declaration (HPD) available
- Product's deep scoring complements the suspension system, masking the metal grid
- No added formaldehyde
- Available in fire-related (Protectone®) versions

Applications:

- Hospitality
- Retail
- Offices
- Education
- Healthcare
- Restaurants

Edge Detail:

- 15/16" reveal
- 9/16" narrow reveal, beveled

Fine Fissured High NRC

Features & Benefits:

- 100% non-directional fissure pattern
- Assists in addressing HIPAA and FGI acoustical and privacy requirements
- Excellent for projects requiring high sound absorption
- Third-party verified Environmental Product Declaration (EPD) and Health Product Declaration (HPD) available
- No added formaldehyde
- Complies with LEED® for Schools classroom acoustics pre-requisite

Applications:

- Schools/classrooms
- Libraries/media centers
- Computer rooms
- Healthcare spaces
- Open plan areas

Edge Detail:

- 15/16" trim
- 15/16" reveal, corner bevel

Landmark™

Features & Benefits:

- Exciting mix of texture and nostalgia
- Wide range of decorative embossed metal panels combined with authentic cornice and perimeter treatments for a rich diversity of interior design options
- Variety of panel sizes, profiles, patterns and finishes available to the designer

Applications:

- Retail
- Restaurants
- Resorts
- Historic renovations

Edge Detail:

- 15/16" flat lay-in
- 15/16" reveal edge
- Concealed snap-in

Open Plan™

Features & Benefits:

- Excellent sound absorption for speech privacy
- High R-value helps cut energy costs
- Humidity resistant
- Mat backing (encapsulation) available as an option
- Foil backing for increased CAC available as an option
- Completely painted edge available as an option

Applications:

- Open plan office
- Classrooms
- Libraries
- Theaters
- Houses of worship

Edge Detail:

- 15/16" trim
- 15/16" reveal
- 9/16" narrow reveal

Rx Symphony® f

Features & Benefits:

- Superior stain resistance and water repellency
- Cleanable with most sanitizing chemicals and wash-tested to 2,000+ cycles
- Exceeds FGI Guidelines for cleanability and acoustic performance in most healthcare applications
- VOC Compliant to CDPH/EHLB/Standard Method version 1.1 (2010)
- Satisfies USDA/FSIS guidelines for sanitary applications
- Outstanding acoustical and thermal value, high light reflectance and humidity resistance
- Exceptional durability/scrubbability
- Third-party verified Environmental Product Declaration (EPD) and Health Product Declaration (HPD) available

Applications:

- Patient rooms
- Treatment rooms
- Nurses stations
- Emergency rooms
- Corridors
- Semi-restricted surgical areas
- Lavatories and restrooms
- Kitchen/food prep areas

Edge Detail:

- 15/16" trim
- 15/16" reveal
- 9/16" narrow reveal

Rx Symphony® g

Features & Benefits:

- Superior stain resistance and water repellency
- Cleanable with most sanitizing chemicals and wash-tested to 2,000+ cycles
- Exceeds FGI Guidelines for cleanability and acoustic performance in most healthcare applications
- Certified for clean room design to ISO Class 4 (trim edge)
- Gypsum core with reinforced mat face
- High CAC blocks unwanted noise from adjoining spaces
- Exceptional durability/scrubbability
- Third-party verified Environmental Product Declaration (EPD) and Health Product Declaration (HPD) available

Applications:

- Patient rooms
- Treatment rooms
- Nurses stations
- Emergency rooms
- Corridors
- Semi-restricted surgical areas
- Lavatories and restrooms
- Kitchen/food prep areas

Edge Detail:

- 15/16" trim

Rx Symphony® m

Features & Benefits:

- Superior stain resistance and water repellency
- Mineral core with reinforced mat face
- Exceeds FGI Guidelines for acoustic performance in most healthcare applications
- Certified for clean room design to ISO Class 4 (trim edge)
- Cleanable with most sanitizing chemicals and wash-tested to 2,000+ cycles
- High light reflectance, increasing employee performance by minimizing fatigue
- VOC compliant with California Department of Public Health Standard Method V1.1, 2010
- Exceptional durability/scrubbability
- Third-party verified Environmental Product Declaration (EPD) and Health Product Declaration (HPD) available

Applications:

- Patient rooms
- Treatment rooms
- Nurses stations
- Emergency rooms
- Corridors
- Semi-restricted surgical areas
- Lavatories and restrooms
- Kitchen/food prep areas

Edge Detail:

- 15/16" trim
- 15/16" reveal
- 9/16" narrow reveal
- 9/16" bolt slot

Sand Micro™

Features & Benefits:

- Non-directional visual
- High humidity and sag resistant
- Third-party verified Environmental Product Declaration (EPD) and Health Product Declaration (HPD) available
- Lightly textured surface provides attractive finish with excellent light reflectance and enhanced durability
- Micro-perforated for sound absorption
- No added formaldehyde

Applications:

- Schools
- Retail/department stores
- Corridors
- Hospitality spaces

Edge Detail:

- 15/16" trim
- 15/16" reveal, corner bevel
- 9/16" narrow reveal, corner bevel
- 9/16" narrow reveal, corner bevel bolt slot

Sand Micro™ Customline®

Features & Benefits:

- Upscale look that offers durability and resists sagging
- Third-party verified Environmental Product Declaration (EPD) and Health Product Declaration (HPD) available
- Scoring gives the appearance of 2' x 2' reveal in a 2' x 4' panel
- No added formaldehyde

Applications:

- Retail/department stores
- Schools
- Corridors
- Hospitality spaces

Edge Detail:

- 15/16" reveal, corner bevel

School Board®

Features & Benefits:

- Up to 25% higher surface hardness than conventional wet-felted ceiling products per ASTM C 367 testing
- Third-party verified Environmental Product Declaration (EPD) and Health Product Declaration (HPD) available
- Available in fire-rated (Protectone®) versions
- No added formaldehyde
- Shares surface pattern with other Fine-Fissured products

Applications:

- Schools
- Corridors
- Dorms
- Day care centers
- Commercial interior spaces

Edge Detail:

- 15/16" trim

VOC Compliant Symphony® *f*

Features & Benefits:

- Superior sound absorption (NRC 0.80-0.95)
- Exceeds FGI Guidelines for cleanability and acoustic performance
- Surface washability exceeds 1000 cycles with sanitizing chemicals
- Suitable clean room component to ISO Class 4
- Overtone® finish features extremely high light reflectance (LR 0.90)
- Perfect for enhanced speech privacy and exceptional productivity in open plan environment
- Third-party verified Environmental Product Declaration (EPD) available
- Moisture resistant
- Mix with other Overtone finish products, Symphony® *m* and *g*, for Fine Tuning possibilities

Applications:

- Open plan areas
- Offices
- Waiting rooms
- Nurses stations
- Libraries
- Computer rooms

Edge Detail:

- 15/16" trim
- 15/16" reveal
- 9/16" narrow reveal

Symphony® *g*

Features & Benefits:

- Gypsum core with reinforced mat face
- High light reflectance enhances conventional lighting, increasing employee performance by minimizing fatigue and eye strain
- High CAC blocks unwanted noise from adjoining spaces
- Surface washability exceeds 1000 cycles with sanitizing chemicals
- Design with other Overtone® finish products, Symphony® *f* and *m*, for Fine Tuning possibilities
- Meets LEED® 2009 and v4 VOC Compliance Guidelines

Applications:

- Auditoriums
- Closed plan areas
- Offices (with other Symphony products)
- Healthcare (with other Symphony products)

Edge Detail:

- 15/16" trim

Symphony® *m*

Features & Benefits:

- Excellent sound absorption (NRC 0.70)
- Exceeds FGI Guidelines for cleanability and acoustic performance
- Third-party verified Environmental Product Declaration (EPD) and Health Product Declaration (HPD) available
- High light reflectance enhances conventional lighting, increasing employee performance by minimizing fatigue and eye strain
- Mix with other Overtone® finish products, Symphony® *f* and *g*, for best acoustical results
- Compliant with LEED® for Schools classroom acoustic prerequisite
- Surface washability exceeds 1000 cycles with sanitizing chemicals
- Suitable for clean room component to ISO Class 4
- Compliant with CA Dept. of Public Health Standard Method Version 1.1-2010

Applications:

- Private offices
- Classrooms
- Patient rooms
- Conference rooms
- Doctor's offices
- Exam/treatment rooms
- Libraries

Edge Detail:

- 15/16" trim
- 15/16" reveal, corner bevel
- 9/16" narrow reveal, corner bevel
- 9/16" narrow reveal, corner bevel bolt slot

Theatre® Black *f*

Features & Benefits:

- Specifically developed to meet acoustical requirements for theater applications
- Matte finish provides extremely low surface reflectivity
- Creates a unique atmosphere from the typical white tile application
- Humidity and sag resistant

Applications:

- Theaters
- School auditoriums
- Dark rooms
- Projection rooms
- Commercial interior spaces

Edge Detail:

- 15/16" trim

TufCore™

Features & Benefits:

- Combines the NRC advantages of fiberglass with high CAC gypsum board in a single panel
- Overtone® surface exceeds FGI guidelines for cleanability and acoustics
- Available in a variety of finish options and edge details
- Enhance speech privacy (for HIPAA and GLBA compliance)
- Especially well-suited to minimize sound transmission between adjacent spaces sharing a common plenum

Applications:

- Classrooms
- Computer rooms
- Corridors
- Private offices
- Exam rooms
- Doctor's offices
- Treatment rooms
- Media centers

Edge Detail:

- 15/16" trim
- 15/16" reveal
- 9/16" narrow reveal

Vantage 10™

Features & Benefits:

- High humidity and sag resistant
- Available in fire-rated (Protectone®) versions
- Non-directional pattern
- Classic mineral ceilings look with sag resistant core
- Third-party verified Environmental Product Declaration (EPD) available for this product
- No added formaldehyde

Applications:

- Schools
- Retail/department stores
- Many commercial interior spaces

Edge Detail:

- 15/16" trim
- 15/16" reveal, corner bevel
- 9/16" narrow reveal, corner bevel
- 9/16" narrow reveal, corner bevel bolt slot

Versatone™

Features & Benefits:

- Ideally suited for environments where economical installation and low maintenance are primary considerations
- Excellent sound absorption
- Humidity resistant

Applications:

- Utility areas
- Retail/department stores
- Strip malls
- Commercial interior spaces

Edge Detail:

- 15/16" trim

Vinylrock™

Features & Benefits:

- Vinyl-faced, highly durable gypsum panel
- Appropriate for use in ceilings that require repeated cleaning, and suitable for cleaning with common disinfecting chemicals
- Satisfies USDA/FSIS guidelines for sanitary applications
- Exceeds FGI Guidelines for cleanability
- Approved for use in federally registered Canadian food establishments
- Extremely low particle emissions (class 100)
- No added formaldehyde

Applications:

- Hospitals
- Food processing
- Commercial kitchens
- Restrooms
- Loading docks

Edge Detail:

- 15/16" trim

VinylShield™ A

Features & Benefits:

- Designed for sanitary and Clean Room applications or where low particle emission and maximum cleanliness are required
- Exceeds FGI Guidelines for cleanability
- Suitable for cleaning with common disinfecting chemicals
- Satisfies USDA/FSIS guidelines for sanitary applications
- Approved for use in federally registered Canadian food establishments
- Extremely low particle emissions (class 100)
- No added formaldehyde
- Vinyl facing provides an easy-to-clean, abuse and stain-resistant ceiling perfect for restrooms, laboratories, hospitals and sanitary food service areas
- Third-party verified Environmental Product Declaration (EPD) and Health Product Declaration (HPD) available

Applications:

- Clean rooms
- Restaurants
- Food preparation areas
- Laboratories
- Sterilization areas

Edge Detail:

- 15/16" trim

VinylShield™ C

Features & Benefits:

- Designed for sanitary and Clean Room applications or where low particle emission and maximum cleanliness are required
- Exceeds FGI Guidelines for cleanability
- Suitable for cleaning with common sanitizing chemicals
- Satisfies USDA/FSIS guidelines for sanitary applications
- Approved for use in federally registered Canadian food establishments
- Extremely low particle emissions (class 100)
- No added formaldehyde
- Vinyl on face and back with sealed edges creating fully encapsulated panel and dramatically reduces particle emission for Clean Room applications
- Third-party verified Environmental Product Declaration (EPD) and Health Product Declaration (HPD) available

Applications:

- Clean Rooms
- Restaurants
- Food Preparation Areas
- Laboratories
- Treatment Rooms

Edge Detail:

- 15/16" trim

9/16" Elite Narrow Stab System

The Elite Narrow Stab System features a slim 9/16" (15 mm) face width to enhance design flexibility and to complement finer, contemporary designs. Cross tees incorporate a staked-on end tab to ensure quick installation with optimal tightness.

Features & Benefits:

- Narrow style 9/16" (15 mm) face complements modern designs
- Double web design for lasting durability and strength
- Stepped-end detail provides a seamless appearance
- Cross tees utilize stab-in design to maximize strength and flexibility
- Intermediate duty load bearing capabilities
- Grid features G30 hot-dipped galvanized steel web construction for corrosion resistance
- Available in standard white and black
- Suitable for seismic applications (Seismic Design Categories A, B, C)

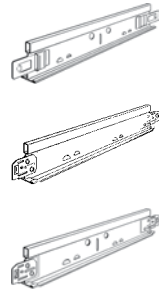

9/16" SmoothLine Bolt Slot System

The SmoothLine Bolt Slot System offers contemporary flair and extended design flexibility. Complementing many of today's modern designs, this system provides a uniform ceiling plane surface when installed with appropriate reveal edge ceiling tile products.

Features & Benefits:

- Narrow 9/16" (15 mm) face features a 1/4" (6 mm) center regress and is compatible with narrow reveal edge panels
- Double web design for lasting durability and strength
- Mitered design on cross tee and main runner intersections produces a clean, continuous slot
- Grid features G30 hot-dipped galvanized steel web construction for corrosion resistance
- Available in standard white only

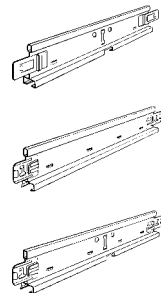

15/16" Classic Hook System

The Classic Hook System features the ever-popular 15/16" (24 mm) face width that is widely used in interior designs today. This system incorporates hook-over cross tee end detail, designed to meet a variety of user needs and preferences.

Features & Benefits:

- Double web design for lasting durability and strength
- Cross tees feature hook-over end tab design for positive locking and easy disassembly
- Intermediate and heavy duty load-bearing capabilities
- Bayonet style couplings featured on main runners for easy installation
- Cross tees feature a butt-cut end design
- Grid features G30 hot-dipped galvanized steel web construction for corrosion resistance
- Available in standard white and black

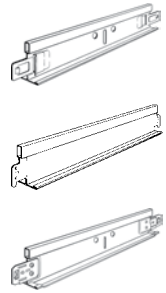

15/16" Classic Stab System

The Classic Stab System features the ever-popular 15/16" (24 mm) face width that is widely used in interior designs today. Strong staked-on end tabs are incorporated into the cross tee design to provide quick and easy installation with optimal tightness among installed components.

Features & Benefits:

- Double web design for durability and strength
- Cross tees feature staked-on end tabs for optimal tightness and ease of installation
- Intermediate and heavy duty load bearing capabilities
- Stepped-end design featured on cross tees
- Grid features G30 hot-dipped galvanized steel web construction for corrosion resistance
- Available in standard white and black
- Suitable for seismic applications (Seismic Design Categories A,B,C,D,E,F)

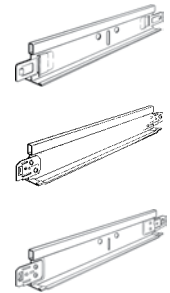

15/16" Classic Aluminum Capped Hook System

The Aluminum Capped Hook System is for areas where moisture is a concern, such as commercial kitchens, laboratories and computer rooms.

Features & Benefits:

- Double web design for lasting durability and strength
- Bayonet style couplings featured on main runners for easy installation
- Cross tees are stepped-end and are offered in 2' and 4' lengths
- Cross tees feature hook-over end tab design for positive locking and easy disassembly
- Cross tees feature a butt-cut end design
- Grid features G30 hot-dipped galvanized steel web construction for corrosion resistance
- Satisfies USDA/FSIS guidelines for sanitary applications
- Available in standard white and black

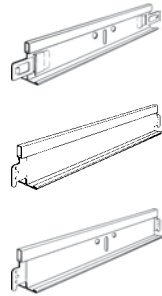

15/16" Classic Aluminum Capped Stab System

The Aluminum Capped Stab System is for areas where moisture is a concern, such as commercial kitchens, laboratories and computer rooms.

Features & Benefits:

- Double web design for lasting durability and strength
- Bayonet style couplings featured on main runners for easy installation
- Cross tees are stepped-end and are offered in 2' and 4' lengths
- Cross tees feature staked-on end tabs for optimal tightness for ease of installation
- Grid features G30 hot-dipped galvanized steel web construction for corrosion resistance
- Satisfies USDA/FSIS guidelines for sanitary applications
- Available in standard white and black
- Suitable for seismic applications (Seismic Design Categories A,B,C)
- Available in standard white and black and 5 additional colors

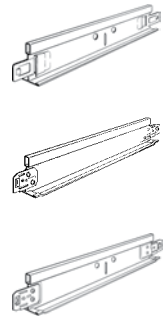

15/16" Classic Environmental Stab System

The Classic Environmental Stab System is ideal for areas where extreme environments exist, such as parking garages and commercial kitchens.

Features & Benefits:

- Double web design for lasting durability and strength
- Bayonet style couplings on main runners for easy installation
- Cross tees are stepped-end and are offered in 2' and 4' lengths
- Cross tees feature staked-on end tabs for optimal tightness and ease of installation
- Grid features G60 hot-dipped galvanized steel web construction with aluminum capping for high-humidity environments
- Satisfies USDA/FSIS guidelines for sanitary applications
- Available in white only
- Suitable for seismic applications (Seismic Design Categories A,B,C)

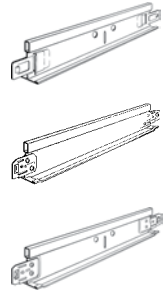

Gyptone® BIG® (GK) Grid System

The Gyptone BIG (GK) Grid System provides smooth ceilings, seamlessly integrating the wall and ceiling.

Features & Benefits:

- Requisite Gyptone screw surface width at ≥ 2 inches
- Quick installation due to modular component design
- Installed components are adjustable for onsite fine tuning
- Flat, rigid system construction facilitates board installation
- Wide screw surface greatly reduces joint cracks on finished boards
- Unique Gyptone® QSTR 25 screw enables attachment between perforations

Cloud Perimeter Trim

The Cloud Perimeter Trim System provides extruded aluminum channel trim for termination of suspended ceiling elements (clouds, peninsulas, transitions to drywall).

Features & Benefits:

- Straight or curved (convex or concave)
- Sturdy extruded aluminum
- Factory mitered corners option
- Integrates with standard ceiling systems
- Engineered to product specifications
- Available in standard white and custom colors

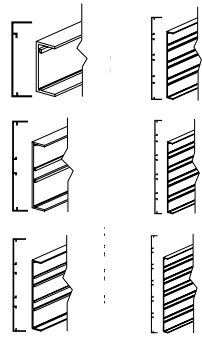

Wall Angle/Grid Accessories

Features & Benefits:

- Variety of wall angle products lends design and installation flexibility
- Standard wall angles to complement popular interior designs
- Shadow moldings produce a reveal-edge look at perimeter installations
- Aluminum wall molding available for high moisture applications
- WA15-15 and WA15-9 available in white, black and color options
- WA15-15SAL available in white only
- SM1020 and SM1000 available in white only

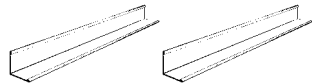
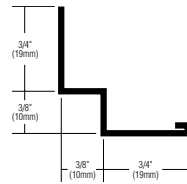

15/16" Fire Secure™ Stab System

The Fire Secure™ Suspension System features a 15/16" (24 mm) face width that is widely used in interior designs today. The strong integral end tabs provide quick and easy installation with optimal tightness among installed components.

Features & Benefits:

- The Fire Secure™ and Protectone® ceiling assembly offers fire-rated solutions for 2 x 2 and 2 x 4 modules
- Suited for both UL and ULC fire-rated designs
- Tested to ASTM E119 for fire rating
- Fire Secure™ and Protectone® suspended ceiling designs have been tested and are listed at UL.com and certainteed.com/ceilings

Seismic Grid Accessories

Features & Benefits:

- Easily integrates with multiple grid profiles
- Two-sided design allows for implementation near any corner
- The CTSTJ clip simplifies installation of single clip in certain seismic applications

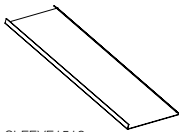

SLEEVE1516

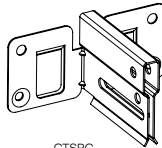

CTSPC

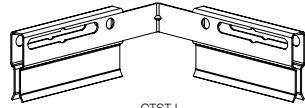

CTSTJ

ONLINE INFORMATION

CertainTeed Corporation's website provides comprehensive, interactive, downloadable product information at www.certainteed.com.

PRODUCT SUPPORT

When you need assistance with product information, literature, or continuing education courses, just dial 1.800.233.8990 to speak with a CertainTeed representative.

SWEETS PRODUCT REFERENCE SECTION

Division	Number	Category	Our Product	Page
06 Wood, Plastics & Composites	06 73 00	Decking	Deck	77
	06 63 00	Railing	Rail	77
	06 16 43	Gypsum Sheathing	GlasRoc	94
	06 22 00	Trim	Restoration Millwork	83
07 Thermal and Moisture Protection	07 21 00	Insulation	Insulation	88
	07 21 29	Insulation	Spray Insulation	88
	07 46 33	Siding	Vinyl Siding	49
	07 50 00	Roofing	Low Slope Roofing	13
	07 31 13	Asphalt Shingles	Steep Slope Roofing	13
09 Finishes	09 20 00	Gypsum	Gypsum	94
	09 51 00	Ceilings	Ceilings	106
13 Sound, Vibration & Seismic Control	13 48 13	Acc. Joint Sealant	Green Glue	94
23 Heating, Ventilating & Air Conditioning	23 07 00	HVAC Insulation	Mechanical Insulation	88
32 Exterior Improvements	32 31 23	Fence	Fence	66

*Based on CSI MasterFormat 2004

El Paso Corporation Office Building

Once considered to be ahead of its time in design, the El Paso Corporation Building, a 48-year-old Houston skyscraper, is once again on the cutting edge following a recent sustainable remodeling. Among the materials used in this project were CertainTeed Ecophon ceiling panels, which feature the highest LEED® recycled content of any ceilings product available in North America.





ASK ABOUT ALL OF OUR OTHER CERTAINTEED® PRODUCTS AND SYSTEMS:

ROOFING • SIDING • TRIM • DECKING • RAILING • FENCE
GYPSUM • CEILINGS • INSULATION

CertainTeed Corporation
P.O. Box 860
Valley Forge, PA 19482

Professional: 800-233-8990
Consumer: 800-782-8777

www.certainteed.com
<http://blog.certainteed.com>

Code No. 80-10-332A, © 03/14 CertainTeed Corporation, Printed in U.S.A.

