

## PIPE ATTACHMENTS

### PLASTIC PIPE RISER CLAMP

#### Figure 126LD

#### Figure 126LD PVC

The Figure 126LD is designed for the support or steadying of vertical PVC pipe risers for DWV applications. It is designed to hold tight to the pipe, transmitting the load to the structure through the ears on each end. When possible the clamp should be placed under a coupling, hub, or lugs welded to the pipe. For heavier loads please see our Figure 126. The Figure 126LD PVC is completely PVC coated.

NOTE: This product is not designed to be supported with rods.

**Materials:** Carbon Steel.

**Finish:** Plain, Painted, Electro-Galvanized, Hot-Dip Galvanized, PVC.

**Compliance:** Federal Specification A-A-1192 Type 8, MSS-SP-69 (Type 8) and BSPSS-BS3974.

**Ordering:** Specify pipe size, figure number, and finish. For Metric applications specify M126LD or M126LD PVC.

FIGURE 126LD – RISER CLAMP  
FIGURE 126LD – PVC RISER CLAMP

PIPE SIZE	MAXIMUM LOAD	A	WEIGHT EACH
1½	225	5¾	0.62
40	1001	146	0.28
2	225	6½	0.67
50	1001	3710	0.30
3	225	7¾	0.88
80	1001	184	0.40
4	225	8½	1.01
100	1001	216	0.46

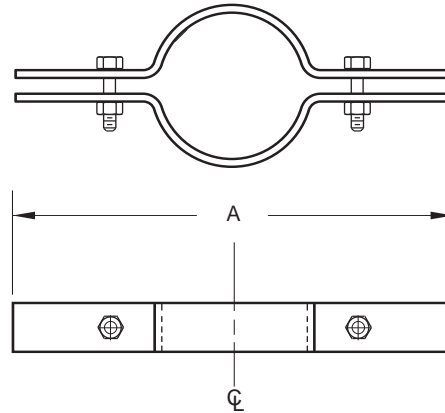

### ANCHOR CHAIR

#### Figure 127

The Figure 127 is composed of two plates, one notched for the correct pipe size and the other has holes punched for a U-bolt. Both pieces are welded together. The U-bolt has sufficient thread to allow for tightening to the pipe.

This anchor is used in conjunction with our Figure 84 and 139 Welded Steel Brackets. A square washer is set under the lips of angle iron sections of the Bracket and nuts tightened on the U-bolt to prevent movement of the anchor.

Made special to customer order.

**Material:** Steel.

**Finish:** Plain, Painted, Electro-Galvanized, Hot-Dip Galvanized.

**Ordering:** Specify pipe size, figure number, and finish. For Metric applications specify Figure M127.

FIG. 127 – ANCHOR CHAIR

PIPE SIZE	A	B	D	H	WEIGHT EACH
4	3	8	4	5	6.28
100	76	203	102	127	2.85
5	3¾	9¾	4	5¾	7.32
125	92	232	102	143	3.32
6	4¼	10¼	5	6½	10.55
150	103	260	127	165	4.79
8	5⅙	12¼	5	7¾	15.25
200	135	311	127	197	6.92
10	6½	14½	5	9¼	21.30
250	165	368	127	235	9.66
12	7¾	16½	5	10¾	25.50
300	194	419	127	264	11.57
14	8½	18	5	11¼	31.50
350	216	457	127	286	14.29
16	9%	20	5	12¾	40.00
400	244	508	127	314	18.14
18	10¾	22	6	13¾	49.50
450	276	559	152	346	22.45
20	12	24½	6	15	65.90
500	305	622	152	381	29.89
24	14	28½	6	17	81.00
600	356	724	152	432	36.74

