

## Control Connector Inserts

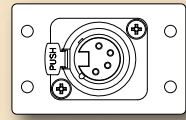

**IPS-C610D**  
2 x 4 Pin Female  
XLR to Solder



**IPS-C611S**  
4 Pin Mini XLR  
to Captive  
Screw Terminal



**IPS-C612S**  
TPS Block 10  
Connector

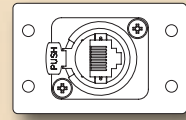

**IPS-C710D**  
Neutrik EtherCon  
RJ-45



**IPS-C410S**  
9 Pin DSub Male  
to Female  
Bulkhead



**IPS-C411S**  
9 Pin DSub Male  
to Solder



**IPS-C910S**  
Momentary  
Switch



**IPS-C920S**  
2 x Momentary  
Switch

## Under Table Enclosures



**IPS-UT11**  
1 W x 1 H Under Table IPS Enclosure



**IPT-UT21**  
2 W x 1 H Under Table IPS Enclosure

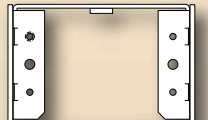

**IPS-UT12**  
1 W x 2 H Under Table IPS Enclosure

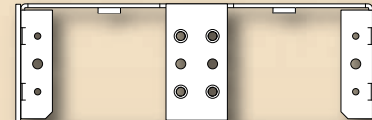

**IPS-UT22**  
2 W x 2 H Under Table IPS Enclosure



**IPS-UT31**  
3 W x 1 H Under  
Table IPS Enclosure

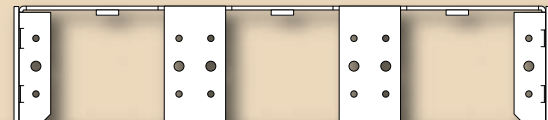

**IPS-UT32**  
3 W x 2 H Under  
Table IPS Enclosure



**IPS-RK12**  
Bracket with 6  
2 Slot IPS Openings

## Simple Solutions for Decora Wallplates

### Keystone Inserts



**SS-RJ45**  
CAT 5 to Punch  
Down



**SS-RJCAT6**  
CAT 6 to  
Punch Down  
(Black Only)



**SS-RJ11**  
RJ11 to Punch  
Down



**SS-LC**  
Fiber LC  
Bulkhead (Black  
Only)



**SS-HDMI**  
HDMI Bulkhead  
(White and Black  
Only)



**SS-BNC**  
BNC Bulkhead



**SS-SCON**  
S-Video  
Connector  
Bulkhead



**SS-FCON**  
F Connector  
Bulkhead



**SS-RCA-R**  
Red RCA  
Bulkhead



**SS-RCA-B**  
Black RCA  
Bulkhead



**SS-RCA-Y**  
Yellow RCA  
Bulkhead



**SS-MINI**  
3.5mm Stereo  
to Solder



**SS-SWMOM**  
Momentary  
Switch



**SS-SWMAIN**  
Maintained  
Switch



**SS-CBLNK**  
Blank Insert



**SS-USBA**  
USB A Bulkhead  
(Black Only)



**SS-USBAHW**  
USB A to  
Punch Down  
(Black Only)



**SS-USBB**  
USB B Bulkhead  
(Black Only)



**SS-USBBHW**  
USB B to  
Punch Down  
(Black Only)



**SS-USB-CHRG**  
USB Universal 10W  
Charging Port  
(black only) with  
Power Supply

### Decora Trim Rings

SS-DPLT1 - 1 Gang Wall Plate  
SS-DPLT2 - 2 Gang Wall Plate  
SS-DPLT3 - 3 Gang Wall Plate  
SS-DPLT4 - 4 Gang Wall Plate

\* When using the Decora inserts  
below, these models only fit the  
SS-PORT3.

### Decora Inserts



**SS-PBLNK**  
Blank Insert



**SS-PORT3**  
3 Keystone  
Insert



**SS-PORT4**  
4 Keystone  
Insert (White  
and Ivory Only)



**SS-PORT6**  
6 Keystone  
Insert (White  
and Ivory Only)



**SS-P1DB**  
Insert with  
DSub Opening



**SS-P2DB**  
Insert with 2x  
DSub Openings



**SS-P1XLR**  
Decora 1 XLR  
hole for Neutrik  
D series (White,  
Black, Ivory)

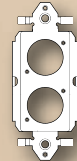

**SS-P2XLR**  
Decora 2 XLR  
hole for Neutrik  
D series (White,  
Black, Ivory)



**SS-PDSXL**  
Decora 1D-SUB,  
1 D series XLR  
(White, Black,  
Ivory)

## Machined 1/4" Aluminum Wall Plates

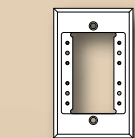

**IPS-WP1S**  
1 Gang Plate  
w/ 1 IPS

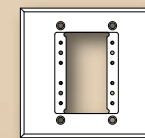

**IPS-WP1D**  
2 Gang Plate  
w/ 1 IPS

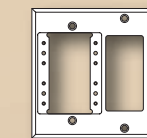

**IPS-WP2D**  
2 Gang Plate  
w/1 IPS and  
1 Decora

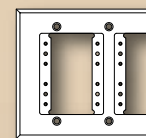

**IPS-WP1T**  
3 Gang Plate  
w/ 2 IPS

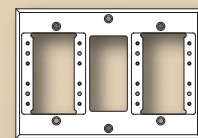

**IPS-WP2T**  
3 Gang Plate  
w/ 2 IPS and  
1 Decora

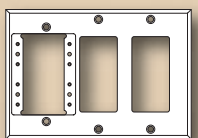

**IPS-WP3T**  
3 Gang Plate  
w/ 1 IPS and  
2 Decora

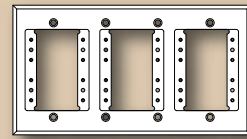

**IPS-WP1Q**  
4 Gang Plate w/ 3 IPS

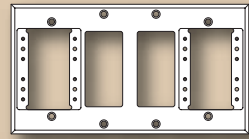

**IPS-WP2Q**  
4 Gang Plate w/ 2 IPS  
and 2 Decora

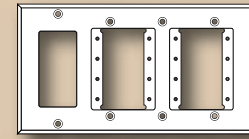

**IPS-WP3Q**  
4 Gang Plate w/ 2 IPS  
and 1 Decora

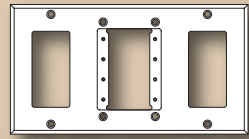

**IPS-WP4Q**  
4 Gang Plate w/ 1 IPS  
and 2 Decora

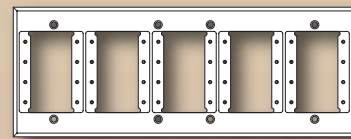

**IPS-WP1H**  
(Black Only)  
6 Gang Plate w/ 5 IPS Openings

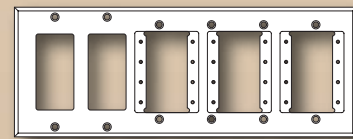

**IPS-WP2H**  
(Black Only)  
6 Gang Plate w/ 3 IPS  
and 2 Decora

Also available in  
High Strength Plastic

WP = Aluminum  
PWP = Plastic



P: 800.332.FSR1 • W: fsrinc.com • E: sales@fsrinc.com



244 Bergen Boulevard · Woodland Park, NJ 07424  
800.332.FSR1 · 973.785.4347 · F: 973.785.3318  
W: fsrinc.com · E: sales@fsrinc.com LIT1443

© 2013 FSR, Inc. All Rights Reserved



FSR has the solution for custom AV and Data Plates. The IPS connectivity family is in stock, priced competitively and works well in walls, under table and floor box applications.

The Wall plates are machined from 1/4" aircraft grade aluminum for a lifetime of service. Our plates are available from single gang up to 6 gangs and mix standard decora openings with IPS openings, an FSR exclusive.

The insert connectors are mounted to steel plates again insuring a lifetime of service. The inserts are available with no labeling, standard labeling or we will custom label them for you.

To make design work easier, visit our web site and try out the IPS Planner. It's a simple drag and drop tool for building wall plates and provides finished drawings as well as a bill of materials.

Additionally, our IPS inserts can be changed at any time for easy upgrade-ability.

All IPS wall plates and inserts carry a limited lifetime warranty.

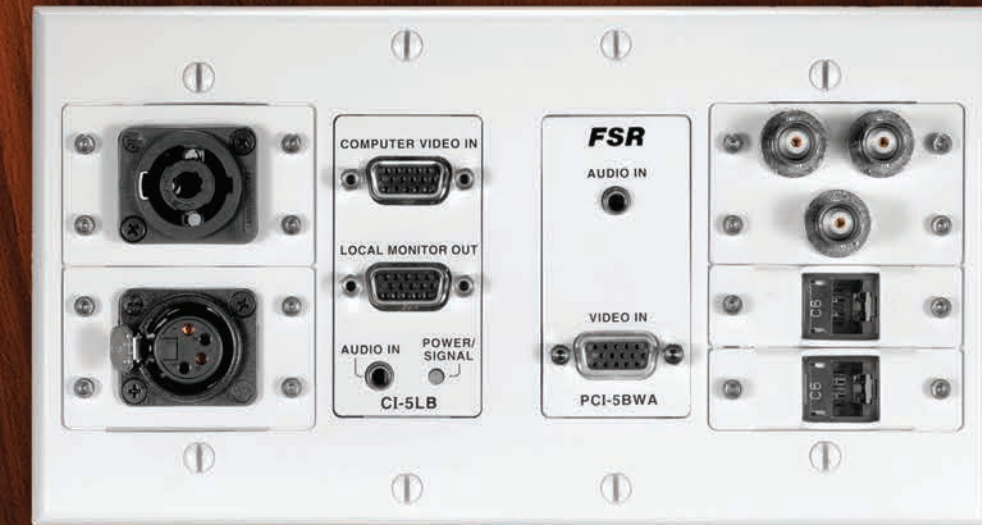

## Intelligent Plate Solutions

I/O Plates for Walls,  
Under Tables and  
Wall Boxes

## Video Connector Inserts

|   |   |  |   |  |   |   |
|---|---|--|---|--|---|---|
| <b>IPS-V210S</b><br>Yellow RCA to Solder            | <b>IPS-V210S-LB</b><br>Yellow RCA to Solder (Labeled)         | <b>IPS-V211S</b><br>Yellow RCA to RCA                      | <b>IPS-V211S-LB</b><br>Yellow RCA to RCA (Labeled)      | <b>IPS-V213S</b><br>Yellow RCA to BNC                                | <b>IPS-V213S-LB</b><br>Yellow RCA to BNC (Labeled)                      | <b>IPS-V110S</b><br>BNC to BNC                                    |
| <b>IPS-V120S</b><br>1 White & 1 Yellow BNC to BNC's | <b>IPS-V310S</b><br>S-Video to 2 BNC Breakout                 | <b>IPS-V310S-LB</b><br>S-Video to 2 BNC Breakout (Labeled) | <b>IPS-V311S</b><br>S-Video to S-Video Bulkhead         | <b>IPS-V311S-LB</b><br>S-Video to S-Video (Labeled)                  | <b>IPS-V230S</b><br>Red, Green & Blue RCA's to RCA's                    | <b>IPS-V230S-LB</b><br>Red, Green & Blue RCA's to RCA's (Labeled) |
| <b>IPS-V231D</b><br>Red, Green & Blue RCA to BNC    | <b>IPS-V231D-LB</b><br>Red, Green & Blue RCA to BNC (Labeled) | <b>IPS-V130D</b><br>Red, Green & Blue BNC's to BNC's       | <b>IPS-V911S</b><br>F Connector to F Connector Bulkhead | <b>IPS-V921S</b><br>S-Video to S-Video & Yellow RCA to BNC (Labeled) | <b>IPS-V921S-LB</b><br>S-Video to S-Video & Yellow RCA to BNC (Labeled) | <b>IPS-V922S</b><br>S-Video to S-Video & BNC to BNC               |

## Audio Connector Inserts

|   |   |   |  |   |  |  |
|---|---|---|--|---|--|--|
| <b>IPS-A220S</b><br>Red and White RCA's to RCA's                                      | <b>IPS-A220S-LB</b><br>Red and White RCA's to RCA's (Labeled) | <b>IPS-A221S</b><br>Red and White RCA's to Solder       | <b>IPS-A221S-LB</b><br>Red and White RCA's to Solder (Labeled)       | <b>IPS-A222S</b><br>Red and White RCA's to Cap. Screw Terminals                   | <b>IPS-A222S-LB</b><br>Red and White RCA's to Cap. Screw Terminals (Labeled) | <b>IPS-A223S</b><br>Red and White RCA's to Cap. Screw Terminals Balanced |
| <b>IPS-A223S-LB</b><br>Red and White RCA's to Cap. Screw Terminals Balanced (Labeled) | <b>IPS-A510S</b><br>3.5mm Stereo to Solder                    | <b>IPS-A510S-LB</b><br>3.5mm Stereo to Solder (Labeled) | <b>IPS-A511S</b><br>3.5mm Stereo to Captive Screw Terminals Balanced | <b>IPS-A511S-LB</b><br>3.5mm Stereo to Captive Screw Terminals Balanced (Labeled) | <b>IPS-A512S</b><br>1/4" Stereo Jack to Solder                               | <b>IPS-A522S</b><br>2 x 1/4" Stereo Jack to Solder                       |
| <b>IPS-A610S</b><br>Mini 3 Pin Male XLR to Solder                                     | <b>IPS-A620S</b><br>2 x Mini 3 Pin XLR to Solder              | <b>IPS-A611D</b><br>3 Pin Female XLR to Solder          | <b>IPS-A612S</b><br>3 Pin Male XLR to Solder                         | <b>IPS-A613D</b><br>Speakon to Solder   |  |  |

## Voice and Data Connector Inserts

|  |  |  |   |  |  |   |
|--|--|--|---|--|--|---|
| <b>IPS-D710S</b><br>RJ-45 Punch-Down                                 | <b>IPS-D710S-LB</b><br>RJ-45 Punch-Down (Labeled)    | <b>IPS-D711S</b><br>RJ-45 CAT 6 Punch-Down | <b>IPS-D711S-LB</b><br>RJ-45 CAT 6 Punch-Down (Labeled) | <b>IPS-D712S</b><br>RJ-45 to RJ-45 Bulkhead          | <b>IPS-D712S-LB</b><br>RJ-45 to RJ-45 Bulkhead (Labeled) | <b>IPS-D713S</b><br>RJ-45 CAT 6 to RJ-45 CAT 6 Bulkhead |
| <b>IPS-D713S-LB</b><br>RJ-45 CAT 6 to RJ-45 CAT 6 Bulkhead (Labeled) | <b>IPS-D714S</b><br>RJ-11 Punch-Down                 | <b>IPS-D720D</b><br>2 x RJ-45 Punch-Down   | <b>IPS-D720D-LB</b><br>2 x RJ-45 Punch-Down (Labeled)   | <b>IPS-D721D</b><br>2 x RJ-45 Bulkhead               | <b>IPS-D721D-LB</b><br>2 x RJ-45 Bulkhead (Labeled)      | <b>IPS-D715S</b><br>USB A to USB A Bulkhead             |
| <b>IPS-D715S-LB</b><br>USB A to USB A Bulkhead (Labeled)             | <b>IPS-D716S</b><br>USB A to Captive Screw Terminal* | <b>IPS-D717S</b><br>USB A Charging Port*   | <b>IPS-D718S</b><br>USB B to USB B Bulkhead*            | <b>IPS-D719S</b><br>USB B to Captive Screw Terminal* | <b>IPS-D801S</b><br>Fiber ST Bulkhead                    | <b>IPS-D802S</b><br>Dual Fiber LC Bulkhead*             |

\*Rear of connector is slightly larger than the mounting plate on these models. Allow extra room while stacking.

## Digital Video Connector Inserts

|                                       |   |
|---------------------------------------|---|
| <b>IPS-V611T</b><br>DVI-I FF Bulkhead | <b>IPS-V610S</b><br>HDMI to HDMI Bulkhead |
|---------------------------------------|---|

## Computer Video Connector Inserts

|   |  |  |   |
|---|--|--|---|
| <b>IPS-V410S</b><br>HD-15 FF Bulkhead                           | <b>IPS-V410S-LB</b><br>HD-15 FF Bulkhead (Labeled)                           | <b>IPS-AV920D</b><br>HD-15 FF Bulkhead and 3.5mm Stereo Solder | <b>IPS-AV920D-LB</b><br>HD-15 FF Bulkhead and 3.5mm Stereo Solder (Labeled) |
| <b>IPS-AV921D</b><br>HD-15 F to 5 BNC's and 3.5mm Stereo Solder | <b>IPS-AV921D-LB</b><br>HD-15 F to 5 BNC's and 3.5mm Stereo Solder (Labeled) | <b>IPS-V150T</b><br>Red, Green, Blue, H and V BNC's to BNC's   | <b>IPS-V150T-LB</b><br>Red, Green, Blue, H and V BNC's to BNC's (Labeled)   |

## Ordering Notes

All inserts are available in White, Ivory or Black unless otherwise noted. Specify color by adding the color suffix to the part numbers above.

White=WHT  
Black=BLK  
Ivory=IVO  
Example; IPS-A510S-LB-WHT

Custom Labeling Available on All Inserts and Plates

All IPS Inserts and Plates have a Limited Lifetime Warranty.

Use \$2000 of our IPS Solutions and receive free custom printing!

## Audio and Video Connector Inserts

|  |   |  |   |   |  |
|--|---|--|---|---|--|
| <b>IPS-AV230S</b><br>Red, White and Yellow RCA's to Solder | <b>IPS-AV230S-LB</b><br>Red, White and Yellow RCA's to Solder (Labeled) | <b>IPS-AV922S</b><br>Yellow RCA and 3.5mm Stereo to Solder | <b>IPS-AV922S-LB</b><br>Yellow RCA and 3.5mm Stereo to Solder (Labeled) | <b>IPS-AV231S</b><br>Red, White and Yellow RCA's to RCA's | <b>IPS-AV231S-LB</b><br>Red, White and Yellow RCA's to RCA's (Labeled) |
|--|---|--|---|---|--|

## Specialty Inserts

|  |   |
|--|---|
| <b>IPS-AV923D</b><br>9 Pin DSub Bulkhead and 3.5mm Stereo Solder                 | <b>IPS-AVC940T</b><br>HD15 to 5 BNC, 3.5mm Stereo to Solder, 2 x RJ-45        |
| <b>IPS-AVC941T</b><br>HD15 to 5 BNC's, 3.5mm Stereo to Solder, RJ-45, Yellow RCA | <b>IPS-AVC942T</b><br>HD15 to 5 BNC's, 3.5mm Stereo to Solder, RJ-45, S-Video |

## Cable Pass-Through Inserts

|  |   |
|--|---|
| <b>IPS-B010D</b><br>1 x .812" ID Split Bushing   | <b>IPS-B020D</b><br>2 x .312" ID Split Bushing            |
| <b>IPS-B011Q</b><br>1" x 2" Opening with Grommet | <b>IPS-B030T</b><br>2 x .312" and 1 x .812" Split Bushing |

## Keystone Inserts

|  |  |
|--|--|
| <b>IPS-B040S</b><br>1 Keystone Opening | <b>IPS-B041D</b><br>2 Keystone Opening |
|--|--|

## Blank Inserts

|   |   |
|---|---|
| <b>IPS-B000S</b><br>Single Height Blank | <b>IPS-B000D</b><br>Double Height Blank |
| <b>IPS-B000Q</b><br>Quad Height Blank   |   |

## AC Outlet

|   |
|---|
| <b>IPS-AC110D</b><br>AC Outlet to Edison Plug (Under Table Use Only) Black Only |
|---|

