



ECODRY 30-75 LB. DRYERS

ENERGY EFFICIENT • HIGH PERFORMANCE • VERSATILE



M76ED

THE MOST ENERGY EFFICIENT DRYER

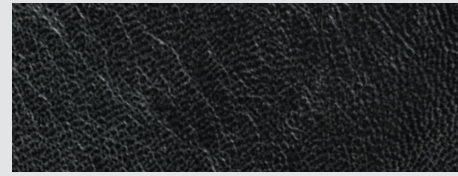

M3535ED



M50ED



Productivity.

Milnor's EcoDry dryer line offers a unique axial airflow. Heat flows in from the rear and is captured in the solid (not perforated) galvanized steel drum where multiple heat sensors keep temperatures even. This design yields exceptional drying results while delivering energy savings up to 25% more efficient than any other dryer.

When compared to similar dryers, the footprint of the Milnor EcoDry dryer translates into more productive value for each square foot of the laundry floor.

Efficiency.

The dryer's unique sensing system measures the presence of moisture in the load. The microprocessor stops the dryer exactly when the load is dry, saving time and energy.

Dual paned glass door seals heat inside the dryer—keeping the heat focused on laundry. Milnor's ED drying tumblers are completely sealed and keep laundry rooms cooler which can help cut air-conditioning costs.

Dual burner design allows dryers to maintain a tighter range of the set temperature, enabling a dramatic reduction in energy usage without sacrificing performance. Delicate cycles can be programmed to use heat from only one burner for more exact temperatures and energy savings.

Easy to use.

Dryers that are easy to use stay in operation longer. Milnor ED dryers feature simple, push-button controls to streamline turnaround times. The Phase 8 control is also advanced, featuring self-diagnostics capable of reporting dryer service needs. The scrolling display can also output messages in two languages – a necessity for many washrooms.

Rugged construction.

A four-point roller support system is stable and durable. It can eliminate costly service associated with other dryers. Hidden magnetic door switches are designed to last the life of the machine. Epoxy-based powder coated steel is durable. Optional stainless steel doors and front panels are practical and attractive.

Added Features

Easy access – The 30-35 lb. capacity models and stock dryers fit through a standard 3'-0" doorway while the 50 and 75 lb. capacity models can enter a 42" door.

90% Front Serviceability – This feature shortens service visits and can help keep dryers in operation longer when compared to rear-access dryers.

Single-phase reverse tumbling feature – This function can prevent roping and balling. Now, even single-phase machines can deliver a quicker, more even drying process with reverse tumbling.

Standard on M50ED and M76ED (optional on M3030ED, M35ED, M3535ED, and M5050ED).

Hot surface ignition – The Milnor dryers will always start up with reliable hot surface ignition.

Phase 8 technology provides an optional Fire Suppression System (cold weather FSS also optional) to protect against fire damage caused by spontaneous combustion. The system senses an abnormal rise in temperature and quickly activates a water jet system and turns the basket to extinguish the fire. If for some reason the fire re-ignites, FSS will reactivate to ensure the fire is completely out.

Additional safeties include multi-point high temperature monitoring that will shut the burner off if the temperature exceeds the set point parameters.

A unique drying tumbler that maximizes the balance of heat & airflow.



M3030ED-M76ED

Energy Efficient Dryers with the performance you need.



SMART DESIGN



Better cylinder support contributes to long life.

Roller support for reliability.

The basket is driven via a single belt around it and is supported by 4 rollers. This single belt eliminates maintenance-prone gear boxes and idler shafts.

ENERGY EFFICIENT

Speed boosts productivity.

The complete line of EcoDry dryers focuses on maximizing energy efficiency while at the same time ensuring optimum dry times and thru-put. So you don't have to sacrifice number of turns or throughput for the sake of going green.

EcoDry dryers increase your profitability two-fold—allowing for the industry standard of speed while saving around 25% on energy consumption and costs.

Fits through 3'-0" door.

The M3030ED, M35ED, M3535ED and M5050ED can move through a 3'-0" steel door frame.

It's front-serviceable!

The entire front panel can be removed from some machines so most maintenance can be performed from the front. It's a time-saving convenience for service—and a safety benefit. Lint is removed from the front through a large capacity lint drawer.

COMPACT FOOTPRINT

Saves space.

Surprisingly, these dryers are more compact than other dryers. They install close to the wall because there's little to service from the rear of the machine.

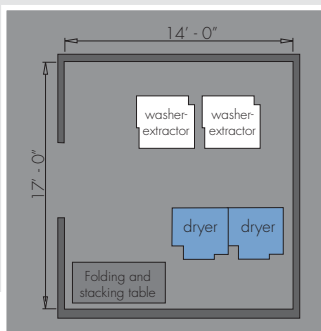

PLUS...

Get these benefits, also.

Phase 8 microprocessor: This innovative control has many user-friendly and safety-oriented features.

Reversing basket: To help prevent tangling, the basket reverses rotation on most models.

Built tough: The cabinet is electrostatically painted inside and out, and all components are painted before assembly for thorough protection.

Fully enclosed cabinet: This design, combined with insulation, improves efficiency by capturing radiant heat and using it to dry. Also improves working conditions.

Other standard feature: Hot surface ignition (fast and reliable).

ECODRY CONDENSED SPECIFICATIONS

| SPECIFICATIONS | UNITS | M3030ED <i>(per pocket)</i> | M35ED | M3535ED <i>(per pocket)</i> | M50ED | M5050ED <i>(per pocket)</i> | M76ED |
|----------------------|-------------|--------------------------------|--------------|--------------------------------|--------------|--------------------------------|--------------|
| Max capacity | lb. (kg) | 30 (13) | 35 (15) | 35 (15) | 50 (22) | 50 (22) | 75 (34) |
| Basket diameter | in. (mm) | 25.75 (654) | 30 (762) | 30 (762) | 37 (939) | 32.75 (831) | 37 (939) |
| Basket depth | in. (mm) | 34 (863) | 30 (762) | 30 (762) | 25.75 (654) | 32.75 (831) | 35.5 (901) |
| Basket volume | cu. ft. (L) | 10.25 (290) | 12.27 (347) | 12.27 (347) | 16.02 (453) | 16 (453) | 22.09 (625) |
| Door opening | in. (mm) | 19.37 (492) | 19.37 (492) | 19.37 (492) | 27.37 (695) | 23.75 (603) | 27.37 (695) |
| Basket motor | HP (kW) | 0.25 (0.19) | 0.25 (0.19) | 0.25 (0.19) | 0.75 (0.56) | 0.33 (0.25) | 0.75 (0.56) |
| Blower motor | HP (kW) | 0.5 (0.37) | 0.5 (0.37) | 0.5 (0.37) | 0.5 (0.37) | 0.5 (0.37) | 0.5 (0.37) |
| Overall width | in. (mm) | 27 (685) | 31.12 (790) | 31.12 (790) | 38.25 (971) | 34.25 (870) | 38.25 (971) |
| Overall depth | in. (mm) | 40.59 (1031) | 40.42 (1026) | 39.62 (1006) | 40.12 (1019) | 56.53 (1436) | 49.81 (1265) |
| Overall height | in. (mm) | 72.87 (1851) | 67 (1701) | 80.37 (2041) | 70.50 (1790) | 81.75 (2076) | 70.5 (1790) |
| Approx net weight | lb. (kg) | 535 (242) | 462 (209) | 600 (272) | 610 (276) | 900 (408) | 745 (337) |
| FSS water connection | in. (GHT) | 0.75 | 0.75 | 0.75 | 0.75 | 0.75 | 0.75 |

GAS MODELS

| | | | | | | | |
|------------------|------------------|-----------------|-----------------|-----------------|------------------|------------------------|------------------|
| Airflow | cfm (cmm) | 310 (8.78) | 319 (9.03) | 380 (10.76) | 600 (17) | 540 (15.29) | 600 (17) |
| Heat input | btu/hr (kcal/hr) | 52,500 (13,230) | 64,000 (16,128) | 64,000 (16,128) | 110,000 (27,720) | 110,000 (27,720) | 130,000 (32,760) |
| Gas inlet | M.N.P.T. | 0.37 | 0.5 | 0.5 | 0.5 | 0.5 | 0.5 |
| Exhaust diameter | in. (mm) | 6 (152) | 6 (152) | 6 (152) | 8 (203) | 8 (203) or 10 (254) | 8 (203) |

STEAM MODELS

| | | | | | | | |
|--------|-----|-----|------|-----|---|-----|---|
| Boiler | Bhp | N/A | 1.75 | N/A | 3 | N/A | 3 |
|--------|-----|-----|------|-----|---|-----|---|

ELECTRIC MODELS

| | | | | | | | |
|------|----|-----|--|--|---------------------------------|-----|------------------------|
| Oven | kW | N/A | 7.9, 8.3, 9.0, 11.3, 12.4, 12.5, 13.5 | 7.9, 8.3, 9.0, 11.3, 12.4, 12.5, 13.5 | 13.4, 14.7, 14.8, 16.0, 22.0 | N/A | 18.0, 18.5, 20.3, 22.0 |
|------|----|-----|--|--|---------------------------------|-----|------------------------|

All specifications are for gas dryers at 60 Hz unless otherwise noted. Consult factory for steam and electric dryer specifications.

For detailed specifications, dimensional drawings, compressed air requirements (if applicable), etc., please contact us.

All specifications subject to change without notice.



Printed in U.S.A.
© Pellerin Milnor Corporation
B22SL11001/14444

P.O. Box 400, Kenner, LA 70063-0400 USA
504/712-7656 • 800/469-8780
Fax: 504/468-3094
E-mail: milnorinfo@milnor.com
www.milnor.com