

2/2-way Compact Diaphragm Valve, cast valve body, threaded port connection

- Hermetical separation of fluids from the actuator by diaphragm
- For contaminated, viscous or dirty fluids
- Optical position indicator is standard

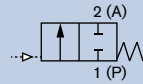

The externally piloted diaphragm valve consists of a pneumatically operated piston actuator, a diaphragm and a 2-way valve housing made of investment cast stainless steel.

The standard material of the actuator is PA polyamide. With its favourable flow characteristics, the valve enables high flow capacities and a variety of applications for contaminated, viscous or dirty fluids to be realised.

Technical Data

Port connection	Threaded ports ISO 228
Orifice	DN15-20
Body material	Cast stainless steel 316L/1.4435
Actuator material	PA polyamide
Pilot air ports	Stainless steel 1.4305
Seal materials	EPDM, FKM, EPDM lined with PTFE
Medium	Neutral gases and liquids, sterile, aggressive or abrasive fluids
Viscosity	Up to viscous
Medium temperature	
EPDM	-5 to +130°C
FKM, EPDM lined with PTFE	Briefly up to +150°C for steam sterilisation -5 to +130°C
Ambient temperature	-5 to +60°C
Control medium	Neutral gases; air
Installation	As required, preferably with actuator in upright position

Options

- Control function B (open by spring force) and I (double-acting actuator)
- Feedback
- Stroke limitation

Dimensions [mm] (see datasheet for further Details)

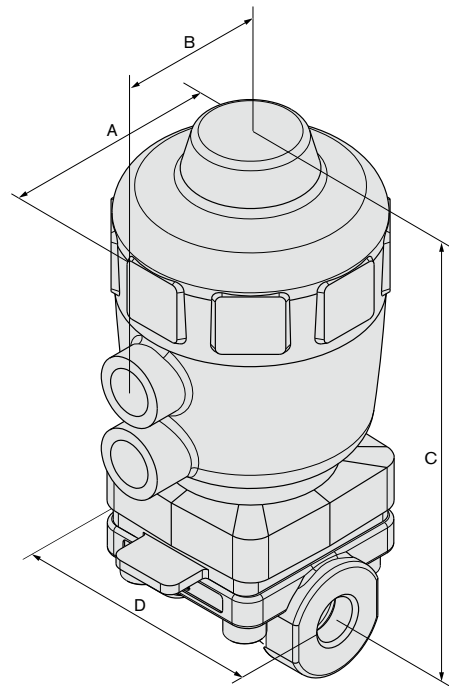

DN	A	B	C	D
15	63	39	122	56
20	80	52	148	80

Ordering Chart

Control function	Orifice [mm]	Port connection [inch]	Kv value water [m³/h]	Actuator size Ø [mm]	Pilot pressure [bar]		Max. operating pressure [bar]	Item no.
					min.	max.		
A 2/2-way normally closed, NC	EPDM seal							
	15	G 1/4	4	50	5	10	8.5	445 417
	15	G 3/8	4	50	5	10	8.5	445 418
	15	G 1/2	4	50	5	10	8.5	445 419
	20	G 3/4	7	63	5.5	10	10	558 712
	FKM seal							
	15	G 1/4	4	50	5	10	8.5	445 420
	15	G 3/8	4	50	5	10	8.5	445 421
	15	G 1/2	4	50	5	10	8.5	445 422
	20	G 3/4	7	63	5.5	10	10	558 714
	EPDM coated with PTFE seal							
	15	G 1/4	4	50	7	10	8.5	-
	15	G 3/8	4	50	7	10	8.5	444 148
	15	G 1/2	4	50	7	10	8.5	-
	20	G 3/4	7	63	8.5	10	10	558 713

2031 Compact

Envelope Dimensions [mm]

