

## Electrical position feedback

- High electrical and mechanical lifetime
- More for less – optimal configuration costs
- Easy maintenance and commissioning
- Increase system and operational safety



Figure shows Type 1060 mounted on actuator cover

The electrical position feedback is screwed in, instead of the visual position indicator. While the valve is opening, the piston of the actuator lifts a palm-button. This button actuates a micro switch with change-over contact, which gives the electrical feedback of the valve position. The palm-button also acts as an optical position indicator.

### Technical data

<b>Micro switch</b>	1 switch over contact
<b>Contact rating</b>	till 250V AC – maximum 5 A ohmic or inductive contact load – filament load 0.5 A till 250V DC – maximum 0.25 A ohmic contact load – maximum 0.02 A inductive load – maximum 0.02 A filament load
<b>Protection class</b>	IP65 acc. to DIN 40050
<b>Connection</b>	solder terminals
<b>Cable outlet</b>	can be rotated through 4 x 90°
<b>Cable diameter</b>	5 to 9 mm
<b>Continuous temperature</b>	+125 °C
<b>Material</b>	housing and micro switch made of plastic

### Envelope Dimensions [mm]

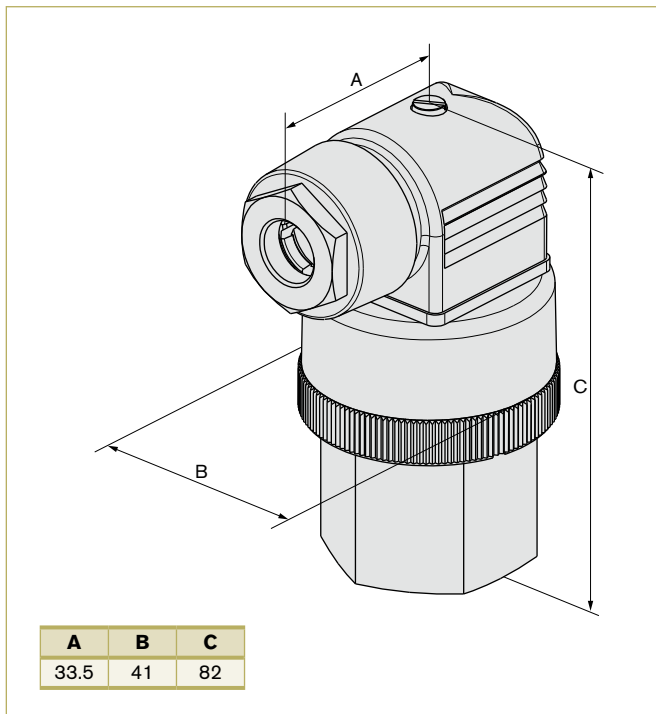

## Ordering Chart

For Actuator size $\varnothing$ [mm]	Item no.
40 (Seat valve)	158 244
40 (Diaphragm valve)	158 220
50 - 80	701 515
100, 125	701 516
175, 225	655 696

1060

## Envelope Dimensions [mm]

