

SAFETY & RELIEF VALVES

OEM Style Bronze Safety Valves for Steam, Air and Non-Hazardous Gas

29 SERIES



Conbraco 29 Series is ideally suited for OEM applications where compact size, dependable performance and maximum economy are required. These rugged safety valves feature a top guided design and patented Teflon® "soft-seat" for dramatically reduced seat leakage. Flow ratings are National Board certified.

ASME Sections I and VIII

Sizes 3/8" - 1-1/4" NPT

Factory set pressures 30 to 200 psig

Maximum temperature 406°F

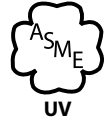

Section I
Power Boilers

Section VIII
Pressure Vessels

APPLICATIONS:

Small to medium sized steam power boilers, sterilizers and distillers, air compressors and receivers, pressure vessels and pressure piping systems.

FEATURES:

- Stainless steel springs are standard
- PFA Teflon® seat resists corrosive boiler chemicals
- Rust-proofed steel stem and spring washers
- Lower control ring ensures short, consistent blowdown
- Tapped body drain allows piping of condensate away from equipment
- Reduced repair costs; soft seat easily replaced
- Registered in all Canadian Provinces under CSA B51 CRN OG8547.5C

OPTIONS:

- 316 Stainless steel wetted trim (29-202 & 29-303 sizes only)
- Oxygen cleaning
- European pressure equipment directive compliant option (CE/PED)

MATERIALS

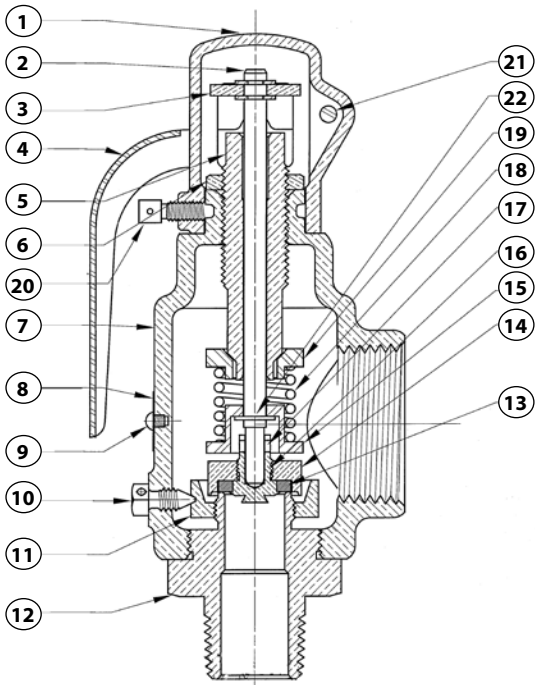

| Item | Component | Material |
|------|-----------------|-----------------|
| 1 | Cap | Bronze or Brass |
| 2 | Stem | Steel - Plated |
| 3 | Lift Washer | Steel - Plated |
| 4 | Lift Lever | Steel - Plated |
| 5 | Adjusting Screw | Brass |
| 6 | Lock Nut | Brass |
| 7 | Body | Bronze |
| 8 | Nameplate | Stainless Steel |
| 9 | Drive Screws | Stainless Steel |
| 10 | Set Screw | Brass |
| 11 | Blowdown Ring | Brass |
| 12 | Nozzle* | Brass/Stainless |
| 13 | Seat Insert | Teflon® PFA |
| 14 | Disc Holder | Brass |
| 15 | Lower Washer | Steel - Plated |
| 16 | Seat Retainer* | Brass/Stainless |
| 17 | Stem Pin | Stainless Steel |
| 18 | Spring | Stainless Steel |
| 19 | Upper Washer | Steel - Plated |
| 20 | Lock Screw | Steel - Plated |
| 21 | Lever Pin | Steel - Plated |
| 22 | Retaining Ring | Stainless Steel |
| - | Seal & Wire | Lead/Steel |

*Teflon is a registered trademark of DuPont.

* Optional stainless steel wetted trim for models 29-202XXL and 29-302XXL. Items 12 & 16 are type 316 stainless steel.