

BUTTERFLY VALVES – Resilient Seated

General Purpose Butterfly Valves – 141 Series & 145 Series

Item	Description	Material
1	Body	Ductile Iron ASTM A536 (65-45-12)
2	Seat	EPDM* — or — Buna-N (Nitrile)* — or — Viton®B*
3	Shaft	416 Stainless Steel ASTM A564
4	Disc	Nickel Plated Ductile Iron ASTM A536 (65-45-12) — or — Aluminum-Bronze ASTM B148, C95400 — or — 316 Stainless Steel A STM A351, Type CF8M
5	Bushing	Glass Reinforced Epoxy
6	Weather Seal	Buna-N
7a	Retainer	Steel with Protective Finish
7b	Retainer	Steel with Protective Finish
8	Washer	Brass
9	Set Screws (Flat Point)	Steel with Protective Finish
10	Set Screws (Cone Point)	Steel with Protective Finish
11	Nameplate	

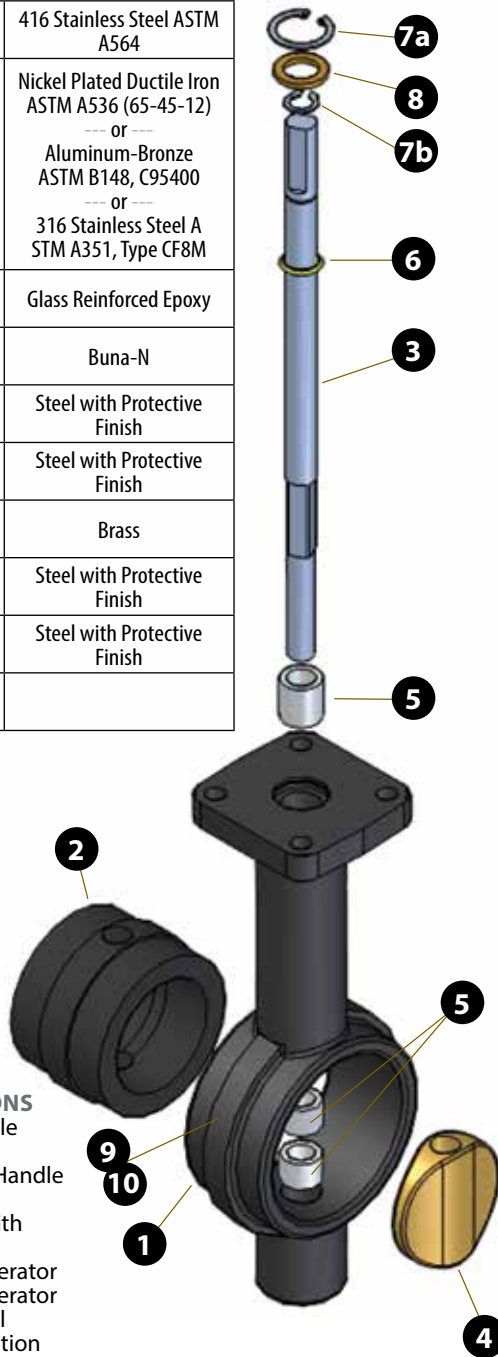

Exploded View
WD141 – Wafer Design Shown

AVAILABLE OPTIONS

- 10 Position Handle
- Gear Operator
- Infinite Position Handle
- Locking Handle
- Gear Operator with Chain Wheel
- Locking Gear Operator
- Locking Gear Operator with Chain Wheel
- Pneumatic Actuation
- Electric Actuation
- Silicon Free Assembly Option (145 Series)

Pressure Rating

- 2" to 12": 200 psi
- 14" to 24": 150 psi

Apollo International™

- **WD141:** One-piece wafer-style, sizes 2" to 12"
- **LD141:** Lug valves, sizes 2" to 24"
(contact the factory for LD141 sizes greater than 24")

Apollo Assembled & Tested in USA

- **WD145:** One-piece wafer-style, sizes 2" to 12"
- **LD145:** Lug valves, sizes 2" to 12"

Certification

- Certified to NSF/ANSI 372 Lead Free.
- Registered under Canadian Registration Number CRN# OC12102.8CL.

Body Design

- Ductile Iron ASTM A536
- WD Model: a one-piece wafer design with flange locating holes in larger sizes (8" to 12")
- LD Model: valves are full lug with tapped lugs, to ANSI 125/150 drilling. Face-to-face dimensions meet universal interchangeability standards outlined in MSS SP-67 and API 609.
- Models come equipped with an extended neck providing at least 2" clearance between the valve top plate and pipe flange to allow ease of insulation installation.

Blowout Proof Seat with Molded in Stiffener Ring

- Isolates body from process media.
- Valves are equipped with a stretch-resistant, non-collapsible blowout-proof seat.
- Phenolic Stiffener Ring (2"-12")
- Aluminum Stiffener Ring (14"-24" LD141 only)

Seat – No Gaskets Required

- Seat design eliminates the need for flange gaskets.
- Installs between standard ANSI 125/150 flanges.

Mounting Flange For Actuator

- ISO 5211 standard cast-in top plate
- Designed to dimensions for easy mounting of Apollo® actuators and manual operators.

Through Shaft

- Assures positive disc positioning and dependable performance.

Weather Seal

- Shaft equipped with weather seal to prevent external media from entering the shaft bore.

Square Shaft-to-Disc Connection

- Provides a robust shaft-to-disc connection without pins or bolts. Easy maintenance.

Three Bushings

- Supports shaft at three locations to enhance shaft alignment and absorb actuator side thrusts.

Profiled Disc Design

- Precision machined disc edge creates bubble tight shutoff, primary seal. Polished disc edge ensures long seat life, minimal torque.

Shaft Seal

- The shaft diameter is greater than the diameter of the seat's shaft hole creating a robust shaft seal.
- The stiffening ring molded into the seat guards against distortion, a frequent cause of shaft leakage.

End of Line Service

- All LD Model valves are equipped with retainer screws for dead end service; 2" through 12" to 200 psig

Testing: All valves are 100 percent factory tested before shipping