

# Lever-Operated Horizontal Crimp Tester

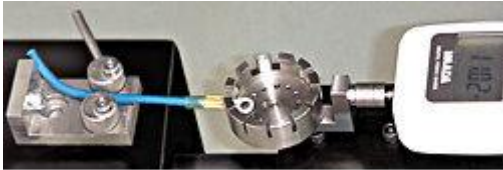

- Horizontal test stand
- DPS Digital Force Gauge (specify range)
- Crimp Test Attachments:
  - Stand side: specify GT-30 Vise Chuck or WG-300 Cam Grip
  - Gauge side: specify WG-1, WG-2, WG-3 or KC-100 Grip
- Max Load: 220 lbf
- Outstanding accuracy of  $\pm 0.2\%$
- Real time and peak mode (selectable)
- Newton, lb and kg units are selectable
- RS-232C, Digimatic and analog outputs

**PRICING  
DELIVERY  
SUPPORT**



Setup shows WG-3 grip and WG-300 cam grip

All items sold separately



This wire terminal crimp tester is a digital pull tester for checking the pull-off force values of electrical leads, crimped terminals, connectors, and all other pull tests. System comes with test stand and DPS force gauge of your choice. Choose optional pull test attachments wedge grip, cam grip, vise chuck, WG-1 or WG-2 wire grip to suit your application (attachments for other applications are available).

WG-1 is perfect for pull testing crimp on wire terminals. Set the opening size by turning the wingnut until jaws contact sample, then back off a little until the sample slides into the jaws from the side. Then you can simply slide the next sample into the jaws when you are ready to test.

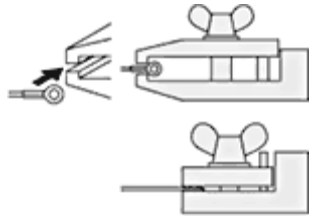

WG-2 grips the actual wire or sample tested with serrated jaws. Ideal for a variety of shapes.

WG-3 multi wire terminal grip has 12 wire gauge apertures on the turret. Locate the appropriate size, lock in position and you're ready to test.

The KC-100 spring-loaded wedge grip is ideal for tensile measurements of thick materials (up to 10mm thick). The serrated jaw is 15mm wide.

## Crimp Test Attachments



WG-1

WG-2

WG-3

KC-100

GT-30 VISE CHUCK

WG-300 CAM GRIP

[Click here for a complete list of special attachments](#)

DPS Ranges (Resolution) Accuracy: $\pm 0.2\%$ F.S. $\pm 1$ LSD			
Model	Capacity (Resolution)		
	Pounds/Ounces	Kilograms/Grams	Newtons
DPS-0.5	8.819 ozf (0.001 ozf)	250.0 gf (0.1 gf)	2.452 N (0.001 N)
DPS-1	17.64 ozf (0.01 ozf)	500.0 gf (0.1 gf)	4.903 N (0.001 N)
DPS-4	4.409 lbf (0.001 lbf)	2.000 kgf (0.001 kgf)	19.61 N (0.01 N)