

Pull Tester - Motorized with Output



- Combination of screw drive system and high performance brushless motor provides extremely smooth and powerful operation over the entire speed range.
- Wide speed range: 0.4 – 11.5 in/min (optional speed ranges available)
- Max clearance 9" (with extender 14")
- No programming required
- Newton, lbf and kgf units are selectable
- RS-232C, Digimatic and analog outputs



Setup shows Z2 force gauge with WG-3 wire terminal grip and WG-300 cam grip All items sold separately

The motorized digital pull tester is designed to check the pull-off force values of electrical leads, crimped terminals and connectors and ensure consistent results. System consists of a motorized test stand and Imada DPS or Z2 gauge in the range of your choice. Choose optional attachments cam grip, vise chuck, WG-1, WG-2, WG-3 or KC-1000 grip to suit your application. Attachments for other applications are available.

WG-1 is perfect for pull testing crimp on terminals. Set the opening size by turning the wingnut until jaws contact sample, then back off a little until the sample slides into the jaws from the side. Then you can simply slide the next sample into the jaws when you are ready to test.

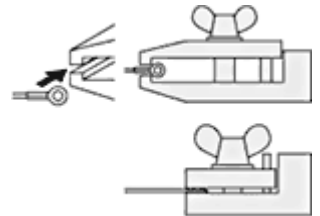

WG-2 grips the actual wire or sample tested with serrated jaws. Ideal for a variety of shapes.

WG-3 multi terminal grip has 12 wire gauge apertures on the turret. Locate the appropriate size, lock in position and you're ready to test.

The KC-1000 spring-loaded wedge grip is ideal for tensile measurements of thick materials (up to 10mm thick). The serrated jaw is 15mm wide.

Pull Test Attachments



WG-1

WG-2

WG-3

KC-1000

GT-30 VISE CHUCK

WG-300 CAM GRIP

Pull Tester Ranges (Resolution) Accuracy: $\pm 0.2\%$ F.S. ± 1 LSD

Z2 Capacity (Resolution)	DPS Capacity (Resolution)	NOTE: In addition to lbf, kilograms and Newtons may be selected from buttons on the force gauge.
Pounds/Ounces	Pounds/Ounces	
7.00 ozf (0.01 ozf)	8.819 ozf (0.001 ozf)	
18.00 ozf (0.01 ozf)	17.64 ozf (0.01 ozf)	
4.400 lbf (0.001 lbf)	4.409 lbf (0.001 lbf)	
11.00 lbf (0.01 lbf)	11.02 lbf (0.01 lbf)	
44.00 lbf (0.01 lbf)	44.09 lbf (0.01 lbf)	
110.0 lbf (0.1 lbf)	110.2 lbf (0.1 lbf)	