

2 ■ CUTTING / SAWING / CORE DRILLING / REAMING / GAUGING

2101 : Cutting Wheel - Steel and Cast Iron Pipe Cutter

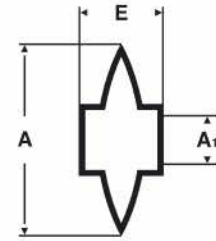

For pipe cutter	Type	A mm	A1 mm	E mm	Packaging	Kg	Ref.
210110 - 210120 - 210130	Steel	32	9	19	5	0,170	210121
210110 - 210120 - 210130	Grey cast iron	30	9	18,75	5	0,170	210122
210145 - 210165	Steel	41	9,55	28	5	0,435	210141
210145 - 210165	Grey cast iron	34	9,55	28	5	0,435	210142
210210	Grey cast iron	42	9,6	8	5	0,285	210211
210220	Grey cast iron	47	11,1	9,5	5	0,390	210221
210210	Ductile cast iron	45	9,6	8	5	0,300	210261
210220	Ductile cast iron	50	11,1	9,5	5	0,375	210266
210250	Construction-type grey cast iron	32	9	19	5	0,170	210251
210260	Ductile cast iron	45	9,6	8	5	0,300	210261
210265	Ductile cast iron	50	11,1	9,5	5	0,375	210266
210260	Grey cast iron	42	9,6	8	5	0,285	210211
210265	Grey cast iron	47	11,1	9,5	5	0,390	210221

STAINLESS STEEL TUBE CUTTER

2104 : Stainless Steel Pipe Cutter 6-28 mm

Max thickness: 3.2 mm.

Soft Touch® non-slip knob: good hold in hand.

Quick and tool-less wheel change.

Fold-away reamer blade.



A mm	A " OD	L mm	H mm	E maxi mm	Kg	Ref.
6 - 28	1/4 - 1.1/8	142	55	3,2	0,385	210469



Safety, one of the top concerns of Virax

Safety is a vital concern in the Virax production site:

Build awareness, communicate and train in risks.

Develop the risk prevention process.

Target zero accident.

Monitor safety equipment.