

Series SG Gear Operator

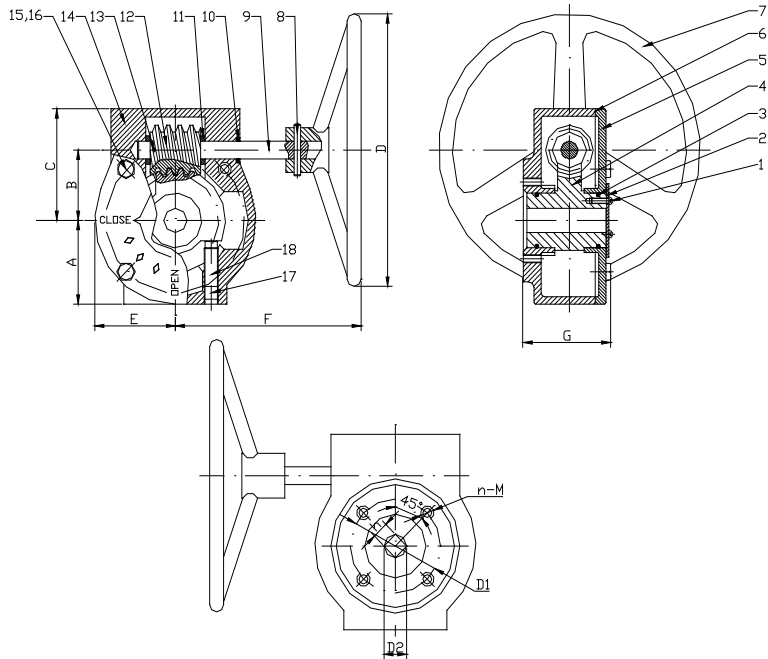

Item	Quantity	Part Description	Material Code
1	2	Bolts	Steel
2	1	Indicator	Aluminum
3	2	"O" Ring	ASTM D2000 NBR
4	1	Worm Gear	ASTM A536 65-45-12
5	1	Cover	ASTM A126 Class B
6	1	Spacer Sheet	
7	1	Hand Wheel	ASTM A126 Class B
8	1	Taper Pin	AISI 1045
9	1	Shaft	AISI 1045
10	1	Ring	ASTM D2000 NBR
11	2	Baffle Ring	ASTM536 65-45-12
12	1	Worm	AISI 1045
13	1	Taper Pin	STEEL
14	1	Housing	ASTM A126 Class B
15	4	Bolts	Steel
16	4	Spring Spacer	AISI 1566
17	1	Locking Screw	Steel
18	1	Adjusting Screw	Steel



Model	Gear Ratio	Unit	A	B	C	D	D1	D2	E	F	G	h	M	n	Output Torque IN/LBS	Weight LBS/KG
SG-11	24:1	in mm	2.13 54	1.77 45	2.87 73	5.9 150	F05	0.496 13	2.07 53	6.1 155	2.68 68	0.354 9	M6	4 102	1504	10.1 5
SG-12	24:1	in mm	2.13 54	1.77 45	2.87 73	5.9 150	F07	0.56 14	2.07 53	6.1 155	2.68 68	0.43 11	M8	4 102	1504	10.1 5
SG-13	30:1	in mm	3.01 76	2.6 66	3.94 100	11.81 300	F10	1.12 28	3.00 76	8.74 222	3.00 76	0.867 22	M10	4 102	6195	18.7 8
SG-14	50:1	in mm	3.19 81	3.05 77	4.59 117	11.81 300	F10	1.12 28	3.19 81	8.39 213	3.18 81	0.867 22	M10	4 102	10621	24.64 11

Series SG Gear Operator (Continued)



Item	Quantity	Part Description	Material Code
1	1	Housing	ASTM A126 Class B
2	1	Top Cover	ASTM A126 Class B
3	1	Gear Quadrant	Ductile Iron
4	1	Worm Gear	Steel
5	1	Input Shaft	Steel
6	1	Hand Wheel	ASTM A126 Class B
7	1	Indicator	Aluminum
9	2	Adjustment Screw	Steel
10	2	Set Screw	Steel
11	1	Shaft Seal	Buna-N

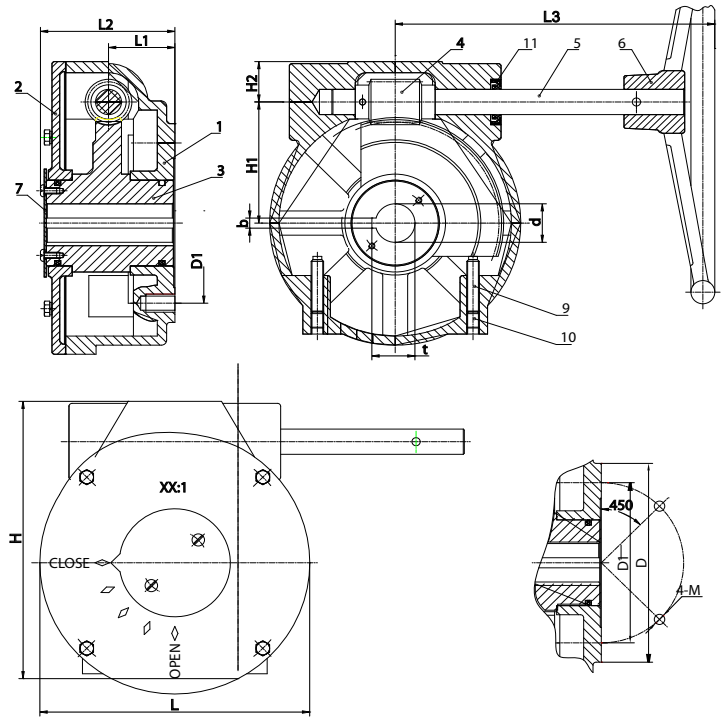

Model	Gear Ratio	Unit	D	D1	H	H1	H2	L	L1	L2	L3	M	b	d	t	Φ	Output Torque IN/LBS	Weight LBS/KG
SG-15	50:1	in mm	5.51 140	4.02 102	7.78 198	3.05 77	1.54 39	6.38 162	1.71 43	3.18 81	8.39 213	0.39 10	0.315 8	1.25 32	1.38 35	11.81 300	10621	24.6 11
SG-16	80:1	in mm	7.76 197	5.51 140	11.32 288	4.72 120	1.57 40	10.04 255	2.32 59	4.92 125	9.88 251	0.63 16	0.393 10	1.31 33	1.42 36	11.81 300	22127	73.7 33
SG-17	80:1	in mm	7.76 197	5.51 140	11.32 288	4.72 120	1.57 40	10.04 255	2.32 59	4.92 125	9.88 251	0.63 16	0.393 10	1.5 38	1.61 41	11.81 300	22127	73.7 33
SG-18	560:1	in mm	7.76 197	5.51 140	12.32 313	4.72 120	3.39 86	8.43 214	2.36 60	6.06 154	13.3 338	0.63 16	0.393 10	1.63 41	1.74 44	11.81 300	22127	105.8 48
SG-19	640:1	in mm	6.50 165	5.18 132	12.32 313	4.72 120	2.17 55	10.87 276	2.36 60	6.06 154	13.3 338	0.79 20	0.630 16	2.0 51	2.22 56	11.81 300	35403	105.8 48

SDC Declutchable Manual Override



- One piece body, IP67 solid weatherproof sealing
- ISO5211 mounting standard
- Self lubricated bearing for worm & gear
- WCB body surface treated by phosphating, epoxy & polyester coating
- Optional relief air shut off (RV)
- Optional lock out (LO)

SDC Dimensions

SDC-17

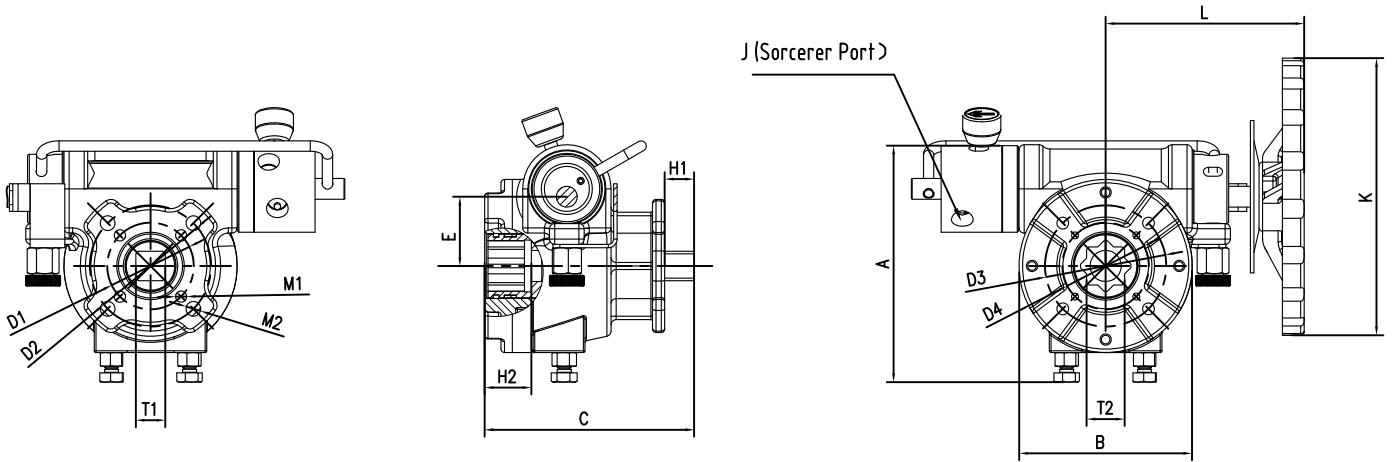

SDC-53, SDC-106, SDC-177, SDC-354

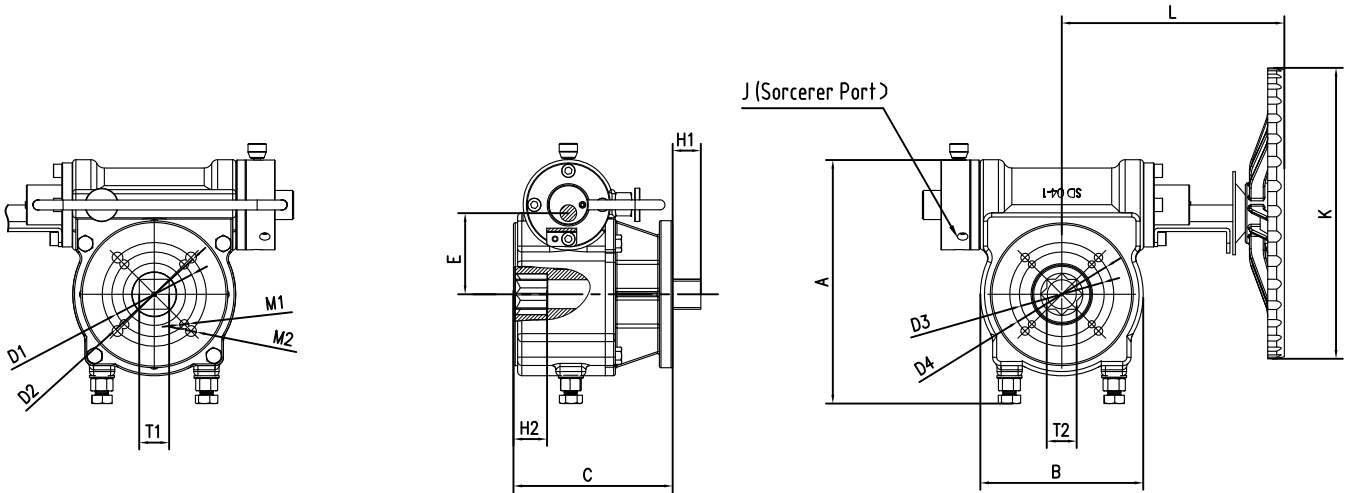

Model	A	B	C	D1	D2	D3	D4	E	L	M1	M2
SDC-17	120	100	104	F05	F07	F05	F07	44.5	120	4-φ7	4-φ9
SDC-53	192	148	145	F07	F10	F07	F10	71	175	4-φ9	4-φ11
SDC-106	192	148	145	F07	F10	F07	F10	71	181	4-φ9	4-φ11
SDC-177	260	196	192	F10	F12	F10	F12	107.5	272	4-φ11	4-φ13
SDC-354	334	255	181	F16	-	F12	F16	123	275	4-φ22	-

Model	T1	T2	H1	H2	K	J	Actuators	Output Torque
SDC-17	□ 17	□ 17	14	25	φ200	1/4"NPT	SPN II 075~100	1770 in/lb
SDC-53	□ 22	□ 27	19	30	φ200	1/4"NPT	SPN II 100~145	5310 in/lb
SDC-106	□ 27	□ 27	19	30	φ300	1/4"NPT	SPN II 145~180	10620 in/lb
SDC-177	□ 36	□ 36	34	40	φ400	1/4"NPT	SPN II 200~240	17700 in/lb
SDC-354	□ 46	□ 46	45	50	φ700	1/4"NPT	SPN II 265~300	35400 in/lb