

# RL35023S

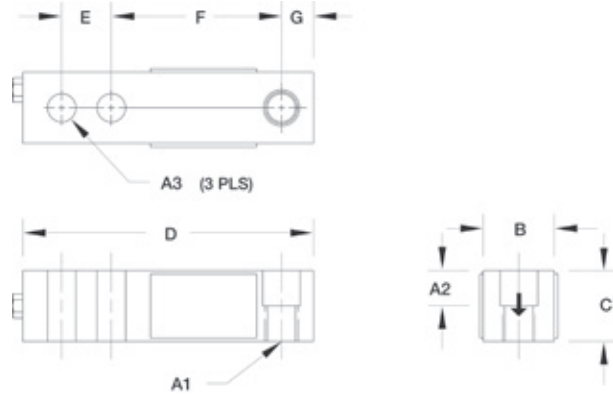

Single-ended Beam, Stainless Steel, NTEP Certified 1:5000 Class III Multiple Cell, IP67



Picture is a representation of actual product



## Specifications

<b>Full Scale Output:</b> 3.0 mV/V	<b>Safe Sideload:</b> 100% full scale	<b>Seal Type:</b> Environmentally sealed, IP67	<b>Insulation Resistance:</b> 5,000 megohms
<b>Output Resistance:</b> 349-355 ohms	<b>Rated Excitation:</b> 5-10 VDC (15 V maximum)	<b>Cable Length:</b> 20 ft (6.1 m)	<b>Warranty:</b> Two-year limited warranty
<b>Input Resistance:</b> 343-357 ohms	<b>Nonlinearity:</b> 0.03% full scale	<b>Cable Diameter:</b> 0.200 polyurethane jacket	<b>Approvals:</b>   
<b>Material/Finish:</b> Stainless steel	<b>Deflection at Capacity:</b> 500 lb-1,500 lb=0.013 in (0.33 mm) 1,000 lb-5,000 lb=0.017 in-0.025 in (0.4318 mm-0.635 mm) 5,000 lb-10,000 lb=0.025 in-0.035 in (0.635 mm-0.889 mm) 15,000 lb-20,000 lb=0.048 in-0.013 in (1.2912 mm-0.3302 mm)	<b>Cable Coloring:</b> Red .....+ Excitation Black.....- Excitation Green.....+ Signal White.....- Signal	
<b>Temperature:</b> Compensated range 14°F to 104°F/-10°C to 40°C Operating range -40°F to 150°F/-40°C to 65°C	<b>Safe Overload:</b> 150% full scale	<b>Hysteresis:</b> 0.02% full scale	

## Dimensions

RATED CAPACITY	A1	A2	A3	A4	B	C	D	E	F	G
<b>lb/inches</b>										
1,000-4,000	1/2-20 UNF-2B	0.62	0.53	0.53 dia	1.25	1.25	5.12	1.00	3.00	0.50
5000-10,000	3/4-16 UNF-2B	0.75	0.78	0.78 dia	1.50	1.50	6.75	1.50	3.75	0.75
<b>kg/mm</b>										
453.6-1,814.4	1/2-20 UNF-2B	15.8	13.5	13.5 dia	31.8	31.8	130.1	25.4	76.2	12.7
2,268.0-4,535.9	3/4-16 UNF-2B	19.1	19.8	19.8 dia	38.1	38.1	171.5	38.1	95.3	19.1

## Order Information

LOAD RATING	PART #	EST. SHIPPING WEIGHT	PRICE
1,000 lb (453.6 kg)	30649	3 lb	\$325.00
2,000 lb (907.2 kg)	30650	3 lb	325.00
2,500 lb (1,134.0 kg)	30651	3 lb	325.00
4,000 lb (1,814.4 kg)	30652	3 lb	325.00
5,000 lb (2,268.0 kg)	30653	5 lb	415.00
10,000 lb (4,535.9 kg)	30654	5 lb	415.00
<b>Conduit Adapter Kit (must be factory installed to maintain warranty)</b>			
3/8-24 nipple	31533*	1 lb	30.00
3/8-24 to 1/4-18NPT	31534*	1 lb	30.00

\* PN 31533 and PN 31534 must be installed together to form the Conduit Adapter Kit

## Interchangeable Products

MANUFACTURER	MODEL	PAGE #
VPG Sensortronics®	65023 S	311
VPG Sensortronics	65023 SS	306
VPG Celtron®	SQB-HSS	201

## Weigh Module Available

MANUFACTURER	MODEL	PAGE #
Rice Lake Weighing Systems	RL50210	52
Rice Lake Weighing Systems	RL1800 Series	62