



NRM20K - NRM25K

Specifications

Multi-Way Reach Trucks

2.0 - 2.5 tonnes



Characteristics			Cat Lift Trucks	Cat Lift Trucks
1.1	Manufacturer (abbreviation)		NRM20K	NRM25K
1.2	Manufacturer's model designation		Battery	Battery
1.3	Power source: (battery, diesel, LP gas, petrol)		Sit-on	Sit-on
1.4	Operator type: pedestrian, (operator)-standing, -seated			
1.5	Load capacity	Q (kg)	2000	2500
1.6	Load centre distance	c (mm)	600	600
1.8	Load distance, axle to fork face	x (mm)	(See table)	(See table)
1.9	Wheelbase	y (mm)	1485	1485
Weight				
2.1	Truck weight, without load / including battery (simplex mast, lowest lift height)	kg	6550	7300
2.3	Axle loading without load, front/rear (simplex mast, lowest lift height)	kg	2700 / 2x 925	2900 / 2x 950
2.4	Axle loading, mast forward, with maximum load, front/rear (simplex mast, lowest lift height)		850 / 2x 2850	600 / 2x 3350
2.5	Axle loading, mast retracted, with maximum load, front/rear (simplex mast, lowest lift height)		2200 / 2x 2175	2400 / 2x 2450
Wheels, Drive Train				
3.1	Tyre type: V=solid, L=pneumatic, SE=solid pneumatic - front/rear		Vul / Vul	Vul / Vul
3.2	Tyre dimensions, front		285 / 75	285 / 75
3.3	Tyre dimensions, rear		343 / 140	343 / 140
3.5	Number of wheels, front/rear (x=driven)		1x / 4	1x / 4
3.6	Track width (centre of tyres), load side	b10 (mm)	1410	1410
Dimensions				
4.1	Mast tilt, forwards/backwards	α/β °	2 / 6	2 / 6
4.2	Height with mast lowered (see tables)	h1 (mm)	(See table)	(See table)
4.3	Free lift (see tables)	h2 (mm)	(See table)	(See table)
4.4	Lift height (see tables)	h3 (mm)	(See table)	(See table)
4.5	Overall height with mast raised	h4 (mm)	(See table)	(See table)
4.7	Height to top of overhead guard	h6 (mm)	2185	2185
4.8	Seat height or platform height	h7 (mm)	1055	1055
4.10	Load legs	h8 (mm)	485	485
4.15	Fork height, fully lowered	h13 (mm)	50	50
4.19	Overall length	l1 (mm)	2590	2590
4.20	Length to fork face (includes fork thickness)	l2 (mm)	(See table)	(See table)
4.21	Overall width	b1 (mm)	1700	1700
4.22	Fork dimensions (thickness, width, length)	s / e / l (mm)	50 / 120 / 1150	50 / 120 / 1150
4.24	Fork carriage width	b3 (mm)	1680	1680
4.25	Outside width over forks (minimum/maximum)	b5 (mm)	560 - 1970	560 - 1970
4.26	Innerwidth of load legs	b4 (mm)	900	900
4.28	Mast reach	l4 (mm)	(See table)	(See table)
4.32	Ground clearance at centre of wheelbase, with load (forks lowered)	m2 (mm)	80	60
4.33	Working aisle width (Ast) with 1000 x1200 mm pallets, load crosswise, platform up/down	Ast (mm)	(See table)	(See table)
4.34	Working aisle width (Ast) with 800 x1200 mm pallets, load lengthwise, platform up/down	Ast (mm)	(See table)	(See table)
4.35	Turning circle radius	Wa (mm)	1800	1800
4.37	Truck length over load legs	l7 (mm)	1980	1980
Performance				
5.1	Travel speed, with/without load	km/h	10.0 / 10.5	10.0 / 10.5
5.2	Lifting speed, with/without load	m/s	0.23 / 0.43	0.21 / 0.43
5.3	Lowering speed, with/without load	m/s	0.40 / 0.38	0.40 / 0.38
5.4	Reach speed, with/without load	m/s	0.10 / 0.10	0.10 / 0.10
5.8	Maximum gradeability, with/without load	%	8.0 / 12.5	7.0 / 12.0
5.9	Acceleration time (10 metres) with/without load	s	6.0 / 5.6	6.5 / 5.6
5.10	Service brakes (mechanical/hydraulic/electric/pneumatic)		Electro-mechanical	Electro-mechanical
Electric motors				
6.1	Drive motor capacity (60 min. short duty)	kW	7.5	7.5
6.2	Lift motor output at 15% duty factor	kW	14.0	14.0
6.4	Battery voltage/capacity at 5-hour discharge	V/Ah	48 / 775, 930	48 / 775, 930
6.5	Battery weight	kg	1100, 1300	1100, 1300
Miscellaneous				
8.1	Type of drive control		Stepless	Stepless



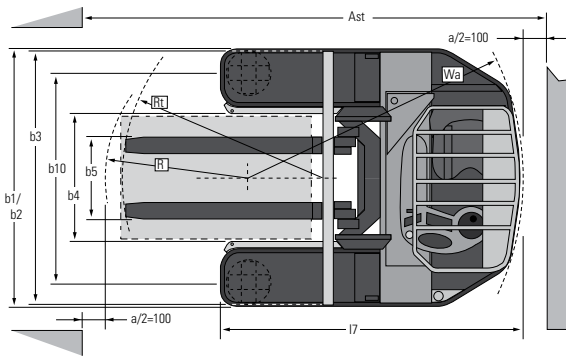
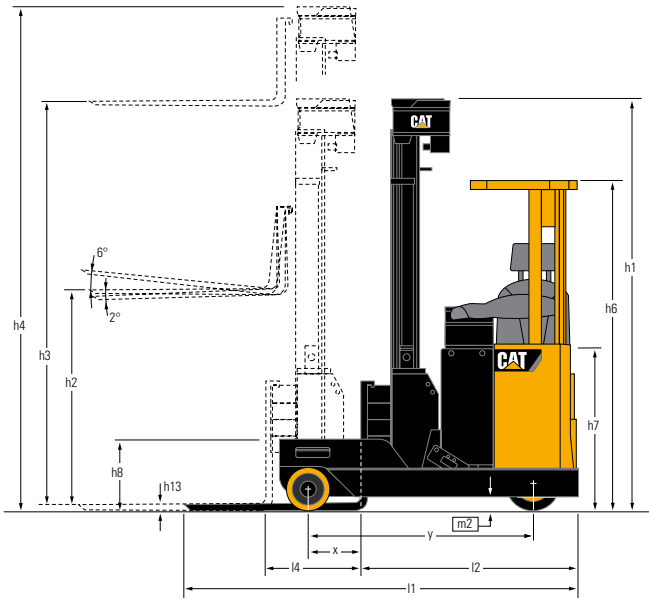

$Ast = Wa + R + a$
 $Ast =$ Working aisle width
 $Wa =$ Turning radius
 $a =$ Safety clearance = 2×100 mm
 $R = \sqrt{(l6 - x)^2 + (l12 / 2)^2}$



Introducing the solution to handle wide loads in narrow aisles...

Lower Cost of Ownership

- Broad selection of built-in diagnostic functions minimise troubleshooting and downtime.
- Cab swings wide open, enabling quick and easy maintenance.
- AC technology for all motors and controllers (drive, pump and steering motors).
- AC drive motor provides powerful acceleration, regenerative braking and stepless modulation of travel speed.
- Each load wheel has an independent steer motor, controller and brake system for enhanced manoeuvrability.
- All wheels turn 360° in either direction for infinite steering precision.

Unmatched Productivity

- Smooth and easy handling of long loads in narrow aisles.
- Multi-directional travel: forwards, backwards, parallel, sideways, and rotational. Travel modes are controlled by a selection switch.
- High frequency control unit for the pump results in smooth, jolt free performance for each individual hydraulic function.
- Fully programmable functions like speed, acceleration and braking for job-matched performance.

Safety and Ergonomics

- Comfortable, high-tech and functional operator's compartment.
- The swing-away control console ensures optimum driving comfort.
- Fully adjustable seat for weight, backrest and driving position.
- Clear view mast for unobstructed view for the operator.

Options

- Lift height indicator or lift height pre-selector.
- Hinged elbow support for driver.
- Radio / speaker system.
- Warning light.
- Seat head rest.

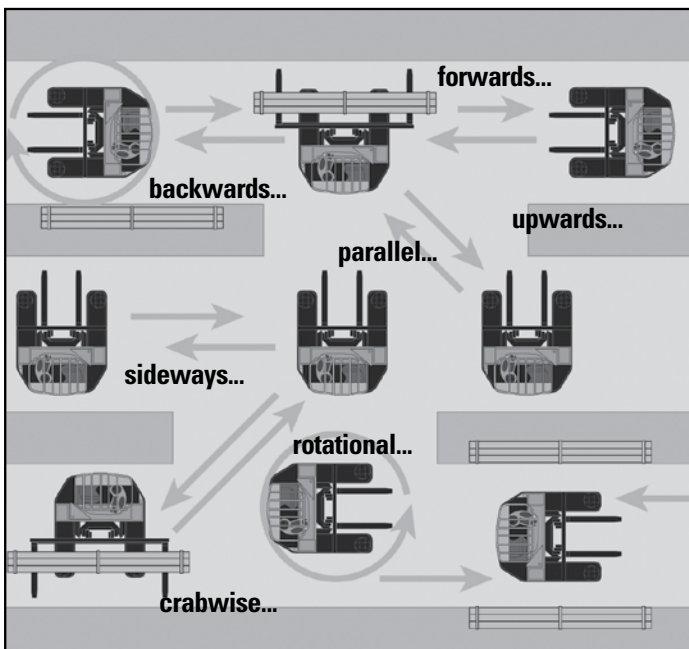

Cat® Lift Trucks.

Your partner in materials handling.

When your materials flow organisation requires the best, rely on Cat Lift Trucks.

Pointed research and development programs and regular interfacing with users together lead to distinctive product features, good product reliability and high user acceptance.

The highly ergonomic NRM20K and NRM25K Multi-Way Reach Truck models are revolutionary in concept, imaginative in execution, with performance you've come to expect from a Cat® product. These very robust and highly manoeuvrable machines feature multi-directional travel, exceptional stability and impressive residual capacities at lift heights up to 9.0metres.

Cat Lift Trucks is committed to quality. This means providing you with equipment and services which result in the most cost-effective solutions for your business.

NRM20K - NRM25K					
Mast Type	3+h13 mm	h1 mm	h4 mm	h2+h13 mm	Carriage tilt F/B (°)
Triplex with free lift	5400	2495	6200	1800	2/6
	5700	2595	6500	1900	2/6
	5900	2662	6700	1967	2/6
	6300	2795	7100	2100	2/6
	7000	3028	7800	2333	2/6
	7500	3195	8300	2500	2/6
	8000	3362	8800	2667	2/6
	8500	3528	9300	2833	2/6

Mast Performance and Capacity

h1 = Overall lowered height
h4 = Overall extended height
h2 + h13 = Free lift

NRM20K / NRM25K Integrated fork spreader with tilt							
Chassis width (mm)	Battery current (Ah)	Battery weight (kg)	Ast*(Ast3*) 4.33 (mm)	Ast*(Ast3*) 4.34 (mm)	l4 4.28 (mm)	l2 4.20 (mm)	x 1.8 (mm)
1700	800	1100	2885 (2650)	2940 (2850)	620	1440	255
1700	960	1300	2925 (2705)	2990 (2906)	565	1495	200

Cat lift trucks dealers are committed to providing you a comprehensive array of services

- Advice on machine selection to provide you the most economical solution for the job.
- Parts availability and trained service mechanics to respond quickly and effectively when you need them.
- A variety of preventive maintenance, service and repair plans tailored to your needs.
- A full range of acquisition possibilities, straight purchase, short and long term rental, leasing etc.



info@catliftruck.com
www.catliftruck.com

WESC1546(01/14)ok
©2014, MCFE. All Rights Reserved. CAT, CATERPILLAR their respective logos, 'Caterpillar Yellow' and the 'Power Edge' trade dress, as well as corporate and product identity used herein, are trademarks of Caterpillar and may not be used without permission.

Printed in The Netherlands

NOTE: Performance specifications may vary depending on standard manufacturing tolerances, vehicle condition, types of tyres, floor or surface conditions, applications, or operating environment. Trucks may be shown with non-standard options. Specific performance requirements and locally available configurations should be discussed with your Cat lift trucks Dealer. Cat Lift Trucks follows a policy of continual product improvement. For this reason, some materials, options and specifications could change without notice.

