

BRASS AIR COCKS & SHUT-OFF VALVES

TEE HANDLE HEXAGON SHOULDER

MODEL	NPT Connection
EFI 63T	1/8"
EFI 64T	1/4"



LEVER HANDLE FEMALE

WITH MALE UNION
Conn. Size: 1/4" NPT

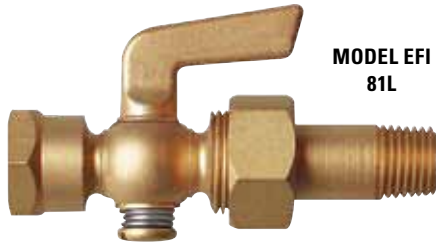

MODEL EFI 81L

TEE HANDLE FEMALE WITH MALE UNION

Conn. Size: 1/4" NPT



MODEL EFI 81T

PET COCK

CONSTRUCTION: STAINLESS STEEL

Pressure Rating: 150 PSI

Sizes: 1/8", 1/4", 3/8", 1/2" NPT



MODEL EFI 1508



MODEL EFI 129
BRASS



MODEL EFI 130
STAINLESS STEEL

THROTTLER FOR REDUCING PULSATION

CONSTRUCTION: BRASS,
TYPE 303 STAINLESS STEEL

Pressure Rating: 600 PSI (Brass)
2000 PSI (Stainless Steel)

NPT Connection: 1/4" male inlet and
1/4" female outlet

The throttler employs the variable restricted orifice principle—the entrance for pressure can be made larger if the pressure medium is of high viscosity or smaller when the pressure is high and the frequency of pulsation great. Adjustment of the variable orifice is accomplished by means of an eccentric which is activated by a thumb screw. A locknut protects the adjustment from vibration or inadvertent change.

BALL VALVE

CONSTRUCTION: BRONZE
OR STAINLESS STEEL

BRONZE FEATURES:

- Chromium plated ball
- Reinforced PTFE seats and stuffing box ring
- Blow-out-proof stem design
- Meets WW-V-35C Type: II

Composition: BZ Style: 3

STAINLESS STEEL FEATURES:

- Investment cast components
- Reinforced PTFE seats and stuffing box ring
- Stainless Steel lever and nut
- Meets NACE-MR-01-75
- Meets WV-V-35C Type: II

Composition: SS Style: 3

STANDARD VALVE RATINGS:

- BRONZE VALVES
600 PSI WOG, Cold, Non-Shock
- 316 STAINLESS STEEL VALVES
2,000 PSI WOG, 1/4" thru 1"
1,500 PSI WOG, 1-1/4" thru 2"
Cold, Non-Shock
- All standard valves rated for 150 PSI saturated steam on-off service
- Vacuum service to 29 inches mercury
- All valves tested to MSS-SP-72, 100 PSI air under water, in the opened and closed position



MODEL EFI 70
BRONZE



MODEL EFI 76
STAINLESS STEEL

NPT Conn.	Dimensions in Inches			
	A	B	C	D
1/4	.37	2.06	1.75	3.87
3/8	.37	2.06	1.75	3.87
1/2	.50	2.25	*1.75	3.87
3/4	.68	3.00	2.12	4.87
1	.87	3.37	2.25	4.87
1-1/4	1.00	4.00	2.62	5.50
1-1/2	1.25	4.37	3.05	8.00
2	1.50	*4.68	3.24	8.00

*B = 5.50, C = 1.81 in Stainless Steel

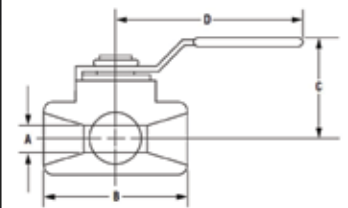

NEEDLE VALVE

CONSTRUCTION: CARBON STEEL
OR 316 STAINLESS STEEL

FEATURES:

- 10,000 PSI - cold non-shock
- Reinforced PTFE Packing
- Steel Valves are Nickel Plated
- Barstock Design
- 3/4" and 1" have Tee Handles
- 250 PSI Saturated Steam

Sizes: 1/4", 3/8", 1/2", 3/4" or 1" NPT



MODEL EFI 1900

STOP COCK

CONSTRUCTION: STAINLESS STEEL

Pressure Rating: 150 PSI

Sizes: 1/8", 1/4", 3/8" NPT



MODEL EFI 1506