

# RL35023

Single-ended Beam, Alloy Steel, NTEP Certified 1:5000 Class III Multiple Cell, IP67

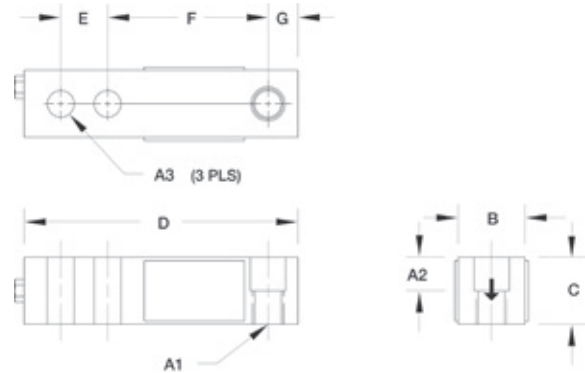

Picture is a representation of actual product



## Specifications

**Full Scale Output:**

3.0mV/V

**Output Resistance:**

349-355 ohms

**Input Resistance:**

343-357 ohms

**Material/Finish:**

High-alloy steel, nickel plated

**Temperature:**

Compensated range  
14°F to 104°F/-10°C to 40°C  
Operating range  
-40°F to 150°F/-40°C to 65°C

**Safe Overload:**

150% full scale

**Safe Sideload:**

100% full scale

**Rated Excitation:**

5-10 VDC (15 V maximum)

**Nonlinearity:**

0.03% full scale

**Hysteresis:**

0.02% full scale

**Insulation Resistance:**

5,000 megohms

**Deflection at Capacity:**

500 lb-1,000 lb=0.013 in (0.3 mm)  
2,000 lb-3,000 lb=0.015 in (0.4 mm)  
4,000 lb-5,000 lb=0.025 in (0.6 mm)  
10,000 lb=0.035 in (0.9 mm)

**Seal Type:**

Environmentally sealed, IP67

**Cable Length:**

20 ft (6.1 m)

**Cable Diameter:**

0.200 polyurethane jacket

**Cable Color Code:**

Red .....+ Excitation  
Black.....- Excitation  
Green .....+ Signal  
White .....- Signal

**Warranty:**

Two-year limited warranty

**Approvals:**



## Dimensions

RATED CAPACITY	A1	A2	A3	B	C	D	E	F	G
<b>lb/inches</b>									
500	1/2-20 UNF-2B	0.50	0.53	1.25	1.00	5.12	1.00	3.00	0.50
1,000-5,000 SE*	1/2-20 UNF-2B	0.62	0.53	1.25	1.25	5.12	1.00	3.00	0.50
5,000 LE**-10,000	3/4-16 UNF-2B	0.75	0.78	1.50	1.50	6.75	1.50	3.75	0.75
15,000-20,000	1-14 UNS-2B	1.00	1.03	2.00	2.00	8.88	2.00	4.88	1.03
<b>kg/mm</b>									
226.8	1/2-20 UNF-2B	12.7	13.5	31.8	25.4	130.1	25.4	76.2	12.7
453.6-2,268.0 SE*	1/2-20 UNF-2B	15.8	13.5	31.8	31.8	130.1	25.4	76.2	12.7
2,268.0 LE**-4,535.9	3/4-16 UNF-2B	19.1	19.8	38.1	38.1	171.5	38.1	95.3	19.8
6,803.9-9,071.9	1-14 UNS-2B	25.4	26.2	50.8	50.8	225.6	50.8	124.0	25.0

## Order Information

LOAD RATING		PART #	EST. SHIPPING WEIGHT	PRICE
1,000 lb	(453.6 kg)	21528	3 lb	\$295.00
2,000 lb	(907.2 kg)	21529	3 lb	295.00
2,500 lb	(1,134.0 kg)	21530	3 lb	295.00
3,000 lb	(1,360.8 kg)	21531	3 lb	295.00
4,000 lb	(1,814.4 kg)	21532	3 lb	295.00
5,000 lb SE*	(2,268.0 kg)	21535	3 lb	295.00
5,000 lb LE**	(2,268.0 kg)	21533	5 lb	375.00
10,000 lb	(4,535.9 kg)	21534	5 lb	375.00
<b>Non-NTEP Certified</b>				
500 lb	(226.8 kg)	17181	3 lb	295.00
15,000 lb	(6,803.9 kg)	17186	10 lb	645.00
20,000 lb	(9,071.9 kg)	17187	10 lb	645.00
20,000 lb***	(9,071.9 kg)	166127	10 lb	725.00
<b>Conduit Adapter Kit (must be factory installed to maintain warranty)</b>				
3/8-24 nipple		31533****	1 lb	30.00
3/8-24 to 1/4-18 NPT		31534****	1 lb	30.00

## Interchangeable Products

MANUFACTURER	MODEL	PAGE #
VPG Celtron®	SQB	200
VPG Sensortronics®	65023	304

## Weigh Module Available

MANUFACTURER	MODEL	PAGE #
Rice Lake Weighing Systems	RL50210TA	52
Rice Lake Weighing Systems	RL1800 Series	62

\* SE refers to small envelope

\*\* LE refers to large envelope

\*\*\* Overbraided cable

\*\*\*\* PN31533 and PN 31534 must be installed together to form the Conduit Adapter Kit