



# CHECK VALVE

## MODEL CK3M/CK3T/CK3R

### HIGH QUALITY DISC TYPE CHECK VALVE WITH LOW PRESSURE DROP

#### Benefits

**Compact check valve for steam, air and water services.**

1. Fine machined metal, Fluorine Resin or Nitrile Rubber valve seats provide tight closure.
2. Stainless steel internal parts and body ensure long service life.
3. No wear of valve disc or valve seat even with frequent, impulsive contact between them.
4. Performance assured with installation in either vertical, or horizontal pipelines.
5. Simple construction eliminates problems.
6. Low pressure drop due to large flow area.



#### Specifications

Model	CK3M	CK3T	CK3R
Connection	<b>Screwed</b>		Screwed
Size (in)	<b>1/2, 3/4, 1, 1 1/4, 1 1/2, 2</b>		1/2, 3/4, 1, 1 1/4, 1 1/2, 2
Sealing Surface*	Stainless Steel	Fluorine Resin	Nitrile Rubber
Maximum Operating Pressure (psig) PMO	300	230	
Maximum Operating Temperature (°F) TMO	428	365	194
Minimum Required Differential Pressure for Tight Sealing (psi)	—		7
Minimum Opening Differential Pressure** (psi)	0.3		
Maximum Allowable Pressure (psig) PMA	300		
Maximum Allowable Temperature (°F) TMA	428		
Applicable Fluids***	Steam	Steam, Hot water	Air, Water

\* Perfect sealing cannot be guaranteed for metal or fluorine resin sealing surfaces.

Degradation of, or debris on, rubber sealing surfaces may also prevent perfect sealing.

\*\* When the valve has remained closed for a long period of time, the valve and the valve seat may stick, increasing the necessary minimum opening differential pressure.

\*\*\* Do not use for toxic, flammable or otherwise hazardous fluids.

**Connections and sizes in bold are standard**



To avoid abnormal operation, accidents or serious injury, DO NOT use this product outside of the specification range. Local regulations may restrict the use of this product to below the conditions quoted.

No.	Description	Material	ASTM/AISI*	JIS	
①	Valve Body	Cast Stainless Steel	A351 Gr.CF8	SCS13	
②	Inlet Union	Cast Stainless Steel	A351 Gr.CF8	SCS13	
③ <sup>MR</sup>	Union Gasket	Fluorine Resin	PTFE	PTFE	
④ <sup>MR</sup>	Valve Disc	1/2 – 1	Stainless Steel	AISI304	SUS304
		1 1/4 – 2	Cast Stainless Steel	A351 Gr.CF8	SCS13
⑤ <sup>R</sup>	Spring Holder	Stainless Steel	AISI304	SUS304	
⑥	Coil Spring	Stainless Steel	AISI304	SUS304	
⑦	Valve Seat	CK3M	Cast Stainless Steel	A351 Gr.CF8	SCS13
		CK3T	Fluorine Resin	PTFE	PTFE
		CK3R	Nitrile Rubber	D2000BF	NBR

\* Equivalent

Replacement kits available: (M) maintenance parts, (R) repair parts

When requesting replacement kits, please specify the Minimum Opening Differential Pressure.

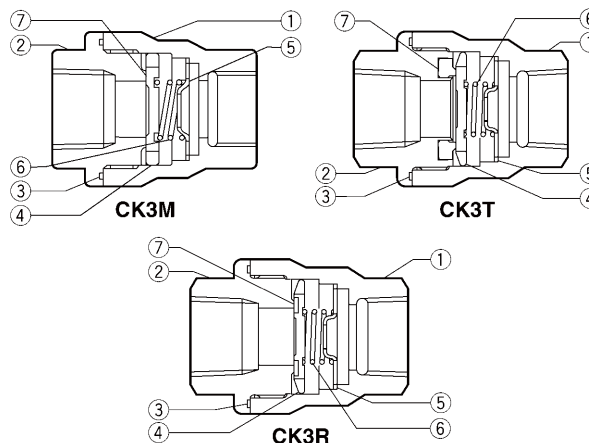

**Dimensions**

● **CK3M/CK3T/CK3R** Screwed

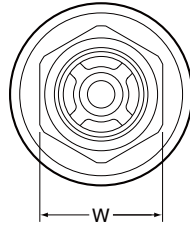
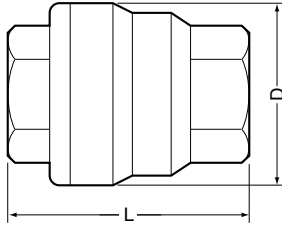

**CK3M/CK3T/CK3R** Screwed\* (in)

Size	L	φ D	W	Weight (lb)
1/2	2 3/16	1 9/16	1 1/16	0.7
3/4	2 3/8	2	1 1/4	1.1
1	2 3/4	2 3/8	1 5/8	1.8
1 1/4	3 1/8	2 15/16	2	2.9
1 1/2	3 3/8	3 3/8	2 3/16	3.5
2	3 15/16	3 3/4	2 3/4	4.9

\* NPT, other standards available

**Cv Values**

Size (in)	1/2	3/4	1	1 1/4	1 1/2	2
Cv (US)	3.7	6.6	10	15	21	29
Cv (UK)	3.1	5.5	8.3	13	17	24
Kvs (DIN)	3.2	5.7	8.6	13	18	25



**DO NOT DISASSEMBLE OR REMOVE THIS PRODUCT WHILE IT IS UNDER PRESSURE.**  
 Allow internal pressure of this product to equal atmospheric pressure and its surface to cool to room temperature before disassembling or removing. Failure to do so could cause burns or other injury. READ INSTRUCTION MANUAL CAREFULLY.

**TLV CORPORATION**

13901 South Lakes Drive, Charlotte, NC 28273-6790  
 Phone: 704-597-9070 Fax: 704-583-1610  
 E-mail: [tlv@tlvengineering.com](mailto:tlv@tlvengineering.com)  
 For Technical Service 1-800 "TLV TRAP"



Manufacturer

ISO 9001/ISO 14001

**TLV CO., LTD.**  
 Kakogawa, Japan

is approved by LRQA Ltd. to ISO 9001/14001

