

Photo Eyes



Retro-reflective

Standard Features

- Many varieties available for both truck scale and dynamic weighing applications
- Arrange photo eyes to keep wheels on scale
- Rugged outdoor applications
- Reflective types work up to 17 ft (2.13 m) in clean conditions
- Quick disconnects for easy replacement
- Broken beams can signal a wheel off the scale or prevent a weighment in unattended systems
- Transmitter/receiver types work up to 100 ft (30.48 m) in clean conditions

Part Number/Price

Part #	Description	Price
Photo Eyes		
78975	Allen-Bradley® photo eye retro-reflective sensor	\$255.00
78976	Photo eye reflector, 3 in diameter	\$25.00
78977	Quick disconnect photo eye cable, 12 ft, 5-Pin mini connector	\$105.00
Photo Switches		
165776	Kit, photo eye switch	\$1,125.00
103013	Photo switch receiver	\$235.00
103014	Photo switch transmitter	\$185.00
103015	Photo switch quick connector receiver	\$105.00
103016	Photo switch quick connector transmitter	\$75.00
130398	Mounting swivel assembly for 103103 and 103014	\$21.00
156532	Photo eye stand kit	\$300.00

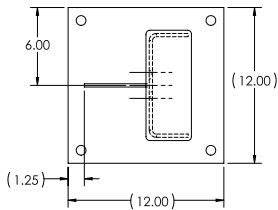

PN 156532 photo eye stand kit dimensions

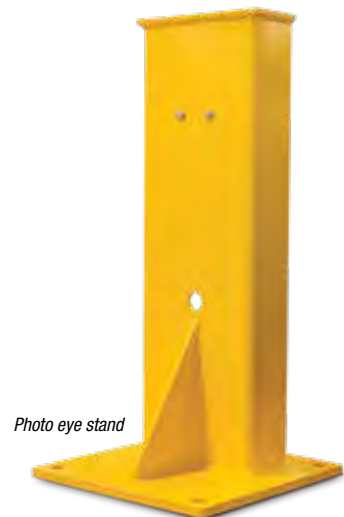
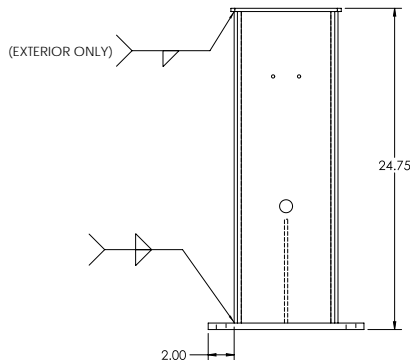

Photo eye stand

Standard Features: Light

- Housing meets or exceeds ITE specifications
- Stainless steel hardware
- 8 in LED lights, enclosure injection molded polycarbonate
- LED modules
- Compliant to ITE UTCSH - LED circular signal
- Temperature compensated power supplies for long LED life
- Conformal coated power supplies
- Intertek/ETL certified and listed on ETL certification program
- 135 VAC



Traffic Light

Standard Features: Pole

- 4.5 in outer dimension aluminum pole
- Cast aluminum base mounts to concrete with four anchor bolts
- Base underside has integrated anchor bolt guide to ensure proper anchor placement
- Removable 8 in access door for cable splicing and bolt attachments (H x W) 15 in x 13 3/4 in

Part Number/Price

Part #	Description	Est. Weight	Price
23146	Traffic light kit, 8 in, 60 W, mounting hardware that mounts to a 4 in outer dimension pipe, 115 VAC	25 lb	\$725.00
85789	Aluminum pole with base, 8 ft (4.5 in OD - schedule 40)	70 lb	\$830.00
179172	Aluminum pole cap, 4.5 in (for use when traffic light not mounted on pole)		\$45.00
87111	Side mount brackets include 12 in nipples and universal hubs, bracket, aluminum upper and lower assembly	10 lb	\$200.00
84504	Anchor bolt with nut washer	2 lb	\$5.00
160242	Kit; dual traffic light		\$3,675.00
160208	Control panel, dual traffic light		\$730.00
156106	Buzzer box, 115 VAC		\$555.00
163734	Switch box, remote (includes legend plates for Zero, Print, Tare, Cancel and Accept)		\$250.00



Traffic Light Pole



Buzzer Box



Control Panel



Switch Box