



### PWM100 MIXER

#### Powerful Jet Mixer for Small Water Tanks

The PAX Water Mixer (PWM100) is an active jet mixer for small water storage tanks. The mixer creates a powerful vortex flow pattern to thoroughly circulate the entire tank volume and prevent water quality issues. Compact and lightweight, the mixer can be easily lowered into the tank from the hatch and self-rights on the tank floor, even on a sloped surface.

- *Lightweight and easy-to-install*
- *Eliminates thermal stratification*
- *Improves disinfectant residual levels*
- *Lowers DBPs and nitrifying bacteria*
- *Protects tank from ice damage and corrosion*

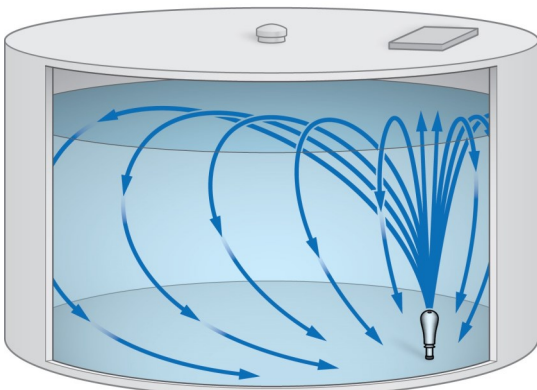

The PAX Water Mixer creates a powerful vortex flow pattern to thoroughly mix the entire tank volume.





### PWM100 MIXER Options

| MIXER SPECIFICATIONS                  | PWM100 (115V)   | PWM100 (230V)                                       | PWM100 (115) with Control Center (PCC105)                | PWM100 (230) with Control Center (PCC105)             |
|---------------------------------------|---|---|--|---|
| <b>Power Supply Requirement</b>       | 120 VAC, 60 Hz, GFCI-protected, 20 amp circuit        | 240 VAC, 60 Hz, GFCI-protected, 15 amp circuit      | 120 VAC, 50/60 Hz, non-GFCI-protected, 20 amp circuit    | 240 VAC, 50/60 Hz, non-GFCI-protected, 20 amp circuit |
| <b>Customer Supplied Power Switch</b> | Type 3R safety disconnect switch                      |   |  |   |
| <b>Motor Type</b>                     | 115 VAC, 60 Hz, ½ HP, water-filled, water-lubricated  | 230 VAC, 60 Hz, ½ HP, waterfilled, water-lubricated |  |   |
| <b>Nominal Power Draw</b>             | 1.15 kVA (670 watts)                                  |   |  |   |
| <b>Footprint Diameter</b>             | 10" (25 cm)   |   |  |   |
| <b>Height</b>                         | 2' 6" (76 cm)   |   |  |   |
| <b>Weight</b>                         | 40 lbs. (18 kg)                                       |   |  |   |
| <b>Material: Housing</b>              | 316 stainless steel                                   |   |  |   |
| <b>Material: Motor Seals</b>          | Chlorine/chloramine-resistant NBR rubber              |   |  |   |
| <b>Material: Foot</b>                 | Chlorine/chloramine-resistant EPDM rubber             |   |  |   |
| <b>Wiring</b>                         | NSF 61 & UL-listed submersible pump cable 14 AWG (2.1 |   | NSF 61 & UL-listed submersible pump cable 14 AWG (2.1    |   |
| <b>Control Center Dimensions</b>      | N/A   |   | 42 lbs. (19 kg) (20" x 16" x 8" / 50 cm x 40 cm x 20 cm) |   |
| <b>Material: Control Center</b>       | N/A   | N/A   | Powder-coated carbon steel, Type 3R enclosure            |   |

**TOP VIEW**

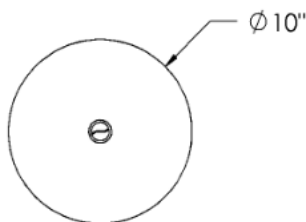

**SIDE VIEW**

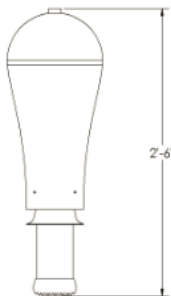

**CONTROL CENTER**

(DEPENDENT ON CONFIGURATION)

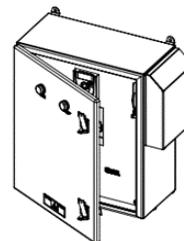

Certified to NSF/ANSI 61