

Interchangeable Products

VPG REVERE®
9363
 ARTECH®
SS2010

Weigh Module Available

RICE LAKE WEIGHING SYSTEMS
ITCM
Isolated Tension Cell Mount page 632

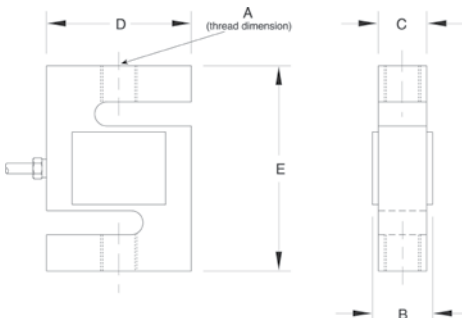

Picture is a representation of actual product

Specifications

- Full Scale Output:**
3.0 (± 0.008) mV/V
- Output Resistance:**
350 (± 3.5) ohms
- Input Resistance:**
390 (± 15) ohms
- Material/Finish:**
Stainless steel
- Temperature:**
Compensated range
14° F to 104° F/-10° C to 40° C
Operating range
-40° F to 150° F/-40° C to 65° C
- Seal Type:**
Environmentally sealed, IP67
- Safe Overload:**
150% full scale
- Rated Excitation:**
5-10 VDC (15 V maximum)
- Nonlinearity:**
0.03% full scale
- Hysteresis:**
0.03% full scale
- Insulation Resistance:**
5,000 megohms
- Cable Length:**
20 ft (6.1 m)
- Cable Color Code:**
Red+ Excitation
Black.....- Excitation
Green.....+ Signal
White- Signal
- Warranty:**
Two-year limited warranty
- Approvals:**



Dimensions

Rated Capacity	A	B	C	D	E
lb/in					
50-300	1/4-28 UNF-2B	0.65	0.46	2.00	2.40
500-1,000	1/2-20 UNF-2B	0.90	0.71	2.00	2.40
2,500	1/2-20 UNF-2B	1.15	0.96	2.00	2.40
3,000	1/2-20 UNF-2B	1.15	0.96	3.00	3.90
5,000	3/4-16 UNF-2B	1.15	0.96	3.00	3.90
10,000	3/4-16 UNF-2B	1.40	1.21	3.00	3.90
15,000	1-14 UNS-2B	1.63	1.46	3.44	5.50
20,000	1 1/4-12 UNF-2B	1.88	1.68	4.44	7.00
kg/mm					
22.7-136	1/4-28 UNF-2B	16.5	11.7	50.8	61.0
226.8-453.6	1/2-20 UNF-2B	22.9	18.0	50.8	61.0
1134.0	1/2-20 UNF-2B	29.2	24.4	50.8	61.0
1360.8	1/2-20 UNF-2B	29.2	24.4	76.2	99.1
2268.0	3/4-16 UNF-2B	29.2	24.4	76.2	99.1
4535.9	3/4-16 UNF-2B	35.7	30.7	76.2	99.1
15,000	1-14 UNS-2B	41.4	37.1	87.4	139.7
20,000	1 1/4-12 UNF-2B	47.8	42.8	112.8	177.8

Order Information

Load Rating	Part#	Est. Weight	Price
RL2000SS NTEP Certified			
100 lb	45.4 kg	46511	2 lb \$295.00
250 lb	113.4 kg	46503	2 lb \$295.00
300 lb	136 kg	181826	2 lb \$295.00
500 lb	226.8 kg	46504	2 lb \$295.00
750 lb	340.2 kg	46505	2 lb \$295.00
1,000 lb	453.6 kg	46506	2 lb \$295.00
2,500 lb	1,134.0 kg	46507	2 lb \$295.00
3,000 lb	1,360.8 kg	46508	4 lb \$325.00
5,000 lb	2,268.0 kg	46509	4 lb \$475.00
10,000 lb	4,535.9 kg	46510	4 lb \$495.00
RL2000SS NON-NTEP Certified			
50 lb	22.9 kg	17013	2 lb \$295.00
15,000 lb	6,804.0 kg	158375	7 lb \$675.00
20,000 lb	9,072.0 kg	158376	13 lb \$895.00
Conduit Adapter Kit* (must be factory installed to maintain warranty)			
3/8-24 nipple		31533*	1 lb \$30.00
3/8-24 to 1/4-18NPT		31534*	1 lb \$30.00

* PN 31533 and PN 31534 must be installed together to form the Conduit Adapter Kit