

# Wall Panels

# Architectural Solutions® 100

For available Finishes see pages 146-150

## Features

- Ultra thin [1/8"] panels provide quick, simple, design sensitive interfaces at door frames, electrical outlets and moldings.
- Abuse-resistant, self-healing finishes convert any drywall surface into tackable display wall.
- Unique combination of abuse resistance and sound absorption provides ideal solution for converting gyms into multi-function rooms.
- Peel & stick tape mounting provides nondestructive attachment to metal and high-pressure laminate surfaces.
- Ultra strong, flexible panels span surface imperfections and drywall joints, eliminating time and expense required to tape, float and finish drywall.
- Extensive selection of standard fabrics, colors, textures and patterns.
- 2 Year Limited Warranty.

Relative Installed Cost:

\$\$\$\$

Product Features at a Glance:

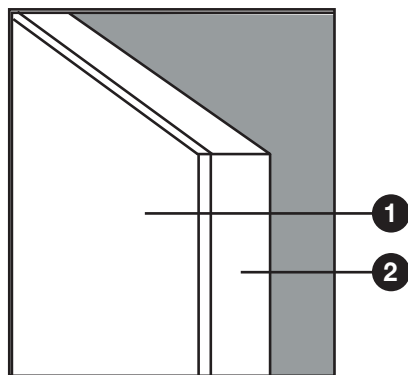

- 1 Finish
- 2 Acoustical Core

## A Cost-Effective Renovation Solution Providing Acoustical Performance and Tackability

Conference Rooms, Gymnasiums, Corridors, Classrooms

### Physical Data

#### Finish

- Guilford of Maine FR701® polyester fabrics
- Maharam Tek-Wall® 1000 polyolefin fabrics
- Omnova Web Core vinyl fabrics
- BGF Nubby glass cloth fabrics
- Hytex Whisper Tex non-woven polyester fabric
- Selected Arc-Com, Designtex, Gilford and Knoll finishes available
- Customer provided material

#### Edge

Square: [4] fabric wrapped edges

#### Mounting

Construction Adhesive, and Peel and Stick Tape

#### Substrate

1/8" X 16-20pcf molded fiberglass tack board

#### Fire

- Core – Class A per ASTM E 84
- Fabrics – Class A per ASTM E 84
- Adhesive – Class A per ASTM E 84

#### Size

- Standard: 4' x 8', 4' x 10'
- Maximum: 5' x 10' (select finishes)
- Custom sizes also available

### Sound Absorption

NRC Range .25 – .35 (Guilford of Maine fabric finish)

### Frequency Band

125 Hz	250 Hz	500 Hz	1000 Hz	2000 Hz	4000 Hz
.05	.26	.26	.24	.37	.65



# Architectural Solutions® 200

For available Finishes see pages 146-150

## Features

- Extensive selection of standard fabrics, colors, textures and patterns.
- Strong, lightweight honeycomb construction to withstand both tenant abuse and panel relocation.
- Fully-tailored fabric-wrapped edges for single panel applications and quick, simple installation and relocation.
- PVC-reinforced edges for crisp joints between panels and extended panel life.
- High-density fiberglass tack board improves acoustics, abuse resistance and makes every panel a fully tackable display surface.
- 2 Year Limited Warranty.

Relative Installed Cost:

\$\$\$\$

Product Features at a Glance:

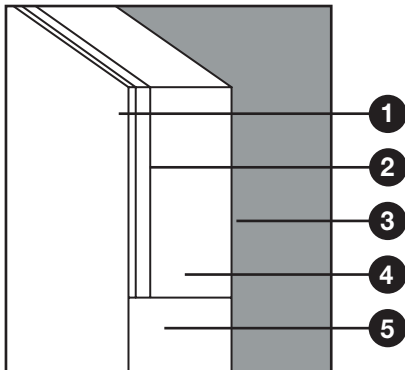

- 1 Finish
- 2 Impact/Tack Layer
- 3 Glass Fiber Mat
- 4 Honeycomb Acoustical Core
- 5 PVC Edge Reinforcement

## An Abuse-Resistant Solution Providing Acoustical Performance and Tackability

Conference Rooms, Private Offices and Public Areas

### Physical Data

#### Finish

- Guilford of Maine FR701® polyester fabrics
- Maharam Tek-Wall® 1000 polyolefin fabrics
- Omnova Web Core vinyl fabrics
- BGF Nubby glass cloth fabrics
- Hytex Whisper Tex non-woven polyester fabric
- Selected Arc-Com, Designtex, Gilford and Knoll finishes available
- Customer provided material

#### Edge

- Square: [4] fabric wrapped
- PVC-reinforced

#### Options

J-Moldings with fabric wrapped finishes

#### Mounting

Velcro®, Z-Clip, Impaling Clip with Adhesive, Construction Adhesive

#### Substrate

3/4" panel thickness – 1/8"16-20pcf fiberglass tack board bonded to 5/8" honeycomb core with glass mat back.

#### Fire

- Core – Class A per ASTM E 84
- Fabrics – Class A per ASTM E 84
- Adhesive – Class A per ASTM E 84

#### Size

- Standard: 4' x 10' maximum
- Custom sizes also available

### Sound Absorption

NRC Range .70 – .80 (Guilford of Maine fabric finish)

#### Frequency Band

125 Hz	250 Hz	500 Hz	1000 Hz	2000 Hz	4000 Hz
.07	.22	.81	.98	.89	.83

# Architectural Solutions® 300

For available Finishes see pages 146-150

## Features

- Vinyl or polyolefin fabrics withstand repeated cleanings.
- Abuse resistant, honeycomb construction.
- Highly acoustical.
- Fully tailored – fabric wrapped edges.
- Velcro mounting for harsh environments.
- PVC-reinforced edges for crisp joints between panels and extended panel life.
- 2 Year Limited Warranty.
- Moisture-resistant.

Relative Installed Cost:

\$\$\$\$

Product Features at a Glance:

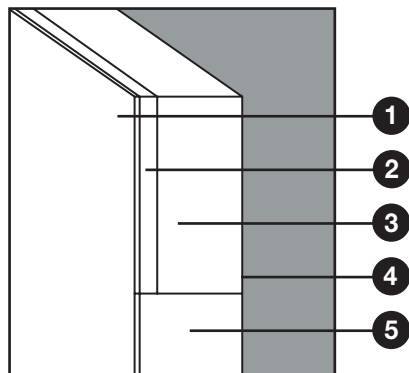

- 1 Finish
- 2 Impact/Tack Layer
- 3 Honeycomb Acoustical Core. Moisture Resistant
- 4 Glass Fiber Mat
- 5 PVC Edge Reinforcement

## A Quiet Solution for Harsh and Humid Environments

Swimming Pools, Health Clubs and Industrial Applications

### Physical Data

#### Finish

- Maharam Tek-Wall® 1000 polyolefin fabric
- Omnova Web Core vinyl fabrics
- Selected Arc-Com, Designtex, Gilford and Knoll finishes available

#### Edge

Square: [4] fabric wrapped  
PVC-reinforced

#### Options

J-Moldings with fabric wrapped finishes

#### Sound Absorption

NRC Range .70 – .80

#### Mounting

Velcro®, Aluminum Z-Clip, Construction Adhesive

#### Substrate

3/4" panel thickness – 1/8" 16-20pcf molded fiberglass board bonded to a moisture resistant 5/8" honeycomb core with glass mat back.

#### Fire

- Core – Class A per ASTM E 84
- Fabrics – Class A per ASTM E 84
- Adhesive – Class A per ASTM E 84

#### Size

- Standard: 4' x 10' maximum
- Custom sizes also available

### Sound Absorption

NRC Range .70 – .80 (Guilford of Maine fabric finish)

### Frequency Band

125 Hz	250 Hz	500 Hz	1000 Hz	2000 Hz	4000 Hz
.07	.22	.81	.98	.89	.83



# Architectural Solutions® 400

For available Finishes see pages 146-150

## Features

- Extensive selection of standard fabrics, colors, textures and patterns.
- Strong – lightweight-honeycomb construction withstands abuse; fiberglass backing for improved sound absorption.
- Fully tailored fabric wrapped edges for single panel applications and quick installation and relocation.
- Aluminum reinforced edges for crisp joints between panels and extended panel life.
- High density fiberglass tackboard improves acoustics and abuse resistance and creates a fully tackable display surface on every panel.
- 2 Year Limited Warranty.

Relative Installed Cost:

\$\$\$\$

Product Features at a Glance:

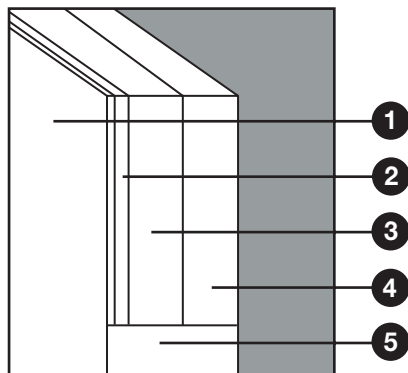

- 1 Finish**
- 2 Impact/Tack Layer**
- 3 Honeycomb Acoustical Core**
- 4 Fiberglass Acoustical Core**
- 5 Aluminium Edge Reinforcement**

## An Exceptional Sound Absorption Solution For High Noise Areas

Data Processing, Computer and Mechanical Rooms

### Physical Data

#### Finish

- Guilford of Maine FR701® polyester fabrics
- Maharam Tek-Wall® 1000 polyolefin fabrics
- Hytex Whisper Tex non-woven polyester fabrics
- Omnova Web Core vinyl fabrics
- Nubby glass cloth fabrics
- Selected Arc-Com, Designtex, Gilford and Knoll finishes available
- Customer provided material

#### Edge

- Square: [4] fabric wrapped edges
- Aluminum reinforced

#### Options

- Z bar mounting

#### Mounting

Velcro®, Z-Clip, Impaling Clip with Adhesive, Construction Adhesive

#### Substrate

1-1/2" Panel thickness – 1/8" 16-20pcf fiberglass tack board bonded to 5/8" honeycomb that is backed with 3/4" 6-7pcf fiberglass

#### Fire

- Core – Class A per ASTM E 84
- Fabrics – Class A per ASTM E 84
- Adhesive – Class A per ASTM E 84

#### Size

- Standard: 4' x 10' maximum
- Custom sizes also available

### Sound Absorption

NRC Range .85 – .95 (Guilford of Maine fabric finish)

#### Frequency Band

125 Hz	250 Hz	500 Hz	1000 Hz	2000 Hz	4000 Hz
.34	.81	1.04	.92	.81	.82

# Architectural Solutions® 500

For available Finishes see pages 146-150

## Features

- Extensive selection of standard fabrics, colors, textures and patterns.
- Economical, high density, perforated mineral fiberboard core for improved acoustics and tackability.
- Fully tailored, fabric wrapped edges with the look and feel of premium panels.
- 30" Standard panel width plus full custom size capabilities to simplify room layout and panel installation.
- 2 Year Limited Warranty.

Relative Installed Cost:

\$\$\$\$

Product Features at a Glance:



## A General Purpose Solution Providing Acoustical Performance and Tackability

Conference Rooms, Private Offices and Class Rooms

Physical Data						
<b>Finish</b>			<b>Mounting</b>			
<ul style="list-style-type: none"> <li>• Guilford of Maine FR701® polyester fabrics</li> <li>• Maharam Tek-Wall® 1000 polyolefin fabrics</li> <li>• Omnova Web Core vinyl fabrics</li> <li>• BGF Nubby glass cloth fabrics</li> <li>• Hytex Whisper Tex non-woven polyester fabric</li> <li>• Selected Arc-Com, Designtex, Gilford and Knoll finishes available</li> <li>• Customer provided material</li> </ul>			<ul style="list-style-type: none"> <li>• Concealed Splines, Z-Clip, Velcro®</li> <li>• Construction Adhesive</li> </ul>			
<b>Edge</b>			<b>Substrate</b>			
<ul style="list-style-type: none"> <li>• Square: [4] fabric wrapped edges</li> </ul>			5/8" panel thickness X 24pcf fire-rated, high-density perforated mineral fiber board			
<b>Options</b>			<b>Fire</b>			
<ul style="list-style-type: none"> <li>• J-Moldings with fabric wrapped finishes</li> <li>• Radius, mitered or beveled edges</li> </ul>			<ul style="list-style-type: none"> <li>• Core – Class A per ASTM E 84</li> <li>• Fabrics – Class A per ASTM E 84</li> <li>• Adhesive – Class A per ASTM E 84</li> </ul>			
<b>Sound Absorption</b>			<b>Size</b>			
NRC Range .25 – .35 (Guilford of Maine fabric finish)						
Frequency Band						
125 Hz	250 Hz	500 Hz	1000 Hz	2000 Hz	4000 Hz	
.12	.10	.27	.36	.43	.33	

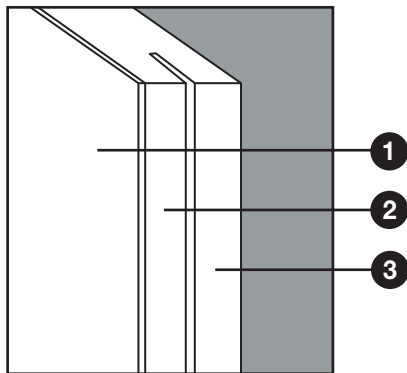

- 1 Finish
- 2 High Density, Perforated Mineral Fiber
- 3 Concealed Spline Kerf

# Architectural Solutions® 600

For available Finishes see pages 146-150

## Features

- Ultimate in performance flexibility through unique combinations of fiberglass cores [3/4"] [1"] [2-4"].
- Fully tailored fabric wrapped edges for single panel applications and quick, simple installation and relocation.
- 48" Standard panel width plus full custom size capabilities to simplify room layout and installation.
- Unique 1/8" high-density, molded fiberglass. Impact/lock layer available to extend panel life.
- Economical, high-density fiberglass core for excellent noise control.
- Extensive selection of standard fabrics, colors, textures and patterns.
- 2 Year Limited Warranty.

## Relative Installed Cost:

\$\$\$\$

## Product Features at a Glance:

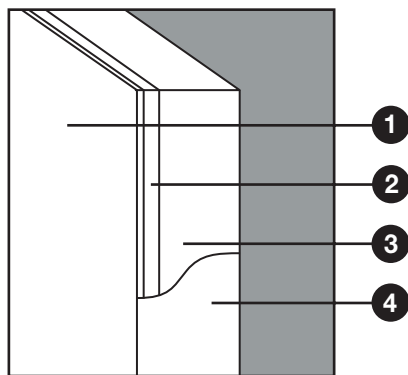

- 1 Finish**
- 2 Optional Impact Molded Fiberglass/Tack Layer**
- 3 Fiberglass Acoustical Core**
- 4 Hardened Edges**

## Maximum Sound Absorption for Specific Design Challenges

Open Plan Perimeters, Recording Studios

Physical Data	
<b>Finish</b>	<b>Mounting</b>
<ul style="list-style-type: none"> <li>• Guilford of Maine FR701® polyester fabrics</li> <li>• Maharam Tek-Wall® 1000 polyolefin fabrics</li> <li>• Omnova Web Core vinyl fabrics</li> <li>• BGF Nubby glass cloth fabrics</li> <li>• Hytex Whisper Tex non-woven polyester fabric</li> <li>• Selected Arc-Com, Designtex, Gilford and Knoll finishes available</li> <li>• Customer provided material</li> </ul>	<ul style="list-style-type: none"> <li>• Velcro® Z-Clip, Impaling Clip with Adhesive, Construction Adhesive, Magnetic Buttons</li> </ul>
<b>Edge</b>	<b>Substrate</b>
<ul style="list-style-type: none"> <li>• Square: [4] fabric wrapped</li> <li>• Hardened edges</li> </ul>	<ul style="list-style-type: none"> <li>• [3/4"], [1"], [1 1/2"], [2"] 6-7pcf fiberglass with chemically hardened edges and optional 1/8" 16-20pcf fiberglass tack/impact surface</li> </ul>
<b>Options</b>	<b>Fire</b>
<ul style="list-style-type: none"> <li>• J-Moldings with fabric wrapped finishes</li> <li>• Radius, mitered or beveled edges.</li> <li>• Baffle and Cloud Mounting Options [D-ring/Eye hook]</li> <li>• Z-Bar mounting option</li> <li>• Thickness combinations of fiberglass cores up to 4 1/8" available.</li> </ul>	<ul style="list-style-type: none"> <li>• Core – Class A per ASTM E 84</li> <li>• Fabrics – Class A per ASTM E 84</li> <li>• Adhesive – Class A per ASTM E 84</li> </ul>
	<b>Size</b>
	<ul style="list-style-type: none"> <li>• [3/4"] 4' x 10' , [1 1/2"] 4' x 10'</li> <li>• Custom sizes also available</li> </ul>

## Sound Absorption (Guilford of Maine fabric finish)

Frequency Band	NRC Range	125 Hz	250 Hz	500 Hz	1000 Hz	2000 Hz	4000 Hz
3/4"	.75 – .85	.08	.31	.78	1.01	1.00	.87
7/8"†	.80 – .90	.11	.38	.84	1.02	1.07	1.21
1"	.80 – .90	.15	.45	.90	1.04	.98	.81
1-1/8"†	.90 – 1.00	.21	.53	.98	1.10	1.14	1.40
2"	1.00 – 1.10	.40	.97	1.16	1.08	1.01	1.00
2-1/8"†	.95 – 1.05	.52	.97	1.14	1.07	1.01	1.02

† with 1/8" Impact/Tack Layer



# Architectural Solutions® 700

For available Finishes see pages 146-150

## Features

- Extensive selection of standard fabrics, colors, textures and patterns.
- Economical, high density fiberglass core for excellent noise control.
- Fully tailored fabric wrapped edges with the look and feel of custom panels.
- 48" standard width plus full custom size capabilities to simplify room layout and installation.
- Ultimate in performance, flexibility through unique combinations of fiberglass cores [3/4 – 2-1/8"].
- 2 Year Limited Warranty.

## Relative Installed Cost:

\$\$\$\$

## Product Features at a Glance:

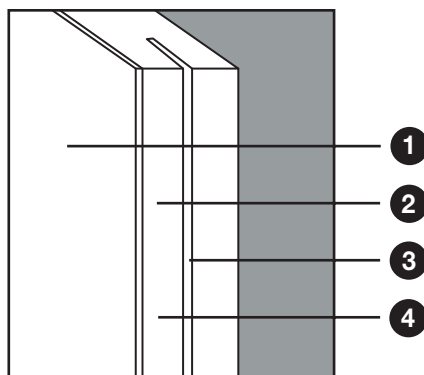

- 1 Finish
- 2 Fiberglass acoustical core
- 3 Concealed spline kerf edge mounting
- 4 Hardened Edges

## A General Purpose Solution Providing Exceptional Sound Absorption

Data Processing, Computer Rooms and General Offices

### Physical Data

#### Finish

- Guilford of Maine FR701® polyester fabrics
- Maharam Tek-Wall® 1000 polyolefin fabrics
- Omnova Web Core vinyl fabrics
- BGF Nubby glass cloth fabrics
- Hytex Whisper Tex non-woven polyester fabric
- Selected Arc-Com, Designtex, Gilford and Knoll finishes available
- Customer provided material

#### Edge

- Square: [4] fabric wrapped edges
- Hardened edges

#### Options

J-Moldings with fabric wrapped finishes, Radius or beveled edges

#### Mounting

Concealed Spline

#### Substrate

[3/4"], [1"], [1 1/2"], [2"] 6-7pcf fiberglass with chemically hardened edges and optional 1/8" 16-20pcf fiberglass tack/impact surface

#### Fire

- Core – Class A per ASTM E 84
- Fabrics – Class A per ASTM E 84
- Adhesive – Class A per ASTM E 84

#### Size

- [3/4"] 4' x 10' , [1 1/2"] 4' x 10'
- Custom sizes also available

### Sound Absorption (Guilford of Maine fabric finish)

#### Frequency Band

	NRC Range	125 Hz	250 Hz	500 Hz	1000 Hz	2000 Hz	4000 Hz
3/4"	.75 – .85	.08	.31	.78	1.01	1.00	.87
7/8"†	.80 – .90	.11	.38	.84	1.02	1.07	1.21
1"	.80 – .90	.15	.45	.90	1.04	.98	.81
1-1/8"†	.90 – 1.00	.21	.53	.98	1.10	1.14	1.40
2"	1.00 – 1.10	.40	.97	1.16	1.08	1.01	1.00
2-1/8"†	.95 – 1.05	.52	.97	1.14	1.07	1.01	1.02

† with 1/8" Impact/Tack Layer



# Architectural Solutions® 800

For available Finishes see pages 146-150

## Features

- The most economical way to reduce unwanted noise.
- Extensive selection of standard fabrics, colors, textures and patterns.
- Quick, simple installations with H&J Moldings finished to match or coordinate with the panel finishes.
- 2 Year Limited Warranty.
- Face laminated only - EXPOSED EDGES.

Relative Installed Cost:

\$\$\$\$

Product Features at a Glance:

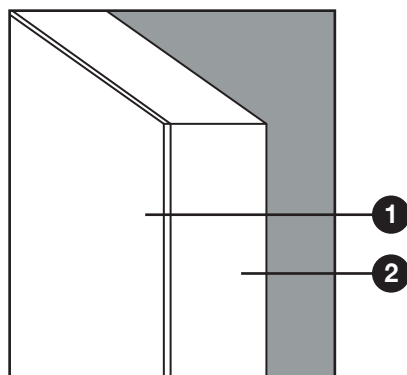

- 1 Finish
- 2 Fiberglass Acoustical Core

## A Cost-Effective Solution Providing Excellent Sound Absorption Copy Rooms, Gymnasiums and Industrial Applications

Physical Data						
<b>Finish</b>			<b>Substrate</b>			
<ul style="list-style-type: none"> <li>• Guilford of Maine FR701® polyester fabrics</li> <li>• Maharam Tek-Wall® 1000 polyolefin fabrics</li> <li>• Omnova Web Core vinyl fabrics</li> <li>• BGF Nubby glass cloth fabrics</li> <li>• Hytex Whisper Tex non-woven polyester fabric</li> <li>• Customer provided material</li> </ul>			1" panel thickness x 6-7pcf fiberglass			
<b>Edge</b>			<b>Fire</b>			
<ul style="list-style-type: none"> <li>• Non-wrapped</li> <li>• Face laminated only</li> </ul>			<ul style="list-style-type: none"> <li>• Core – Class A per ASTM E 84</li> <li>• Fabrics – Class A per ASTM E 84</li> <li>• Adhesive – Class A per ASTM E 84</li> </ul>			
<b>Mounting</b>			<b>Size</b>			
H&J Moldings in choice of white PVC or fabric wrapped finishes			<ul style="list-style-type: none"> <li>• Standard: 4' x 10' 6-7pcf</li> <li>• Custom sizes also available</li> </ul>			
Sound Absorption						
NRC Range .65 – .75 (Guilford of Maine fabric finish)						
Frequency Band						
125 Hz	250 Hz	500 Hz	1000 Hz	2000 Hz	4000 Hz	
.20	.53	.76	.77	.71	.61	



# Architectural Solutions® 900

For available Finishes see pages 146-150

## Features

- Maximum tackability up to 20 lbs. with minimal sound absorption.
- Fully tailored fabric wrapped edges for single pane applications or full height continuous display walls.
- Look and feel of custom acoustical wall panels plus extended useful life due to a unique 1/8" high density fiberglass impact surface over a super high density tack fiber core.
- 48" Standard width for minimal vertical joints.
- Extensive selection of standard fabrics, colors, textures and patterns.
- For higher sound absorption, see Solutions® 1000 product.
- 2 Year Limited Warranty.

Relative Installed Cost:

\$\$\$\$

Product Features at a Glance:

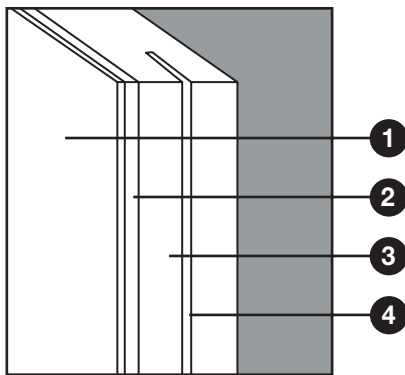

- 1 Finish**
- 2 Impact Molded Fiberglass/Tack Layer**
- 3 Mineral Fiber Core**
- 4 Concealed Spline Kerf**

## An Attractive Solution Providing Maximum Tackability Conference and Training Rooms, Display Walls and Tackboards

### Physical Data

#### Finish

- Guilford of Maine FR701® polyester fabrics
- Maharam Tek-Wall® 1000 polyolefin fabrics
- Omnova Web Core vinyl fabrics
- BGF Nubby glass cloth fabrics
- Hytex Whisper Tex non-woven polyester fabric
- Selected Arc-Com, Designtex, Gilford and Knoll finishes available
- Customer provided material

#### Edge

Square: [4] fabric wrapped

#### Options

- J-Moldings with fabric wrapped finishes.
- Radius, mitered or beveled edges

#### Sound Absorption

NRC Range .25 – .35 (Guilford of Maine fabric finish)

#### Frequency Band

125 Hz	250 Hz	500 Hz	1000 Hz	2000 Hz	4000 Hz
.05	.26	.26	.24	.37	.65

#### Mounting

Concealed Spline, Z-Clip, Velcro® or Construction Adhesive

#### Substrate

3/4" panel thickness 1/8" 16-20pcf molded fiberglass tack board bonded to 5/8" 24pcf fire rated mineral fiber board

#### Fire

- Core – Class A per ASTM E 84
- Fabrics – Class A per ASTM E 84
- Adhesive – Class A per ASTM E 84

#### Size

- Standard: 4' x 10' maximum
- Custom sizes also available

For available Finishes see pages 146-150

## Features

- Maximum tackability up to 20 Lbs.
- Fully tailored fabric wrapped edges for single panel applications or full height continuous display walls.
- Unique 1/8" high density fiberglass impact surface extends panel life.
- 48" Standard width for minimal vertical joints.
- Extensive selection of standard fabrics, colors, textures and patterns.
- 2 Year Limited Warranty.

Relative Installed Cost:

\$\$\$\$

Product Features at a Glance:

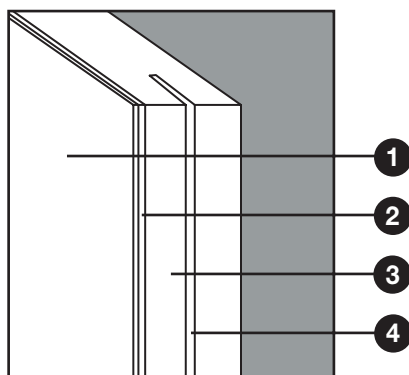

- 1 Finish
- 2 Impact Molded Fiberglass/Tack Layer
- 3 Fire Rated Mineral Fiber Core
- 4 Concealed Spline Kerf

## An Attractive Solution Providing Maximum Tackability and Excellent Sound Absorption

Conference and Training Rooms, Museums, Libraries

### Physical Data

#### Finish

- Guilford of Maine FR701® polyester fabrics
- Maharam Tek-Wall® 1000 polyolefin fabrics
- Omnova Web Core vinyl fabrics
- BGF Nubby glass cloth fabrics
- Hytex Whisper Tex non-woven polyester fabric
- Selected Arc-Com, Designtex, Gilford and Knoll finishes available
- Customer provided material

#### Edge

Square: [4] fabric wrapped

#### Options

- J-Moldings with fabric wrapped finishes
- Radius, mitered or beveled edges

#### Mounting

Concealed Spline, Z-Clip, Velcro®, Construction Adhesive

#### Substrate

3/4" panel thickness 1/8" 16-20pcf molded fiberglass tack board bonded to 24pcf fire rated, perforated 5/8" mineral fiber board

#### Fire

- Core – Class A per ASTM E 84
- Fabrics – Class A per ASTM E 84
- Adhesive – Class A per ASTM E 84

#### Size

- Standard: 4' x 10' maximum
- Custom sizes also available

### Sound Absorption

NRC Range .65 – .75 (Guilford of Maine fabric finish)

#### Frequency Band

125 Hz	250 Hz	500 Hz	1000 Hz	2000 Hz	4000 Hz
.10	.31	.75	.87	.85	.72

# Architectural Solutions®

## FABRIC TEXTURES AND FINISHES

This chart represents the standard finish options. C.O.M. (Customers Own Material) option is available on all wall products.

### Wall Products

Wall Products	Guilford of Maine	Tek-Wall®	Whisper Tex	Web Core	White and/or Black Nubby	C. O. M.
	Finishes					
Solutions® 100	•	•	•	•	•	•
Solutions® 200	•	•	•	•	•	•
Solutions® 300		•		•		•
Solutions® 400	•	•	•	•	•	•
Solutions® 500	•	•	•	•	•	•
Solutions® 600	•	•	•	•	•	•
Solutions® 700	•	•	•	•	•	•
Solutions® 800	•	•	•	•	•	•
Solutions® 900	•	•	•	•	•	•
Solutions® 1000	•	•	•	•	•	•

### Finish Description

#### Guilford of Maine

(Woven polyester by Guilford of Maine) maximum acoustics combined with superior color and texture selection, excellent durability and good cleanability

#### Tek-Wall®

(Woven polyolefin by Maharam) excellent acoustics, maximum durability, excellent color and texture selection, maximum cleanability

#### Whisper-Tex

(Non-woven polyester by Hytex Industries) excellent acoustics and durability, maximum pattern, color and texture selection, fire and smoke retardant

#### Web Core

(Vinyl fabric by Omnova Solutions) maximum durability with an expanded color and texture selection, maximum cleanability, excellent acoustics

#### Nubby

(Woven fiberglass fabric) maximum acoustics, excellent durability and light reflectance

Availability of all finishes is subject to the discretion of the manufacturer and can not be guaranteed by CertainTeed. Due to the limits of photographic reproduction, colors shown are approximate only.

**For actual finish and fabric samples, call:**













**Guilford of Maine** – 800-544-0200

**Hytex** – 781-963-4400

**Maharam** – 800-645-3943

**OMNOVA SOLUTIONS** – (800) 496-3432

Polyolefin Fabrics – Guilford of Maine (available on wall panels)

	#468 EUCALYPTUS		#408 BLACK		#390 ROSE QUARTZ
	#561 VERTE PAPIER		#394 OPAL		#475 SIENNA
	#467 BLUE SPRUCE		#238 GREY MIX		#545 BRONZE
	#402 GREEN NEUTRAL		#751 TERRA		#556 DEEP BURGUNDY
	#381 AQUAMARINE		#298 MEDIUM GREY		#460 BUFF
	#470 ULTRAMARINE		#747 STRAW		#403 VANILLA NEUTRAL
	#175 CRYSTAL BLUE		#748 BONE		#422 CINNABAR
	#486 BAYBERRY		#481 PEARL		#753 VIOLET
	#150 WEDGEWOOD		#758 DESERT SAND		#752 LILAC
	#153 BALTIC		#750 CEMENT MIX		#749 DUNE
	#401 BLUE NEUTRAL		#538 SILVER PAPIER		#757 STREAM
	#406 SILVER NEUTRAL		#380 QUARTZ		#755 LEAF
	#405 LAVENDER NEUTRAL		#130 WHEAT		#754 LIGHT MOSS
	#424 AMETHYST		#539 BLEU PAPIER		#549 CHROME GREEN
	#553 BLUE PLUM		#423 PUMICE		#756 LAKE
	#404 APRICOT NEUTRAL		#418 CLARET ACCENT		
			#400 CHERRY NEUTRAL		



















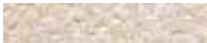







# Architectural Solutions®

## FABRIC TEXTURES AND FINISHES

Polyolefin Fabrics – *Tek-Well®* (available on wall panels)

	#195 LINEN MIST		#171 SEASIDE GREEN		#207 HONEYSUCKLE
	#192 WOODROSE PETAL		#176 MISTY MORN		#220 CAMEL HAIR
	#183 BISCUIT BEIGE		#165 SPRAY MIST		#166 PEBBLE BEACH
	#179 MINTLESS		#164 SANDRIFT GREY		#221 COIN
	#226 BUTTERCREAM		#163 JEWELLED MARBLE		#213 SPARROW
	#209 MOONDUST		#162 DOVE GREY		#194 SULPHUR GREY
	#206 CORNSILK		#223 SISAL		

### Polyolefin Fabrics – Hytex Whisper Tex (available on wall panels)

	<p><b>Plissé Pattern</b>  <i>Note: The Plissé pattern is available in the colors shown for Coppersmith. When ordering Plissé use prefix "60".</i>  <b>#60-61 PLISSÉ MOSS</b></p>		<b>#59-26 SANDSTONE</b>		<b>#59-48 PERSIMMON</b>
			<b>#59-39 GRANITE</b>		<b>#59-32 BAYLEAF</b>
			<b>#59-55 CHARCOAL</b>		<b>#59-34 KHAKI</b>
	<p><b>Coppersmith Pattern</b>  <i>When ordering Coppersmith use prefix "59".</i>  <b>#59-51 COPPERSMITH HONEY</b></p>		<b>#59-08 IVORY</b>		<b>#59-28 LODEN</b>
			<b>#59-58 HYACINTH</b>		<b>#59-60 LAGOON</b>
	<b>#59-53 FLAGSTONE</b>		<b>#59-38 PLATINUM</b>		<b>#59-47 CLARET</b>
	<b>#59-51 HONEY</b>		<b>#59-54 PEWTER</b>		<b>#59-46 ESPRESSO</b>
	<b>#59-52 NATURAL</b>		<b>#59-14 PEARL</b>		<b>#59-61 MOSS</b>
	<b>#59-49 HARVEST</b>		<b>#59-59 WEDGEWOOD</b>		
	<b>#59-50 SAFFRON</b>		<b>#59-56 JET</b>		
			<b>#59-57 NAVY</b>		

# Architectural Solutions®

## FABRIC TEXTURES AND FINISHES

Vinyl – *Omnova Solutions Web Core (available on wall panels)*

	<b>High Style Pattern</b> #399043 WHITE		<b>Glenshire Pattern</b> #389325 PEACH		<b>Knightsbridge Pattern</b> #411309 ROBIN EGG
	<b>#390493 PURE WHITE</b>		<b>#389326 ASH BLUE</b>		<b>#411306 BLUE WHITE</b>
	<b>#389330 FLANNEL</b>		<b>#389323 BOTTLE GREEN</b>		<b>#411305 SAND DUNE</b>
	<b>#389331 ROSE MIST</b>		<b>Hatton Pattern</b> #413034 HEATHER		<b>#411307 GREEN MIST</b>
	<b>#389332 CRYSTAL BEACH</b>		<b>#411723 GRAY</b>		<b>#411308 STONE BLUE</b>
	<b>#389334 BLUEBERRY</b>		<b>#411724 QUARTZ</b>		<b>#411304 LILAC</b>
			<b>#413035 LIGHT GREEN</b>		

Fiberglass Fabrics – *Woven and non-woven fiberglass (available on select ceilings and wall panels)*

	<b>WHITE NUBBY</b>
--	--------------------