

IMMERSIBLE MOTORS

Reliance® Immersible Motors: Proven performance—even at thirty feet.

Reliance® Immersible motors are designed for use where any possibility of flooding exists. The motors feature totally enclosed, blower-cooled enclosures and are designed with a unique sealing system. This system allows reliable operation for a period of two weeks while submerged under a maximum depth of thirty feet of water.

A diverse product line is offered to satisfy most demanding requirements:

- Horsepower range 5 to 250 HP
- Frame range 210 to 449
- 3600, 1800, 1200, and 900 rpm

The immersible design has been proven by conducting extensive tests and inspections. The only way to claim that our motors will run underwater for two weeks is to imitate these same field conditions. At the conclusion of the testing, the motors are disassembled and inspected by engineers to assess dryness and structural integrity.



Premium features:

- Premium efficient designs
- Variable frequency operation on variable torque applications
- Winding temperature detectors (thermostats)
- Space heater
- Moisture detector inside the frame
- P-Base or C- face mounting
- Vertical or horizontal mounting available
- 25 feet of cable, other lengths available
- Immersible motor sealing system

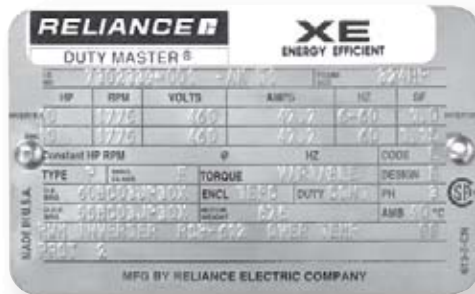

Immersible motors are ideal for drypit applications in flood plains. The motor exceeds the IP67 requirements of two weeks submersion at a depth of thirty feet.

All immersible motors are manufactured at the Reliance ISO9001 certified facility in Gainesville, Georgia.

Contact your local Sales Engineer for more information or visit our website at www.reliance.com.

- Aggregate/Cement
- Food
- Mining
- ✓ Forest/Paper
- ✓ Petro/Chem
- Unit/Baggage Handling
- HVAC/Industrial Air Handling
- ✓ Environmental/Fluid Power
- Automotive
- Metals



The totally enclosed blower-cooled immersible motor is equipped with a Reliance ½ hp motor for cooling. Once the motor is submerged, a float switch* disengages the blower motor. The blower motor must be inspected and replaced if necessary before re-starting the motor dry.

*Reliance does not provide the float switch.

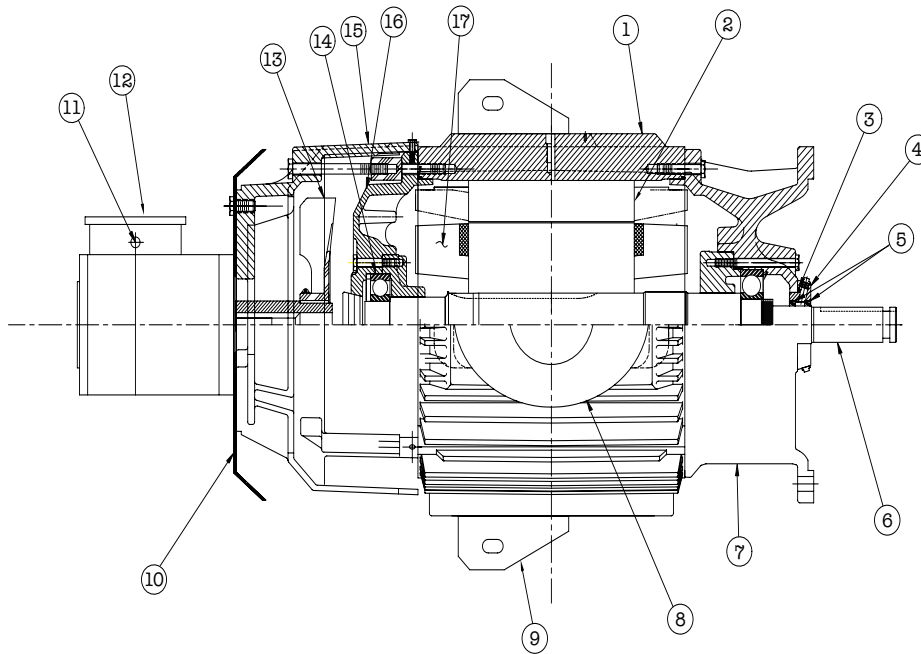

This cutaway shows the typical construction for a vertical mount immersible motor. The unique sealing arrangement makes the immersible motor the ideal choice for applications where the possibility of flooding exists.

- | | | |
|-------------------------|------------------------------------|----------------------------|
| 1. Frame | 7. Back end bracket | 13. Outer Fan |
| 2. Stator | 8. Conduit box, cable cap assembly | 14. Front end ball bearing |
| 3. O ring, seal carrier | 9. Lifting Plates | 15. Fan cover |
| 4. Seal carriage | 10. Drip cover | 16. Front end bracket |
| 5. Seals | 11. Blower motor cable entry | 17. Rotor |
| 6. Shaft | 12. Blower motor | |