

Extended-Life Performance

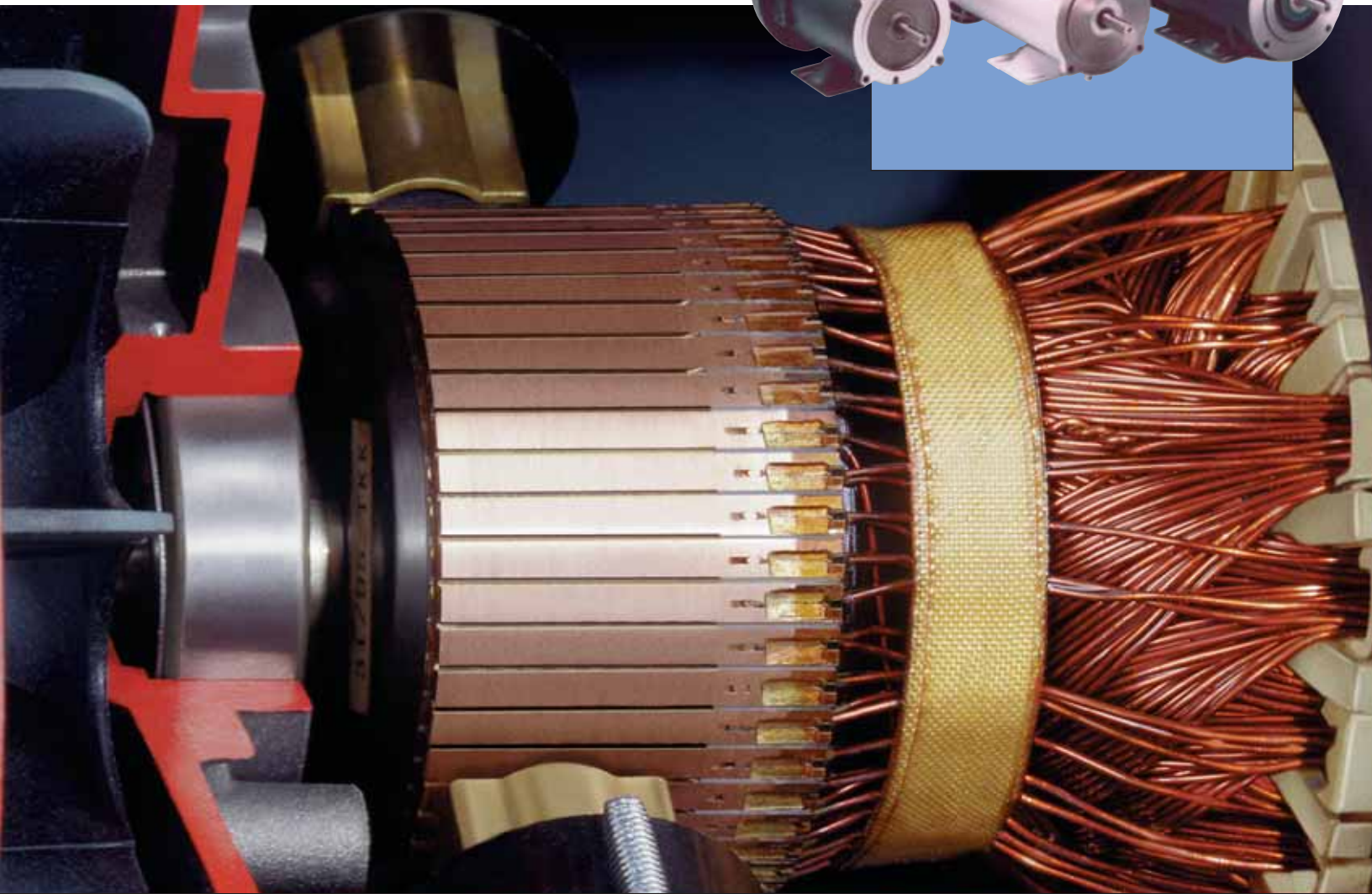

**Reliance® RPM XL
Fractional DC Motors**



RELIANCE

RPM XL DC Motors 1/8-2 HP Single-Phase Variable-Speed NEMA 56 C-Face Mounting

EXTENDED BRUSH AND MOTOR LIFE FOR SUPERIOR PERFORMANCE

The Reliance® RPM XL fractional DC motors provide dependable, variable-speed performance in a wide variety of industrial and commercial applications.

Extended Life Designed for low maintenance and extended life, RPM XL motors include several innovative features that provide measurable improvements in performance, including a new brush design that has been proven in independent testing to outlast competitive motor brushes 4 to 1.

Efficient These motors have permanent magnet fields, for reduced energy costs in comparison with wound field motors. Since there is no need for a field power supply, installation and maintenance costs are also reduced.

Performance Matched The RPM XL is designed to operate with single-phase DC controllers. When used with a NEMA power code K, these motors deliver 20:1 constant torque speed range on most ratings, with no overframing required. Torque at start-up is up to 650% of rated full load torque.

Approved RPM XL motors are manufactured under ISO-9001 certification; U/L component recognized and CSA approval are standard.

Reliable If you're looking for a small, high-performance, low-maintenance DC motor with variable-speed capabilities and lasting reliability, the Reliance RPM XL offers the characteristics you need from a manufacturer you trust.

Standard TEFC design helps keep operating temperatures low for extended motor life. For special applications, **TENV**, **wash-down** and **explosion proof** enclosures are also available.

High-grade **epoxy blue-green paint** with non-toxic rust inhibitors provides protection against harsh industrial environments. (Wash-down motors use USDA-approved white epoxy paint.)

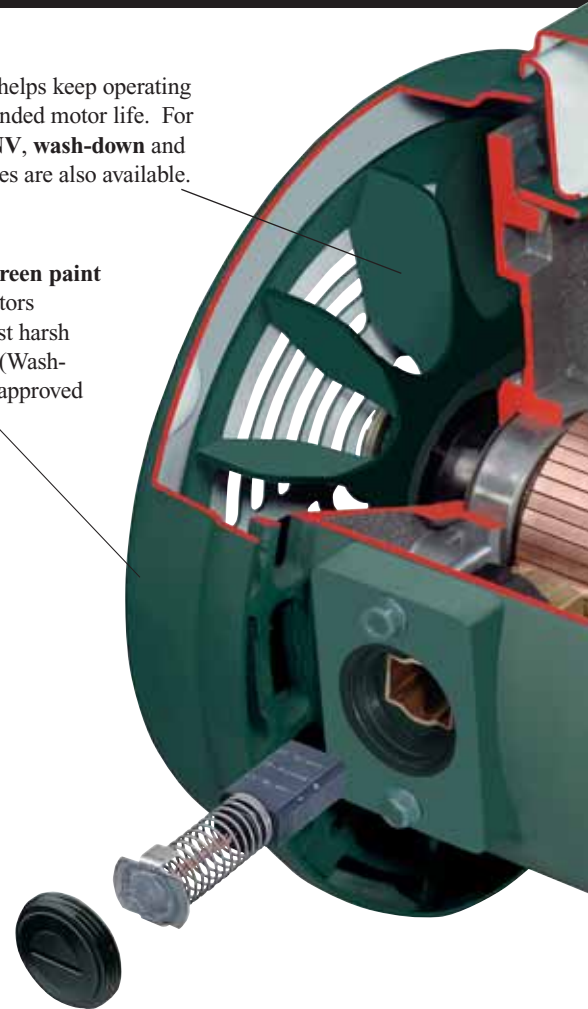

Oversized **brushes** are made of a new, longer lasting material. The **armature** is electrically balanced to protect the brushes against arcing. **Cartridge-style brush holders** promote regular brush inspection and maintenance. **Brass inserts and stainless steel springs** hold the brushes in place, ensuring constant pressure on the commutator, further extending brush life.

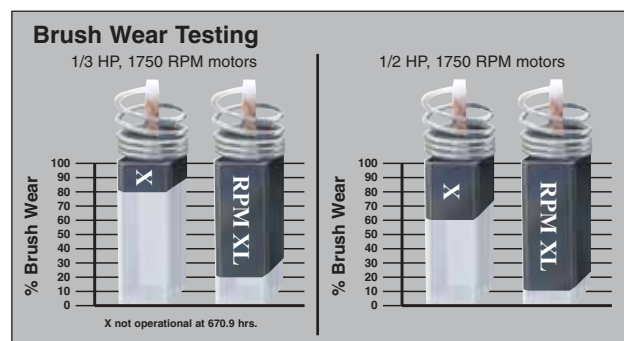

Independent testing compared Reliance RPM XL motors with a competitor's motors of the same rating. The results? The brush life of our new RPM XL small DC motors proved **at least four times longer** than the competition's. Testing details available upon request.

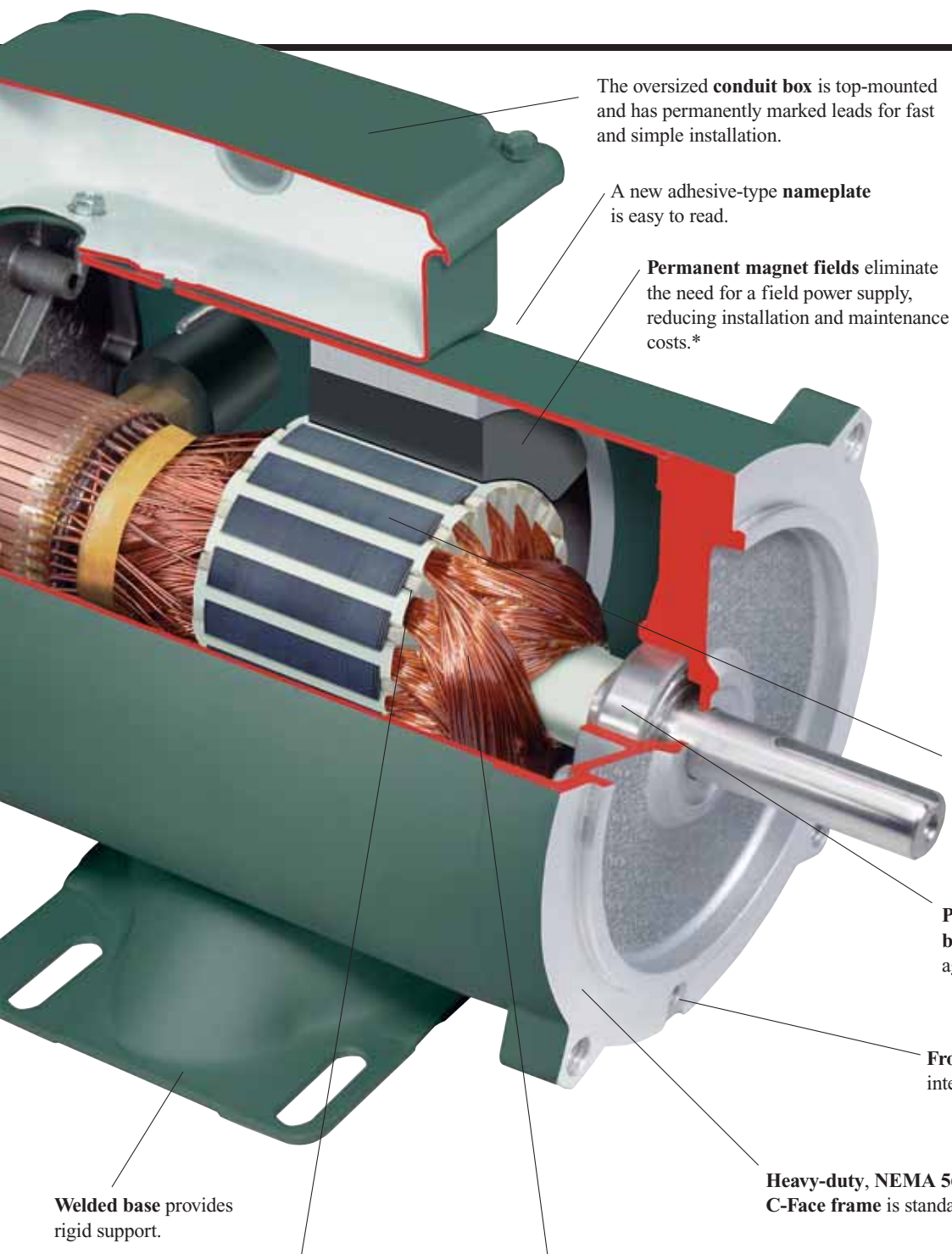

The oversized **conduit box** is top-mounted and has permanently marked leads for fast and simple installation.

A new adhesive-type **nameplate** is easy to read.

Permanent magnet fields eliminate the need for a field power supply, reducing installation and maintenance costs.*

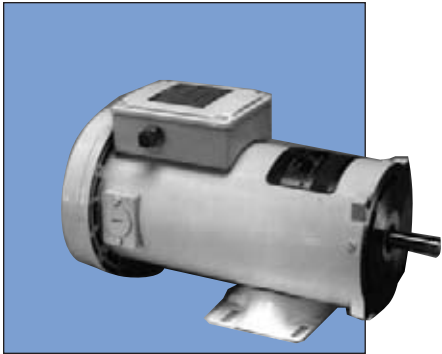

Wash-down models are available for severe, industrial applications, including food processing environments, where protection against contaminants, steam and high-pressure cleaning is critical. Special features include **lip seals** on both ends of the motor shaft to restrict water entry; a high-strength **stainless steel shaft** that resists corrosive environments; a **gasketed conduit box**; **double-sealed bearings**; **USDA-approved white epoxy paint**; and a **corrosion-resistant fan**.

Armature Class F non-hygroscopic insulation system, rated at 180° C, helps to extend motor life.

Permanently lubricated double-shielded ball bearings keep out dirt while guarding against grease loss.

Front and back drains protect the motor interior from water contamination.

Heavy-duty, NEMA 56 C-Face frame is standard.

Welded base provides rigid support.

Molded plastic end lamination and shaft protection for extended electrical and mechanical endurance.

The **armature winding** uses an improved, multiple-section design for improved motor performance and extended brush life.

Thermostats are available on a production basis or from stock. **IEC enclosures** are also available on a production basis. Convenient kits are available for **optional tachometer mounting**.

* Wound field models also available from stock.