

# HOKE Gyrolok RS Bonded Seals

## RS Bonded Seals

RS bonded gaskets create a seal with DIN 3852, Type A (RS) parallel threads. Gasket outer rings are available in both 316 stainless steel and zinc plated carbon steel. The inner ring, bonded to the outer ring, consists of either Buna-N or fluorocarbon FKM. To order, specify pipe size, outer ring, and inner ring material.

Note: For use only with Gyrolok RS fittings

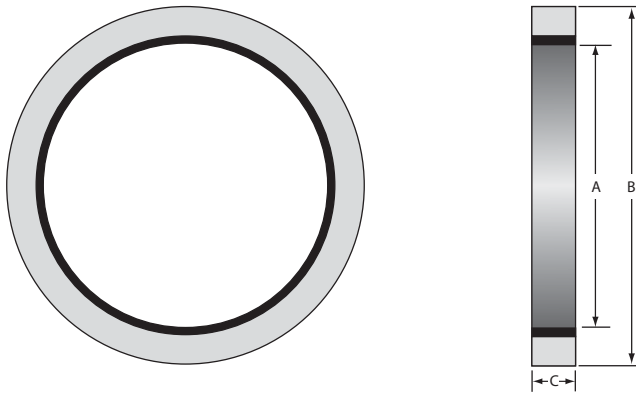

BSP PIPE SIZE	DIMENSIONS (INCHES)		
	A	B	C
1/8"	0.41	0.63	0.08
1/4"	0.54	0.81	0.08
3/8"	0.68	0.94	0.08
1/2"	0.85	1.13	0.09
3/4"	1.06	1.38	0.09
1"	1.33	1.69	0.09

METRIC PIPE SIZE	DIMENSIONS (MM)		
	A	B	C
8MM	8.7	13.0	1.0
10MM	10.7	16.0	
12MM	12.7	18.0	
14MM	14.7	21.0	
16MM	16.7	23.0	1.5
18MM	18.7	26.0	
20MM	20.7	28.0	
22MM	22.7	30.0	2.0
24MM	24.7	32.0	

## How to Order

[ 8 ] - RSG - [ 316 ] [ B ]

### Inner Ring

B Buna-N  
V Fluoroelastomer FKM

### Outer Ring

316 316 stainless steel  
CS Carbon steel, zinc plated

### BSP / Metric\* Pipe Sizes

2 G 1/8" A  
4 G 1/4" A  
6 G 3/8" A  
8 G 1/2" A  
12 G 3/4" A  
16 G 1" A  
8mm  
10mm  
12mm  
14mm  
16mm  
18mm  
20mm  
22mm  
24mm

\* For metric sizes, add "mm" to the size.  
Example: 12mm-RSG-316 B