

BlazeMaster® Fire Protection Fittings – STANDARD

CAPS

5017

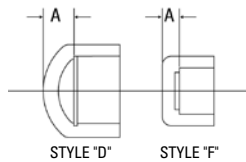

Caps

UNIV. FIG. NO.	NOM. SIZE	APPROX. NET WT./LBS.	DIM. A INCHES	STYLE	JOINT
5017	3/4"	0.04	0.31	D	S
5017	1"	0.06	0.39	D	S
5017	1-1/4"	0.22	0.41	F	S
5017	1-1/2"	0.30	0.42	F	S
5017	2"	0.42	0.44	F	S
5017	2-1/2"	0.62	1.20	D	S
5017	3"	0.96	1.26	D	S

COUPLINGS

5001
5001-R

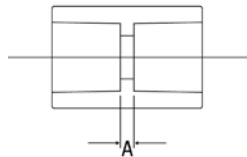

Coupling

UNIV. FIG. NO.	NOM. SIZE	APPROX. NET WT./LBS.	DIM. A INCHES	JOINT
5001	3/4"	0.06	0.12	SXS
5001	1"	0.08	0.09	SXS
5001	1-1/4"	0.12	0.08	SXS
5001	1-1/2"	0.30	0.27	SXS
5001	2"	0.44	0.28	SXS
5001	2-1/2"	0.72	0.20	SXS
5001	3"	1.10	0.22	SXS
5001-R	1"x3/4"	0.08	0.29	SXS
5001-R	1-1/4"x1"	0.12	0.35	SXS
5001-R	1-1/2"x1-1/4"	0.38	0.51	SXS
5001-R	1-1/2"x1"	0.36	0.67	SXS
5001-R	1-1/2"x3/4"	0.34	0.80	SXS
5001-R	2"x1-1/2"	0.52	0.51	SXS
5001-R	2"x1"	0.48	0.75	SXS

CROSSES

5035
5035-R

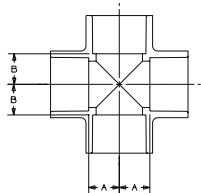

Cross

UNIV. FIG. NO.	NOM. SIZE	APPROX. NET WT./LBS.	DIM. A INCHES	DIM. B INCHES	JOINT
5035	3/4"	0.12	0.61	0.61	SXSXSXS
5035	1"	0.24	0.75	0.75	SXSXSXS
5035	1-1/4"	0.34	0.90	0.90	SXSXSXS
5035	1-1/2"	0.69	1.23	1.23	SXSXSXS
5035	2"	1.02	1.53	1.53	SXSXSXS
5035	2-1/2"	1.70	1.75	1.75	SXSXSXS
5035	3"	FUTURE OFFERING			
5035-R	1"x1"x3/4"x3/4"	0.18	0.61	0.73	SXSXSXS

BlazeMaster®