

595-Y-NS

The NIB-SEAL® Insulated Extended Handle system stops condensation cold. Its unique thermal barrier design keeps moisture from forming and infiltrating your insulated system while preventing thermal energy loss through exposed metal handles.



T595-Y-NS

Design Features:

- Protective sleeve provides a stationary surface to affix the pipe insulation. This allows operation of the valve without destroying the integrity of the insulated system
- High strength cylindrical handle features easy access to integral memory stop for system balancing
- Packing is accessible for adjustment without removing insulation
- Cap and insulating plug provide vapor seal to prevent exchange of air
- Position indication at a glance
- Preformed hole allows for convenient tagging

Specifications:

- UL94 (VO, V5B and 5VA)
- ASTM E84 (NFPA 255)
- MSS SP110

Applications:

- HVAC systems
- Insulated piping systems
- Hot and cold water lines (insulated)

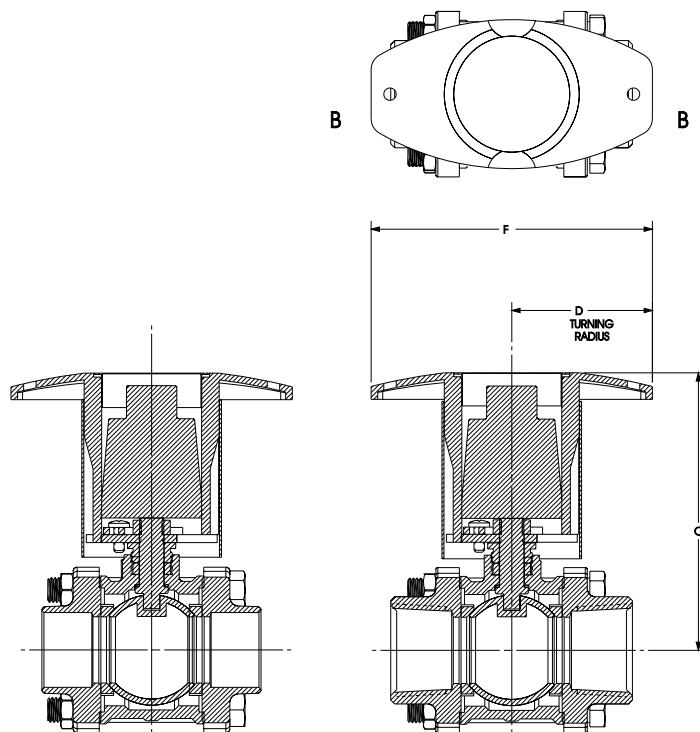

Dimensions in inches

Size	Dim. C	Dim. D	Dim. F
1/4	3.75	2.19	4.25
3/8	3.75	2.19	4.25
1/2	3.75	2.19	4.25
3/4	4.00	2.19	4.25
1	4.25	2.19	4.25
1 1/4	5.38	3.38	6.50
1 1/2	5.56	3.38	6.50
2	5.88	3.38	6.50

Dimensions in millimeters

Size	Dim. C	Dim. D	Dim. F
10	95.3	55.6	107.9
12	95.3	55.6	107.9
15	95.3	55.6	107.9
20	101.6	55.6	107.9
25	107.9	55.6	107.9
32	136.7	85.9	165.1
40	141.2	85.9	165.1
50	149.4	85.9	165.1

